

WATER WELL RECORD

Form WWC-5

Division of Water Resources App. No.

Well ID

MW12R

Original Record Correction Change in Well Use

1 LOCATION OF WATER WELL: County Washington Fraction NE 1/4 NW 1/4 NW 1/4 NW 1/4 Section Number 34 Township Number T 2 S Range Number R 5 E W

2 WELL OWNER: Last Name: First: Street or Rural Address where well is located (if unknown, distance and direction from nearest town or intersection): If at owner's address, check here: Hwy 36 & 145, Hanover KS

3 LOCATE WELL WITH "X" IN SECTION BOX: N NW NE SW SE S

4 DEPTH OF COMPLETED WELL: 23.5 ft Depth(s) Groundwater Encountered: 1) 23.5 ft 2) 3) 4) Dry Well WELL'S STATIC WATER LEVEL: 8.13 ft

5 Latitude: 39.84158 (decimal degrees) Longitude: 96.86040 (decimal degrees) Horizontal Datum: X WGS 84 NAD 83 NAD 27

7 WELL WATER TO BE USED AS: 1 Domestic: Household Lawn & Garden Livestock Irrigation Feedlot Industrial 2 Public Water Supply: well ID 3 Dewatering: how many wells? 4 Aquifer Recharge: well ID 5 Monitoring: well ID MW12R 6 Environmental Remediation: well ID 7 Air Sparge 8 Soil Vapor Extractor 9 Recovery 10 Injection 10 Oil Field Water Supply: lease 11 Test Hole: well ID 12 Geothermal: How many bores? a) Closed Loop Horizontal Vertical b) Open Loop Surface Discharge Inj. of Water Other (specify):

Was a chemical/bacteriological sample submitted to KDHE? Yes No If yes, date sample was submitted: Water well disinfected? Yes No

8 TYPE OF CASING USED: Steel PVC Other CASING JOINTS: Glued Clamped Welded Threaded Casing diameter 2 in. to 13.5 ft Diameter in. to ft Diameter in. to ft Casing height above land surface -0.52 in. Weight lbs./ft. Well thickness or gauge No TYPE OF SCREEN OR PERFORATION MATERIAL: Steel Stainless Steel Fiberglass PVC Other (Specify) SCREEN OR PERFORATION OPENINGS ARE: Continuous Slot Mill Slot Gauze Wrapped Torch Cut Drilled Holes Other (Specify) Louvered Shutter Key Punched Wire Wrapped Saw Cut None (Open Hole) SCREEN-PERFORATED INTERVALS: From 13.5 ft. to 23.5 ft. From ft. to ft. From ft. to ft. GRAVEL PACK INTERVALS: From 11.5 ft. to 13.5 ft. From ft. to ft. From ft. to ft.

9 GROUT MATERIAL: Neat cement Cement grout Bentonite Other Concrete: 0-1' Grout intervals: From 1 ft. to 11.5 ft. From ft. to ft. From ft. to ft.

Nearest source of possible contamination: Septic Tank Lateral Lines Pit Privy Livestock Pens Insecticide Storage Sewer Lines Cess Pool Sewage Lagoon Fuel Storage Abandoned Water Well Watertight Sewer Lines Seepage Pit Feedyard Fertilizer Storage Oil Well / Gas Well Other (Specify) Direction from well? E Distance from well? ~45 ft

Table with columns: FROM, TO, LITHOLOGIC LOG, FROM, TO, LITHO. LOG (cont.) or PLUGGING INTERVALS. Rows: 0-1.5 Topsoil and gravel, 1.5-5 Shale and clay, 5-16 Sandy clay, 16-17 Sandy clay limestone stringers, 17-23.5 Weathered shaley clay

Notes: KDHE ID: Pony Express Service Center; U5-101-00360 Target of monitoring well is shallow groundwater, <20' of grout was installed at the direction of KDHE.

11 CONTRACTOR'S OR LANDOWNER'S CERTIFICATION: This water well was constructed, reconstructed, or plugged under my jurisdiction and was completed on (mo-day-year) 11/10/22 and this record is true to the best of my knowledge and belief. Kansas Water Well Contractor's License No 757 This Water Well Record was completed on (mo-day-year) 12/15/22 under the business name of Larsen & Associates, Inc. Signature

Washington

34-2-5E

RECEIVED

DENNIS L HANDKE

1820 NW 59th Terrace
TOPEKA, KANSAS 66618
785-286-4047 Home

JAN 03 2023

BUREAU OF WATER

Jess Chapman
Larsen & Assoc.
1311 E. 25th St., Suite B
Lawrence, Kansas, 66046

November 25, 2022

RE: Monitor Well Elevation Survey
US-36 Hwy & K-148 Hwy, Hanover, Kansas

Proj. 22-00MMM
Pony Express Service Center
KDHE ID U5-101-00360

Bench Mark: Square cut on the SW corner of concrete sidewalk at the SW corner of the building.
Elev: 1360.29 North 5024.66 West 4660.32 (from SE Cor. Sec. 34-2-5E)

MW-3	rim	1351.94	North	4951.00	SW1/4,NW1/4,NW1/4,NW1/4
	top pipe	1351.72	West	5125.95	Lat= 39.84093 Long = 96.86213
MW-4	rim	1359.52	North	4900.88	SW1/4,NE1/4,NW1/4,NW1/4
	top pipe	1359.26	West	4620.40	Lat= 39.84079 Long = 96.86036
MW-7	rim	1360.05	North	4558.04	NE1/4,SW1/4,NW1/4,NW1/4
	top pipe	1362.80	West	4724.48	Lat= 39.83985 Long = 96.86070
MW-10	rim	1359.87	North	4836.70	SE1/4,NW1/4,NW1/4,NW1/4
	top pipe	1362.57	West	4513.94	Lat= 39.84062 Long = 96.85995
MW-12R	rim	1358.57	North	5188.13	NE1/4,NW1/4,NW1/4,NW1/4
	top pipe	1358.05	West	4640.13	Lat= 39.84158 Long = 96.86040
MW-17	rim	1356.93	North	5069.93	NE1/4,NW1/4,NW1/4,NW1/4
	top pipe	1356.69	West	4731.68	Lat= 39.84126 Long = 96.86072
RW-1	rim	1352.21	North	5191.03	NE1/4,NE1/4,NW1/4,NW1/4
	top pipe	1355.11	West	4271.45	Lat= 39.84159 Long = 96.85908
RW-2	rim	1359.80	North	4972.52	NE1/4,NW1/4,NW1/4,NW1/4
	top pipe	1362.36	West	4670.98	Lat= 39.84099 Long = 96.86051
RW-3	rim	1366.61	North	4763.92	SE1/4,NW1/4,NW1/4,NW1/4
	top pipe	1369.46	West	4934.16	Lat= 39.84042 Long = 96.86144
RW-4	rim	1359.23	North	4835.97	SE1/4,NE1/4,NW1/4,NW1/4
	top pipe	1362.08	West	4503.90	Lat= 39.84062 Long = 96.85991
Park well	floor	1358.82	North	4909.46	SW1/4,NE1/4,NW1/4,NW1/4
			West	4469.04	Lat= 39.84082 Long = 96.85979

Lat & Long derived from Hanover SE 7.5' quad map. WGS84

Elevation established from USGS Station "Hanover". NAVD 88

If you have any questions, please feel free to call me. Thank you for the opportunity of service to you.

Dennis L Handke RLS



NOTE: Figures exhibited within this report are only to be used within the context of this report. Placement of property lines, wells, structures, and roads is based on the available information from county appraiser maps, surveys, site visits, and/or previous vendor reports and should be considered approximate.

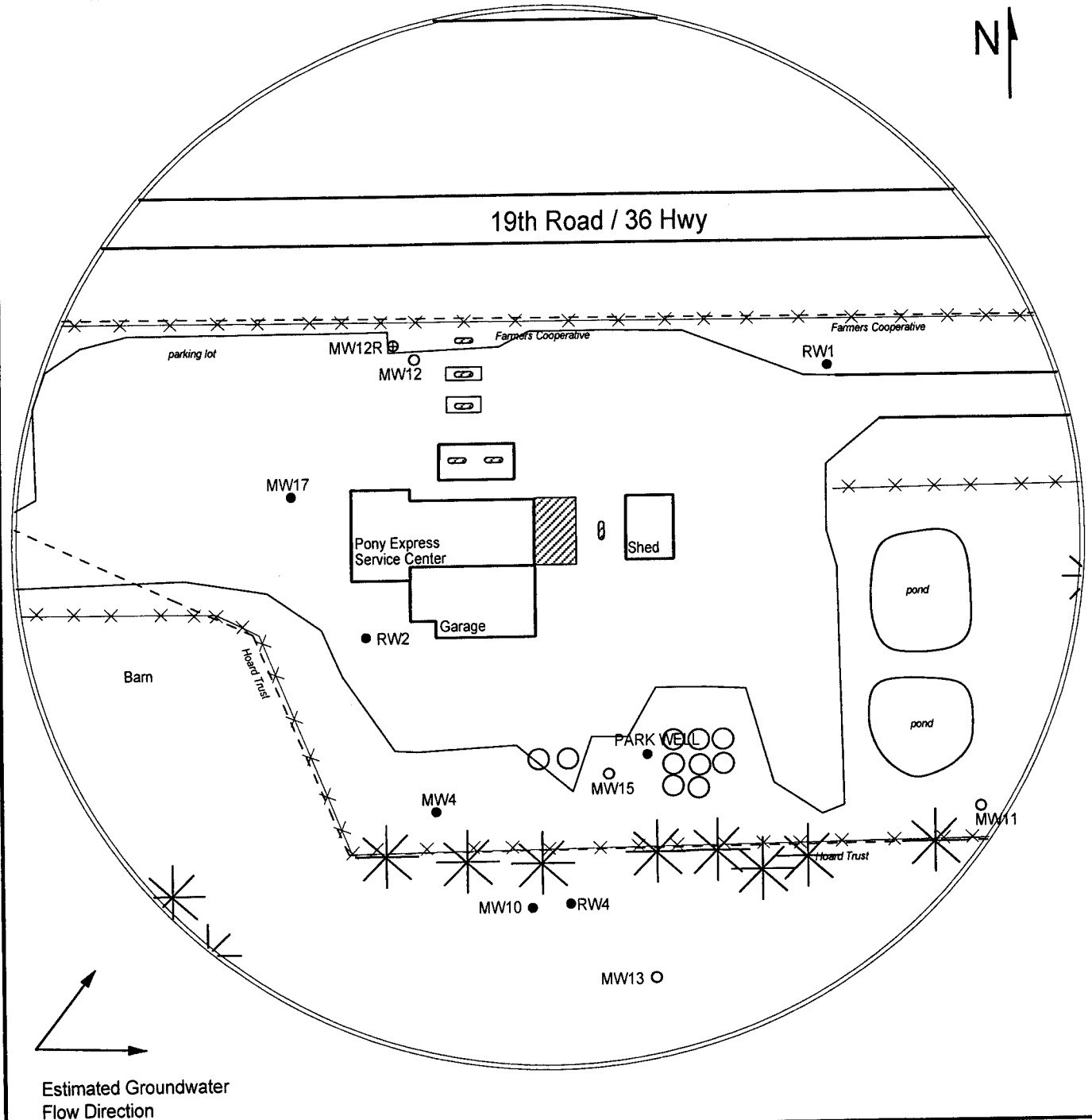

FIGURE 1 - 350 FT RADIUS AREA BASE MAP



PROJECT:
 Pony Express Service Center
 Hwy 36 & 148
 Hanover, KS
 KDHE ID: U5-101-00360
 Date: 11/10/22

LEGEND:

- Approximate Location of Former UST Basin & Pump Island
- Building with Basement
- Approximate Location of Property Line
- Existing Monitoring Well
- New Monitoring Well
- Plugged Monitoring Well

1311 E 25th St. Suite B 785-841-8707 office
 Lawrence, KS 66046 785-865-4282 fax

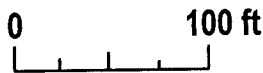

RECEIVED

RECEIVED

MAR 08 2023

JAN 03 2023