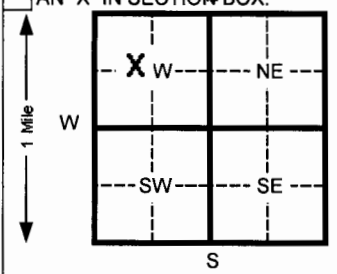

1 LOCATION OF WATER WELL: County: Wilson	Fraction SE ¼ NW ¼ NW ¼	Section Number 20	Township Number T 30 S	Range Number R 16 E/W
--	-----------------------------------	-----------------------------	----------------------------------	---------------------------------

Distance and direction from nearest town or city street address of well if located within city? **SAW-6**
The well is located approximately 40 feet east of N. 9th St. within the alley between Carolina and Grant Streets in Neodesha.
Latitude N37° 25.508' Longitude W95° 41.086'

2 WATER WELL OWNER: **BP Amoco Oil Co.**
 RR#, St. Address, Box # : **1100 North 12th Street**
 City, State, ZIP Code : **Neodesha, Kansas 66757**
 Board of Agriculture, Division of Water Resources
 Application Number: **Not Applicable**

3 LOCATE WELL'S LOCATION WITH AN "X" IN SECTION BOX: 	4 DEPTH OF COMPLETED WELL 23.5 ft. ELEVATION: _____
	Depth(s) Groundwater Encountered 1 19 ft. 2 _____ ft. 3 _____ ft. WELL'S STATIC WATER LEVEL Unk. ft. below land surface measured on mo/day/yr _____ Pump test data: Well water was _____ ft. after _____ hours pumping _____ gpm Est. Yield _____ gpm: Well water was _____ ft. after _____ hours pumping _____ gpm Bore Hole Diameter 14.75 in. to 24 ft. and _____ in. to _____ ft. WELL WATER TO BE USED AS: 5 Public water supply 8 Air conditioning 11 Injection well 1 Domestic 3 Feed lot 6 Oil field water supply 9 Dewatering 12 Other (Specify below) 2 Irrigation 4 Industrial 7 Lawn and garden (domestic) 10 Monitoring well Was a chemical/bacteriological sample submitted to Department? Yes _____ No X If yes, mo/day/yr sample was submitted _____ Water Well Disinfected? Yes _____ No _____

5 TYPE OF BLANK CASING USED:
 1 Steel 3 RMP (SR) 5 Wrought Iron 8 Concrete tile CASING JOINTS: Glued _____ Clamped _____
2 PVC 4 ABS 6 Asbestos-Cement 9 Other (specify below) _____ Welded _____
 7 Fiberglass _____ **Threaded** _____

Blank casing diameter **4** in. to **9.5** ft., Dia _____ in. to _____ ft., Dia _____ in. to _____ ft.
 Casing height above land surface **0** in., weight **N/A** lbs./ft. Wall thickness or gauge No. **0.2370**

TYPE OF SCREEN OR PERFORATION MATERIAL:
 1 Steel 3 Stainless steel 5 Fiberglass **7** PVC 10 Asbestos-cement
 2 Brass 4 Galvanized steel 6 Concrete tile 8 RMP (SR) 11 Other (specify) _____
 12 None used (open hole)

SCREEN OR PERFORATION OPENINGS ARE:
 5 Gauzed wrapped 8 Saw cut 11 None (open hole)
 1 Continuous slot 3 Mill slot **6** Wire wrapped 9 Drilled holes
 2 Louvered shutter 4 Key punched 7 Torch cut 10 Other (specify) _____

SCREEN-PERFORATED INTERVALS: From **9.5** ft. to **23.5** ft. From _____ ft. to _____ ft.
 From _____ ft. to _____ ft. From _____ ft. to _____ ft.
 GRAVEL PACK INTERVALS: From **7.5** ft. to **24** ft. From _____ ft. to _____ ft.
 From _____ ft. to _____ ft. From _____ ft. to _____ ft.

6 GROUT MATERIAL: 1 Neat cement 2 Cement grout **3 Bentonite** 4 Other _____
 Grout Intervals From **2.5** ft. to **7.5** ft. From _____ ft. to _____ ft. From _____ ft. to _____ ft.
 What is the nearest source of possible contamination:
 1 Septic tank 4 Lateral lines 7 Pit privy **11** Fuel storage 14 Abandoned water well
 2 Sewer lines 5 Cess pool 8 Sewage lagoon 12 Fertilizer storage 15 Oil well/ Gas well
 3 Watertight sewer lines 6 Seepage pit 9 Feedyard 13 Insecticide storage 16 Other (specify below) _____

Direction from well? **Northwest** How many feet? **1,600**

FROM	TO	CODE	LITHOLOGIC LOG	FROM	TO	PLUGGING INTERVALS
0	1	02	Black, gravel and silt fill			
1	9	03	Tan, sandy, silty clay			
9	19	05	Tan to gray, clayey, fine grained sand			
19	24	11	Gray, clayey, sandy gravel, poorly sorted			
	24	28	Bedrock			

7 CONTRACTOR'S OR LANDOWNER'S CERTIFICATION: This water well was (1) constructed, (2) reconstructed, or (3) plugged under my jurisdiction and was completed on (mo/day/yr) **9/9/04** and this record is true to the best of my knowledge and belief. Kansas Water Well Contractor's License No. **616** This Water Well Record was completed on (mo/day/yr) **11/4/04** under the business name of **Thiele Geotech, Inc.** by (signature) *D. J. ...*

INSTRUCTIONS: Please fill in blanks and circle the correct answers. Send three copies to Kansas Department of Health and Environment, Bureau of Water, Topeka, Kansas 66620-0001. Telephone: 913-296-5545. Send one to WATER WELL OWNER and retain one for your records.

OFFICE USE ONLY

T

R

SEC

RECEIVED
NOV 08 2004

BUREAU OF WATER

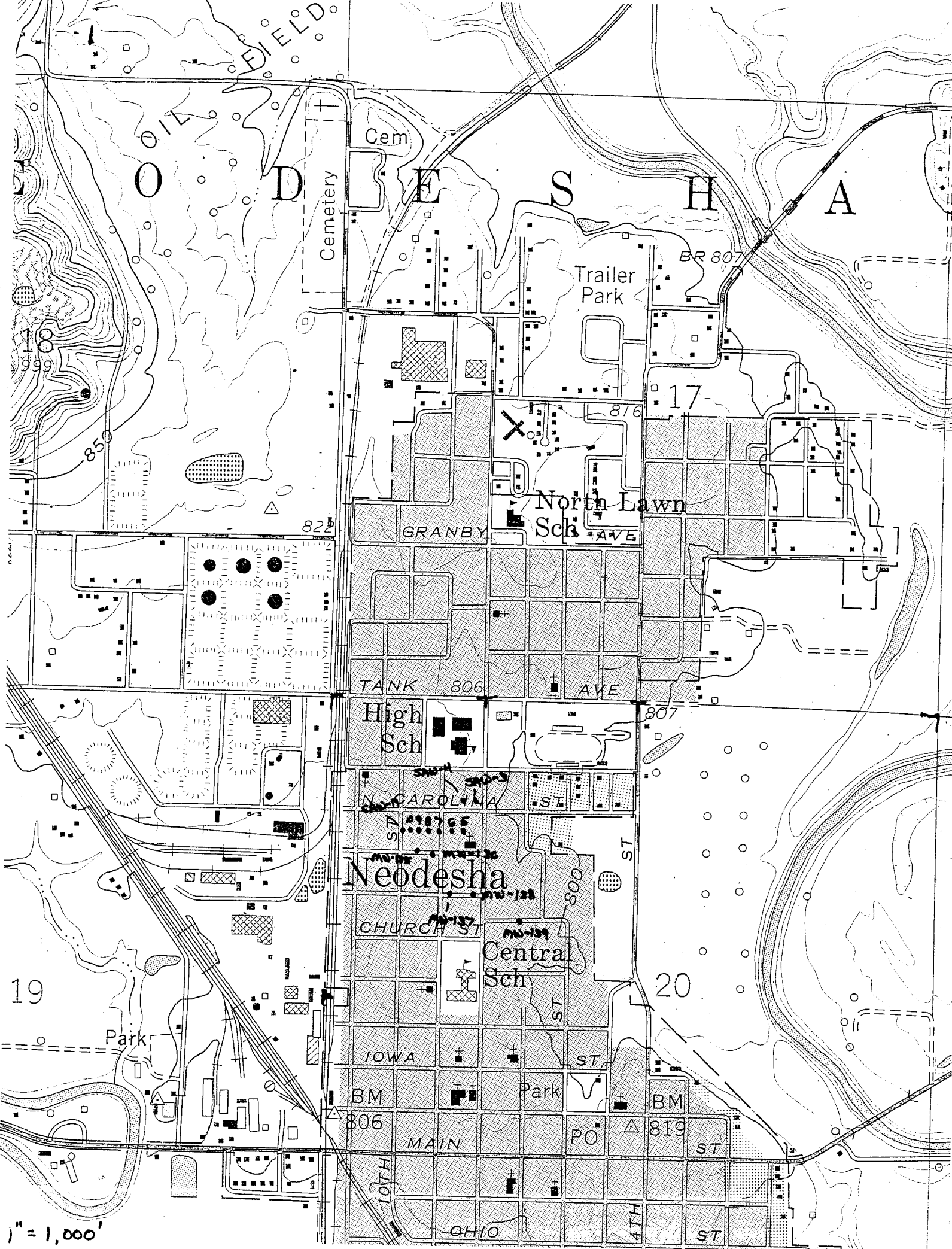

OIL FIELD
Cem
Cemetery
E S H A

Trailer Park
BR 807

North Lawn Sch
816

GRANBY AVE

TANK AVE
806

High Sch

N. CAROLINA ST

Neodesha

CHURCH ST

Central Sch

Park

IOWA ST

BM 806

Park

BM 819

MAIN ST

PO

OHIO ST

4TH ST

ST

1" = 1,000'