

1 LOCATION OF WATER WELL: County: Wilson	Fraction SE ¼ NW ¼ NW ¼	Section Number 20	Township Number T 30 S	Range Number R 16 E/W
--	-----------------------------------	-----------------------------	----------------------------------	---------------------------------

Distance and direction from nearest town or city street address of well if located within city? **SAW-7**
The well is located approximately 25 feet west of N. 9th St. within the alley between Carolina and Grant Streets in Neodesha.
Latitude N37° 25.516' Longitude W95° 41.114'

2 WATER WELL OWNER: BP Amoco Oil Co. RR#, St. Address, Box # : 1100 North 12th Street City, State, ZIP Code : Neodesha, Kansas 66757	Board of Agriculture, Division of Water Resources Application Number: Not Applicable
--	--

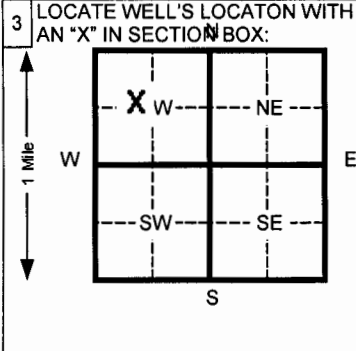

4 DEPTH OF COMPLETED WELL **28** ft. ELEVATION: _____

Depth(s) Groundwater Encountered 1 **20** ft. 2 _____ ft. 3 _____ ft.

WELL'S STATIC WATER LEVEL **Unk.** ft. below land surface measured on mo/day/yr _____

Pump test data: Well water was _____ ft. after _____ hours pumping _____ gpm

Est. Yield _____ gpm: Well water was _____ ft. after _____ hours pumping _____ gpm

Bore Hole Diameter **14.75** in. to **28** ft. and _____ in. to _____ ft.

WELL WATER TO BE USED AS: 5 Public water supply 8 Air conditioning 11 Injection well
 1 Domestic 3 Feed lot 6 Oil field water supply 9 Dewatering 12 Other (Specify below)
 2 Irrigation 4 Industrial 7 Lawn and garden (domestic) **10** Monitoring well

Was a chemical/bacteriological sample submitted to Department? Yes _____ No **X** If yes, mo/day/yr sample was submitted _____

Water Well Disinfected? Yes _____ No _____

5 TYPE OF BLANK CASING USED:

1 Steel	3 RMP (SR)	5 Wrought Iron	8 Concrete tile	CASING JOINTS: Glued _____ Clamped _____
2 PVC	4 ABS	6 Asbestos-Cement	9 Other (specify below)	Welded _____
		7 Fiberglass		Threaded

Blank casing diameter **4** in. to **14** ft., Dia _____ in. to _____ ft., Dia _____ in. to _____ ft.

Casing height above land surface **0** in., weight **N/A** lbs./ft. Wall thickness or gauge No. **0.2370**

TYPE OF SCREEN OR PERFORATION MATERIAL:

1 Steel	3 Stainless steel	5 Fiberglass	8 RMP (SR)	10 Asbestos-cement
2 Brass	4 Galvanized steel	6 Concrete tile	9 ABS	11 Other (specify)
				12 None used (open hole)

SCREEN OR PERFORATION OPENINGS ARE:

1 Continuous slot	3 Mill slot	5 Gauzed wrapped	8 Saw cut	11 None (open hole)
2 Louvered shutter	4 Key punched	6 Wire wrapped	9 Drilled holes	
		7 Torch cut	10 Other (specify)	

SCREEN-PERFORATED INTERVALS: From **14** ft. to **28** ft. From _____ ft. to _____ ft.

GRAVEL PACK INTERVALS: From **12** ft. to **28** ft. From _____ ft. to _____ ft.

6 GROUT MATERIAL: 1 Neat cement 2 Cement grout **3 Bentonite** 4 Other _____

Grout Intervals From **2.5** ft. to **12** ft. From _____ ft. to _____ ft. From _____ ft. to _____ ft.

What is the nearest source of possible contamination:

1 Septic tank	4 Lateral lines	7 Pit privy	11 Fuel storage	14 Abandoned water well
2 Sewer lines	5 Cess pool	8 Sewage lagoon	12 Fertilizer storage	15 Oil well/ Gas well
3 Watertight sewer lines	6 Seepage pit	9 Feedyard	13 Insecticide storage	16 Other (specify below)

Direction from well? **Northwest** How many feet? **1,500**

FROM	TO	CODE	LITHOLOGIC LOG	FROM	TO	PLUGGING INTERVALS
0	1.5	02	Black, clay and silt fill			
1.5	10	03	Tan to gray, sandy, silty clay			
10	19	05	Tan to gray, clayey, fine grained sand			
19	28	11	Tan, clayey, sandy gravel, poorly sorted			
	28	28	Bedrock			

7 CONTRACTOR'S OR LANDOWNER'S CERTIFICATION: This water well was **(1) constructed**, (2) reconstructed, or (3) plugged under my jurisdiction and was completed on (mo/day/yr) **9/7/04** and this record is true to the best of my knowledge and belief. Kansas Water Well Contractor's License No. **616** This Water Well Record was completed on (mo/day/yr) **11/4/04** under the business name of **Thiele Geotech, Inc.** by (signature) *D. J. Al...*

INSTRUCTIONS: Please fill in blanks and circle the correct answers. Send three copies to Kansas Department of Health and Environment Bureau of Water, Topeka, Kansas 66620-0001. Telephone: 913-296-5545. Send one to WATER WELL OWNER and retain one for your records.

OFFICE USE ONLY

T
R

SEC

RECEIVED
NOV 08 2004

BUREAU OF WATER

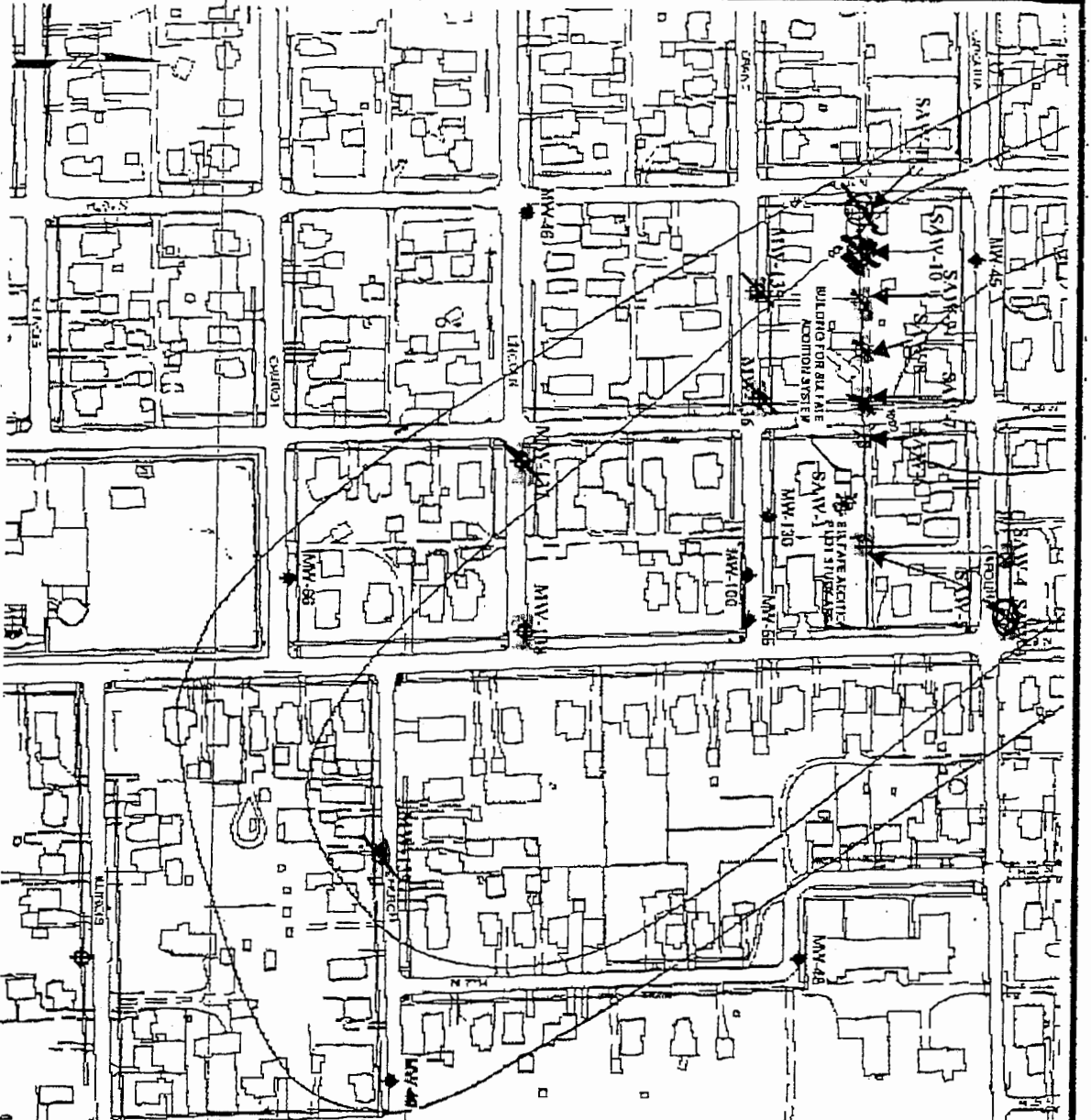

Sulfate Addition Prototype Design Memo

BP Products North America Inc., Neodesha, KS 67501-1699-5089

DATE 08/03/04 DRAWN: E.S.S.

SULFATE ADDITION PROTOTYPE LAYOUT

LEGEND

- MW-68
- ◆ EXISTING MONITORING WELL
- ◊ PROPOSED MONITORING WELL
- ◊ PROPOSED ADDITION WELL
- ◊ ALTERNATIVE ADDITIONAL WELL
- ◊ EXISTING ADDITION WELL
- 50 — BENZENE CONCENTRATION CONTOUR (ug/l)

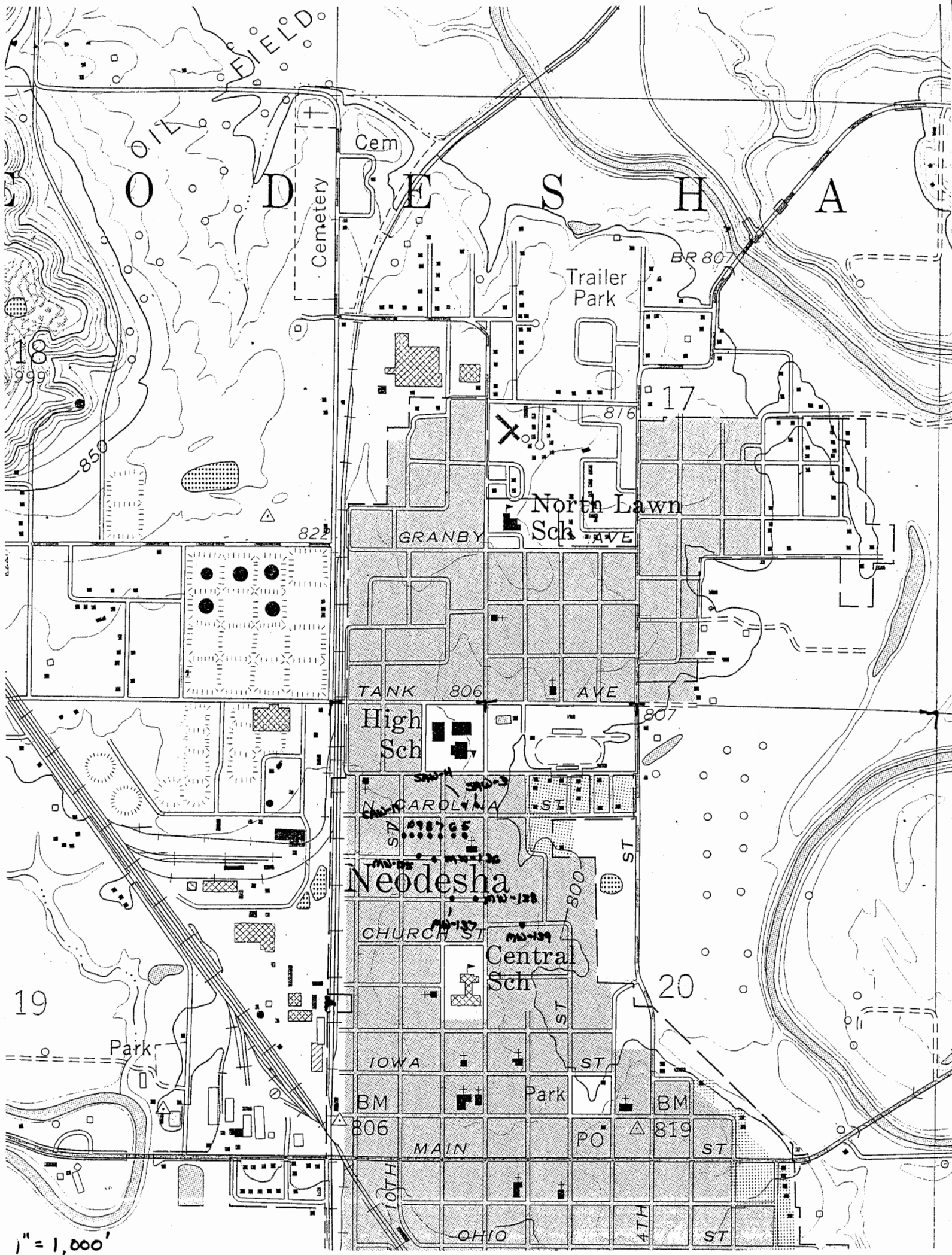

OIL FIELD
D E S H A

Cemetery

Cem

Trailer Park

BR 807

17

816

North Lawn Sch

GRANBY AVE

822

TANK AVE

806

AVE

High Sch

807

N. CAROLINA ST

Neodesha

CHURCH ST

Central Sch

20

19

Park

IOWA ST

ST

BM

Park

BM

806

PO

819

MAIN ST

ST

ST

OHIO ST

4TH ST

ST

1" = 1,000'