

1 LOCATION OF WATER WELL:	Fraction SE ¼ NW ¼ NW ¼	Section Number 20	Township Number T 30 S	Range Number R 16 <input type="checkbox"/> EW
County: Wilson				
Distance and direction from nearest town or city street address of well if located within city? SAW-10 The well is located approximately 65 feet east of N. 10th St. within the alley between Carolina and Grant Streets in Neodesha. Latitude N37° 25.515' Longitude W95° 41.156'				
2 WATER WELL OWNER: BP Amoco Oil Co.				
RR#, St. Address, Box # : 1100 North 12th Street			Board of Agriculture, Division of Water Resources	
City, State, ZIP Code : Neodesha, Kansas 66757			Application Number: Not Applicable	
3 LOCATE WELL'S LOCATION WITH AN "X" IN SECTION BOX:		4 DEPTH OF COMPLETED WELL 26.5 ft. ELEVATION: _____		
		Depth(s) Groundwater Encountered 1 20 ft. 2 _____ ft. 3 _____ ft.		
		WELL'S STATIC WATER LEVEL Unk. ft. below land surface measured on mo/day/yr		
		Pump test data: Well water was _____ ft. after _____ hours pumping _____ gpm		
		Est. Yield _____ gpm: Well water was _____ ft. after _____ hours pumping _____ gpm		
		Bore Hole Diameter 14.75 in. to 27 ft. and _____ in. to _____ ft.		
		WELL WATER TO BE USED AS: 5 Public water supply 8 Air conditioning 11 Injection well		
		1 Domestic 3 Feed lot 6 Oil field water supply 9 Dewatering 12 Other (Specify below)		
		2 Irrigation 4 Industrial 7 Lawn and garden (domestic) <input checked="" type="checkbox"/> 10 Monitoring well		
		Was a chemical/bacteriological sample submitted to Department? Yes _____ No <input checked="" type="checkbox"/> If yes, mo/day/yr sample was submitted _____		
		Water Well Disinfected? Yes _____ No _____		
5 TYPE OF BLANK CASING USED:				
1 Steel		3 RMP (SR)		5 Wrought Iron
<input checked="" type="checkbox"/> 2 PVC		4 ABS		8 Concrete tile
		7 Fiberglass		CASING JOINTS: Glued _____ Clamped _____
				6 Asbestos-Cement 9 Other (specify below) _____
Blank casing diameter 4 in. to 11.5 ft., Dia _____ in. to _____ ft., Dia _____ in. to _____ ft.		Welded _____		
Casing height above land surface 0 in., weight N/A lbs./ft. Wall thickness or gauge No. 0.2370		<input checked="" type="checkbox"/> Threaded		
TYPE OF SCREEN OR PERFORATION MATERIAL:				
1 Steel		3 Stainless steel		5 Fiberglass
<input checked="" type="checkbox"/> 7 PVC		4 Galvanized steel		8 RMP (SR)
		6 Concrete tile		11 Other (specify) _____
		9 ABS		12 None used (open hole)
SCREEN OR PERFORATION OPENINGS ARE:				
1 Continuous slot		3 Mill slot		5 Gauzed wrapped
2 Louvered shutter		4 Key punched		<input checked="" type="checkbox"/> 6 Wire wrapped
				8 Saw cut
				9 Drilled holes
				10 Other (specify) _____
SCREEN-PERFORATED INTERVALS: From 11.5 ft. to 26.5 ft. From _____ ft. to _____ ft. From _____ ft. to _____ ft.				
GRAVEL PACK INTERVALS: From 9.5 ft. to 27 ft. From _____ ft. to _____ ft. From _____ ft. to _____ ft.				
6 GROUT MATERIAL: 1 Neat cement 2 Cement grout <input checked="" type="checkbox"/> 3 Bentonite 4 Other _____				
Grout Intervals From 2.5 ft. to 9.5 ft. From _____ ft. to _____ ft. From _____ ft. to _____ ft.				
What is the nearest source of possible contamination:				
1 Septic tank		4 Lateral lines		7 Pit privy
2 Sewer lines		5 Cess pool		<input checked="" type="checkbox"/> 11 Fuel storage
3 Watertight sewer lines		6 Seepage pit		10 Livestock pens
				12 Fertilizer storage
				13 Insecticide storage
				14 Abandoned water well
				15 Oil well/ Gas well
				16 Other (specify below) _____
Direction from well? Northwest				How many feet? 1,300
FROM	TO	CODE	LITHOLOGIC LOG	FROM TO PLUGGING INTERVALS
0	1	02	Black, clay and silt fill	
1	12	03	Tan, sandy, silty clay	
12	20	05	Tan to olive, clayey, fine grained sand	
20	27	11	Gray, clayey, sandy gravel, poorly sorted	
	27	28	Bedrock	
7 CONTRACTOR'S OR LANDOWNER'S CERTIFICATION: This water well was (1) constructed, (2) reconstructed, or (3) plugged under my jurisdiction and was completed on (mo/day/yr) 9/1/04 and this record is true to the best of my knowledge and belief. Kansas Water Well Contractor's License No. 616 This Water Well Record was completed on (mo/day/yr) 11/4/04 under the business name of Thiele Geotech, Inc. by (signature) <i>D. J. [Signature]</i>				
INSTRUCTIONS: Please fill in blanks and circle the correct answers. Send three copies to Kansas Department of Health and Environment, Bureau of Water, Topeka, Kansas 66620-0001. Telephone: 913-296-5545. Send one to WATER WELL OWNER and retain one for your records.				

OFFICE USE ONLY

T
R

SEC

RECEIVED
NOV 08 2004

BUREAU OF WATER

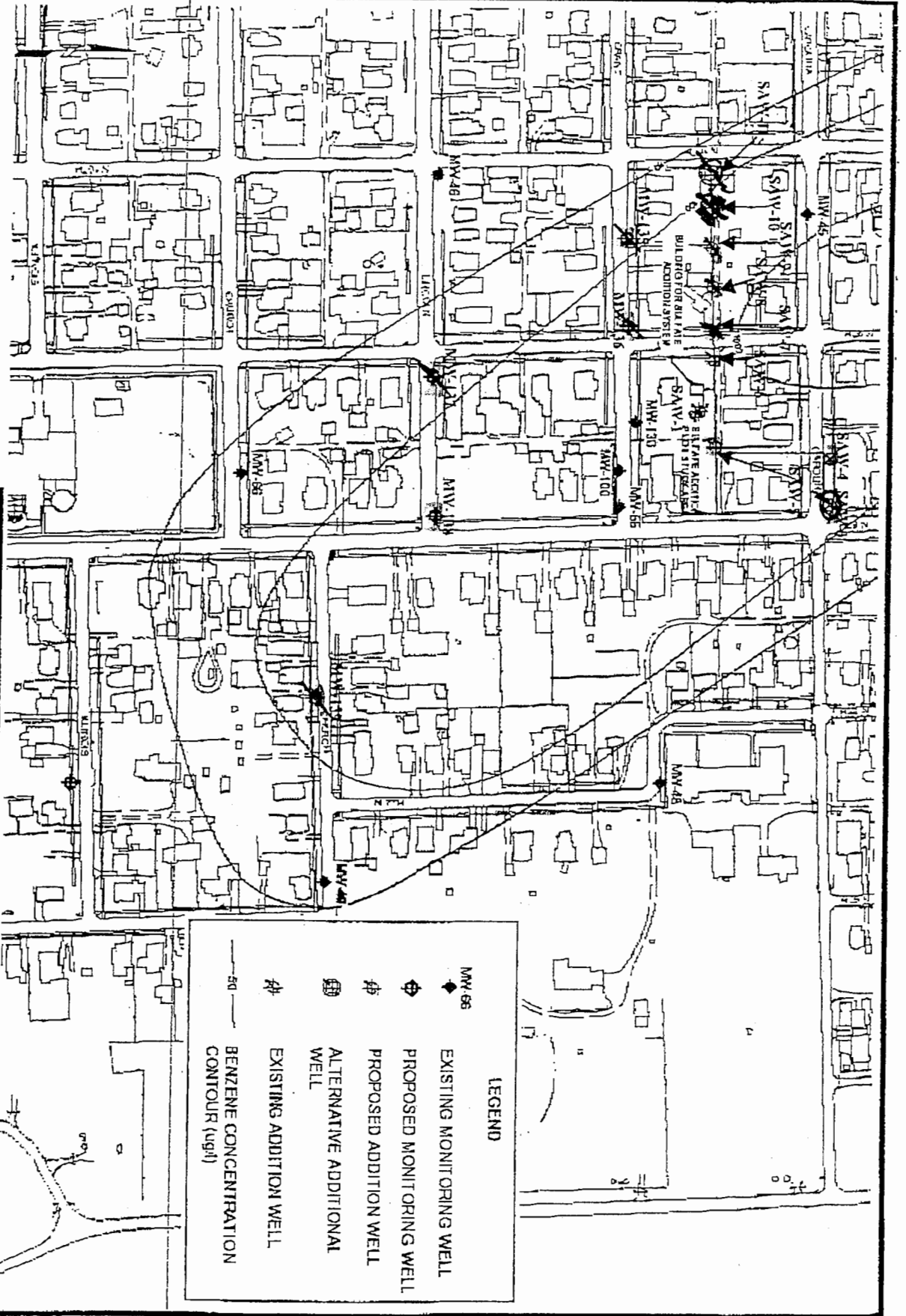
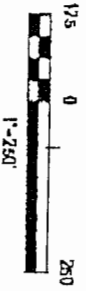

Sulfate Addition Prototype Design Memo
 DP Products North America Inc., Neeshoba, KS (AHS01-19978-509)
 DATE: 09/03/04 DRAWN: E.S.S.

SULFATE ADDITION PROTOTYPE LAYOUT
 ATTACHMENT 2

Send To Printer Back To TerraServer Change to 11x17 Print Size Show Grid Lines Change to Landscape

USGS 2 km N of Neodesha, Kansas, United States 07 Oct 1991



0 ————— 100M

0 ————— 100yd

Image courtesy of the U.S. Geological Survey

© 2004 Microsoft Corporation. **Terms of Use** **Privacy Statement**

NEODESHA

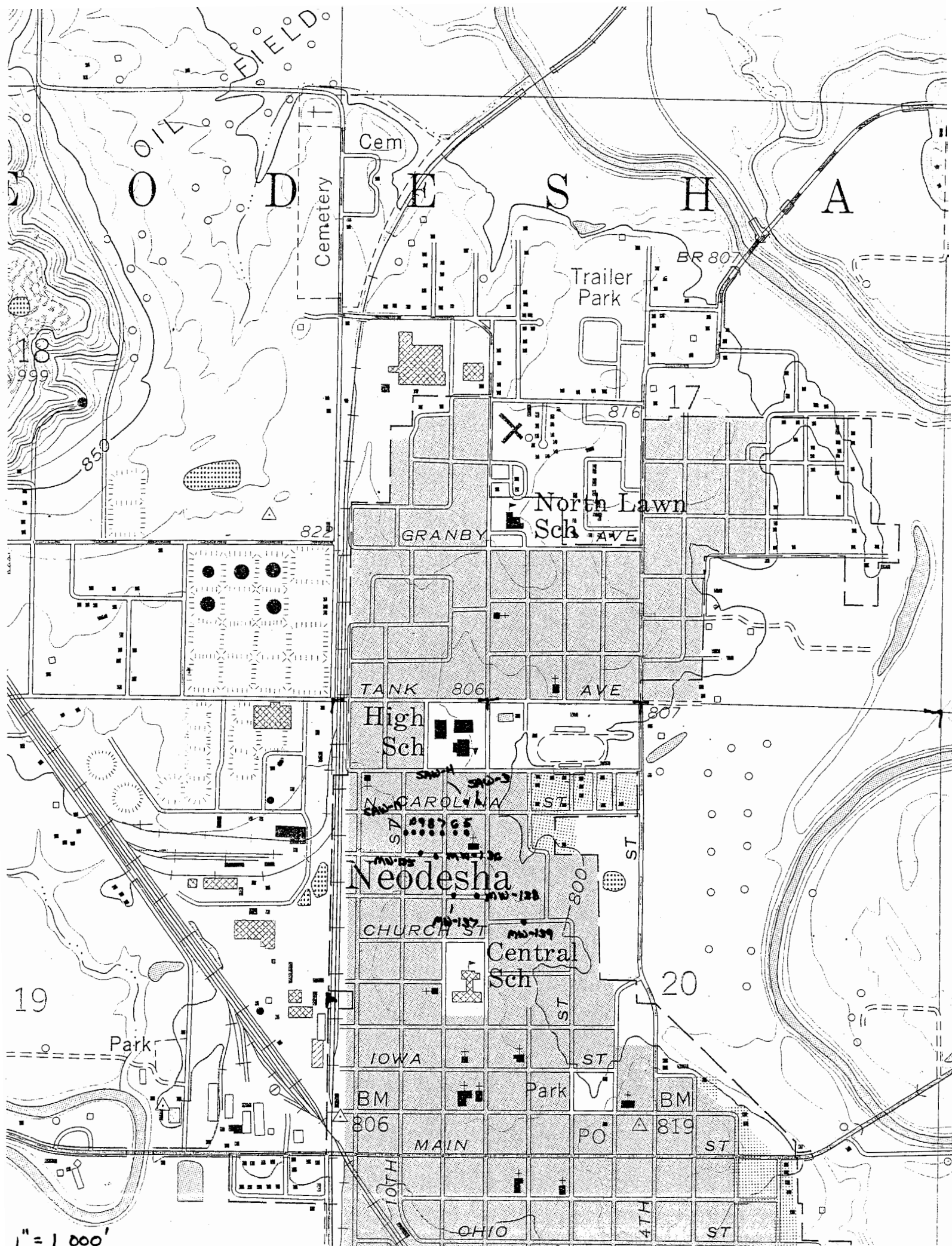

1" = 1,000'