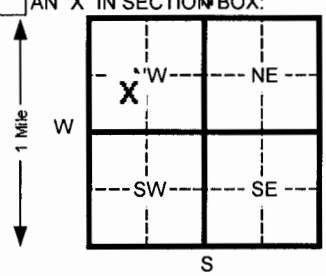

1 LOCATION OF WATER WELL: Fraction **NE 1/4 SW 1/4 NW 1/4** Section Number **20** Township Number **T 30 S** Range Number **R 16 E/W**
 County: **Wilson**

Distance and direction from nearest town or city street address of well if located within city? **MW-136**
The well is located approximately 75 feet west of the intersection of N. 9th St. and Grant St. within Grant St. in Neodesha.
Latitude N37° 25.483' Longitude W95° 41.113'

2 WATER WELL OWNER: **BP Amoco Oil Co.**
 RR#, St. Address, Box # : **1100 North 12th Street** Board of Agriculture, Division of Water Resources
 City, State, ZIP Code : **Neodesha, Kansas 66757** Application Number: **Not Applicable**

3 LOCATE WELL'S LOCATION WITH AN "X" IN SECTION BOX:

4 DEPTH OF COMPLETED WELL **24.5** ft. ELEVATION: _____
 Depth(s) Groundwater Encountered 1 **20** ft. 2 _____ ft. 3 _____ ft.
 WELL'S STATIC WATER LEVEL **Unk.** ft. below land surface measured on mo/day/yr _____
 Pump test data: Well water was _____ ft. after _____ hours pumping _____ gpm
 Est. Yield _____ gpm: Well water was _____ ft. after _____ hours pumping _____ gpm
 Bore Hole Diameter **8** in. to **25** ft. and _____ in. to _____ ft.
 WELL WATER TO BE USED AS: 5 Public water supply 8 Air conditioning 11 Injection well
 1 Domestic 3 Feed lot 6 Oil field water supply 9 Dewatering 12 Other (Specify below)
 2 Irrigation 4 Industrial 7 Lawn and garden (domestic) **10** Monitoring well
 Was a chemical/bacteriological sample submitted to Department? Yes _____ No **X** If yes, mo/day/yr sample was submitted _____
 Water Well Disinfected? Yes _____ No _____

5 TYPE OF BLANK CASING USED: 5 Wrought Iron 8 Concrete tile CASING JOINTS: Glued _____ Clamped _____
 1 Steel 3 RMP (SR) 6 Asbestos-Cement 9 Other (specify below) Welded _____
2 PVC 4 ABS 7 Fiberglass **Threaded**
 Blank casing diameter **2** in. to **14.5** ft., Dia _____ in. to _____ ft., Dia _____ in. to _____ ft.
 Casing height above land surface **0** in., weight **N/A** lbs./ft. Wall thickness or gauge No. **0.1875**
 TYPE OF SCREEN OR PERFORATION MATERIAL: **7** PVC 10 Asbestos-cement
 1 Steel 3 Stainless steel 5 Fiberglass 8 RMP (SR) 11 Other (specify) _____
 2 Brass 4 Galvanized steel 6 Concrete tile 9 ABS 12 None used (open hole)
 SCREEN OR PERFORATION OPENINGS ARE: 5 Gauzed wrapped 8 Saw cut 11 None (open hole)
 1 Continuous slot **3** Mill slot 6 Wire wrapped 9 Drilled holes
 2 Louvered shutter 4 Key punched 7 Torch cut 10 Other (specify) _____
 SCREEN-PERFORATED INTERVALS: From **14.5** ft. to **24.5** ft. From _____ ft. to _____ ft.
 From _____ ft. to _____ ft. From _____ ft. to _____ ft.
 GRAVEL PACK INTERVALS: From **12.5** ft. to **25** ft. From _____ ft. to _____ ft.
 From _____ ft. to _____ ft. From _____ ft. to _____ ft.

6 GROUT MATERIAL: 1 Neat cement 2 Cement grout **3 Bentonite** 4 Other _____
 Grout Intervals From **1** ft. to **12.5** ft. From _____ ft. to _____ ft. From _____ ft. to _____ ft.
 What is the nearest source of possible contamination: 10 Livestock pens 14 Abandoned water well
 1 Septic tank 4 Lateral lines 7 Pit privy **11** Fuel storage 15 Oil well/ Gas well
 2 Sewer lines 5 Cess pool 8 Sewage lagoon 12 Fertilizer storage 16 Other (specify below)
 3 Watertight sewer lines 6 Seepage pit 9 Feedyard 13 Insecticide storage
 Direction from well? **Northwest** How many feet? **1,600**

FROM	TO	CODE	LITHOLOGIC LOG	FROM	TO	PLUGGING INTERVALS
0	1.5		Brick, asphalt, gravel			
1.5	15	03	Tan to gray, silty clay			
15	18	02	Light gray to tan, clayey sand, fine grained			
18	25	11	Tan to gray, clayey, sandy gravel, poorly sorted			
	25	28	Bedrock			

7 CONTRACTOR'S OR LANDOWNER'S CERTIFICATION: This water well was **(1)** constructed, (2) reconstructed, or (3) plugged under my jurisdiction and was completed on (mo/day/yr) **8/30/04** and this record is true to the best of my knowledge and belief. Kansas
 Water Well Contractor's License No. **616** This Water Well Record was completed on (mo/day/yr) **11/4/04**
 under the business name of **Thiele Geotech, Inc.** by (signature) *[Signature]*

INSTRUCTIONS: Please fill in blanks and circle the correct answers. Send three copies to Kansas Department of Health and Environment, Bureau of Water, Topeka, Kansas 66620-0001. Telephone: 913-296-5545. Send one to WATER WELL OWNER and retain one for your records.

OFFICE USE ONLY

T

R

SEC

RECEIVED

NOV 0 8 2004

BUREAU OF WATER

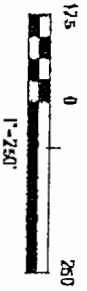

Sulfate Addition Prototype Design Memo
 BP Products North America Inc., Neodesha, KS (AM051-18979-506)
 DATE: 09/03/04 DRAWN: ES.S.

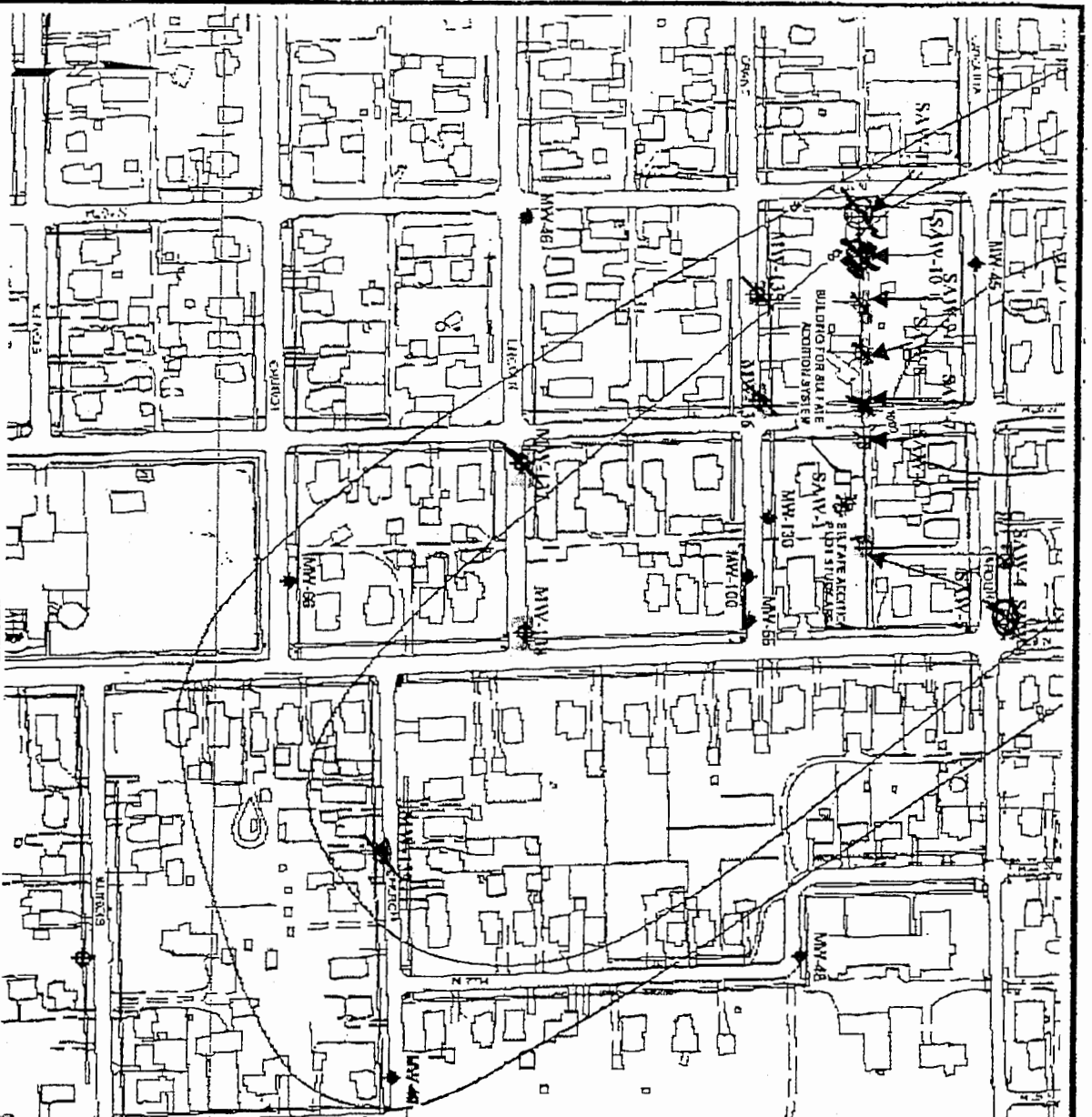

LEGEND

- MW 66
- ◆ EXISTING MONITORING WELL
- ⊕ PROPOSED MONITORING WELL
- ⊕ PROPOSED ADDITION WELL
- ⊕ ALTERNATIVE ADDITIONAL WELL
- ⊕ EXISTING ADDITION WELL
- 50 — BENZENE CONCENTRATION CONTOUR (ug/l)

SULFATE ADDITION PROTOTYPE LAYOUT
 ATTACHMENT 2

[Send To Printer](#)

[Back To TerraServer](#)

[Change to 11x17 Print Size](#)

[Show Grid Lines](#)

[Change to Landscape](#)

USGS 2 km N of Neodesha, Kansas, United States 07 Oct 1991



0 100M

0 100yd

Image courtesy of the U.S. Geological Survey

© 2004 Microsoft Corporation. **Terms of Use** **Privacy Statement**

NEODESHA

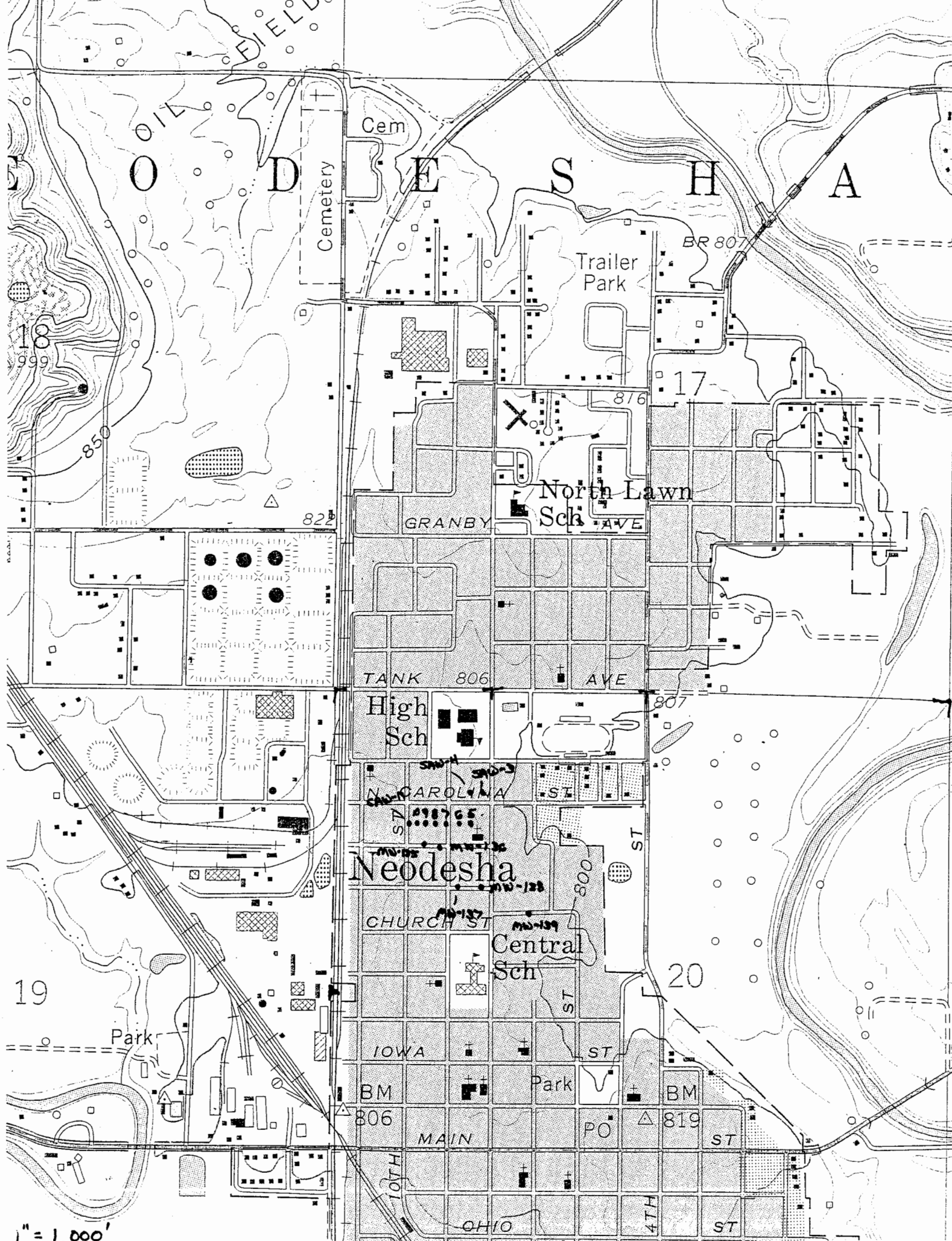

1" = 1,000'