

1 LOCATION OF WATER WELL:		Fraction		Section Number		Township Number		Range Number	
County: Wilson		NE ¼ SW ¼ NW ¼		20		T 30 S		R 16 <input type="checkbox"/> EW	
Distance and direction from nearest town or city street address of well if located within city? MW-137 The well is located approximately 250 feet west of the intersection of N. 8th St. and Lincoln St. within Lincoln St. in Neodesha. Latitude N37° 25.425' Longitude W95° 41.078'									
2 WATER WELL OWNER: BP Amoco Oil Co. RR#, St. Address, Box # : 1100 North 12th Street Board of Agriculture, Division of Water Resources City, State, ZIP Code : Neodesha, Kansas 66757 Application Number: Not Applicable									
3 LOCATE WELL'S LOCATION WITH AN "X" IN SECTION BOX:			4 DEPTH OF COMPLETED WELL 24.5 ft. ELEVATION:						
			Depth(s) Groundwater Encountered 1 20 ft. 2 _____ ft. 3 _____ ft. WELL'S STATIC WATER LEVEL Unk. ft. below land surface measured on mo/day/yr Pump test data: Well water was _____ ft. after _____ hours pumping _____ gpm Est. Yield _____ gpm: Well water was _____ ft. after _____ hours pumping _____ gpm Bore Hole Diameter 8 in. to 26 ft. and _____ in. to _____ ft. WELL WATER TO BE USED AS: 5 Public water supply 8 Air conditioning 11 Injection well 1 Domestic 3 Feed lot 6 Oil field water supply 9 Dewatering 12 Other (Specify below) 2 Irrigation 4 Industrial 7 Lawn and garden (domestic) <input checked="" type="checkbox"/> 10 Monitoring well Was a chemical/bacteriological sample submitted to Department? Yes _____ No <input checked="" type="checkbox"/> If yes, mo/day/yr sample was submitted _____ Water Well Disinfected? Yes _____ No _____						
			5 TYPE OF BLANK CASING USED:						
			1 Steel 3 RMP (SR) 5 Wrought Iron 8 Concrete tile CASING JOINTS: Glued _____ Clamped _____ 2 <input checked="" type="checkbox"/> PVC 4 ABS 6 Asbestos-Cement 9 Other (specify below) Welded _____ 7 Fiberglass _____ Threaded <input checked="" type="checkbox"/> Blank casing diameter 2 in. to 14.5 ft., Dia _____ in. to _____ ft., Dia _____ in. to _____ ft. Casing height above land surface 0 in., weight N/A lbs./ft. Wall thickness or gauge No. 0.1875 TYPE OF SCREEN OR PERFORATION MATERIAL: <input checked="" type="checkbox"/> 7 PVC 10 Asbestos-cement 1 Steel 3 Stainless steel 5 Fiberglass 8 RMP (SR) 11 Other (specify) _____ 2 Brass 4 Galvanized steel 6 Concrete tile 9 ABS 12 None used (open hole) SCREEN OR PERFORATION OPENINGS ARE: 1 Continuous slot <input checked="" type="checkbox"/> 3 Mill slot 5 Gauzed wrapped 8 Saw cut 11 None (open hole) 2 Louvered shutter 4 Key punched 6 Wire wrapped 9 Drilled holes 7 Torch cut 10 Other (specify) _____ SCREEN-PERFORATED INTERVALS: From 14.5 ft. to 24.5 ft. From _____ ft. to _____ ft. From _____ ft. to _____ ft. From _____ ft. to _____ ft. GRAVEL PACK INTERVALS: From 12.5 ft. to 26 ft. From _____ ft. to _____ ft. From _____ ft. to _____ ft. From _____ ft. to _____ ft.						
			6 GROUT MATERIAL: 1 Neat cement 2 Cement grout <input checked="" type="checkbox"/> 3 Bentonite 4 Other _____						
Grout Intervals From 1 ft. to 12.5 ft. From _____ ft. to _____ ft. From _____ ft. to _____ ft. What is the nearest source of possible contamination: 1 Septic tank 4 Lateral lines 7 Pit privy <input checked="" type="checkbox"/> 11 Fuel storage 14 Abandoned water well 2 Sewer lines 5 Cess pool 8 Sewage lagoon 12 Fertilizer storage 15 Oil well/ Gas well 3 Watertight sewer lines 6 Seepage pit 9 Feedyard 13 Insecticide storage 16 Other (specify below) _____ Direction from well? Northwest How many feet? 2,000									
FROM		TO		CODE		LITHOLOGIC LOG		FROM TO PLUGGING INTERVALS	
0		1.5				Brick, asphalt, and gravel			
1.5		10		03		Tan to gray, sandy, silty clay			
10		20		05		Tan to gray, clayey, fine grained, sand, well sorted			
20		26		11		Gray to tan, clayey, sandy gravel, poorly sorted			
		26		28		Bedrock			
RECEIVED NOV 08 2004 BUREAU OF WATER									
7 CONTRACTOR'S OR LANDOWNER'S CERTIFICATION: This water well was <input checked="" type="checkbox"/> (1) constructed, <input type="checkbox"/> (2) reconstructed, or <input type="checkbox"/> (3) plugged under my jurisdiction and was completed on (mo/day/yr) 8/31/04 and this record is true to the best of my knowledge and belief, Kansas Water Well Contractor's License No. 616 This Water Well Record was completed on (mo/day/yr) 11/4/04 under the business name of Thiele Geotech, Inc. by (signature) <i>D. J. ...</i>									
INSTRUCTIONS: Please fill in blanks and circle the correct answers. Send three copies to Kansas Department of Health and Environment, Bureau of Water, Topeka, Kansas 66620-0001. Telephone: 913-296-5545. Send one to WATER WELL OWNER and retain one for your records.									

OFFICE USE ONLY

T

R

SEC

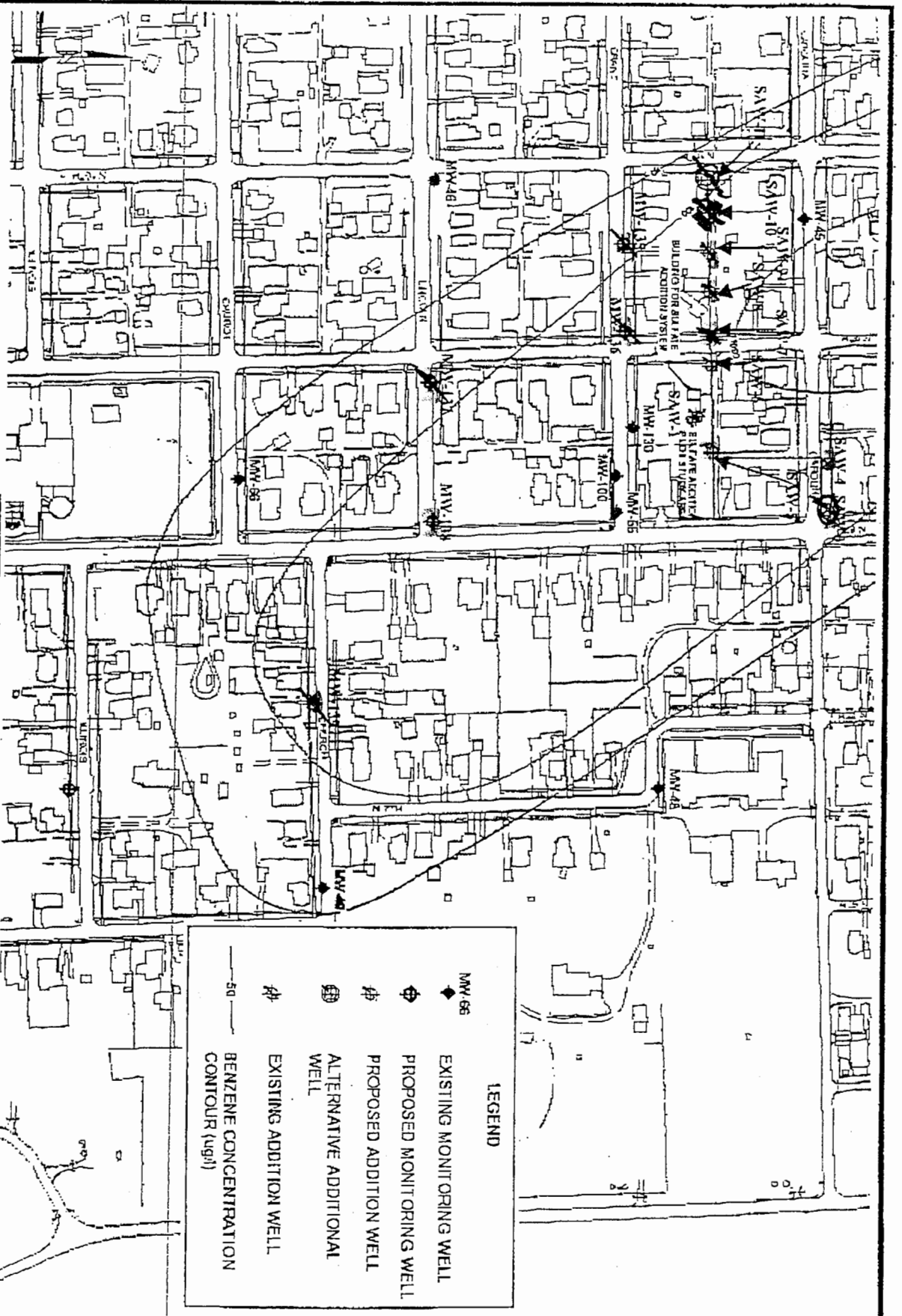
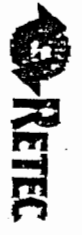

Sulphate Addition Prototype Design Matrix

HP Products North America Inc., Neodesha, KS (AMR261: 1879-508)

DATE: 06/03/04 DRAWN: E.S.S.

SULFATE ADDITION PROTOTYPE LAYOUT

ATTACHMENT 2

Send To Printer Back To TerraServer Change to 11x17 Print Size Show Grid Lines Change to Landscape

USGS 2 km N of Neodesha, Kansas, United States 07 Oct 1991



0 100M

0 100yd

Image courtesy of the U.S. Geological Survey
© 2004 Microsoft Corporation. **Terms of Use** **Privacy Statement**

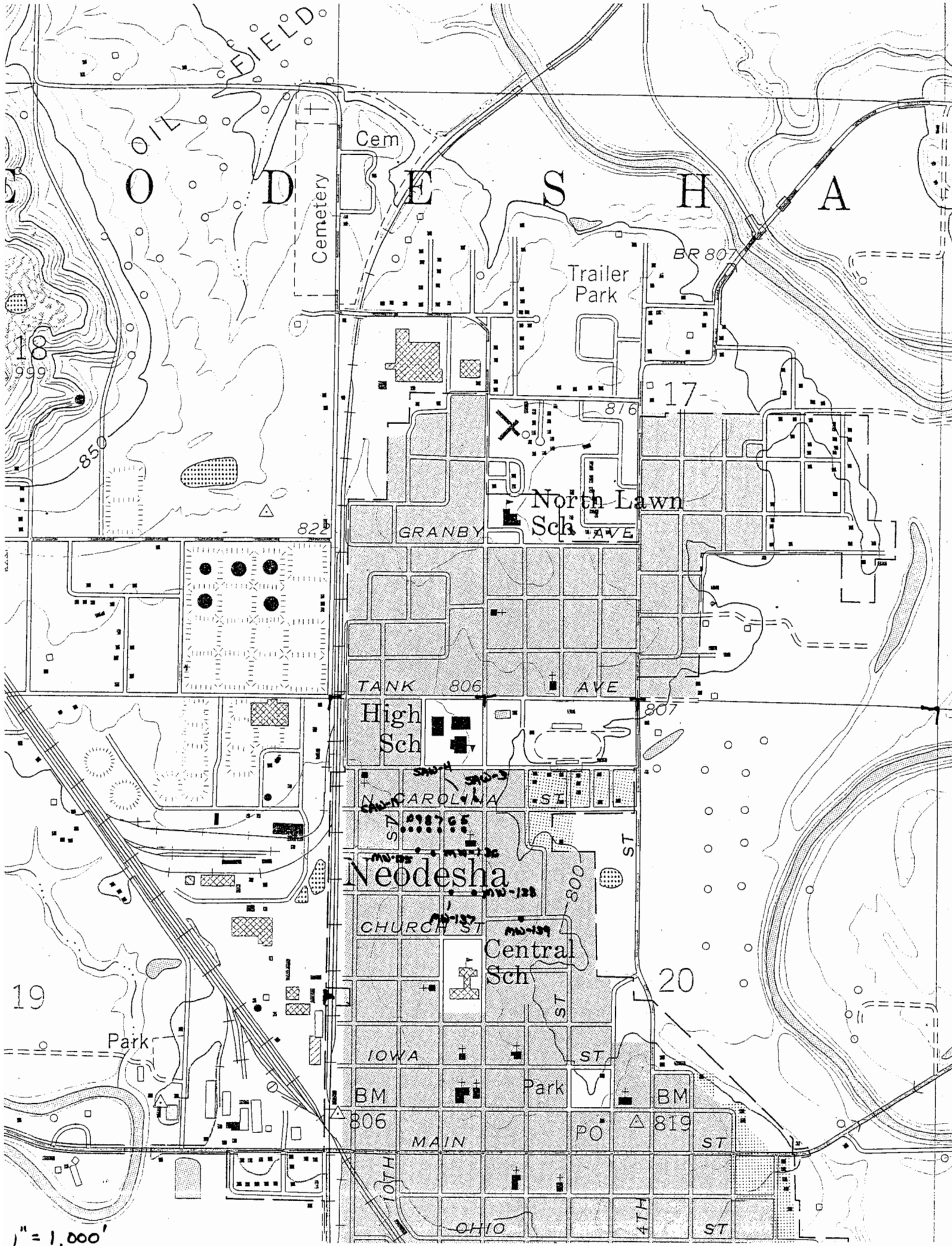

1" = 1,000'