

1 LOCATION OF WATER WELL: County: Wilson	Fraction NW ¼ SE ¼ NW ¼	Section Number 20	Township Number T 30 S	Range Number R 16 E/W
--	-----------------------------------	-----------------------------	----------------------------------	---------------------------------

Distance and direction from nearest town or city street address of well if located within city? **MW-139**
The well is located approximately 300 feet east of the intersection of N. 8th St. and Church St. within Church St. in Neodesha.
Latitude N37° 25.387' Longitude W95° 40.961'

2 WATER WELL OWNER: **BP Amoco Oil Co.**
 RR#, St. Address, Box # : **1100 North 12th Street**
 City, State, ZIP Code : **Neodesha, Kansas 66757**
 Board of Agriculture, Division of Water Resources
 Application Number: **Not Applicable**

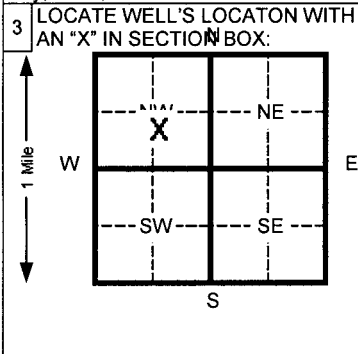

4 DEPTH OF COMPLETED WELL **26** ft. ELEVATION:
 Depth(s) Groundwater Encountered 1 **20** ft. 2 _____ ft. 3 _____ ft.
 WELL'S STATIC WATER LEVEL **Unk.** ft. below land surface measured on mo/day/yr
 Pump test data: Well water was _____ ft. after _____ hours pumping _____ gpm
 Est. Yield _____ gpm: Well water was _____ ft. after _____ hours pumping _____ gpm
 Bore Hole Diameter **8** in. to **26.5** ft. and _____ in. to _____ ft.
 WELL WATER TO BE USED AS: 5 Public water supply 8 Air conditioning 11 Injection well
 1 Domestic 3 Feed lot 6 Oil field water supply 9 Dewatering 12 Other (Specify below)
 2 Irrigation 4 Industrial 7 Lawn and garden (domestic) **10** Monitoring well
 Was a chemical/bacteriological sample submitted to Department? Yes _____ No **X** If yes, mo/day/yr sample was submitted _____
 Water Well Disinfected? Yes _____ No

5 TYPE OF BLANK CASING USED:
 1 Steel 3 RMP (SR) 5 Wrought Iron 8 Concrete tile CASING JOINTS: Glued _____ Clamped _____
2 PVC 4 ABS 6 Asbestos-Cement 9 Other (specify below) _____ Welded _____
 7 Fiberglass _____ **Threaded** _____
 Blank casing diameter **2** in. to **16** ft., Dia _____ in. to _____ ft., Dia _____ in. to _____ ft.
 Casing height above land surface **0** in., weight **N/A** lbs./ft. Wall thickness or gauge No. **0.1875**
 TYPE OF SCREEN OR PERFORATION MATERIAL:
 1 Steel 3 Stainless steel 5 Fiberglass 8 RMP (SR) 10 Asbestos-cement
 2 Brass 4 Galvanized steel 6 Concrete tile 9 ABS 11 Other (specify) _____
 SCREEN OR PERFORATION OPENINGS ARE:
 1 Continuous slot **3** Mill slot 5 Gauzed wrapped 8 Saw cut 11 None (open hole)
 2 Louvered shutter 4 Key punched 6 Wire wrapped 9 Drilled holes
 7 Torch cut 10 Other (specify) _____
 SCREEN-PERFORATED INTERVALS: From **16** ft. to **26** ft. From _____ ft. to _____ ft.
 From _____ ft. to _____ ft. From _____ ft. to _____ ft.
 GRAVEL PACK INTERVALS: From **14** ft. to **26.5** ft. From _____ ft. to _____ ft.
 From _____ ft. to _____ ft. From _____ ft. to _____ ft.

6 GROUT MATERIAL: 1 Neat cement 2 Cement grout **3 Bentonite** 4 Other _____
 Grout Intervals From **1** ft. to **14** ft. From _____ ft. to _____ ft. From _____ ft. to _____ ft.
 What is the nearest source of possible contamination:
 1 Septic tank 4 Lateral lines 7 Pit privy **11** Fuel storage 10 Livestock pens 14 Abandoned water well
 2 Sewer lines 5 Cess pool 8 Sewage lagoon 12 Fertilizer storage 15 Oil well/ Gas well
 3 Watertight sewer lines 6 Seepage pit 9 Feedyard 13 Insecticide storage 16 Other (specify below) _____
 Direction from well? **Northwest** How many feet? **2,500**

FROM	TO	CODE	LITHOLOGIC LOG	FROM	TO	PLUGGING INTERVALS
0	1		Brick and asphalt			
1	11	03	Tan to gray silty clay with trace sand			
11	18	05	Gray to tan, clayey, silty, fine grained sand,			
18	26.5	11	Tan to gray, clayey, sandy gravel, poorly sorted			

RECEIVED
NOV 08 2004
BUREAU OF WATER

7 CONTRACTOR'S OR LANDOWNER'S CERTIFICATION: This water well was **(1) constructed**, (2) reconstructed, or (3) plugged under my jurisdiction and was completed on (mo/day/yr) **8/31/04** and this record is true to the best of my knowledge and belief. Kansas Water Well Contractor's License No. **616** This Water Well Record was completed on (mo/day/yr) **11/4/04** under the business name of **Thiele Geotech, Inc.** by (signature) *D. J. A. [Signature]*

INSTRUCTIONS: Please fill in blanks and circle the correct answers. Send three copies to Kansas Department of Health and Environment, Bureau of Water, Topeka, Kansas 66620-0001. Telephone: 913-296-5545. Send one to WATER WELL OWNER and retain one for your records.

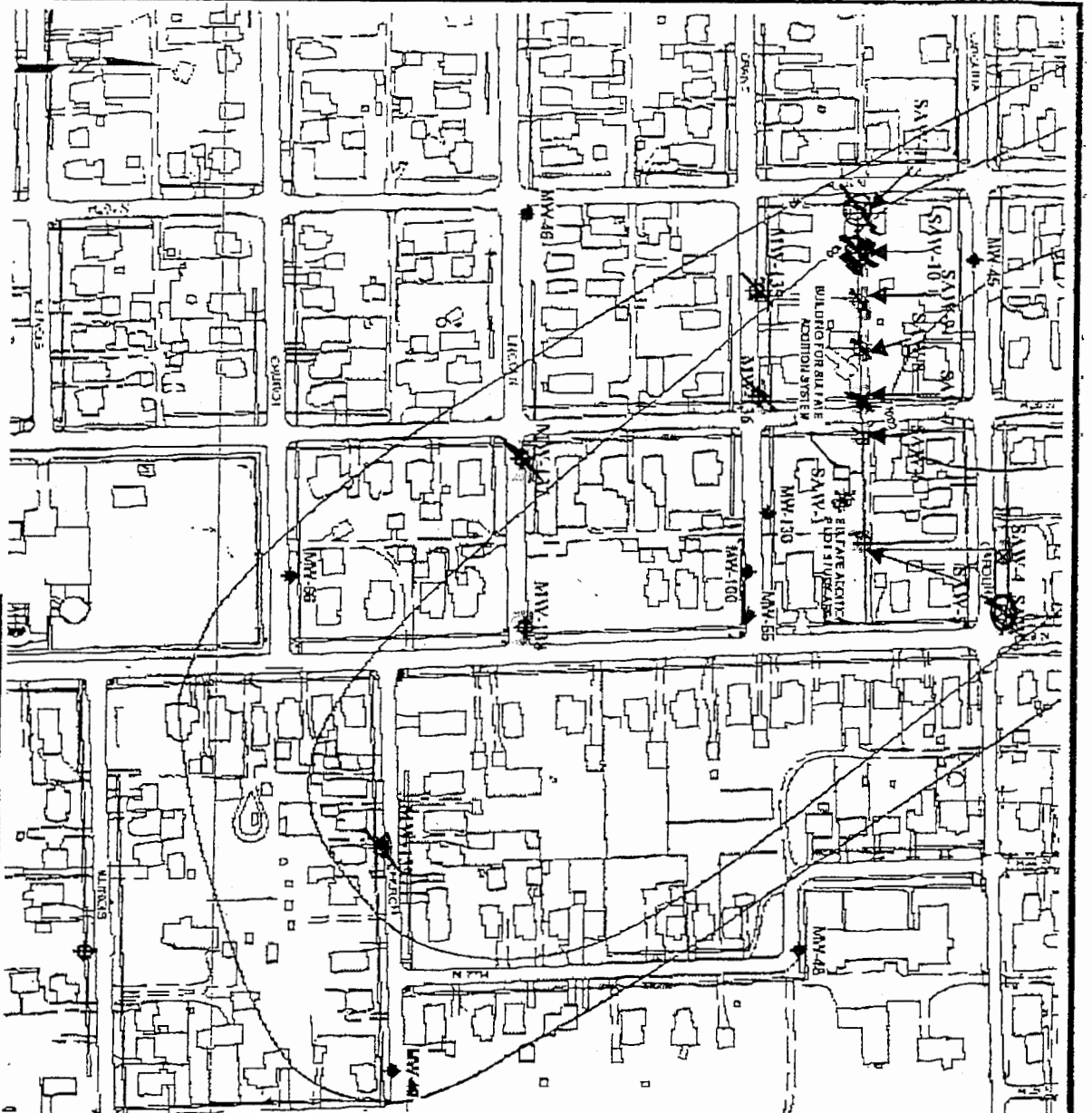
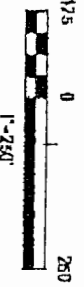

Sulfate Addition Prototype Design Memo

BP Products North America Inc., Neochale, KS (AMXG1: 18979-508)

DATE: 09/03/04

PROJECT: E.S.S.

SULFATE ADDITION PROTOTYPE LAYOUT

ATTACHMENT 2

- LEGEND**
- MW-66 EXISTING MONITORING WELL
 - PROPOSED MONITORING WELL
 - PROPOSED ADDITION WELL
 - ALTERNATIVE ADDITIONAL WELL
 - EXISTING ADDITION WELL
 - BENZENE CONCENTRATION CONTOUR (ug/l)

Send To Printer

Back To TerraServer

Change to 11x17 Print Size

Show Grid Lines

Change to Landscape

USGS 2 km N of Neodesha, Kansas, United States 07 Oct 1991



0 100M

0 100yd

Image courtesy of the U.S. Geological Survey
© 2004 Microsoft Corporation. **Terms of Use** **Privacy Statement**

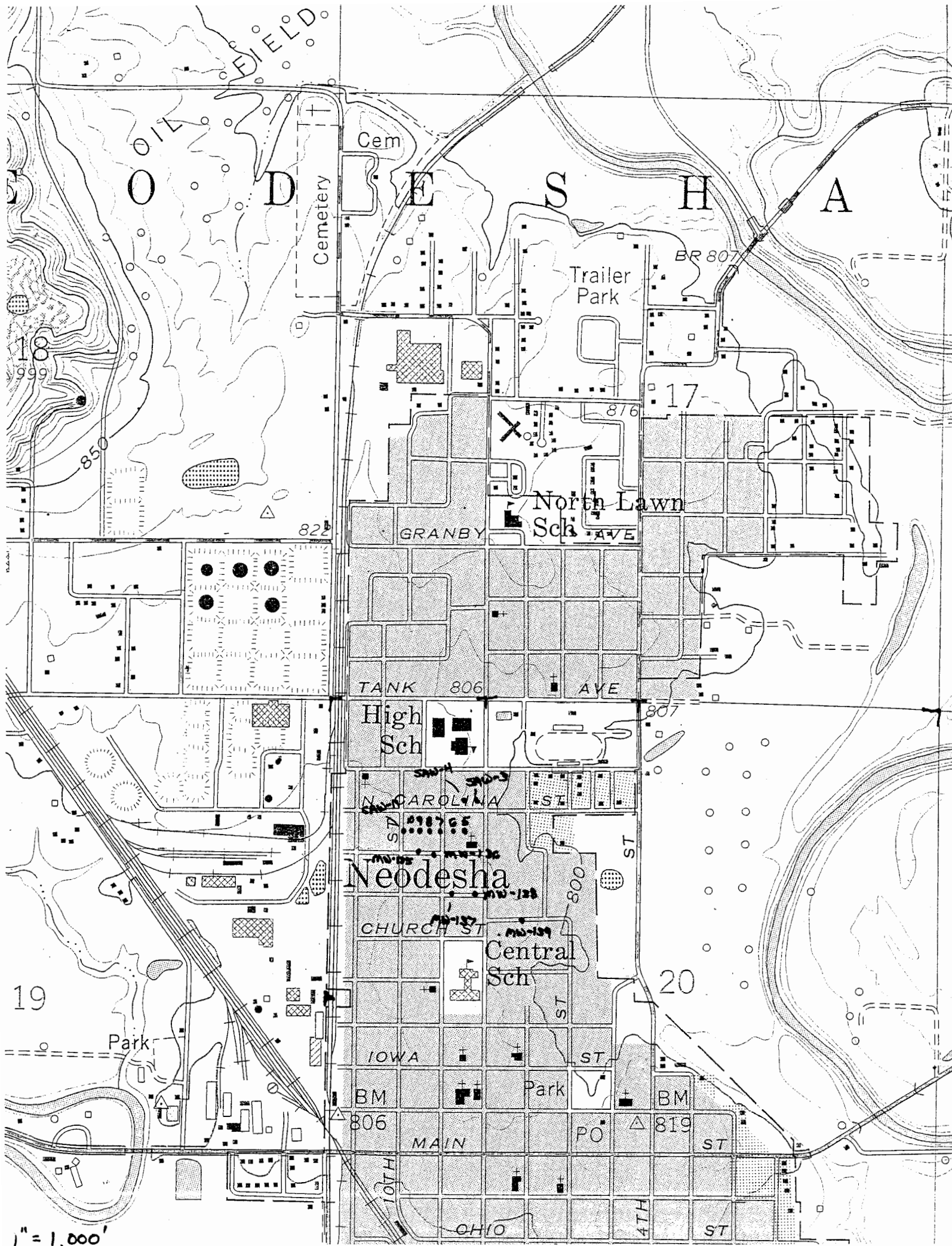

1" = 1,000'