

NW well

WATER WELL RECORD

Form WWC-5

Division of Water Resources App. No.

47595

1 LOCATION OF WATER WELL: County: Sumner Fraction NE 1/4 SW 1/4 NE 1/4 NE 1/4 Section Number 33 Township No. T 30 S Range Number R 2 [X]E [ ]W

Street/Rural Address of Well Location; if unknown, distance & direction from nearest town or intersection: If at owner's address, check here [ ]. From Belle Plaine, Ks. 4E 3/4N ESR Global Positioning System (GPS) information: Latitude: 37.40438 Longitude: 097.20579 Elevation: 1174

2 WATER WELL OWNER: Thane Buss RR#, Street Address, Box #: 418 East Olive Street City, State, ZIP Code : Oxford, Kansas 67119 Collection Method: [X] GPS unit (Make/Model: Garmin 62S) [ ] Digital Map/Photo, [X] Topographic Map, [ ] Land Survey Est. Accuracy: [ ] <3 m, [X] 3-5 m, [ ] 5-15 m, [ ] >15 m

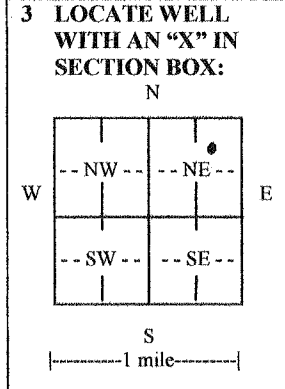

3 LOCATE WELL WITH AN 'X' IN SECTION BOX: 4 DEPTH OF COMPLETED WELL 29 ft. Depth(s) Groundwater Encountered (1)..... ft. (2)..... ft. (3)..... ft. WELL'S STATIC WATER LEVEL 8.....ft. below land surface measured on mo/day/yr. 3/19/2014..... Pump test data: Well water was.....ft. after..... hours pumping..... gpm EST. YIELD.....gpm. Well water was.....ft. after..... hours pumping..... gpm Bore Hole Diameter 20.....in. to 29.....ft., and .....in. to .....ft. WELL WATER TO BE USED AS: [ ] Public water supply [ ] Geothermal [ ] Injection well [ ] Domestic [ ] Feedlot [ ] Oil field water supply [ ] Dewatering [ ] Other (Specify below) [X] Irrigation [ ] Industrial [ ] Domestic-lawn & garden [ ] Monitoring well Was a chemical/bacteriological sample submitted to Department? [ ] Yes [X] No If yes, mo/day/yr sample was submitted..... Water well disinfected? [X] Yes [ ] No

5 TYPE OF CASING USED: [ ] Steel [X] PVC [ ] Other CASING JOINTS: [X] Glued [ ] Clamped [ ] Welded [ ] Threaded Bolted Casing diameter .10..... in. to .19..... ft., Diameter ..... in. to ..... ft., Diameter ..... in. to ..... ft. Casing height above land surface .24..... in., Weight .160.....lbs./ft., Wall thickness or gauge No. .413..... TYPE OF SCREEN OR PERFORATION MATERIAL: [ ] Steel [X] Stainless Steel [ ] PVC [ ] Brass [ ] Galvanized Steel [ ] None used (open hole) [ ] Other (Specify) SCREEN OR PERFORATION OPENINGS ARE: [ ] Continuous slot [ ] Mill slot [ ] Gauze wrapped [ ] Torch cut [ ] Drilled holes [ ] None (open hole) [ ] Louvered shutter [ ] Key punched [X] Wire wrapped [ ] Saw cut [ ] Other (specify) SCREEN-PERFORATED INTERVALS: From .19..... ft. to .29..... ft., From ..... ft. to ..... ft. From ..... ft. to ..... ft. From ..... ft. to ..... ft. GRAVEL PACK INTERVALS: From .29..... ft. to .10..... ft., From ..... ft. to ..... ft. From ..... ft. to ..... ft.

6 GROUT MATERIAL: [ ] Neat cement [ ] Cement grout [X] Bentonite [ ] Other Grout Intervals: From 10..... ft. to 0..... ft., From ..... ft. to ..... ft., From ..... ft. to ..... ft. What is the nearest source of possible contamination: [ ] Septic tank [ ] Lateral lines [ ] Pit privy [ ] Livestock pens [ ] Insecticide storage [X] Other (specify below) [ ] Sewer lines [ ] Cesspool [ ] Sewage lagoon [ ] Fuel storage [ ] Abandoned water well [ ] Watertight sewer lines [ ] Seepage pit [ ] Feedyard [ ] Fertilizer storage [ ] Oil well/gas well None Direction from well ..... Distance from well .....

Table with columns: FROM, TO, LITHOLOGIC LOG, FROM, TO, LITHO. LOG (cont.) or PLUGGING INTERVALS. Rows: 0-2 Top soil, 2-5 Brown-sandy clay, 5-28 Small-med. clay, 28-29 Green shale.

7 CONTRACTOR'S OR LANDOWNER'S CERTIFICATION: This water well was [X] constructed, [ ] reconstructed, or [ ] plugged under my jurisdiction and was completed on (mo/day/year) 3/19/2014..... and this record is true to the best of my knowledge and belief. Kansas Water Well Contractor's License No. 134..... This Water Well Record was completed on (mo/day/year) 3/26/2014..... under the business name of ..Rosenkrantz-Bemis Ent..... by (signature) ..C. J. Smith

INSTRUCTIONS: Use typewriter or ball point pen. PLEASE PRESS FIRMLY and PRINT clearly. Please fill in blanks and check the correct answers. Send three copies (white, blue, pink) to Kansas Department of Health and Environment, Bureau of Water, Geology Section, 1000 SW Jackson St., Suite 420, Topeka, Kansas 666 12-1367. Telephone 785-296-5524. Send one copy to WATER WELL OWNER and retain one for your records. Include fee of \$5.00 for each constructed well. Visit us at http://www.kdheks.gov/waterwell/index.html.