

WATER WELL PLUGGING RECORD Form WWC-5P

KSA 82a-1212

ID NO.

MW 6

1 LOCATION OF WATER WELL: County: Crawford	Fraction ¼ SW ¼ SE ¼ NE ¼	Section Number 19	Township Number T 30 S	Range Number 25	<input checked="" type="checkbox"/> E <input type="checkbox"/> W
--	------------------------------	----------------------	---------------------------	--------------------	--

Street/Rural Address of Well Location; if unknown, distance & direction from nearest town or intersection: If at owner's address, check here 1308 N Walnut St. Pittsburg, KS

Global Positioning Systems (GPS) information:
 Latitude: 37.41936 (in decimal degrees)
 Longitude: -94.70769 (in decimal degrees)
 Elevation: _____
 Horizontal Datum: WGS84, NAD83, NAD27
 Collection Method: _____

2 WATER WELL OWNER: Metso Mineral Industries Inc.
 RR#, St. Address, Box #: 240 Arch St./PO Box 17312
 City, State ZIP Code: York PA 17405-7312

GPS unit (Make/Model: Garmin etrek)
 Digital Map/Photo, Topographic Map, Land Survey
 Est. Accuracy: < 3 m, 3-5 m, 5-15 m, > 15 m

3 MARK WELL'S LOCATION WITH AN "X" IN SECTION BOX:

4 DEPTH OF WELL 16 ft.
WELL'S STATIC WATER LEVEL 3.11 ft.
WELL WAS USED AS:

<input type="checkbox"/> Domestic	<input type="checkbox"/> Public Water Supply	<input checked="" type="checkbox"/> Dewatering
<input type="checkbox"/> Irrigation	<input type="checkbox"/> Oil Field Water Supply	<input checked="" type="checkbox"/> Monitoring
<input type="checkbox"/> Feedlot	<input type="checkbox"/> Domestic (Lawn & Garden)	<input type="checkbox"/> Injection Well
<input type="checkbox"/> Industrial	<input type="checkbox"/> Air Conditioning	<input type="checkbox"/> Other _____

Was a chemical/bacteriological sample submitted to Department? Yes No

5 TYPE OF BLANK CASING USED:

Steel RMP (SR) Wrought Fiberglass Other (Specify below)
 PVC ABS Asbestos-Cement Concrete Tile

Blank casing diameter 2 in. Was casing pulled? Yes No If yes, how much all
 Casing height above or below land surface -6 in.

6 GROUT PLUG MATERIAL: Neat cement Cement grout Bentonite Other Top Soil

Grout Plug Intervals: From 0 ft. to 3 ft., From 3 ft. to 16 ft., From — ft. to — ft.

What is the nearest source of possible contamination:



<input type="checkbox"/> Septic tank	<input type="checkbox"/> Seepage pit	<input type="checkbox"/> Fuel storage	<input type="checkbox"/> Other (specify below)
<input type="checkbox"/> Sewer lines	<input type="checkbox"/> Pit privy	<input type="checkbox"/> Fertilizer storage	<u>unknown</u>
<input type="checkbox"/> Watertight sewer lines	<input type="checkbox"/> Sewage lagoon	<input type="checkbox"/> Insecticide storage	
<input type="checkbox"/> Lateral lines	<input type="checkbox"/> Feedyard	<input type="checkbox"/> Abandoned water well	Direction from well? <u>unknown</u>
<input type="checkbox"/> Cess pool	<input type="checkbox"/> Livestock pens	<input type="checkbox"/> Oil well/Gas well	How many feet? <u>unknown</u>

FROM	TO	PLUGGING MATERIALS	FROM	TO	PLUGGING MATERIALS
0	3	Top Soil			
3	16	Bentonite			

7 CONTRACTOR'S OR LANDOWNER'S CERTIFICATION: This water well was plugged under my jurisdiction and was completed on (mo/day/year) 2/28/2018 and this record is true to the best of my knowledge and belief. Kansas Water Well Contractor's License No. 710. This Water Well Record was completed on (mo/day/year) 3/2/2018 under the business name of Below Ground Surface, Inc. by (signature) Craig R. [Signature]

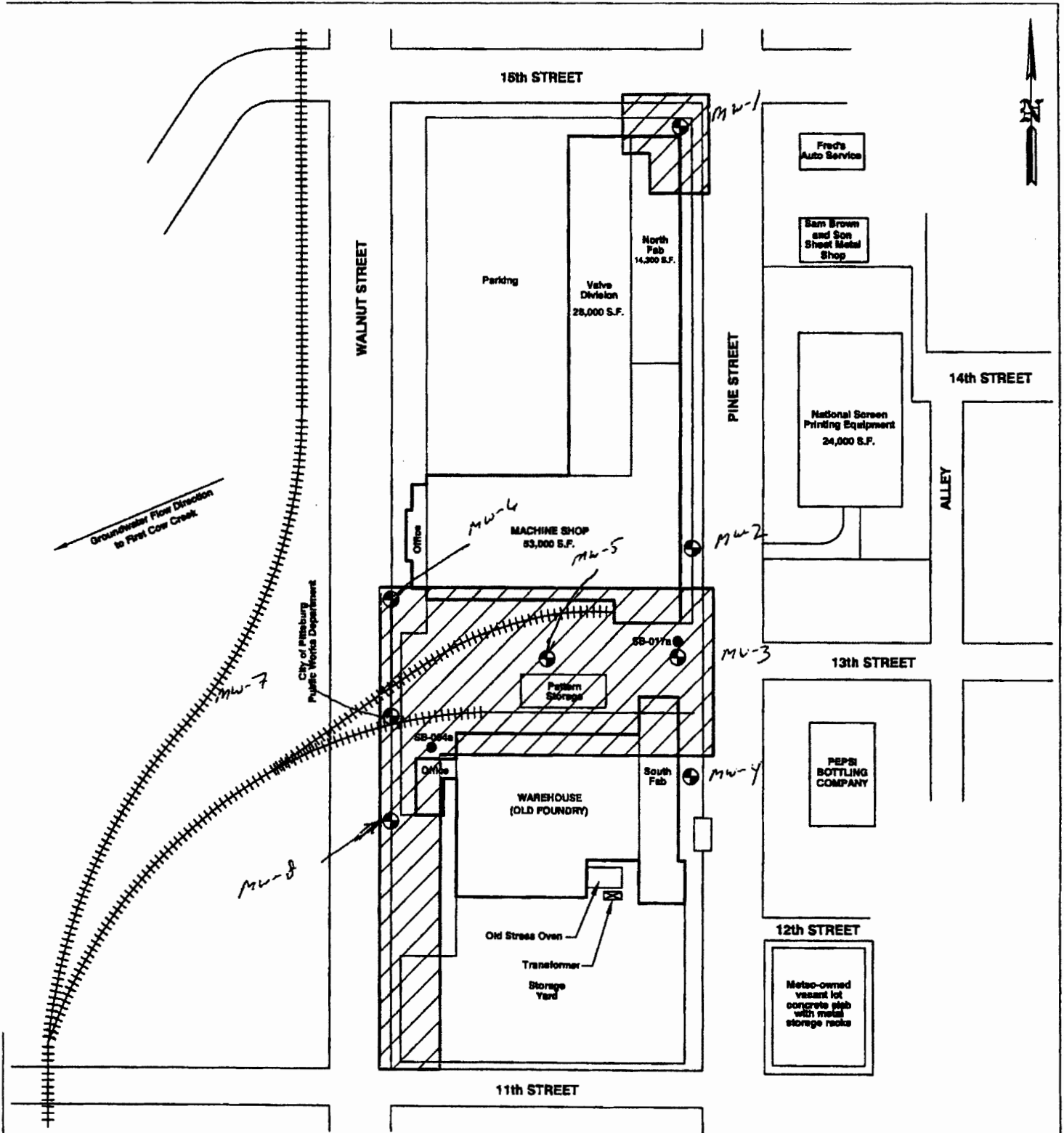
Send one white copy to Kansas Department of Health & Environment, Geology Section, 1000 SW Jackson Street, Ste. 420, Topeka, KS 66612-1367. Send one copy to WATER WELL OWNER and retain one for your records.
 Visit us at <http://www.kdheks.gov/waterwell/index.html> Telephone 785-296-5524.



LEGEND	
	PROPOSED EXTENT OF NO FURTHER ACTION DETERMINATION
	SOIL BORING LOCATIONS
	PROPOSED GROUNDWATER MONITORING WELL LOCATIONS

241 WHEATLAND AVE. SUITE 202 (717) 392-8567
LANCASTER, PA 17602 (717) 398-6482 FAX

August Mack
ENVIRONMENTAL

METSO MINERALS INDUSTRIES, INC.
1308 N. WALNUT STREET
PITTSBURG, KANSAS

SITE PLAN 2

PROJECT No.: JG0220.333	FILENAME: K\AMEP\PO0046.333\Site Plan2	DATE: 05/15/2007
DRAWN BY: ZWG	SCALE: AS SHOWN	FIGURE: 2