

WATER WELL PLUGGING RECORD Form WWC-5P

KSA 82a-1212 ID NO.

MW 7

1 LOCATION OF WATER WELL: Fraction $\frac{1}{4}$ SW $\frac{1}{4}$ SE $\frac{1}{4}$ NE $\frac{1}{4}$ Section Number 19 Township Number T 30 S Range Number 25 E W
 County: Crawford

Street/Rural Address of Well Location; if unknown, distance & direction from nearest town or intersection: If at owner's address, check here 1308 N Walnut St. Pittsburg, KS
East of Walnut \approx 30', south of 15th St. \approx 2010'

Global Positioning Systems (GPS) information:
 Latitude: _____ (in decimal degrees)
 Longitude: _____ (in decimal degrees)
 Elevation: _____
 Horizontal Datum: WGS84, NAD83, NAD27
 Collection Method: _____

2 WATER WELL OWNER: Metso Mineral Industries Inc.
 RR#, St. Address, Box #: 240 Arch St./PO Box 17312
 City, State ZIP Code: York PA 17405-7312

GPS unit (Make/Model): Garmin etrek
 Digital Map/Photo, Topographic Map, Land Survey
 Est. Accuracy: < 3 m, 3-5 m, 5-15 m, > 15 m

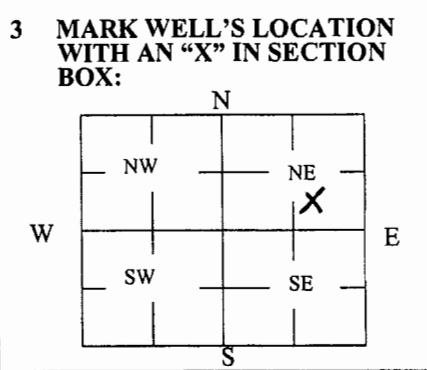

4 DEPTH OF WELL 16 ft.
 WELL'S STATIC WATER LEVEL _____ ft
 WELL WAS USED AS:
 Domestic Public Water Supply Dewatering
 Irrigation Oil Field Water Supply Monitoring
 Feedlot Domestic (Lawn & Garden) Injection Well
 Industrial Air Conditioning Other _____
 Was a chemical/bacteriological sample submitted to Department? Yes No *MW-7*

5 TYPE OF BLANK CASING USED:
 Steel RMP (SR) Wrought Fiberglass Other (Specify below)
 PVC ABS Asbestos-Cement Concrete Tile
 Blank casing diameter 2 in. Was casing pulled? Yes No If yes, how much _____
 Casing height above or below land surface -6 in.



6 GROUT PLUG MATERIAL: Neat cement Cement grout Bentonite Other _____
 Grout Plug Intervals: From _____ ft. to _____ ft., From _____ ft. to _____ ft., From _____ ft. to _____ ft.
 What is the nearest source of possible contamination:
 Septic tank Seepage pit Fuel storage Other (specify below) _____
 Sewer lines Pit privy Fertilizer storage unknown _____
 Watertight sewer lines Sewage lagoon Insecticide storage _____
 Lateral lines Feedyard Abandoned water well Direction from well? unknown
 Cess pool Livestock pens Oil well/Gas well How many feet? unknown

FROM	TO	PLUGGING MATERIALS	FROM	TO	PLUGGING MATERIALS
		<i>After extensive search with tools and metal detector, MW-07 was unable to be located. Neither casing nor boring can be found. Assume construction activities destroyed the well.</i>			

7 CONTRACTOR'S OR LANDOWNER'S CERTIFICATION: This water well was plugged under my jurisdiction and was completed on (mo/day/year) _____ and this record is to the best of my knowledge and belief. Kansas Water Well Contractor's License No. 710. This Water Well Record was completed on (mo/day/year) 3/2/2018 under the business name of Below Ground Surface, Inc. by (signature) *Craig K. Hewitt*

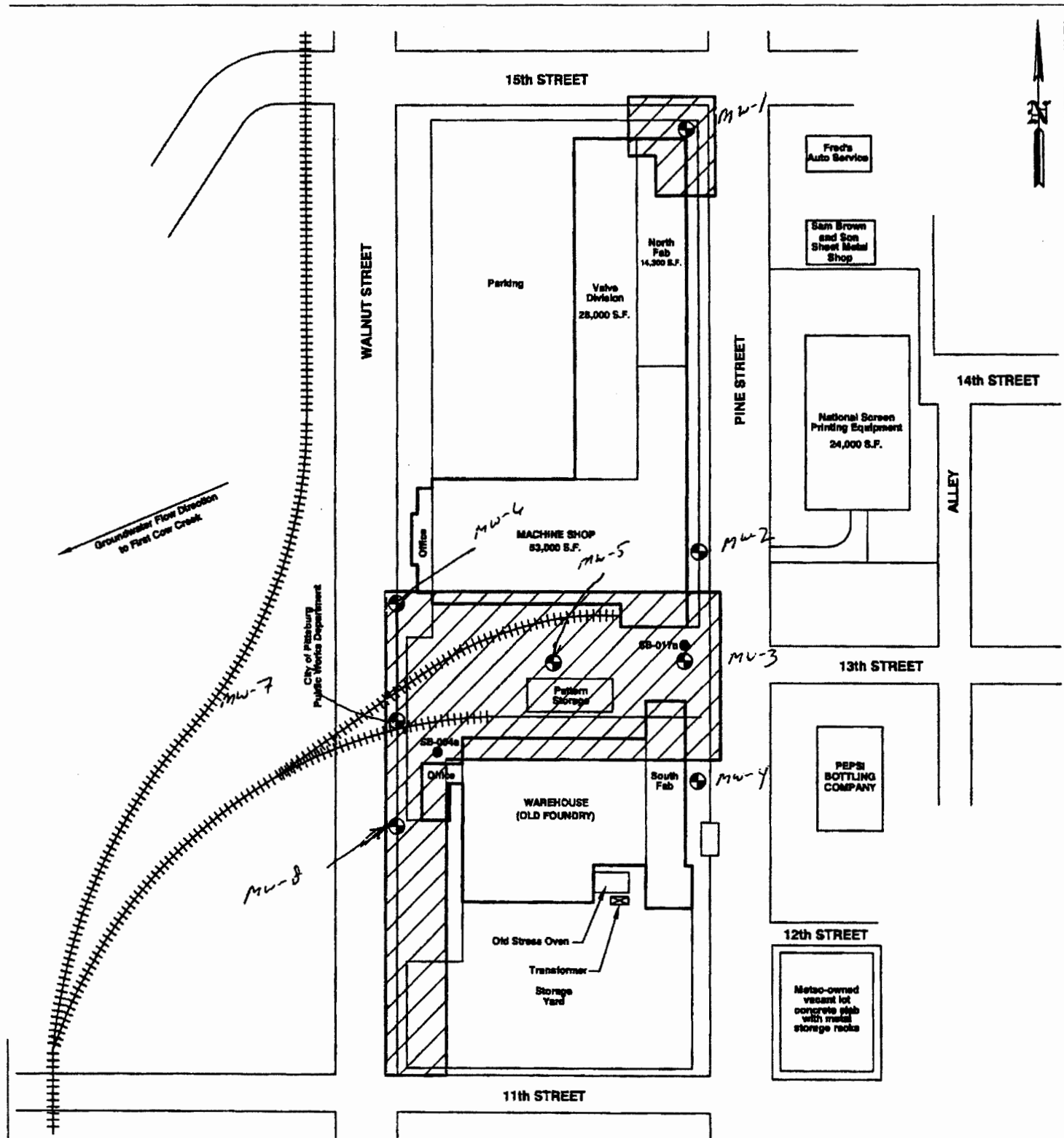
Send one white copy to Kansas Department of Health & Environment, Geology Section, 1000 SW Jackson Street, Ste. 420, Topeka, KS 66612-1367. Send one copy to WATER WELL OWNER and retain one for your records.
 Visit us at <http://www.kdheks.gov/waterwell/index.html> Telephone 785-296-5524.



LEGEND	
	PROPOSED EXTENT OF NO FURTHER ACTION DETERMINATION
	SOIL BORING LOCATIONS
	PROPOSED GROUNDWATER MONITORING WELL LOCATIONS



841 WHEATLAND AVE., SUITE 302
LANCASTER, PA 17602 (717) 388-9587
(717) 388-6483 FAX

August Mack
ENVIRONMENTAL

METSO MINERALS INDUSTRIES, INC.
1308 N. WALNUT STREET
PITTSBURG, KANSAS

SITE PLAN 2

PROJECT No.: JG0020 330	FILENAME: K:\AMEP\PG0048.333\Site Plan 2	DATE: 05/15/2007
DRAWN BY: ZWG	SCALE: AS SHOWN	FIGURE: 2