

WATER WELL RECORD

Form WWC-5

Division of Water Resources App. No.

Well ID

MW1R

Original Record Correction Change in Well Ust

1 LOCATION OF WATER WELL: County Crawford Fraction NE 1/4 SE 1/4 NE 1/4 NE 1/4 Section Number 19 Township Number T 30 S Range Number R 25 E W

2 WELL OWNER: Last Name: First: Street or Rural Address where well is located (if unknown, distance and direction from nearest town or intersection): If at owner's address, check here: 1711 N Broadway, Pittsburg, KS

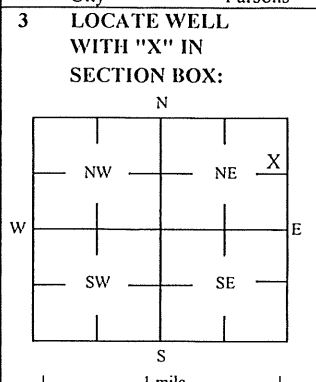

3 LOCATE WELL WITH 'X' IN SECTION BOX: 4 DEPTH OF COMPLETED WELL: 20 ft Depth(s) Groundwater Encountered: 1) ft 2) ft 3) ft, or 4) Dry Well WELL'S STATIC WATER LEVEL: 8.30 ft.

5 Latitude: 37.42361 (decimal degrees) Longitude: 94.70529 (decimal degrees) Horizontal Datum: X WGS 84 NAD 83 NAD 27 Source for Latitude/Longitude: GPS (unit make/model): (WAAS enabled? Yes No) X Land Survey Topographic Map Online Mapper

6 Elevation 935.09 ft Ground Level X TOC Source: X Land Survey GPS Topographic Map Other

7 WELL WATER TO BE USED AS: 1 Domestic: Household Lawn & Garden Livestock Irrigation Feedlot Industrial 5 Public Water Supply: well ID 6 Dewatering: how many wells? 7 Aquifer Recharge: well ID 8 X Monitoring: well ID MW1R 9 Environmental Remediation: well ID Air Sparge Soil Vapor Extractor Recovery Injection 10 Oil Field Water Supply: lease 11 Test Hole: well ID Cased Uncased Geotechnical 12 Geothermal: How many bores? a) Closed Loop Horizontal Vertical b) Open Loop Surface Discharge Inj. of Water Other (specify):

Was a chemical/bacteriological sample submitted to KDHE? Yes No X No If yes, date sample was submitted: Water well disinfected? Yes No X No

8 TYPE OF CASING USED: Steel PVC X Other CASING JOINTS: Glued Clamped Welded X Threaded Casing diameter 2 in. to 10 ft, Diameter in. to ft, Diameter in. to ft, Casing height above land surface -0.33 in. Weight lbs./ft. Well thickness or gauge No TYPE OF SCREEN OR PERFORATION MATERIAL: Steel Stainless Steel Fiberglass X PVC Other (Specify) Brass Galvanized Steel Concrete tile None used (open hole) SCREEN OR PERFORATION OPENINGS ARE: Continuous Slot X Mill Slot Gauze Wrapped Torch Cut Drilled Holes Other (Specify) Louvered Shutter Key Punched Wire Wrapped Saw Cut None (Open Hole) SCREEN-PERFORATED INTERVALS: From 10 ft. to 20 ft, From ft. to ft, From ft. to ft, GRAVEL PACK INTERVALS: From 8 ft. to 20 ft, From ft. to ft, From ft. to ft,

9 GROUT MATERIAL: Neat cement Cement grout X Bentonite X Other Concrete: 0-0.5' Grout intervals: From 0.5 ft. to 8 ft, From ft. to ft, From ft. to ft,

Nearest source of possible contamination: Septic Tank Lateral Lines Pit Privy Livestock Pens Insecticide Storage Sewer Lines Cess Pool Sewage Lagoon X Fuel Storage Abandoned Water Well Watertight Sewer Lines Seepage Pit Feedyard Fertilizer Storage Oil Well / Gas Well Other (Specify) Direction from well? N Distance from well? ~3 ft

Table with 6 columns: 10 FROM, TO, LITHOLOGIC LOG, FROM, TO, LITHO. LOG (cont.) or PLUGGING INTERVALS. Rows include Concrete, Gravel/fill, Silty clay, gravel, Shale, Coal, Shale.

Notes: KDHE ID: Short Stop; U3-019-13788 / 14228 Target of monitoring well is shallow groundwater, <20' of grout was installed at the direction of KDHE.

11 CONTRACTOR'S OR LANDOWNER'S CERTIFICATION: This water well was X constructed, reconstructed, or plugged under my jurisdiction and was completed on (mo-day-year) 12/3/19 and this record is true to the best of my knowledge and belief. Kansas Water Well Contractor's License No 757 This Water Well Record was completed on (mo-day-year) 1/21/20 under the business name of Larsen & Associates, Inc. Signature

Mail 1 white copy along with a fee of \$5.00 for each constructed well to: Kansas Department of Health and Environment, Bureau of Water, 1000 SW Jackson St., Suite 420, Topeka, Kansas 66612-1367. Mail one to Water Well Owner and retain one for your records. Telephone 785-296-5524.

NOTE: Figures exhibited within this report are only to be used within the context of this report. Placement of property lines, wells, structures, and roads is based on the available information from county appraiser maps, surveys, site visits, and/or previous vendor reports and should be considered approximate.

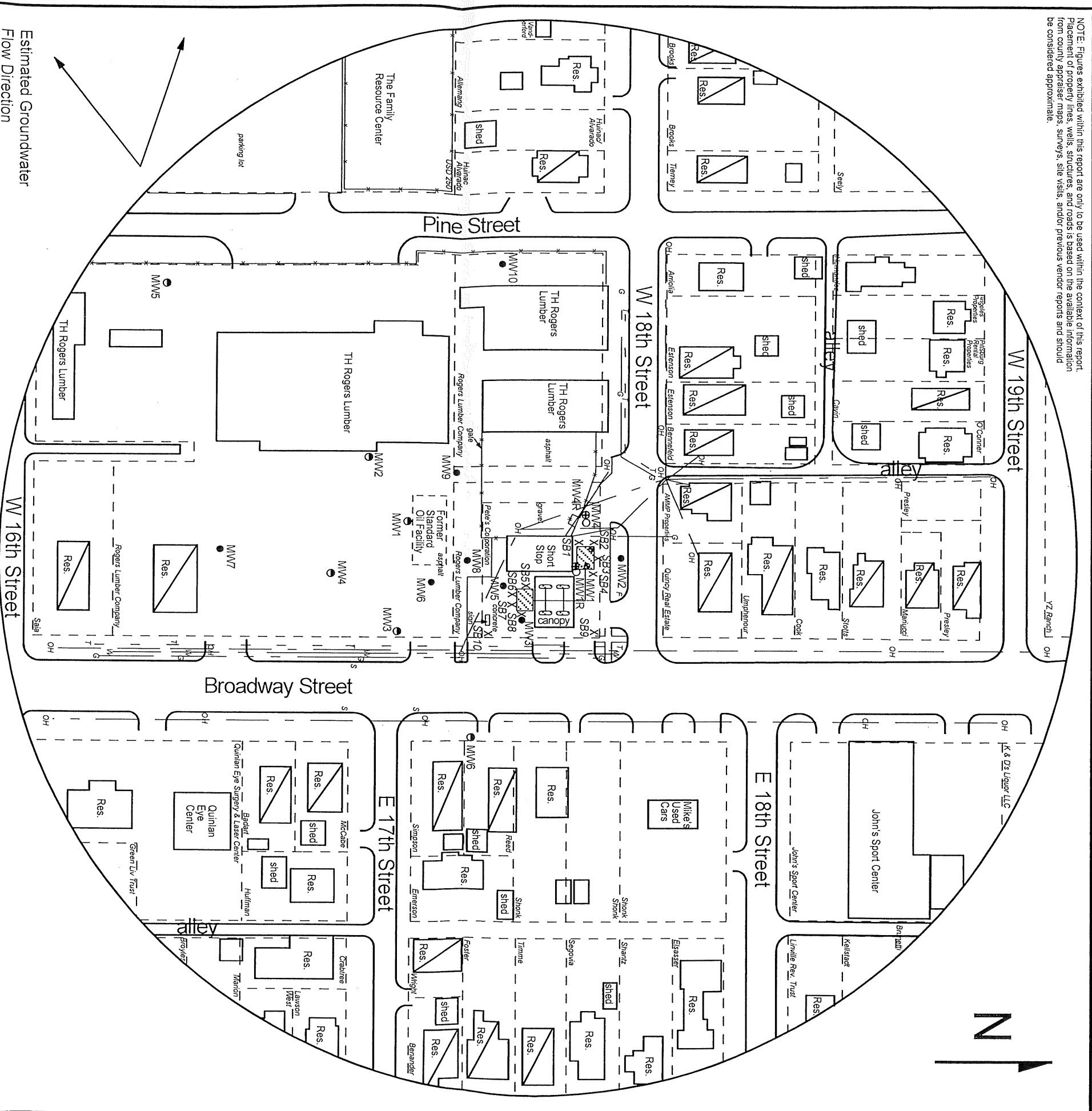

FIGURE 2.2 - 500 FT RADIUS AREA BASE MAP

larsen
 & ASSOCIATES, INC.

















1311 E 25th St., Suite B 785-841-8707 office
 Lawrence, KS 66046 785-865-4282 fax

PROJECT:

Short Stop
 17111 N. Broadway
 Pittsburg, KS
 KDHEID: U3-019-13788/14228
 Date: 12/4/19

0 100 ft

LEGEND

-  Approximate Location of Active UST Basin,
-  Product Lines & Pump Islands
-  Building with Basement
-  Approximate Location of Property Line
-  Existing Monitoring Well
-  Former Standard Oil wells (U3-019-14985)
-  Plugged/Destroyed Well
-  Observation Well
-  Monitoring Well (Installed 12/3/19)
-  Soil Boring (Drilled 12/3-4/19)
-  Fire Hydrant
-  Sewer Inlet
-  Gas Lines (1.5 - 3 ft bgs)
-  Overhead Lines (25'-40' high)
-  Telephone Lines (2 - 6 ft bgs)
-  Water Lines (2 - 6 ft bgs)

NOTE: SB9 & SB10 were drilled to collect hydrologic samples.
NOTE: Utility depths, heights and locations are approximate.