

NOTE: Figures exhibited within this report are only to be used within the context of this report. Placement of property lines, wells, structures, and roads is based on the available information from county appraiser maps, surveys, site visits, and/or previous vendor reports and should be considered approximate.

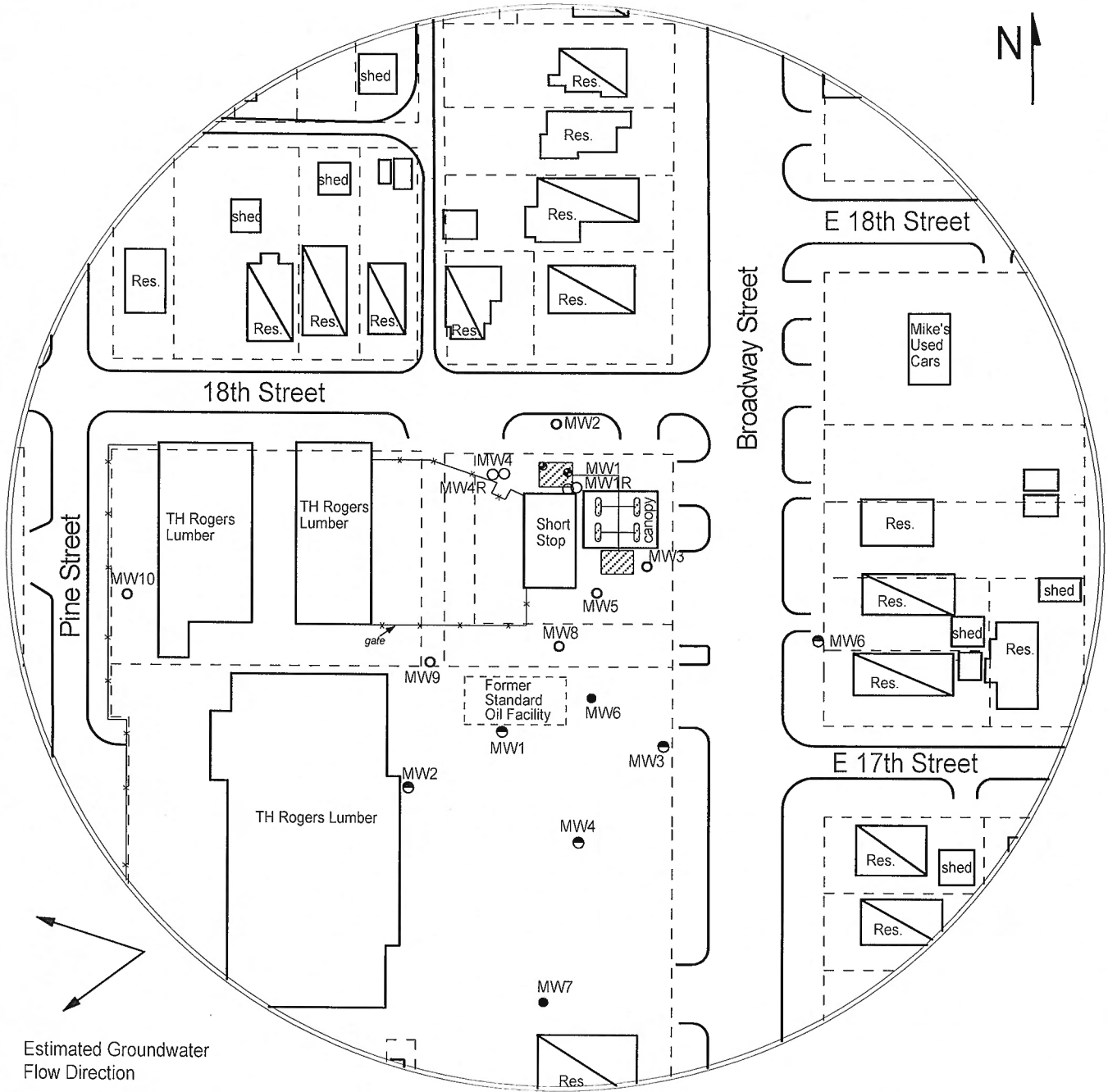
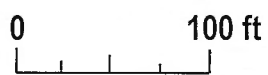

FIGURE 1 - 350 FT RADIUS AREA BASE MAP

- LEGEND:**
- Approximate Location of Active UST Basin, Product Lines & Pump Islands
 - Building with Basement
 - Approximate Location of Property Line
 - Existing Monitoring Well
 - Former Standard Oil Wells(U3-019-14985)
 - Observation Well
 - Plugged/Destroyed Well



PROJECT:
 Short Stop
 1711 N. Broadway
 Pittsburg, KS
 KDHE ID: U3-019-13788/
 14228
 Date: 5/18-19/20



1311 E 25th St. Suite B 785-841-8707 office
 Lawrence, KS 66046 785-865-4282 fax