

1 LOCATION OF WATER WELL: County: Crawford Fraction NE 1/4 SE 1/4 NE 1/4 NE 1/4 Section Number 19 Township Number T 30 S Range Number 25 [X] E [] W

Street/Rural Address of Well Location: if unknown, distance & direction from nearest town or intersection: If at owner's address, check here [] 1711 N Broadway, Pittsburg, KS

Global Positioning Systems (GPS) information: Latitude: 37.42361 (in decimal degrees) Longitude: 94.70529 (in decimal degrees) Elevation: NA Horizontal Datum [X] WGS84, [] NAD83, [] NAD27 Collection Method: [] GPS unit (Make/model: Digital Map/Photo, [] Topographic Map, [] Land Survey Est. Accuracy: [] <3 m, [] 3-5 m, [] 5-15 m, [] >15 m

2 WATER WELL OWNER: Pete's Corporation RR#, St. Address, Box #: 1712 Broadway City, State ZIP Code: Parsons KS 67357

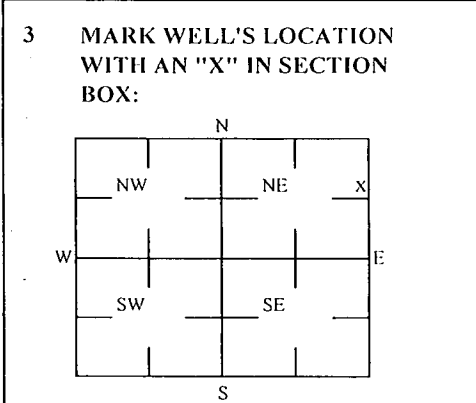

4 DEPTH OF WELL 19 ft. WELL'S STATIC WATER LEVEL NA ft. WELL WAS USED AS: [] Domestic [] Irrigation [] Feedlot [] Industrial [] Public Water Supply [] Oil Field Water Supply [] Domestic (Lawn & Garden) [] Air Conditioning [] Dewatering [X] Monitoring [] Injection Well [] Other Was a chemical/bacteriological sample submitted to Department? Yes [] No [X]

5 TYPE OF BLANK CASING USED: [] Steel [X] PVC [] RMP (SR) [] ABS [] Wrought [] Asbestos-Cement [] Fiberglass [] Concrete Tile [] Other (Specific below) Blank casing diameter 2 in. Was casing pulled? Yes [X] No [] If yes, how much 3' Casing height above or below land surface NA in.

6 GROUT PLUG MATERIAL: [] Neat cement [] Cement grout [X] Bentonite [X] Other Concrete: 0-0.5'; Soil: 0.5-3' Grout Plug Intervals: From 3 ft to 19 ft, From ft to ft, From ft to ft. What is the nearest source of possible contamination: [] Septic tank [] Sewer lines [] Watertight sewer lines [] Lateral lines [] Cess pool [] Seepage pit [] Pit privy [] Sewage lagoon [] Feed yard [] Livestock pens [X] Fuel storage [] Fertilizer storage [] Insecticide storage [] Abandoned water well [] Oil well/Gas well [] Other (specify below) Direction from well? How many feet?

Table with columns FROM, TO, PLUGGING MATERIALS. Rows: 0-0.5 Concrete, 0.5-3 Soil, 3-19 Bentonite. KDHE ID: Short Stop; U3-019-13788/14228

7 CONTRACTOR'S OR LANDOWNER'S CERTIFICATION: This water well was plugged under my jurisdiction and was completed on (mo/day/year) 5/18-19/20 and this record is true to the best of my knowledge and belief. Kansas Water Contractor's License No. 757. This Water Well Record was completed on (mo/day/year) 6/2/2020 under the business name of Larsen & Associates, Inc. By (signature)

Send one white copy to Kansas Department of Health & Environment, Geology Section, 1001 SW Jackson Street, Ste. 420, Topeka, KS 66612-1367. Send one copy to WATER WELL OWNER and retain one for your records. Visit us at http://www.kdheks.gov/waterwell/index.html Telephone 785-296-5524.

NOTE: Figures exhibited within this report are only to be used within the context of this report. Placement of property lines, wells, structures, and roads is based on the available information from county appraiser maps, surveys, site visits, and/or previous vendor reports and should be considered approximate.

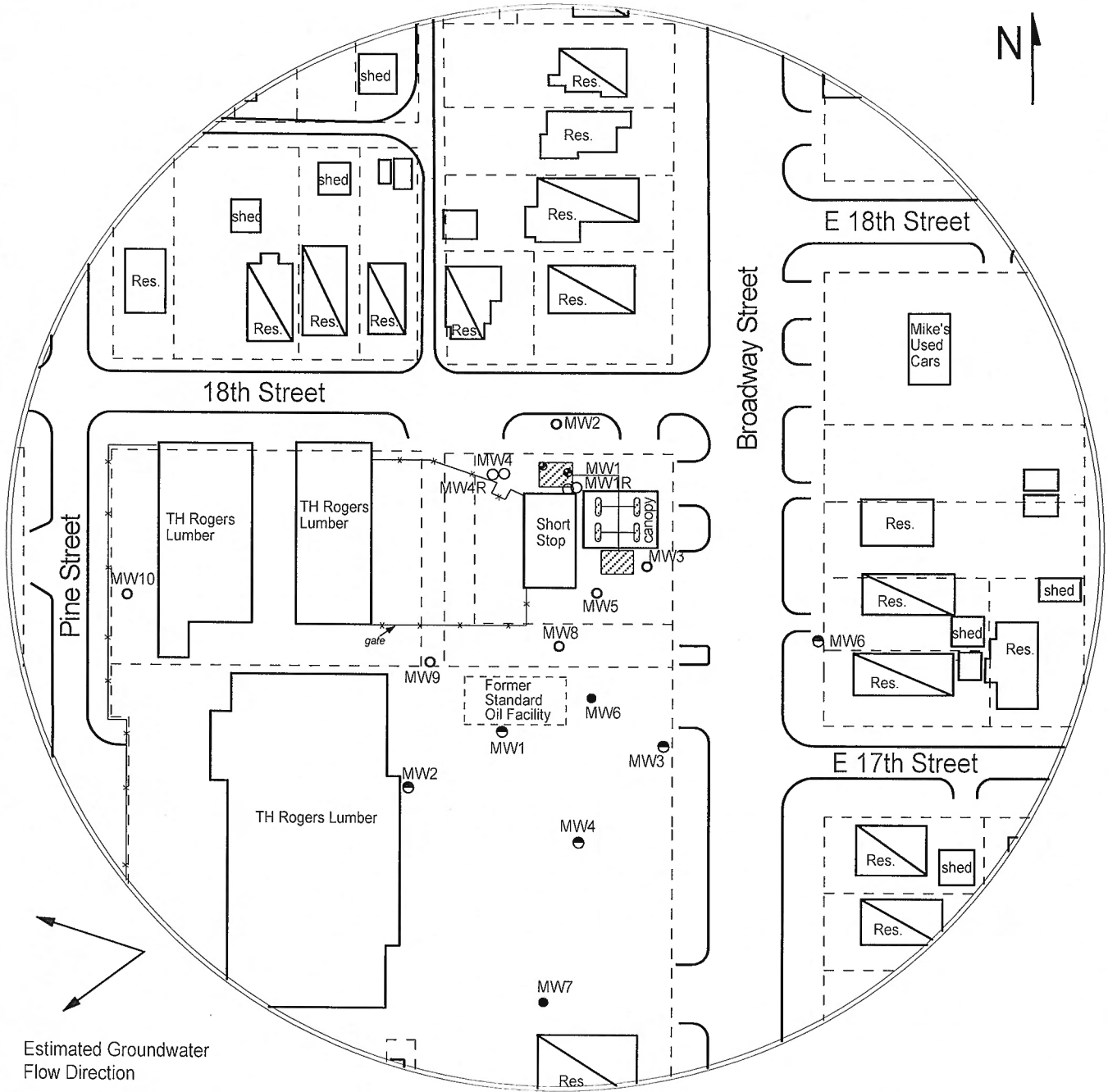
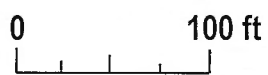

FIGURE 1 - 350 FT RADIUS AREA BASE MAP

- LEGEND:**
- Approximate Location of Active UST Basin, Product Lines & Pump Islands
 - Building with Basement
 - Approximate Location of Property Line
 - Existing Monitoring Well
 - Former Standard Oil Wells(U3-019-14985)
 - Observation Well
 - Plugged/Destroyed Well



PROJECT:
 Short Stop
 1711 N. Broadway
 Pittsburg, KS
 KDHE ID: U3-019-13788/
 14228
 Date: 5/18-19/20



1311 E 25th St. Suite B 785-841-8707 office
 Lawrence, KS 66046 785-865-4282 fax