

WATER WELL PLUGGING RECORD

Form WWC-5P

KSA 82a-1212

ID NO.

MW5

1 LOCATION OF WATER WELL: County: Crawford		Fraction SE ¼ NE ¼ NE ¼	Section Number 19	Township Number T 30 S	Range Number 25 <input checked="" type="checkbox"/> E <input type="checkbox"/> W																																																												
Street/Rural Address of Well Location: if unknown, distance & direction from nearest town or intersection: If at owner's address, check here <input type="checkbox"/> 1711 N Broadway, Pittsburg, KS			Global Positioning Systems (GPS) information: Latitude: NA (in decimal degrees) Longitude: NA (in decimal degrees) Elevation: NA Horizontal Datum <input type="checkbox"/> WGS84, <input type="checkbox"/> NAD83, <input type="checkbox"/> NAD27 Collection Method: <input type="checkbox"/> GPS unit (Make/model: _____) <input type="checkbox"/> Digital Map/Photo, <input type="checkbox"/> Topographic Map <input type="checkbox"/> Land Survey Est. Accuracy: <input type="checkbox"/> <3 m, <input type="checkbox"/> 3-5 m, <input type="checkbox"/> 5-15 m, <input type="checkbox"/> >15 m																																																														
2 WATER WELL OWNER: RR#, St. Address, Box #: Short Stop City, State ZIP Code: 1711 Broadway Pittsburg, KS 66762																																																																	
3 MARK WELL'S LOCATION WITH AN "X" IN SECTION BOX: <div style="text-align: center;"> </div>		4 DEPTH OF WELL 21.5 ft. WELL'S STATIC WATER LEVEL NA ft WELL WAS USED AS: <div style="display: flex; justify-content: space-between;"> <div> <input type="checkbox"/> Domestic <input type="checkbox"/> Irrigation <input type="checkbox"/> Feedlot <input type="checkbox"/> Industrial </div> <div> <input type="checkbox"/> Public Water Supply <input type="checkbox"/> Oil Field Water Supply <input type="checkbox"/> Domestic (Lawn & Garden) <input type="checkbox"/> Air Conditioning </div> <div> <input type="checkbox"/> Dewatering <input checked="" type="checkbox"/> Monitoring <input type="checkbox"/> Injection Well <input type="checkbox"/> Other _____ </div> </div> Was a chemical/bacteriological sample submitted to Department? Yes <input type="checkbox"/> No <input checked="" type="checkbox"/>																																																															
5 TYPE OF BLANK CASING USED: <div style="display: flex; justify-content: space-between;"> <div> <input type="checkbox"/> Steel <input checked="" type="checkbox"/> PVC </div> <div> <input type="checkbox"/> RMP (SR) <input type="checkbox"/> ABS </div> <div> <input type="checkbox"/> Wrought <input type="checkbox"/> Asbestos-Cement </div> <div> <input type="checkbox"/> Fiberglass <input type="checkbox"/> Concrete Tile </div> <div> <input type="checkbox"/> Other (Specific below) _____ </div> </div> Blank casing diameter 2 in. Was casing pulled? Yes <input checked="" type="checkbox"/> No <input type="checkbox"/> If yes, how much 3' Casing height above or below land surface NA in.																																																																	
6 GROUT PLUG MATERIAL: <input type="checkbox"/> Neat cement <input type="checkbox"/> Cement grout <input checked="" type="checkbox"/> Bentonite <input checked="" type="checkbox"/> Other Concrete: 0-0.5'; Soil: 0.5-3' Grout Plug Intervals: From 3 ft to 21.5 ft, From _____ ft to _____ ft, From _____ ft to _____ ft What is the nearest source of possible contamination: <div style="display: flex; justify-content: space-between;"> <div> <input type="checkbox"/> Septic tank <input type="checkbox"/> Sewer lines <input type="checkbox"/> Watertight sewer lines <input type="checkbox"/> Lateral lines <input type="checkbox"/> Cess pool </div> <div> <input type="checkbox"/> Seepage pit <input type="checkbox"/> Pit privy <input type="checkbox"/> Sewage lagoon <input type="checkbox"/> Feed yard <input type="checkbox"/> Livestock pens </div> <div> <input checked="" type="checkbox"/> Fuel storage <input type="checkbox"/> Fertilizer storage <input type="checkbox"/> Insecticide storage <input type="checkbox"/> Abandoned water well <input type="checkbox"/> Oil well/Gas well </div> <div> <input type="checkbox"/> Other (specify below) _____ Direction from well? _____ How many feet? _____ </div> </div> <table border="1" style="width:100%; border-collapse: collapse; margin-top: 10px;"> <thead> <tr> <th>FROM</th> <th>TO</th> <th>PLUGGING MATERIALS</th> <th>FROM</th> <th>TO</th> <th>PLUGGING MATERIALS</th> </tr> </thead> <tbody> <tr> <td>0</td> <td>0.5</td> <td>Concrete</td> <td></td> <td></td> <td></td> </tr> <tr> <td>0.5</td> <td>3</td> <td>Soil</td> <td></td> <td></td> <td></td> </tr> <tr> <td>3</td> <td>21.5</td> <td>Bentonite</td> <td></td> <td></td> <td></td> </tr> <tr> <td></td> <td></td> <td></td> <td></td> <td></td> <td></td> </tr> <tr> <td></td> <td></td> <td></td> <td></td> <td></td> <td></td> </tr> <tr> <td></td> <td></td> <td></td> <td></td> <td></td> <td></td> </tr> <tr> <td></td> <td></td> <td></td> <td></td> <td></td> <td></td> </tr> <tr> <td></td> <td></td> <td></td> <td></td> <td></td> <td></td> </tr> <tr> <td></td> <td></td> <td></td> <td></td> <td></td> <td></td> </tr> </tbody> </table>						FROM	TO	PLUGGING MATERIALS	FROM	TO	PLUGGING MATERIALS	0	0.5	Concrete				0.5	3	Soil				3	21.5	Bentonite																																							
FROM	TO	PLUGGING MATERIALS	FROM	TO	PLUGGING MATERIALS																																																												
0	0.5	Concrete																																																															
0.5	3	Soil																																																															
3	21.5	Bentonite																																																															
7 CONTRACTOR'S OR LANDOWNER'S CERTIFICATION: This water well was plugged under my jurisdiction and was completed on (mo/day/year) 5/18-19/20 and this record is true to the best of my knowledge and belief. Kansas Water Contractor's License No. 757. This Water Well Record was completed on (mo/day/year) 6/2/2020 under the business name of Larsen & Associates, Inc. By (signature) _____																																																																	

Send one white copy to Kansas Department of Health & Environment, Geology Section, 1000 SW Jackson Street, Ste. 420, Topeka, KS 66612-1367. Send one copy to WATER WELL OWNER and retain one for your records.
 Visit us at <http://www.kdheks.gov/waterwell/index.html> Telephone 785-296-5524.

KSA82a-1212

Revised 1/20/2015

Crawford

19-T30-R25E

NOTE: Figures exhibited within this report are only to be used within the context of this report. Placement of property lines, wells, structures, and roads is based on the available information from county appraiser maps, surveys, site visits, and/or previous vendor reports and should be considered approximate.

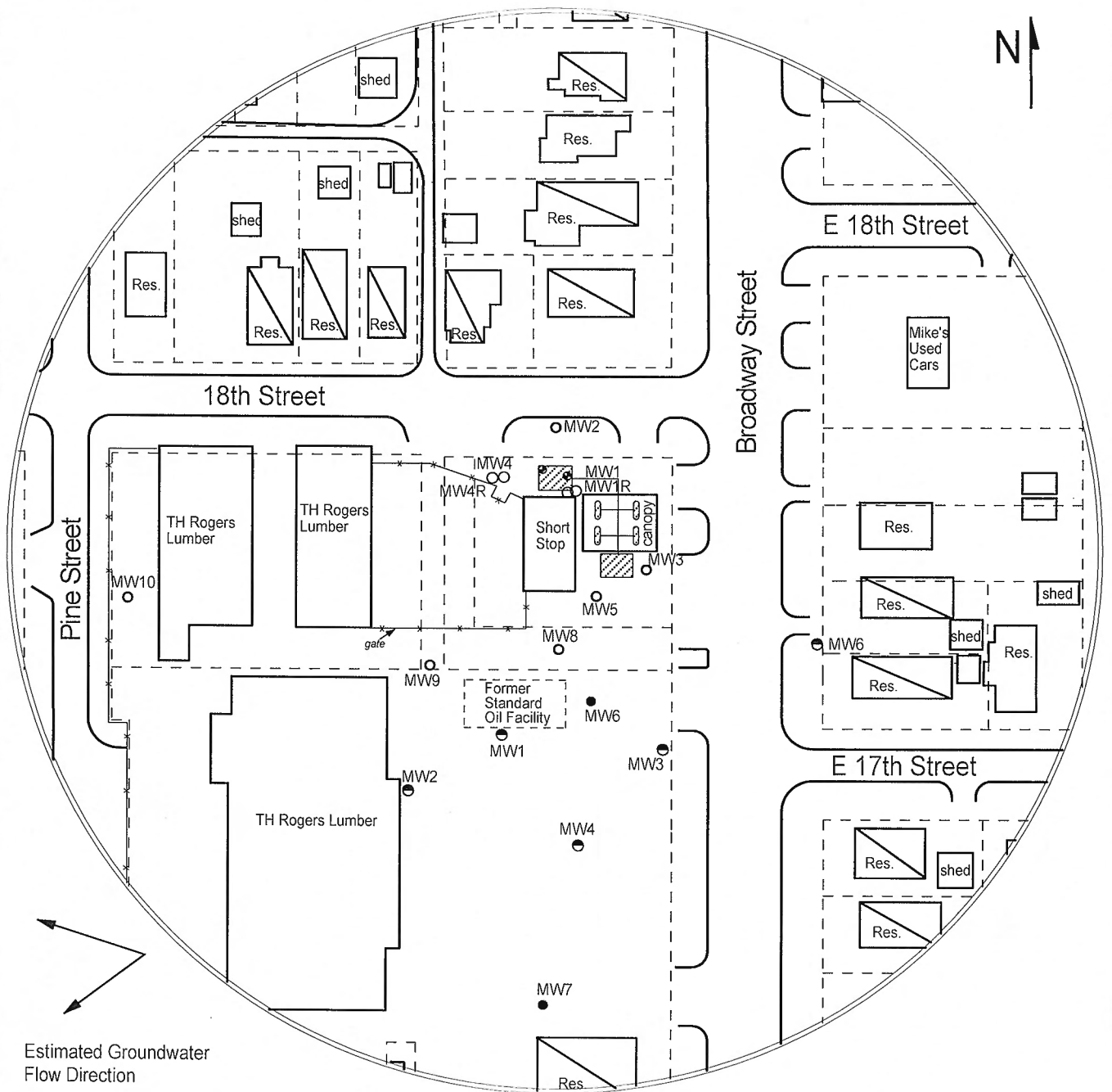

FIGURE 1 - 350 FT RADIUS AREA BASE MAP



1311 E 25th St. Suite B 785-841-8707 office
Lawrence, KS 66046 785-865-4282 fax

PROJECT:

Short Stop
1711 N. Broadway
Pittsburg, KS
KDHE ID: U3-019-13788/
14228

Date: 5/18-19/20

0 100 ft

LEGEND:

- Approximate Location of Active UST Basin, Product Lines & Pump Islands
- Building with Basement
- Approximate Location of Property Line
- Existing Monitoring Well
- Former Standard Oil Wells(U3-019-14985)
- Observation Well
- Plugged/Destroyed Well