

**1 LOCATION OF WATER WELL:** Fraction SW 1/4 SW 1/4 NW 1/4 Section Number 3 Township Number 32 Range Number 14  EW  
 County: Montgomery

Distance and direction from nearest town or city street address of well if located within city?  
Approximately 2 miles east of Elk City, KANSAS on CR 5250

**2 WATER WELL OWNER:** KEVIN DEWAYNE RUSSELL  
 RR#, St. Address, Box #: 5258 CR 2100  
 City, State ZIP Code: Elk City, KANSAS 67344

**Global Positioning Systems** (decimal degrees, min. of 4 digits)  
 Latitude: \_\_\_\_\_  
 Longitude: \_\_\_\_\_  
 Elevation: \_\_\_\_\_  
 Datum: \_\_\_\_\_  
 Data Collection Method: \_\_\_\_\_

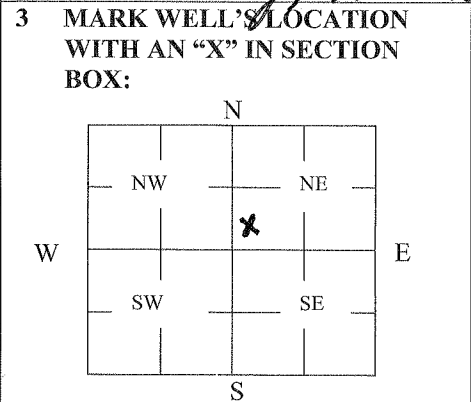

**4 DEPTH OF WELL** 21 ft.  
 WELL'S STATIC WATER LEVEL 4 ft.

WELL WAS USED AS:

<input checked="" type="radio"/> 1 Domestic	5 Public Water Supply	9 Dewatering
2 Irrigation	6 Oil Field Water Supply	10 Monitoring
3 Feedlot	7 Domestic (Lawn & Garden)	11 Injection Well
4 Industrial	8 Air Conditioning	12 Other _____

Was a chemical/bacteriological sample submitted to Department? Yes \_\_\_\_\_ No

**5 TYPE OF BLANK CASING USED:**

1 Steel	3 RMP (SR)	5 Wrought	7 Fiberglass	<input checked="" type="radio"/> 9 Other (Specify below)
2 PVC	4 ABS	6 Asbestos-Cement	8 Concrete Tile	<u>HAND DUG</u>

Blank casing diameter N/A in. Was casing pulled? Yes \_\_\_\_\_ No \_\_\_\_\_ If yes, how much \_\_\_\_\_  
 Casing height above or below land surface \_\_\_\_\_ in.

**6 GROUT PLUG MATERIAL:**  1 Neat cement    2 Cement grout    3 Bentonite    4 Other \_\_\_\_\_

Grout Plug Intervals: From 3 ft. to 2 ft., From \_\_\_\_\_ ft. to \_\_\_\_\_ ft., From \_\_\_\_\_ to \_\_\_\_\_ ft.

What is the nearest source of possible contamination:

<input checked="" type="radio"/> 1 Septic tank	6 Seepage pit	11 Fuel Storage	16 Other (specify below)
2 Sewer lines	7 Pit privy	12 Fertilizer storage	_____
3 Watertight sewer lines	8 Sewage lagoon	13 Insecticide storage	_____
4 Lateral lines	9 Feedyard	14 Abandoned water well	Direction from well? <u>SOUTH</u>
5 Cess pool	10 Livestock pens	15 Oil well/Gas well	How many feet? <u>250'</u>

FROM	TO	PLUGGING MATERIALS	FROM	TO	PLUGGING MATERIALS
21'	17'	CHLORINATED GRAVEL			
17'	3'	<del>CEMENT GROUT CLAY</del>			
3'	2'	<del>SOFT CEMENT GROUT</del>			
2'	0'	TOPSOIL			

**7 CONTRACTOR'S OR LANDOWNER'S CERTIFICATION:** This water well was plugged under my jurisdiction and was completed on (mo/day/year) AUGUST 15, 2010 and this record is true to the best of my knowledge and belief. Kansas Water Well Contractor's License No. \_\_\_\_\_ This Water Well Record was completed on (mo/day/year) 8/15/10 under the business name of KEVIN DEWAYNE RUSSELL - OWNER (signature). Kevin Russell

**INSTRUCTIONS:** Use typewriter or ballpoint pen. Please press firmly and print clearly. Please fill in blanks, underline or circle the correct answers. Send top three copies to Kansas Department of Health and Environment, Bureau of Water, Geology Section, 1000 SW Jackson St., Ste. 420, Topeka, Kansas 66612-1367. Telephone: 785/296-5522. Send one to Water Well Owner and retain one for your records. Visit us at <http://www.kdheks.gov/geo/waterwells>.