

WATER WELL RECORD

Form WWC-5

Revised

Division of Water Resources App. No.

Well ID

MW9

Original Record Correction Change in Well Ust

1 LOCATION OF WATER WELL: County Montgomery Fraction SW 1/4 NE 1/4 NE 1/4 NE 1/4 Section Number 35 Township Number T 32 S Range Number R 15 E

2 WELL OWNER: Last Name: Business: Sunshine Fuels LLC Address: 95 N. County Rd City: Palm Beach State: FL ZIP: 33480 Street or Rural Address where well is located (if unknown, distance and direction from nearest town or intersection): If at owner's address, check here: -40'W of 100 N 25th St., Independence, KS

3 LOCATE WELL WITH "X" IN SECTION BOX: N NW NE SW SE S

4 DEPTH OF COMPLETED WELL: 8 ft Depth(s) Groundwater Encountered: 1) ft 2) ft 3) ft, or 4) Dry Well WELL'S STATIC WATER LEVEL: NA ft below land surface, measured on (mo-day-yr) NA above land surface, measured on (mo-day-yr) Pump test data: Well water was ft after hours pumping gpm Water well was ft after hours pumping gpm Estimated Yield: gpm Bore Hole Diameter: 7.25 in to ft, and in to ft

5 Latitude: 37.22379 (decimal degrees) Longitude: 95.73015 (decimal degrees) Horizontal Datum: X WGS 84 NAD 83 NAD 27 Source for Latitude/Longitude: GPS (unit make/model:) (WAAS enabled? Yes No) X Land Survey Topographic Map Online Mapper 6 Elevation: 788.69 ft Ground Level: X TOC Source: X Land Survey GPS Topographic Map Other

7 WELL WATER TO BE USED AS: 1 Domestic: Household Lawn & Garden Livestock Irrigation Feedlot Industrial 2 Public Water Supply: well ID Dewatering: how many wells? Aquifer Recharge: well ID Monitoring: well ID MW9 Environmental Remediation: well ID Air Sparge Soil Vapor Extractor Recovery Injection 10 Oil Field Water Supply: lease 11 Test Hole: well ID Cased Uncased Geotechnical 12 Geothermal: How many bores? a) Closed Loop Horizontal Vertical b) Open Loop Surface Discharge Inj. of Water Other (specify):

Was a chemical/bacteriological sample submitted to KDHE? Yes No If yes, date sample was submitted: Water well disinfected? Yes No

8 TYPE OF CASING USED: Steel PVC Other CASING JOINTS: Glued Clamped Welded Threaded Casing diameter 2 in. to 3 ft, Diameter in. to ft, Diameter in. to ft, Casing height above land surface -0.43 in. Weight lbs./ft. Well thickness or gauge No TYPE OF SCREEN OR PERFORATION MATERIAL: Steel Stainless Steel Fiberglass PVC Other (Specify) Brass Galvanized Steel Concrete tile None used (open hole) SCREEN OR PERFORATION OPENINGS ARE: Continuous Slot Mill Slot Gauze Wrapped Torch Cut Drilled Holes Other (Specify) Louvered Shutter Key Punched Wire Wrapped Saw Cut Nonc (Open Hole) SCREEN-PERFORATED INTERVALS: From 3 ft. to 8 ft, From ft. to ft, From ft. to ft, GRAVEL PACK INTERVALS: From 2 ft. to 8 ft, From ft. to ft, From ft. to ft,

9 GROUT MATERIAL: Neat cement Cement grout Bentonite Other Concrete: 0-0.5' Grout intervals: From 0.5 ft. to 2 ft, From ft. to ft, From ft. to ft,

Nearest source of possible contamination: Septic Tank Lateral Lines Pit Privy Livestock Pens Insecticide Storage Sewer Lines Cess Pool Sewage Lagoon Fuel Storage Abandoned Water Well Watertight Sewer Lines Sepage Pit Feedyard Fertilizer Storage Oil Well / Gas Well Other (Specify) Direction from well? Distance from well? ft

10 FROM TO LITHOLOGIC LOG FROM TO LITHO. LOG (cont.) or PLUGGING INTERVALS 0 0.5 Asphalt 0.5 2 Clay, with sand, and gravel 2 6 Clay, with fine to medium sand 6 7.5 Clay, with little silt and trace sand 7.5 8 Clay

Notes: KDHE ID: Conoco Food Store; U3-063-00554 Target of monitoring well is shallow groundwater, <20' of grout was installed at the direction of KDHE.

11 CONTRACTOR'S OR LANDOWNER'S CERTIFICATION: This water well was constructed, reconstructed, or plugged under my jurisdiction and was completed on (mo-day-year) 3/27/19 and this record is true to the best of my knowledge and belief. Kansas Water Well Contractor's License No 757 This Water Well Record was completed on (mo-day-year) 4/24/19 under the business name of Larsen & Associates, Inc. Signature

Mail 1 white copy along with a fee of \$5.00 for each constructed well to: Kansas Department of Health and Environment, Bureau of Water, PWS Section, 1000 SW Jackson St., Suite 420, Topeka, Kansas 66612-1367. Mail one to Water Well Owner and retain one for your records. Telephone 785-296-5524.

DENNIS L HANDKE

1820 NW 59th Terrace
TOPEKA, KANSAS 66618
785-286-4047 Home
785-217-5864 Cell

Lindsay James
Blackstone Environmental
16200 Foster Street
Overland Park, Kansas, 66085

April 12, 2019

RE: Monitor Well Elevation Survey
100 N.25th Street, Independence, Kansas

Proj. 19-000
Conoco Food Store
U3-063-00554

Bench Mark: Square cut on SW Corner of concrete sign base at the SW Corner of property.
Elev: 784.86 North 4565.50 West 178.76 (from SE Cor. Sec 35-32-15E)

| | | | | | |
|------|----------|--------|-------|---------|-------------------------------|
| MW-9 | rim | 789.12 | North | 4633.92 | SW1/4,NE1/4,NE1/4,NE1/4 |
| | top pipe | 788.69 | West | 358.04 | Lat= 37.22379 Long = 95.73015 |

Elevation derived from existing project.

Lat & Long derived from Independence 7.5 Quad Map. WGS 84

If you have any questions, please feel free to call me. Thank you for the opportunity to be of service to you.



RECEIVED
MAY 17 2019
BUREAU OF WATER

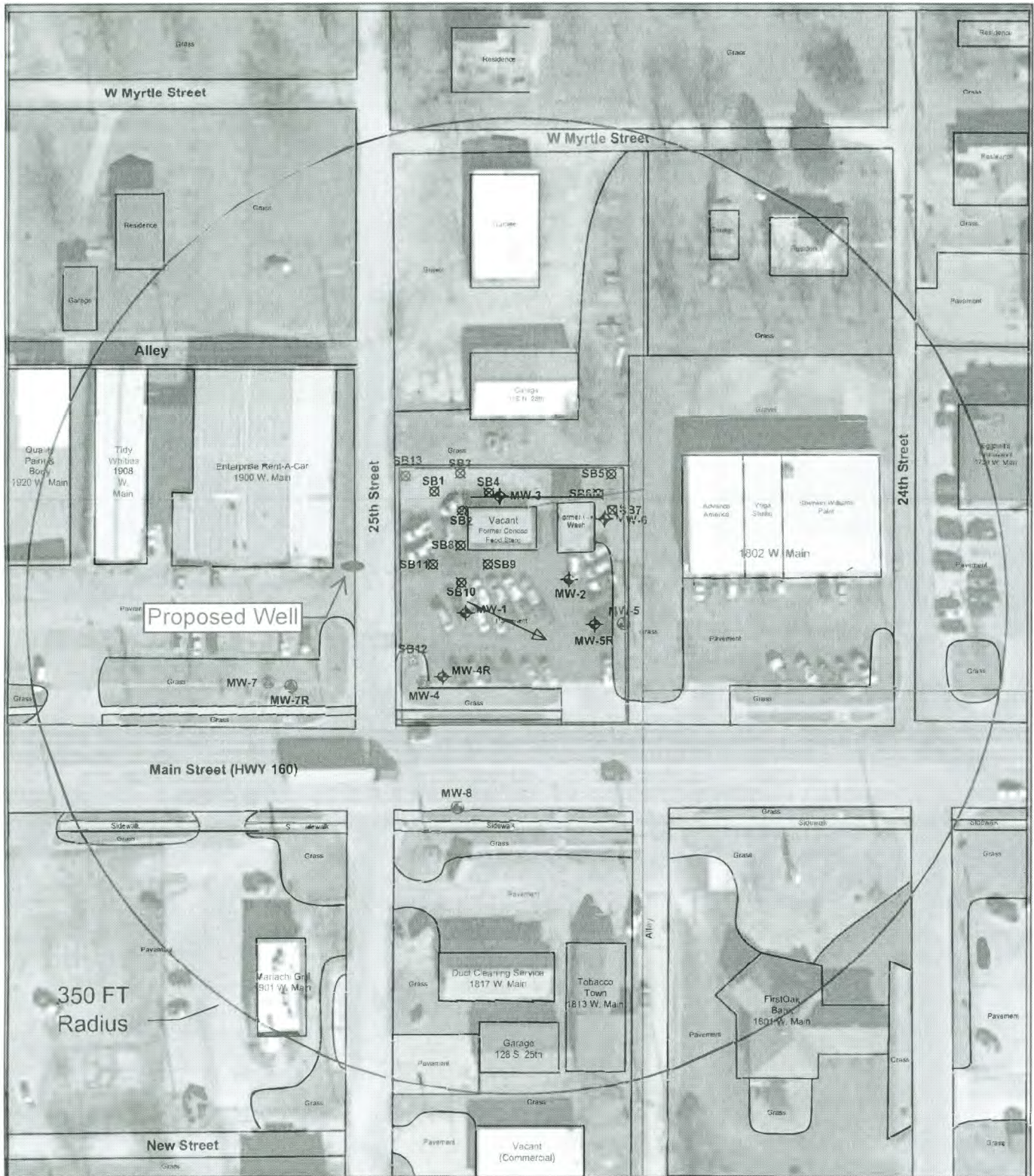

Information not available for former location of dispensers and/or product lines.

| | |
|--|----------------------------------|
| | UST - Removed |
| | Monitoring Well |
| | Gauge Only Well |
| | Destroyed Monitoring Well |
| | Site Property Boundary |
| | Geotech Boring Location |
| | Proposed Soil Boring Location |
| | Groundwater Flow Direction |
| | Overhead Electrical (10-12' ags) |

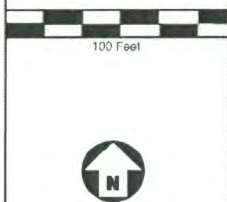

CLIENT: Conoco Food Store
 LOCATION: 100 N. 25th,
 Independence, KS
 KDHE Project Code No. : U3-063-00554
 Owner: Sunshine Fuels



Site Map 2.1

Detailed Site Map

April 2018