

WATER WELL RECORD Form WWC-5

Division of Water Resources App. No.

Well ID CMW-3

Original Record Correction Change in Well Use

1 LOCATION OF WATER WELL: County: Montgomery	Fraction NW ¼ SW ¼ NW ¼ NW ¼	Section Number 31	Township Number T 32 S	Range Number R 16 <input checked="" type="checkbox"/> E <input type="checkbox"/> W
---	--	-----------------------------	----------------------------------	--

2 WELL OWNER: Last Name: Western Plains Alliancef. LLC c/o KDHE Address: Curtis State Office Bldg Address: 1000 SW Jackson Str City: Topeka State: KS ZIP: 66612	First: Street or Rural Address where well is located (if unknown, distance and direction from nearest town or intersection): If at owner's address, check here: <input type="checkbox"/> 100 N. 10th St Independence KS
--	---

3 LOCATE WELL WITH "X" IN SECTION BOX: N W E S 1 mile	4 DEPTH OF COMPLETED WELL: 15 ft. Depth(s) Groundwater Encountered: 1) 6.4 ft. 2) ft. 3) ft., or 4) <input type="checkbox"/> Dry Well WELL'S STATIC WATER LEVEL: 4.84 ft. <input checked="" type="checkbox"/> below land surface, measured on (mo-day-yr) 02/13/2019 <input type="checkbox"/> above land surface, measured on (mo-day-yr) / / Pump test data: Well water was ft. after hours pumping gpm Well water was ft. after hours pumping gpm Estimated Yield: gpm Bore Hole Diameter: 6 in. to 15 ft. and in. to ft.	5 Latitude: 37.22346 (decimal degrees) Longitude: 95.71047 (decimal degrees) Datum: <input checked="" type="checkbox"/> WGS 84 <input type="checkbox"/> NAD 83 <input type="checkbox"/> NAD 27 Source for Latitude/Longitude: <input type="checkbox"/> GPS (unit make/model:) (WAAS enabled? <input type="checkbox"/> Yes <input type="checkbox"/> No) <input type="checkbox"/> Land Survey <input type="checkbox"/> Topographic Map <input type="checkbox"/> Online Mapper:
		6 Elevation: 800 ft. <input checked="" type="checkbox"/> Ground Level <input type="checkbox"/> TOC Source: <input type="checkbox"/> Land Survey <input type="checkbox"/> GPS <input type="checkbox"/> Topographic Map <input checked="" type="checkbox"/> Other KOLAR

7 WELL WATER TO BE USED AS:

1. Domestic: <input type="checkbox"/> Household <input type="checkbox"/> Lawn & Garden <input type="checkbox"/> Livestock	5. <input type="checkbox"/> Public Water Supply: well ID 6. <input type="checkbox"/> Dewatering: how many wells? 7. <input type="checkbox"/> Aquifer Recharge: well ID 8. <input checked="" type="checkbox"/> Monitoring: well ID CMW-3 9. Environmental Remediation: well ID <input type="checkbox"/> Air Sparge <input type="checkbox"/> Soil Vapor Extraction <input type="checkbox"/> Recovery <input type="checkbox"/> Injection	10. <input type="checkbox"/> Oil Field Water Supply: lease 11. Test Hole: well ID <input type="checkbox"/> Cased <input type="checkbox"/> Uncased <input type="checkbox"/> Geotechnical 12. Geothermal: how many bores? a) Closed Loop <input type="checkbox"/> Horizontal <input type="checkbox"/> Vertical b) Open Loop <input type="checkbox"/> Surface Discharge <input type="checkbox"/> Inj. of Water 13. <input type="checkbox"/> Other (specify):
--	--	---

Was a chemical/bacteriological sample submitted to KDHE? Yes No If yes, date sample was submitted:
Water well disinfected? Yes No

8 TYPE OF CASING USED: Steel PVC Other CASING JOINTS: Glued Clamped Welded Threaded
Casing diameter 2 in. to 15 ft., Diameter in. to ft., Diameter in. to ft.
Casing height above land surface 0 in. Weight lbs./ft. Wall thickness or gauge No. **SCH40**

TYPE OF SCREEN OR PERFORATION MATERIAL:
 Steel Stainless Steel Fiberglass PVC Other (Specify)
 Brass Galvanized Steel Concrete tile None used (open hole)

SCREEN OR PERFORATION OPENINGS ARE:
 Continuous Slot Mill Slot Gauze Wrapped Torch Cut Drilled Holes Other (Specify)
 Louvered Shutter Key Punched Wire Wrapped Saw Cut None (Open Hole)

SCREEN-PERFORATED INTERVALS: From 5 ft. to 15 ft., From ft. to ft., From ft. to ft.
GRAVEL PACK INTERVALS: From 4 ft. to 15 ft., From ft. to ft., From ft. to ft.

9 GROUT MATERIAL: Neat cement Cement grout Bentonite Other **Concrete**
Grout intervals: From 0 ft. to 1 ft., From 1 ft. to 4 ft., From ft. to ft.

Nearest source of possible contamination: No potential source of contamination within 200 ft.
 Septic Tank Lateral Lines Pit Privy Livestock Pens Insecticide Storage
 Sewer Lines Cess Pool Sewage Lagoon Fuel Storage Abandoned Water Well
 Watertight Sewer Lines Seepage Pit Feedyard Fertilizer Storage Oil Well/Gas Well
 Other (Specify) **Contaminated Site**
Direction from well? **All** Distance from well? 0 ft.

10 FROM	TO	LITHOLOGIC LOG	FROM	TO	LITHO. LOG (cont.) or PLUGGING INTERVALS
0	.5	Concrete			
.5	8	Clay			
8	13	Shale			
13	15	Limestone			
Notes:					

11 CONTRACTOR'S OR LANDOWNER'S CERTIFICATION: This water well was constructed, reconstructed, or plugged under my jurisdiction and was completed on (mo-day-year) 02/13/2019 and this record is true to the best of my knowledge and belief. Kansas Water Well Contractor's License No. 760. This Water Well Record was completed on (mo-day-year) 02/13/2019 under the business name of **Associated Drilling, Inc.**

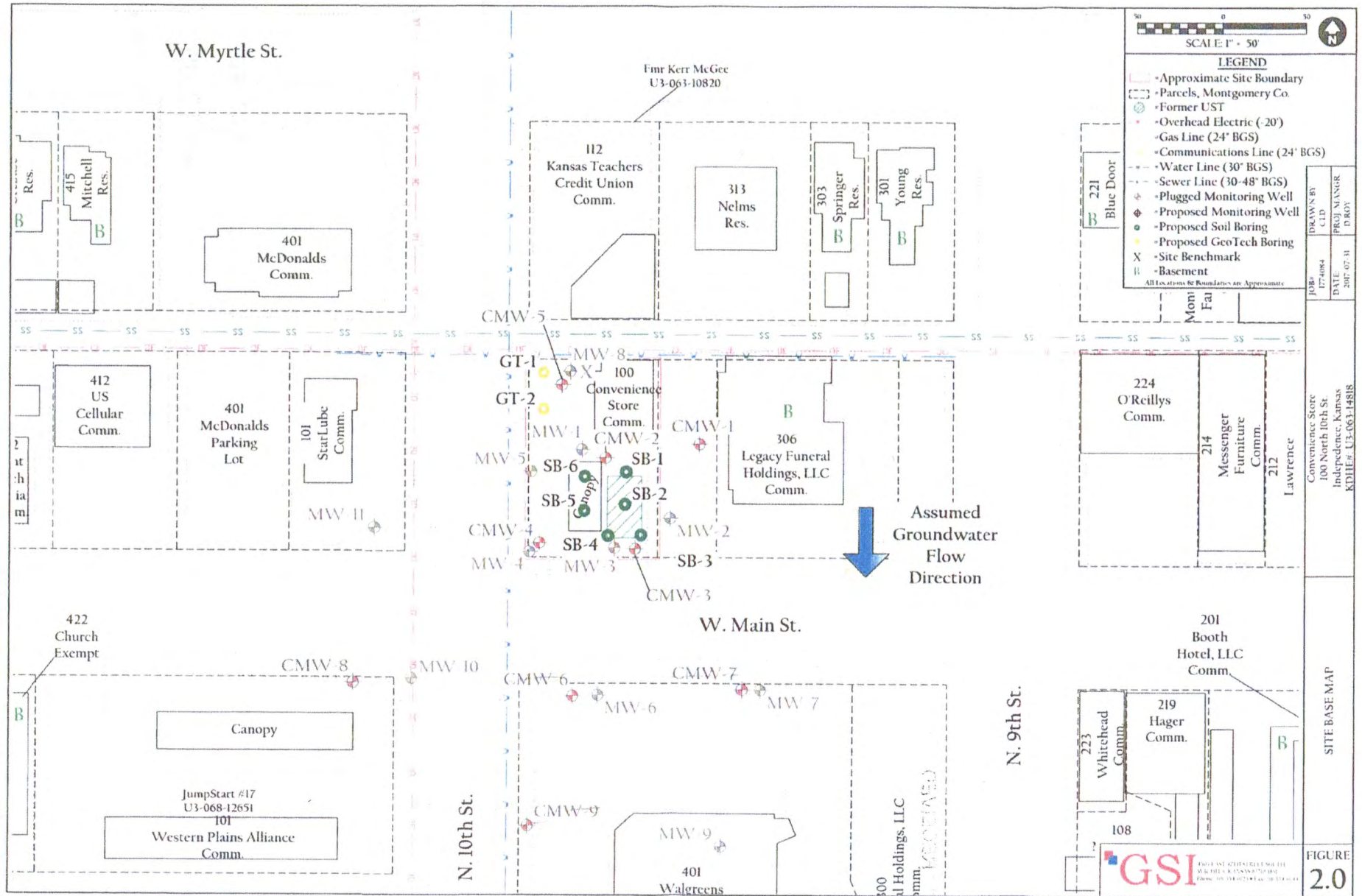

FIGURE 2.0

SITE BASE MAP