

WATER WELL RECORD

Form WWC-5

Division of Water Resources App. No.

48,657

1 LOCATION OF WATER WELL: County: Sumner	Fraction ¼ NE ¼ NE ¼ SE ¼	Section Number 27	Township No. T 32 S	Range Number R 2 <input checked="" type="checkbox"/> E <input type="checkbox"/> W
--	------------------------------	----------------------	------------------------	--

Street/Rural Address of Well Location; if unknown, distance & direction from nearest town or intersection: If at owner's address, check here .
E. 40th and N River Rd. HOLE #2 NORTHWEST

Global Positioning System (GPS) information:
Latitude: (in decimal degrees)
Longitude: (in decimal degrees)
Elevation:
Datum: WGS 84, NAD 83, NAD 27
Collection Method:
 GPS unit (Make/Model:)
 Digital Map/Photo, Topographic Map, Land Survey
Est. Accuracy: <3 m, 3-5 m, 5-15 m, >15 m

2 WATER WELL OWNER: Angela Irons
RR#, Street Address, Box #: 2420 Woodruff Rd
City, State, ZIP Code : Edmond, OK 73013

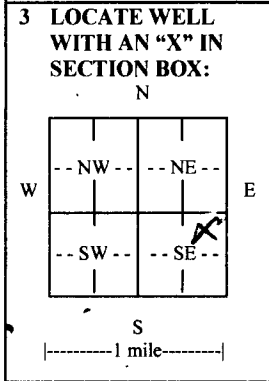

4 DEPTH OF COMPLETED WELL 55 ft.

Depth(s) Groundwater Encountered (1) 23 ft. (2) ft. (3) ft.
WELL'S STATIC WATER LEVEL 23 ft. below land surface measured on mo/day/yr.....
Pump test data: Well water was ft. after hours pumping gpm
EST. YIELD 350 gpm. Well water was ft. after hours pumping gpm
Bore Hole Diameter 30 in. to 55 ft., and in. to ft.
WELL WATER TO BE USED AS: Public water supply Geothermal Injection well
 Domestic Feedlot Oil field water supply Dewatering Other (Specify below)
 Irrigation Industrial Domestic-lawn & garden Monitoring well
Was a chemical/bacteriological sample submitted to Department? Yes No
If yes, mo/day/yr sample was submitted.....
Water well disinfected? Yes No

5 TYPE OF CASING USED: Steel PVC Other
CASING JOINTS: Glued Clamped Welded Threaded
Casing diameter 16 in. to 55 ft., Diameter in. to ft., Diameter in. to ft.
Casing height above land surface 12 in., Weight 16 lbs./ft., Wall thickness or gauge No. SCH40
TYPE OF SCREEN OR PERFORATION MATERIAL:
 Steel Stainless Steel PVC Other (Specify)
 Brass Galvanized Steel None used (open hole)
SCREEN OR PERFORATION OPENINGS ARE:
 Continuous slot Mill slot Gauze wrapped Torch cut Drilled holes None (open hole)
 Louvered shutter Key punched Wire wrapped Saw cut Other (specify)
SCREEN-PERFORATED INTERVALS: From 35 ft. to 55 ft., From ft. to ft.
From ft. to ft., From ft. to ft.
GRAVEL PACK INTERVALS: From 20 ft. to 55 ft., From ft. to ft.
From ft. to ft., From ft. to ft.

6 GROUT MATERIAL: Neat cement Cement grout Bentonite Other
Grout Intervals: From 3 ft. to 20 ft., From ft. to ft., From ft. to ft.
What is the nearest source of possible contamination:
 Septic tank Lateral lines Pit privy Livestock pens Insecticide storage Other (specify below)
 Sewer lines Cesspool Sewage lagoon Fuel storage Abandoned water well
 Watertight sewer lines Seepage pit Feedyard Fertilizer storage Oil well/gas well NONE-OPEN FIELD
Direction from well Distance from well

FROM	TO	LITHOLOGIC LOG	FROM	TO	LITHO. LOG (cont.) or PLUGGING INTERVALS
0	22	Clay			
22	51	Medium Sand to Coarse Sand			
51	55	Shale			

7 CONTRACTOR'S OR LANDOWNER'S CERTIFICATION: This water well was constructed, reconstructed, or plugged under my jurisdiction and was completed on (mo/day/year) 09/28/2015 and this record is true to the best of my knowledge and belief.
Kansas Water Well Contractor's License No. 238 This Water Well Record was completed on (mo/day/year) 09/30/2015 under the business name of Premier Pump & Well Service, Inc. by (signature) *Mansera H. H.*

INSTRUCTIONS: Use typewriter or ball point pen. PLEASE PRESS FIRMLY and PRINT clearly. Please fill in blanks and check the correct answers. Send one copy to Kansas Department of Health and Environment, Bureau of Water, Geology Section, 1000 SW Jackson St., Suite 420, Topeka, Kansas 66612-1367. Telephone 785-296-5524. Send one copy to WATER WELL OWNER and retain one for your records. Include fee of \$5.00 for each constructed well. Visit us at <http://www.kdheks.gov/waterwell/index.html>