

**WATER WELL RECORD**

**Form WWC-5**

Division of Water Resources App. No.  

<b>1 LOCATION OF WATER WELL:</b> County: <u>Cherokee</u> Street/Rural Address of Well Location; if unknown, distance & direction from nearest town or intersection: If at owner's address, check here <input checked="" type="checkbox"/>	Fraction <u>NE 1/4 Sec 4 1/4</u>	Section Number <u>21</u>	Township No. <u>T 32 S</u>	Range Number <u>R 22 E</u>
Attached Map		<b>Global Positioning System (GPS) information:</b> Latitude: <u>37.1438</u> (in decimal degrees) Longitude: <u>95.021</u> (in decimal degrees) Elevation: <u>819</u> Datum: <input type="checkbox"/> WGS 84, <input checked="" type="checkbox"/> NAD 83, <input type="checkbox"/> NAD 27 Collection Method: <input type="checkbox"/> GPS unit (Make/Model: .....) <input checked="" type="checkbox"/> Digital Map/Photo, <input type="checkbox"/> Topographic Map, <input type="checkbox"/> Land Survey Est. Accuracy: <input type="checkbox"/> <3 m, <input checked="" type="checkbox"/> 3-5 m, <input type="checkbox"/> 5-15 m, <input type="checkbox"/> >15 m		
<b>2 WATER WELL OWNER:</b> RR#, Street Address, Box #: <u>RR3</u> City, State, ZIP Code: <u>Columbus, KS 66225</u>				

<b>3 LOCATE WELL WITH AN "X" IN SECTION BOX:</b> N <table style="width: 100%; text-align: center; border-collapse: collapse;"> <tr> <td style="border: 1px solid black; width: 25px; height: 25px;">NW</td> <td style="border: 1px solid black; width: 25px; height: 25px;">NE</td> </tr> <tr> <td style="border: 1px solid black; width: 25px; height: 25px;">SW</td> <td style="border: 1px solid black; width: 25px; height: 25px;">SE</td> </tr> </table> S  -----1 mile-----	NW	NE	SW	SE	<b>4 DEPTH OF COMPLETED WELL</b> <u>60.4</u> ft. Depth(s) Groundwater Encountered (1)..... <u>7</u> ..... ft. (2)..... ft. (3)..... ft. WELL'S STATIC WATER LEVEL.....ft. below land surface measured on mo/day/yr..... Pump test data: Well water was.....ft. after..... hours pumping..... gpm EST. YIELD.....gpm. Well water was.....ft. after..... hours pumping..... gpm Bore Hole Diameter <u>2.5</u> in. to <u>60.4</u> ft., and .....in. to .....ft. WELL WATER TO BE USED AS: <input type="checkbox"/> Public water supply <input type="checkbox"/> Geothermal <input type="checkbox"/> Injection well <input type="checkbox"/> Domestic <input type="checkbox"/> Feedlot <input type="checkbox"/> Oil field water supply <input type="checkbox"/> Dewatering <input type="checkbox"/> Other (Specify below) <input type="checkbox"/> Irrigation <input type="checkbox"/> Industrial <input type="checkbox"/> Domestic-lawn & garden <input type="checkbox"/> Monitoring well <u>GWCA</u> Was a chemical/bacteriological sample submitted to Department? <input type="checkbox"/> Yes <input checked="" type="checkbox"/> No <u>picover</u> If yes, mo/day/yr sample was submitted..... Water well disinfected? <input type="checkbox"/> Yes <input checked="" type="checkbox"/> No
NW	NE				
SW	SE				

**5 TYPE OF CASING USED:**  Steel  PVC  Other .....

CASING JOINTS:  Glued  Clamped  Welded  Threaded

Casing diameter 1 in. to 50.4 ft., Diameter ..... in. to ..... ft., Diameter ..... in. to ..... ft.  
 Casing height above land surface 36 in., Weight .....lbs./ft., Wall thickness or gauge No. sch 40

TYPE OF SCREEN OR PERFORATION MATERIAL:  
 Steel  Stainless Steel  PVC  Other (Specify) .....  
 Brass  Galvanized Steel  None used (open hole)

SCREEN OR PERFORATION OPENINGS ARE:  
 Continuous slot  Mill slot  Gauze wrapped  Torch cut  Drilled holes  None (open hole)  
 Louvered shutter  Key punched  Wire wrapped  Saw cut  Other (specify) .....

SCREEN-PERFORATED INTERVALS: From 60.4 ft. to 50.4 ft., From ..... ft. to ..... ft.  
 From ..... ft. to ..... ft., From ..... ft. to ..... ft.

GRAVEL PACK INTERVALS: From 60.4 ft. to 47 ft., From ..... ft. to ..... ft.  
 From ..... ft. to ..... ft., From ..... ft. to ..... ft.

**6 GROUT MATERIAL:**  Neat cement  Cement grout  Bentonite  Other .....

Grout Intervals: From 47 ft. to 1 ft., From ..... ft. to ..... ft., From ..... ft. to ..... ft.

What is the nearest source of possible contamination:  
 Septic tank  Lateral lines  Pit privy  Livestock pens  Insecticide storage  Other (specify below)  
 Sewer lines  Cesspool  Sewage lagoon  Fuel storage  Abandoned water well  
 Watertight sewer lines  Seepage pit  Feedyard  Fertilizer storage  Oil well/gas well coal mine

Direction from well ..... Distance from well .....

FROM	TO	LITHOLOGIC LOG	FROM	TO	LITHO. LOG (cont.) or PLUGGING INTERVALS
0	8	Grn Clay			
8	11	Tan L.S			
11	20.3	Gray Shale			
20.3	21.1	Coal			
21.1	46.7	Gray Shale			
46.7	47	Coal			
47	55.3	Gray Shale			
55.3	56.8	Coal			
56.8	59.2	Gray Shale			
59.2	60.4	Gray L.S			

**7 CONTRACTOR'S OR LANDOWNER'S CERTIFICATION:** This water well was  constructed,  reconstructed, or  plugged under my jurisdiction and was completed on (mo/day/year) 7-15-11 and this record is true to the best of my knowledge and belief. Kansas Water Well Contractor's License No. 709 This Water Well Record was completed on (mo/day/year) 2-1-12 under the business name of MAX'S by (signature) Daniel Karpman

**INSTRUCTIONS:** Use typewriter or ball point pen. PLEASE PRESS FIRMLY and PRINT clearly. Please fill in blanks and check the correct answers. Send three copies (white, blue, pink) to Kansas Department of Health and Environment, Bureau of Water, Geology Section, 1000 SW Jackson St., Suite 420, Topeka, Kansas 66612-1367. Telephone 785-296-5524. Send one copy to WATER WELL OWNER and retain one for your records. Include fee of \$5.00 for each constructed well. Visit us at <http://www.kdheks.gov/waterwell/index.html>.

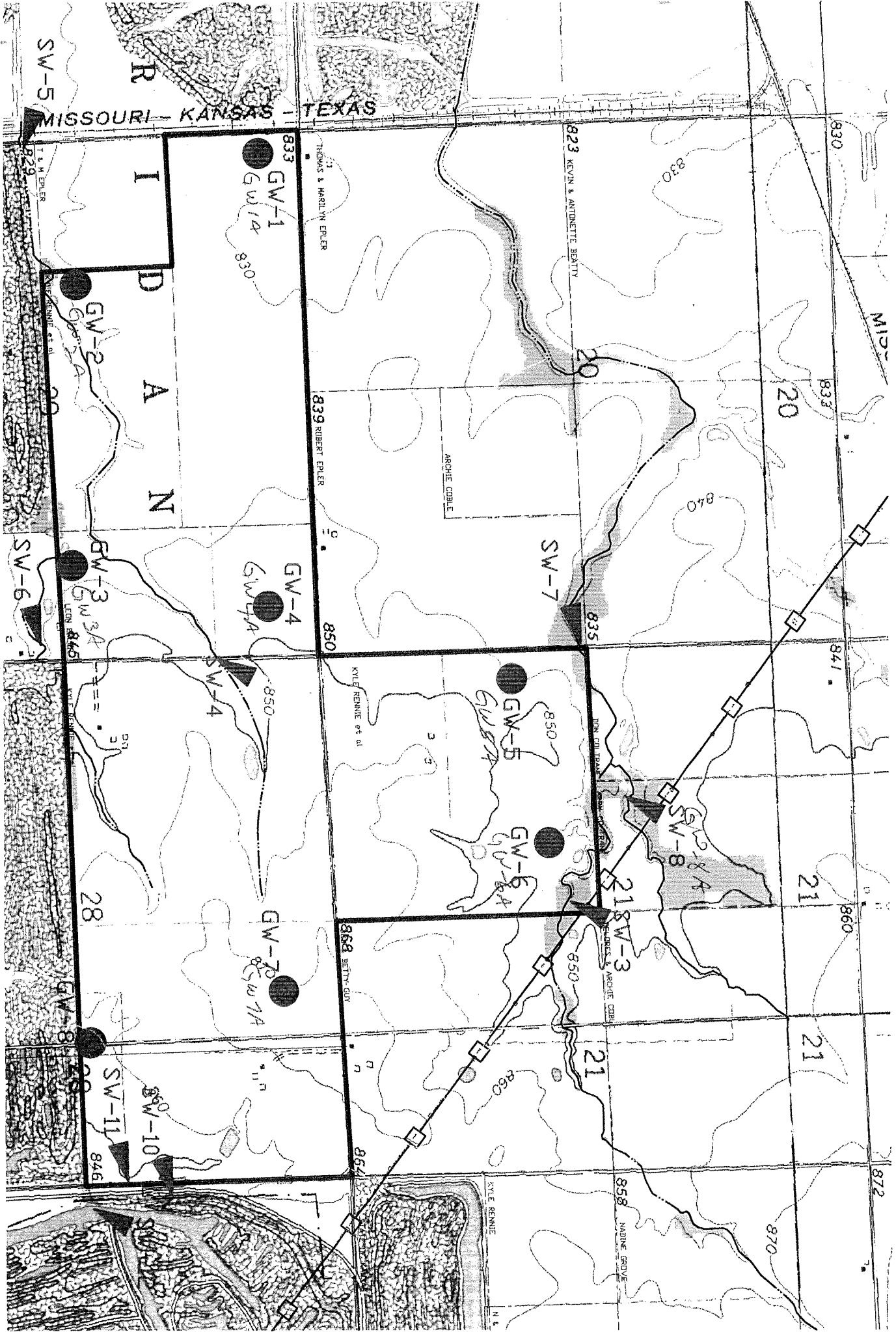

MISSOURI - KANSAS - TEXAS

833  
GW-1  
GW 1A

THOMAS & MARILYN EPLER

I  
D  
A  
N

GW-2

GW-3

GW 3A

SW-6

GW-4

GW 4A

SW-4

SW-7

GW-5

GW 5A

GW-6

GW 6A

GW-8

GW 8A

SW-3

GW-7

GW 7A

GW-8

GW 8A

SW-11

SW-10

823 KEVIN & ANTONETTE BEATTY

839 ROBERT EPLER

ARCHIE COBLE

850

KYLE RENNIE est of

NON COIL SPAN

ARCHIE COBLE

868 BETTY GUY

KYLE RENNIE

858 MADINE GROVE

830

833

841

860

870

872

829 T.M. EPLER

845 LENA

828

846

830

833

841

860

870

872

MID

21

21

21

21

21

21

21

21

21

21

21

21

21

21

21

21

21

21

21

21

21

21

21

21

21

21

21

21

21

21

21

21

21

21

21

21

21

21

21

21

21

21

21

21

21

21

21

21

21

21

21

21

21

21

21

21

21

21

21

21

21

21

21

21

21

21

21

21

21

21

21

21

21

21

21

21

21

21

21

21

21