

GW5

WATER WELL RECORD

Form WWC-5

Division of Water Resources App. No.

1 LOCATION OF WATER WELL: Fraction NW 1/4 Sec 21 Section Number 21 Township No. T 32 S Range Number R 22 E W
 County: Cherokee
 Street/Rural Address of Well Location; if unknown, distance & direction from nearest town or intersection: If at owner's address, check here Attached Map
2 WATER WELL OWNER: Kyle Remes
 RR#, Street Address, Box #: RR3
 City, State, ZIP Code: Columbus, Ks 66725
Global Positioning System (GPS) information:
 Latitude: 37° 19' 40.3" (in decimal degrees)
 Longitude: 95° 0' 46.5" (in decimal degrees)
 Elevation: 838
 Datum: WGS 84, NAD 83, NAD 27
Collection Method:
 GPS unit (Make/Model:)
 Digital Map/Photo, Topographic Map, Land Survey
 Est. Accuracy: <3 m, 3-5 m, 5-15 m, >15 m

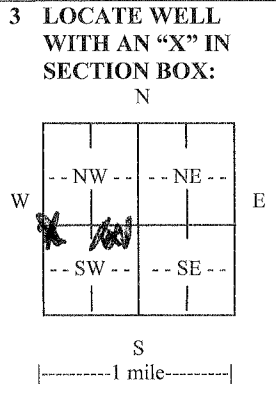

4 DEPTH OF COMPLETED WELL 50'7" ft.
 Depth(s) Groundwater Encountered (1) 13" ft. (2)..... ft. (3)..... ft.
 WELL'S STATIC WATER LEVEL..... ft. below land surface measured on mo/day/yr.....
 Pump test data: Well water was.....ft. after..... hours pumping..... gpm
 EST. YIELD.....gpm. Well water was.....ft. after..... hours pumping..... gpm
 Bore Hole Diameter 6.24 in. to 50.7 ft., andin. toft.
 WELL WATER TO BE USED AS: Public water supply Geothermal Injection well
 Domestic Feedlot Oil field water supply Dewatering Other (Specify below)
 Irrigation Industrial Domestic-lawn & garden Monitoring well GW5
 Was a chemical/bacteriological sample submitted to Department? Yes No
 If yes, mo/day/yr sample was submitted.....
 Water well disinfected? Yes No

5 TYPE OF CASING USED: Steel PVC Other
 CASING JOINTS: Glued Clamped Welded Threaded
 Casing diameter 2 in. to 43.7 ft., Diameter in. to ft., Diameter in. to ft.
 Casing height above land surface 36 in., Weightlbs./ft., Wall thickness or gauge No.
TYPE OF SCREEN OR PERFORATION MATERIAL:
 Steel Stainless Steel PVC Other (Specify)
 Brass Galvanized Steel None used (open hole)
SCREEN OR PERFORATION OPENINGS ARE:
 Continuous slot Mill slot Gauze wrapped Torch cut Drilled holes None (open hole)
 Louvered shutter Key punched Wire wrapped Saw cut Other (specify)
SCREEN-PERFORATED INTERVALS: From 50'7" ft. to 40'7" ft., From ft. to ft.
 From ft. to ft., From ft. to ft.
GRAVEL PACK INTERVALS: From 50'7" ft. to 42 ft., From ft. to ft.
 From ft. to ft., From ft. to ft.

6 GROUT MATERIAL: Neat cement Cement grout Bentonite Other
 Grout Intervals: From 42 ft. to 1 ft., From ft. to ft., From ft. to ft.
 What is the nearest source of possible contamination:
 Septic tank Lateral lines Pit privy Livestock pens Insecticide storage Other (specify below)
 Sewer lines Cesspool Sewage lagoon Fuel storage Abandoned water well COAL mine
 Watertight sewer lines Seepage pit Feedyard Fertilizer storage Oil well/gas well
 Direction from well Distance from well

FROM	TO	LITHOLOGIC LOG	FROM	TO	LITHO. LOG (cont.) or PLUGGING INTERVALS
0	13'3"	B'n Clay			
13'3"	19'3"	Gray Shale			
19'3"	19'9"	Coal			
19'9"	31'1"	Gray Fireclay			
31'1"	35'1"	Gray Shale			
35'1"	36'7"	Gray L.S			
36'7"	45'9"	Gray Shale			
45'9"	47'5"	Coal			
47'5"	50'7"	Gray Shale			

7 CONTRACTOR'S OR LANDOWNER'S CERTIFICATION: This water well was constructed, reconstructed, or plugged under my jurisdiction and was completed on (mo/day/year) 1-14-10 and this record is true to the best of my knowledge and belief.
 Kansas Water Well Contractor's License No. 704 This Water Well Record was completed on (mo/day/year) 2-1-12
 under the business name of MAXS by (signature) David Dwyer

INSTRUCTIONS: Use typewriter or ball point pen. PLEASE PRESS FIRMLY and PRINT clearly. Please fill in blanks and check the correct answers. Send three copies (white, blue, pink) to Kansas Department of Health and Environment, Bureau of Water, Geology Section, 1000 SW Jackson St., Suite 420, Topeka, Kansas 66612-1367. Telephone 785-296-5524. Send one copy to WATER WELL OWNER and retain one for your records. Include fee of \$5.00 for each constructed well. Visit us at <http://www.kdheks.gov/waterwell/index.html>.

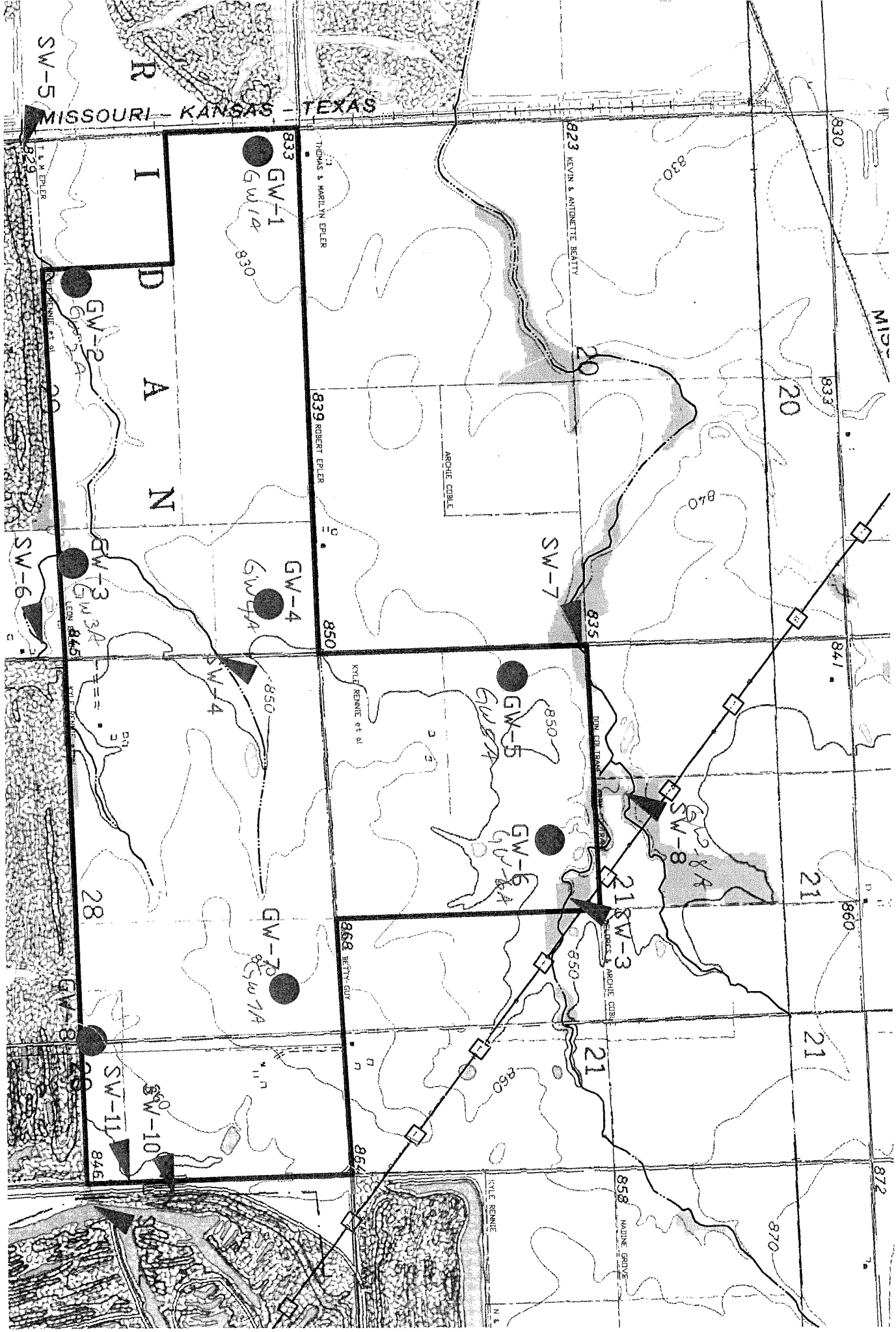

MISSOURI - KANSAS - TEXAS

833 GW-1
GW 1/4

839 GW-2
GW 3/4

839 GW-3
GW 3/4

850 GW-4
GW 1/4

850 GW-5
GW 3/4

850 GW-6
GW 3/4

868 GW-7
GW 1/4

846 GW-8
GW 3/4

823 KEVIN & ANTONETTE BEATTY

835 SW-7

850 GW-5
GW 3/4

850 GW-6
GW 3/4

858 GW-7
GW 1/4

830

840

850

860

870

SW-5

SW-6

SW-7

SW-8

SW-9

SW-10

SW-11

SW-12

SW-13

SW-14

SW-15

SW-16

SW-17

SW-18

SW-19

SW-20

SW-21

SW-22

SW-23

SW-24

SW-25

SW-26

SW-27

SW-28

SW-29

SW-30

SW-31

SW-32

SW-33

SW-34

SW-35

SW-36

SW-37

SW-38

SW-39

SW-40

SW-41

SW-42

SW-43

SW-44

SW-45

SW-46

SW-47

SW-48

SW-49

SW-50

SW-51

SW-52

SW-53

SW-54

SW-55

SW-56

SW-57

SW-58

SW-59

SW-60

SW-61

SW-62

SW-63

SW-64

SW-65

SW-66

SW-67

SW-68

SW-69

SW-70

SW-71

SW-72

SW-73

SW-74

SW-75

SW-76

SW-77

SW-78

SW-79

SW-80

SW-81

SW-82

SW-83

SW-84

SW-85

SW-86

SW-87

SW-88

SW-89

SW-90

SW-91

SW-92

SW-93

SW-94

SW-95

SW-96

SW-97

SW-98

SW-99

SW-100

SW-101

SW-102

SW-103

SW-104

SW-105

SW-106

SW-107

SW-108

SW-109

SW-110

SW-111

SW-112

SW-113

SW-114

SW-115

SW-116

SW-117

SW-118

SW-119

SW-120

SW-121

SW-122

SW-123

SW-124

SW-125

SW-126

SW-127

SW-128

SW-129

SW-130

SW-131

SW-132

SW-133

SW-134

SW-135

SW-136

SW-137

SW-138

SW-139

SW-140

SW-141

SW-142

SW-143

SW-144

SW-145

SW-146

SW-147

SW-148

SW-149

SW-150

SW-151

SW-152

SW-153

SW-154

SW-155

SW-156

SW-157

SW-158

SW-159

SW-160

SW-161

SW-162

SW-163

SW-164

SW-165

SW-166

SW-167

SW-168

SW-169

SW-170

SW-171

SW-172

SW-173

SW-174

SW-175

SW-176

SW-177

SW-178

SW-179

SW-180

SW-181

SW-182

SW-183

SW-184

SW-185

SW-186

SW-187

SW-188

SW-189

SW-190

SW-191

SW-192

SW-193

SW-194

SW-195

SW-196

SW-197

SW-198

SW-199

SW-200

SW-201

SW-202

SW-203

SW-204

SW-205

SW-206

SW-207

SW-208

SW-209

SW-210

SW-211

SW-212

SW-213

SW-214

SW-215

SW-216

SW-217

SW-218

SW-219

SW-220

SW-221

SW-222

SW-223

SW-224

SW-225

SW-226

SW-227

SW-228

SW-229

SW-230

SW-231

SW-232

SW-233

SW-234

SW-235

SW-236

SW-237

SW-238

SW-239

SW-240

SW-241

SW-242

SW-243

SW-244

SW-245

SW-246

SW-247

SW-248

SW-249

SW-250

SW-251

SW-252

SW-253

SW-254

SW-255

SW-256

SW-257

SW-258

SW-259

SW-260

SW-261

SW-262

SW-263

SW-264

SW-265

SW-266

SW-267

SW-268

SW-269

SW-270

SW-271

SW-272

SW-273

SW-274

SW-275

SW-276

SW-277

SW-278

SW-279

SW-280

SW-281

SW-282

SW-283

SW-284

SW-285

SW-286

SW-287

SW-288

SW-289

SW-290

SW-291

SW-292

SW-293

SW-294

SW-295

SW-296

SW-297

SW-298

SW-299

SW-300

SW-301

SW-302

SW-303</