

WATER WELL RECORD

Form WWC-5

Division of Water Resources App. No.

[Empty box for application number]

1 LOCATION OF WATER WELL: County: Cherokee, Fraction: NW 1/4 NW 1/4 SW 1/4, Section Number: 21, Township No. T 32 S, Range Number R 22 E

Street/Rural Address of Well Location; if unknown, distance & direction from nearest town or intersection: ATTACHED MAP. Global Positioning System (GPS) information: Latitude: 37.19.40, Longitude: 95.0.46, Elevation: 838

2 WATER WELL OWNER: Kyle Reaves, RR#, Street Address, Box #: RR 3, City, State, ZIP Code: Columbus, KS 66725. Collection Method: Digital Map/Photo

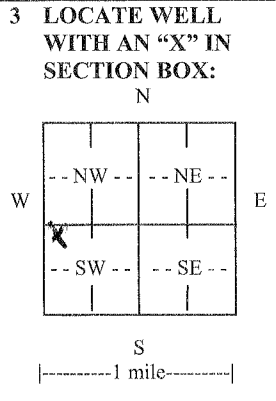

3 LOCATE WELL WITH AN 'X' IN SECTION BOX: 4 DEPTH OF COMPLETED WELL: 50.7 ft. Depth(s) Groundwater Encountered (1): 1.3 ft. WELL'S STATIC WATER LEVEL: ... ft. below land surface measured on mo/day/yr. Pump test data: Well water was ... ft. after ... hours pumping ... gpm. EST. YIELD: ... gpm. Well water was ... ft. after ... hours pumping ... gpm. Bore Hole Diameter: 7.5 in. to 50.7 ft., and ... in. to ... ft. WELL WATER TO BE USED AS: [] Public water supply, [] Geothermal, [] Injection well, [] Domestic, [] Feedlot, [] Oil field water supply, [] Dewatering, [] Other (Specify below) Irrigation, [] Industrial, [] Domestic-lawn & garden, [] Monitoring well. Was a chemical/bacteriological sample submitted to Department? [] Yes, [x] No. If yes, mo/day/yr sample was submitted. Water well disinfected? [] Yes, [x] No

5 TYPE OF CASING USED: [] Steel, [x] PVC, [] Other. CASING JOINTS: [] Glued, [] Clamped, [] Welded, [x] Threaded. Casing diameter: 1 in. to 42.7 ft., Diameter: ... in. to ... ft., Diameter: ... in. to ... ft. Casing height above land surface: 36 in., Weight: ... lbs./ft., Wall thickness or gauge No. Sch 40

TYPE OF SCREEN OR PERFORATION MATERIAL: [] Steel, [] Stainless Steel, [x] PVC, [] Other (Specify) [] Brass, [] Galvanized Steel, [] None used (open hole). SCREEN OR PERFORATION OPENINGS ARE: [] Continuous slot, [x] Mill slot, [] Gauze wrapped, [] Torch cut, [] Drilled holes, [] None (open hole), [] Louvered shutter, [] Key punched, [] Wire wrapped, [] Saw cut, [] Other (specify). SCREEN-PERFORATED INTERVALS: From 50.7 ft. to 40.7 ft., From ... ft. to ... ft., From ... ft. to ... ft. GRAVEL PACK INTERVALS: From 50.7 ft. to 42 ft., From ... ft. to ... ft., From ... ft. to ... ft.

6 GROUT MATERIAL: [] Neat cement, [] Cement grout, [x] Bentonite, [] Other. Grout Intervals: From 42 ft. to 1 ft., From ... ft. to ... ft., From ... ft. to ... ft., From ... ft. to ... ft. What is the nearest source of possible contamination: [] Septic tank, [] Lateral lines, [] Pit privy, [] Livestock pens, [] Insecticide storage, [x] Other (specify below) Sewer lines, [] Cesspool, [] Sewage lagoon, [] Fuel storage, [] Abandoned water well, Watertight sewer lines, [] Seepage pit, [] Feedyard, [] Fertilizer storage, [] Oil well/gas well. Direction from well: ... Distance from well: ...

Table with columns: FROM, TO, LITHOLOGIC LOG, FROM, TO, LITHO. LOG (cont.) or PLUGGING INTERVALS. Rows contain depth intervals and lithology descriptions like 'Bm Clay', 'Gray Shale', 'Coal', 'Gray Fire Clay', 'Gray Shale', 'Gray LS', 'Gray Shale', 'Coal', 'gray shale'.

7 CONTRACTOR'S OR LANDOWNER'S CERTIFICATION: This water well was [x] constructed, [] reconstructed, or [] plugged under my jurisdiction and was completed on (mo/day/year) 7-29-17 and this record is true to the best of my knowledge and belief. Kansas Water Well Contractor's License No. 704. This Water Well Record was completed on (mo/day/year) 2-1-12 under the business name of Mavs by (signature) David Hingle

INSTRUCTIONS: Use typewriter or ball point pen. PLEASE PRESS FIRMLY and PRINT clearly. Please fill in blanks and check the correct answers. Send three copies (white, blue, pink) to Kansas Department of Health and Environment, Bureau of Water, Geology Section, 1000 SW Jackson St., Suite 420, Topeka, Kansas 66612-1367. Telephone 785-296-5524. Send one copy to WATER WELL OWNER and retain one for your records. Include fee of \$5.00 for each constructed well. Visit us at http://www.kdheks.gov/waterwell/index.html.

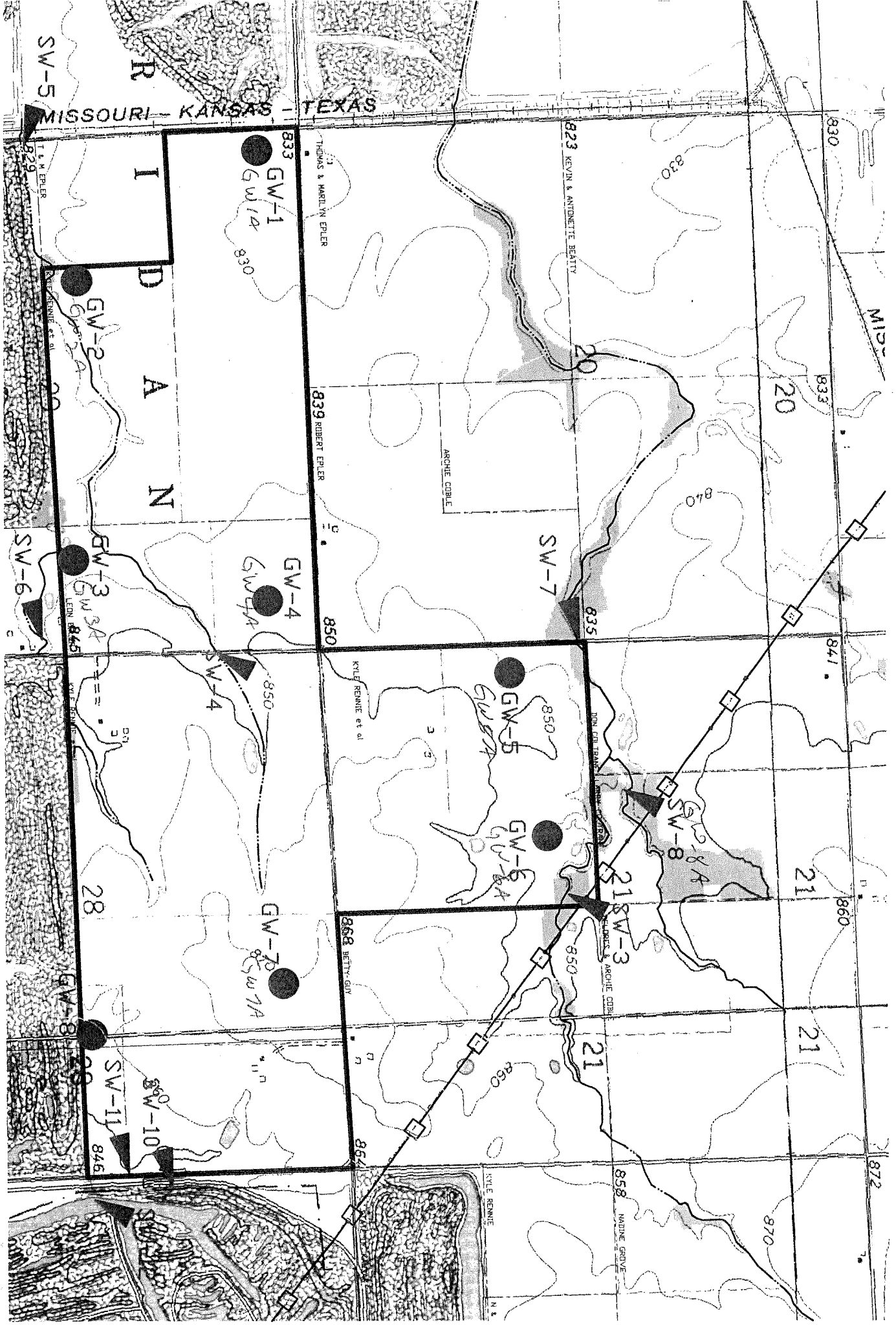

SW-5

R

MISSOURI - KANSAS - TEXAS

I

D

A

N

SW-6

SW-7

SW-4

SW-5

SW-6

SW-8

SW-7

SW-3

SW-8

SW-11

SW-10

833
GW-1
Gw 14

GW-2
Gw 13A

GW-3
Gw 3A
LENN 843

GW-4
Gw 4A

GW-5
Gw 5A

GW-6
Gw 6A

GW-8
Gw 8A

GW-7
Gw 7A

GW-8
Gw 8A

GW-11
Gw 11A

GW-10
Gw 10A

THOMAS & MARILYN EPLER

839 ROBERT EPLER

ARCHE COBLE

KYLE RENNE et al

868 BETTY GUY

KYLE RENNE

858 MADINE GROVE

823 KEVIN & ANTONETTE BEATTY

830

833

841

860

870

872

830

840

835

850

850

860

870

20

21

21

20

21

21SW-3

829

TAM EPLER

830

843

850

846

