

**WATER WELL PLUGGING RECORD Form WWC-5P**

KSA 82a-1212 ID NO.

Mw-15

[ ]

1 **LOCATION OF WATER WELL:** Fraction 1/4 SW 1/4 SE 1/4 SE 1/4 Section Number 27 Township Number T 32 S Range Number 4  E  W  
 County: Cowley

Street/Rural Address of Well Location; if unknown, distance & direction from nearest town or intersection: If at owner's address, check here  2000 Liquitek Lane  
Winfield KS 67156

**Global Positioning Systems (GPS) information:**  
 Latitude: 37.23186 (in decimal degrees)  
 Longitude: -96.97430 (in decimal degrees)  
 Elevation: \_\_\_\_\_  
 Horizontal Datum:  WGS84,  NAD83,  NAD27  
 Collection Method: \_\_\_\_\_

2 **WATER WELL OWNER:** Crayola llc (Binney & Smith)  
 RR#, St. Address, Box #: 1100 Church Lane  
 City, State ZIP Code: Easton PA 18044-0431

GPS unit (Make/Model: Garmin etrex)  
 Digital Map/Photo,  Topographic Map,  Land Survey  
 Est. Accuracy:  < 3 m,  3-5 m,  5-15 m,  > 15 m

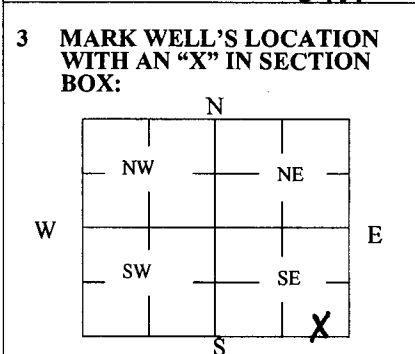

4 **DEPTH OF WELL** 22 ft.  
 WELL'S STATIC WATER LEVEL \_\_\_\_\_ ft  
 WELL WAS USED AS:  
 Domestic  Public Water Supply  Dewatering  
 Irrigation  Oil Field Water Supply  Monitoring  
 Feedlot  Domestic (Lawn & Garden)  Injection Well  
 Industrial  Air Conditioning  
 Was a chemical/bacteriological sample submitted to Department? Yes  No

5 **TYPE OF BLANK CASING USED:**  
 Steel  RMP (SR)  Wrought  Fiberglass  Other (Specify below)  
 PVC  ABS  Asbestos-Cement  Concrete Tile  
 Blank casing diameter 2 in. Was casing pulled? Yes  No  If yes, how much all  
 Casing height above or below land surface -6 in.

6 **GROUT PLUG MATERIAL:**  Neat cement  Cement grout  Bentonite  Other \_\_\_\_\_  
 Grout Plug Intervals: From 3 ft. to 22 ft., From — ft. to — ft., From — ft. to — ft.  
 What is the nearest source of possible contamination:  
 Septic tank  Seepage pit  Fuel storage  Other (specify below)  
 Sewer lines  Pit privy  Fertilizer storage  
 Watertight sewer lines  Sewage lagoon  Insecticide storage  
 Lateral lines  Feedyard  Abandoned water well Direction from well? \_\_\_\_\_  
 Cess pool  Livestock pens  Oil well/Gas well How many feet? \_\_\_\_\_

FROM	TO	PLUGGING MATERIALS	FROM	TO	PLUGGING MATERIALS
0	3	Concrete/Top Soil			
3	22	Bentonite			

7 **CONTRACTOR'S OR LANDOWNER'S CERTIFICATION:** This water well was plugged under my jurisdiction and was completed on (mo/day/year) 8-3-16 and this record is true to the best of my knowledge and belief. Kansas Water Well Contractor's License No. 710. This Water Well Record was completed on (mo/day/year) 8-5-16 under the business name of Below Ground Surface, Inc. by (signature) [Signature]

Send one white copy to Kansas Department of Health & Environment, Geology Section, 1000 SW Jackson Street, Ste. 420, Topeka, KS 66612-1367. Send one copy to WATER WELL OWNER and retain one for your records.  
 Visit us at <http://www.kdheks.gov/waterwell/index.html> Telephone 785-296-5524.



<b>2</b> FIGURE	DESIGNED	DGD	Former Binney & Smith Plant Winfield, Kansas  <b>Potentiometric Surface Map</b> December 2015	 <b>Environmental Resources Management</b> 10955 Lowell Avenue Suite 1000 Overland Park, Kansas 66210 (913) 861-0770		REVISION DESCRIPTION	DATE
	DRAWN	DGD					
	CHECKED	JEG					
	DATE	12/22/2015					
	TIME	15:22					
PROJECT #	0132731						