

1 LOCATION OF WATER WELL: Fraction SW ¼ SW ¼ SW ¼ Section Number 1 Township Number 33S Range Number 19E
 County: Labette

Distance and direction from nearest town or city street address of well if located within city?
Hwy 96 & Ness Road, Altamont KS

2 WATER WELL OWNER: Altamont Conoco
 RR#, St. Address, Box #: PO Box 667
 City, State, ZIP Code: Independence, KS 67301

Global Positioning System (decimal degrees, min. of 4 digits)
 Latitude: NA
 Longitude: NA
 Elevation: NA
 Datum: NA
 Data Collection Method: NA

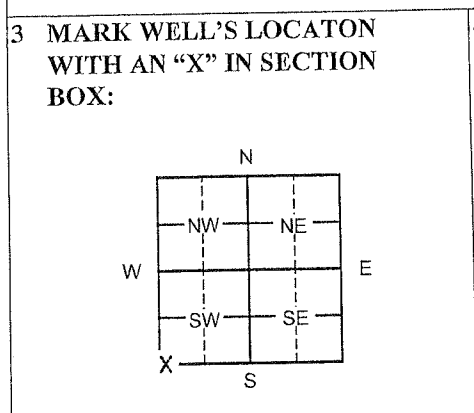

4 DEPTH OF WELL 14.75 ft. MW3
 WELL'S STATIC WATER LEVEL NA ft.
 WELL WAS USED AS:

1 Domestic	5 Public Water Supply	9 Dewatering
2 Irrigation	6 Oil Field Water Supply	<input checked="" type="radio"/> 10 Monitoring
3 Feedlot	7 Domestic (Lawn & Garden)	11 Injection Well
4 Industrial	8 Air Conditioning	12 Other _____

Was a chemical/bacteriological sample submitted to Department? Yes ___ No

5 TYPE OF BLANK CASING USED:

<input type="checkbox"/> 1 Steel	<input type="checkbox"/> 3 RMP (SR)	<input type="checkbox"/> 5 Wrought	<input type="checkbox"/> 7 Fiberglass	<input type="checkbox"/> 9 Other (specify below)
<input checked="" type="checkbox"/> 2 PVC	<input type="checkbox"/> 4 ABS	<input type="checkbox"/> 6 Asbestos-Cement	<input type="checkbox"/> 8 Concrete Tile	_____

Blank casing diameter 2 in. Was casing pulled? Yes No ___ If yes, how much 3 ft
 Casing height above or below land surface NA in.

6 GROUT PLUG MATERIAL: 1 Neat cement 2 Cement grout 3 Bentonite 4 Other Asphalt 0-0.3ft; Soil 0.3-3ft

Grout Plug Intervals: From 3 ft. to 14.75 ft., From _____ ft. to _____ ft., From _____ ft. to _____ ft.

What is the nearest source of possible contamination:

<input type="checkbox"/> 1 Septic tank	<input type="checkbox"/> 6 Seepage pit	<input type="checkbox"/> 11 Fuel storage	<input type="checkbox"/> 16 Other (specify below)
<input type="checkbox"/> 2 Sewer lines	<input type="checkbox"/> 7 Pit privy	<input type="checkbox"/> 12 Fertilizer storage	_____
<input type="checkbox"/> 3 Watertight sewer lines	<input type="checkbox"/> 8 Sewage lagoon	<input type="checkbox"/> 13 Insecticide storage	
<input type="checkbox"/> 4 Lateral lines	<input type="checkbox"/> 9 Feedyard	<input type="checkbox"/> 14 Abandoned water well	Direction from well?
<input type="checkbox"/> 5 Cess pool	<input type="checkbox"/> 10 Livestock pens	<input type="checkbox"/> 15 Oil well/Gas well	How many feet?

FROM	TO	PLUGGING MATERIALS	FROM	TO	PLUGGING MATERIALS
0	0.3	Asphalt			
0.3	3	Soil			
3	14.75	Bentonite			

7 CONTRACTOR'S OR LANDOWNER'S CERTIFICATION: This water well was plugged under my jurisdiction and was completed on (mo/day/year) 12/14/2011 and this record is true to the best of my knowledge and belief. Kansas Water Well Contractor's License No. 757. This Water Well Record was completed on (mo/day/year) 12/29/11 under the business name of Larsen and Associates, Inc. by (signature)

INSTRUCTIONS: Please fill in blanks or circle the correct answers. Send top three copies to Kansas Department of Health and Environment, Bureau of Water, Geology Section, 1000 SW Jackson St., Ste. 420, Topeka, Kansas 66612-1367. Telephone: 785/296-5522. Send one to Water Well Owner and retain one for your records. Visit us at <http://www.kdheks.gov/waterwell>.