

WATER WELL RECORD

Form WWC-5

Division of Water Resources App. No.

31396

1 LOCATION OF WATER WELL: County: Cowley	Fraction SW 1/4 NW 1/4 SW 1/4 SE 1/4	Section Number 11	Township No. T 33 S	Range Number R 3 <input checked="" type="checkbox"/> E <input type="checkbox"/> W
--	---	----------------------	------------------------	--

Street/Rural Address of Well Location; if unknown, distance & direction from nearest town or intersection: If at owner's address, check here .
From Hackney: 1 mile N 2 1/2 mile W

Global Positioning System (GPS) information:
Latitude: .37,18969 (in decimal degrees)
Longitude: 097.06761 (in decimal degrees)
Elevation: 1151
Datum: WGS 84, NAD 83, NAD 27
Collection Method:
 GPS unit (Make/Model: Garmin csx)
 Digital Map/Photo, Topographic Map, Land Survey
Est. Accuracy: <3 m, 3-5 m, 5-15 m, >15 m

2 WATER WELL OWNER: Lester & Barbara Priest
RR#, Street Address, Box #: 22337 41st Road
City, State, ZIP Code : Winfield, Kansas 67156

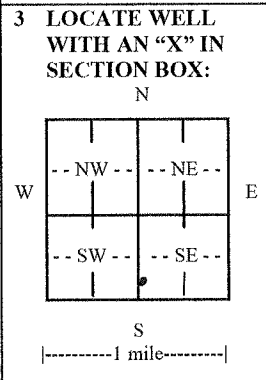

4 DEPTH OF COMPLETED WELL 41 ft.

Depth(s) Groundwater Encountered (1)..... ft. (2)..... ft. (3)..... ft.
WELL'S STATIC WATER LEVEL 17' 8" ft. below land surface measured on mo/day/yr. 5-22-2012.....
Pump test data: Well water was.....ft. after..... hours pumping..... gpm
EST. YIELD.....gpm. Well water was.....ft. after..... hours pumping..... gpm
Bore Hole Diameter 28 in. to 41 ft., and.....in. to.....ft.
WELL WATER TO BE USED AS: Public water supply Geothermal Injection well
 Domestic Feedlot Oil field water supply Dewatering Other (Specify below)
 Irrigation Industrial Domestic-lawn & garden Monitoring well
Was a chemical/bacteriological sample submitted to Department? Yes No
If yes, mo/day/yr sample was submitted.....
Water well disinfected? Yes No

5 TYPE OF CASING USED: Steel PVC Other.....
CASING JOINTS: Glued Clamped Welded Threaded **Bolted**
Casing diameter .12 in. to .31 ft., Diameter..... in. to..... ft., Diameter..... in. to..... ft.
Casing height above land surface .24 in., Weight .160 lbs./ft., Wall thickness or gauge No. 490.....
TYPE OF SCREEN OR PERFORATION MATERIAL:
 Steel Stainless Steel PVC Other (Specify).....
 Brass Galvanized Steel None used (open hole)
SCREEN OR PERFORATION OPENINGS ARE:
 Continuous slot Mill slot Gauze wrapped Torch cut Drilled holes None (open hole)
 Louvered shutter Key punched Wire wrapped Saw cut Other (specify).....
SCREEN-PERFORATED INTERVALS: From .31 ft. to .41 ft., From..... ft. to..... ft.
From..... ft. to..... ft., From..... ft. to..... ft.
GRAVEL PACK INTERVALS: From .41 ft. to .17 ft., From..... ft. to..... ft.
From..... ft. to..... ft., From..... ft. to..... ft.

6 GROUT MATERIAL: Neat cement Cement grout Bentonite Other.....
Grout Intervals: From .17 ft. to 0 ft., From..... ft. to..... ft., From..... ft. to..... ft.
What is the nearest source of possible contamination:
 Septic tank Lateral lines Pit privy Livestock pens Insecticide storage Other (specify below)
 Sewer lines Cesspool Sewage lagoon Fuel storage Abandoned water well
 Watertight sewer lines Seepage pit Feedyard Fertilizer storage Oil well/gas well **old irrigation well**
Direction from well West..... Distance from well .17'.....

FROM	TO	LITHOLOGIC LOG	FROM	TO	LITHO. LOG (cont.) or PLUGGING INTERVALS
0	3	Top soil			
3	10	Tannish grav clay			
10	17	Tan clay			
17	40	Small to fine sand			
40	41	Gray shale			

7 CONTRACTOR'S OR LANDOWNER'S CERTIFICATION: This water well was constructed, reconstructed, or plugged under my jurisdiction and was completed on (mo/day/year) 5-22-2012..... and this record is true to the best of my knowledge and belief. Kansas Water Well Contractor's License No. 134..... This Water Well Record was completed on (mo/day/year) 5-30-2012..... under the business name of Rosencrantz-Bemis Ent...... by (signature) Jessica DeLeon

INSTRUCTIONS: Use typewriter or ball point pen. PLEASE PRESS FIRMLY and PRINT clearly. Please fill in blanks and check the correct answers. Send three copies (white, blue, pink) to Kansas Department of Health and Environment, Bureau of Water, Geology Section, 1000 SW Jackson St., Suite 420, Topeka, Kansas 66612-1367. Telephone 785-296-5524. Send one copy to WATER WELL OWNER and retain one for your records. Include fee of \$5.00 for each constructed well. Visit us at <http://www.kdheks.gov/waterwell/index.html>.