

WATER WELL PLUGGING RECORD Form WWC-5P KSA 82a-1212 ID NO.

1 LOCATION OF WATER WELL: County: Sumner Fraction: 1/4 NE 1/4 NW NW Section Number: 18 Township Number: T 34 S Range Number: 1 [X] E [] W

Street/Rural Address of Well Location: 3N 4 1/4 E South Haven Global Positioning Systems (GPS) information: Latitude: Longitude: Elevation: Horizontal Datum: WGS84, NAD83, NAD27 Collection Method:

2 WATER WELL OWNER: Keith Yearout RR#: 14003 SW Acton Rd City, State ZIP Code: Lake City, KS 67071 Est. Accuracy: < 3 m, 3-5 m, 5-15 m, > 15 m

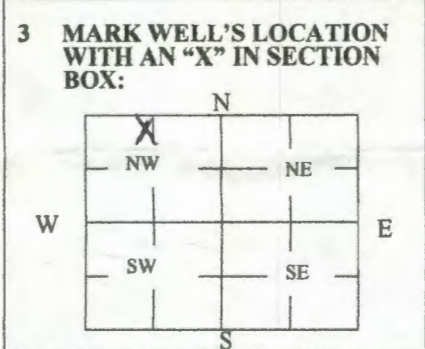

3 MARK WELL'S LOCATION WITH AN 'X' IN SECTION BOX: 4 DEPTH OF WELL: 21 ft. WELL'S STATIC WATER LEVEL: 31 ft. WELL WAS USED AS: [X] Domestic, [] Irrigation, [] Feedlot, [] Industrial, [] Public Water Supply, [] Oil Field Water Supply, [] Domestic (Lawn & Garden), [] Air Conditioning, [] Dewatering, [] Monitoring, [] Injection Well, [] Other. Was a chemical/bacteriological sample submitted to Department? Yes [] No [X]

5 TYPE OF BLANK CASING USED: [X] Steel, [] PVC, [] RMP (SR), [] ABS, [] Wrought, [] Asbestos-Cement, [] Fiberglass, [] Concrete Tile, [] Other. Blank casing diameter: 6 in. Was casing pulled? Yes [] No [] Casing height above or below land surface: 14 in.

6 GROUT PLUG MATERIAL: [] Neat cement, [] Cement grout, [X] Bentonite, [] Other. Grout Plug Intervals: From 0 ft. to 21 ft. What is the nearest source of possible contamination: [] Septic tank, [] Sewer lines, [] Watertight sewer lines, [] Lateral lines, [] Cess pool, [] Seepage pit, [] Pit privy, [] Sewage lagoon, [] Feedyard, [] Livestock pens, [] Fuel storage, [] Fertilizer storage, [] Insecticide storage, [X] Abandoned water well, [] Oil well/Gas well, [] Other. Direction from well? SE. How many feet? 500.

Table with columns: FROM, TO, PLUGGING MATERIALS. Row 1: FROM 0, TO 21, PLUGGING MATERIALS Bentonite Hole Plug.

7 CONTRACTOR'S OR LANDOWNER'S CERTIFICATION: This water well was plugged under my jurisdiction and was completed on (mo/day/year) 6-28-19 and this record is true to the best of my knowledge and belief. Kansas Water Well Contractor's License No. 140 This Water Well Record was completed on (mo/day/year) 8-5-19 under the business name of Lyman's Inc by (signature) [Signature]

Send one white copy to Kansas Department of Health & Environment, Geology Section, 1000 SW Jackson Street, Ste. 420, Topeka, KS 66612-1367. Send one copy to WATER WELL OWNER and retain one for your records. Visit us at http://www.kdheks.gov/waterwell/index.html Telephone 785-296-5524.