

CORRECTION(S) TO WATER WELL RECORD (WWC-5)
(to rectify lacking or incorrect information)

County: Montgomery

Location listed as:

Location changed to:

Section-Township-Range: None Given

36-34S-16E

Fraction ($\frac{1}{4}$ $\frac{1}{4}$ $\frac{1}{4}$): _____

S2 SW SE SE

Other changes: Initial statements: No owner name given.

Changed to: Coffeyville Resources Refining & Marketing, LLC

Comments: Owner's name from county assessor's parcel search online.

verification method: well address, city street map, plat map, and mapping tool on KGS website.

initials: DRF date: 12/3/2008

submitted by: Kansas Geological Survey, Data Resources Library, 1930 Constant Ave., Lawrence, KS 66047-3726
to: Kansas Dept of Health & Environment, Bureau of Water, 1000 SW Jackson, Suite 420, Topeka, KS 66612-1367.

LOCATION OF WATER WELL:	Fraction	Section Number	Township Number	Range Number
County: <u>Montgomery</u>	$\frac{1}{4}$ $\frac{1}{4}$ $\frac{1}{4}$			E/W

Distance and direction from nearest town or city street address of well if located within city?

WATER WELL OWNER: Coffeyville, KS
 Board of Agriculture, Division of Water Resources
 RR #, St. Address, Box #: 708 E 8th
 City, State, ZIP Code: _____ Application Number: _____

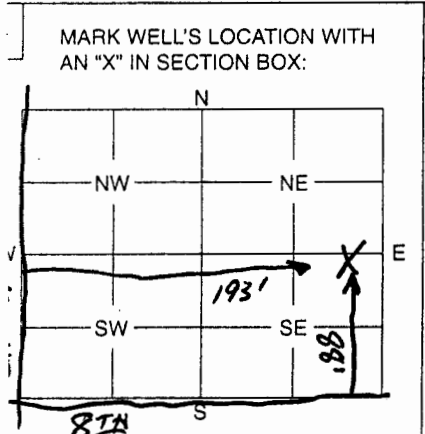

4 DEPTH OF WELL 14' ft.
 WELL'S STATIC WATER LEVEL 13' ft.
 WELL WAS USED AS:
 1 Domestic 5 Public Water Supply 9 Dewatering
 2 Irrigation 6 Oil Field Water Supply 10 Monitoring Well
 3 Feedlot 7 Domestic (Lawn & Garden) 11 Injection Well
 4 Industrial 8 Air Conditioning 12 Other

Was a chemical / bacteriological sample submitted to Department? Yes No
 If yes, mo/day/yr sample was submitted

Water Well Disinfected: Yes No

TYPE OF BLANK CASING USED:

1 Steel	3 RMP (SR)	5 Wrought	7 Fiberglass	<input checked="" type="radio"/> Other (Specify below) <u>BRICK</u>
2 PVC	4 ABS	6 Asbestos-Cement	8 Concrete Tile	

Blank casing diameter 3'3" in. Was casing pulled? Yes No If yes, how much Full depth
 Casing height above or below land surface in.

GROUT PLUG MATERIAL: 1 Neat cement 2 Cement grout 3 Bentonite Other Flowable Fill

Grout Plug Intervals: From ft. to ft., From ft. to ft., From to ft.

What is the nearest source of possible contamination:

1 Septic tank	6 Seepage pit	11 Fuel storage	<input checked="" type="radio"/> Other (specify below) <u>CISTERN</u>
2 Sewer lines	7 Pit privy	12 Fertilizer storage	
3 Watertight sewer lines	8 Sewage lagoon	13 Insecticide storage	
4 Lateral lines	9 Feedyard	14 Abandoned water well	
5 Cess pool	10 Livestock pens	15 Oil well/Gas well	

Direction from well? WEST How many feet? 70'

FROM	TO	PLUGGING MATERIALS
<u>14'</u>	<u>13'</u>	<u>Chlorinated Gravel</u>
<u>3'6"</u>	<u>3'</u>	<u>Flowable Fill</u>
<u>13'</u>	<u>3'6"</u>	<u>Native Soil</u>
<u>3'</u>	<u>0</u>	<u>Native Soil</u>

CONTRACTOR'S OF LANDOWNER'S CERTIFICATION: This water well was plugged under my jurisdiction and was completed on (mo/day/year) 12-6-07 and this record is true to the best of my knowledge and belief. Kansas Water Well Contractor's License No. This Water Well Record was completed on (mo/day/year) under the business name of
 by (signature) [Signature]

INSTRUCTIONS: Use typewriter or ball point pen. Please press firmly and print clearly. Please fill in blanks, underline or circle the correct answers. Send top three copies to Kansas Department of Health and Environment, Bureau of Water, Geology Section, 1000 SW Jackson, Ste. 420, Topeka, Kansas 66612-1367. Telephone: 785/296-5522. Send one to Water Well Owner and retain one for your records.