

WATER WELL RECORD

Form WWC-5

Division of Water Resources App. No.

Well ID

MW6

[X] Original Record [] Correction [] Change in Well Use

1 LOCATION OF WATER WELL: County Montgomery Fraction SE 1/4 SW 1/4 SE 1/4 SE 1/4 Section Number 35 Township Number T 34 S Range Number R 16 [X] E [] W

2 WELL OWNER: Last Name: Business: Sinclair Marketing, Inc. Address: 550 East South Temple City Salt Lake City State: UT ZIP: 84102 Street or Rural Address where well is located (if unknown, distance and direction from nearest town or intersection): -45° N of 502 W 8th St., Coffeyville, KS

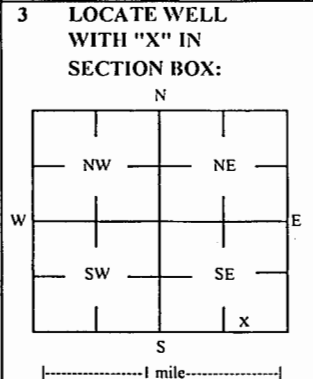

3 LOCATE WELL WITH "X" IN SECTION BOX: 4 DEPTH OF COMPLETED WELL: 24 ft. Depth(s) Groundwater Encountered: 1) 24 ft. 2) 3) 4) [] Dry Well WELL'S STATIC WATER LEVEL: 11.7 ft. [X] below land surface, measured on (mo-day-yr) 3/21/2019 [] above land surface, measured on (mo-day-yr) Pump test data: Well water was ft after hours pumping gpm Water well was ft after hours pumping gpm Estimated Yield: gpm Bore Hole Diameter: 7.25 in to ft, and in to ft

5 Latitude: 37.03659 (decimal degrees) Longitude: 95.62235 (decimal degrees) Horizontal Datum: [X] WGS 84 [] NAD 83 [] NAD 27 Source for Latitude/Longitude: [] GPS (unit make/model:) (WAAS enabled? [] Yes [] No) [X] Land Survey [] Topographic Map [] Online Mapper

6 Elevation: 751.81 ft [] Ground Level [X] TOC Source: [X] Land Survey [] GPS [] Topographic Map [] Other

7 WELL WATER TO BE USED AS: 1 Domestic: [] Household [] Lawn & Garden [] Livestock [] Irrigation [] Feedlot [] Industrial 2 Public Water Supply: well ID 3 Dewatering: how many wells? 4 Aquifer Recharge: well ID 5 Monitoring: well ID MW6 6 Environmental Remediation: well ID 7 Air Sparge [] Soil Vapor Extractor 8 Recovery [] Injection 9 Oil Field Water Supply: lease 10 Test Hole: well ID [] Cased [] Uncased [] Geotechnical 11 Geothermal: How many bores? a) Closed Loop [] Horizontal [] Vertical b) Open Loop [] Surface Discharge [] Inj. of Water [] Other (specify):

Was a chemical/bacteriological sample submitted to KDHE? [] Yes [X] No If yes, date sample was submitted: Water well disinfected? [] Yes [X] No

8 TYPE OF CASING USED: [] Steel [X] PVC [] Other CASING JOINTS: [] Glued [] Clamped [] Welded [X] Threaded Casing diameter 2 in. to 14 ft, Diameter in. to ft, Diameter in. to ft, Casing height above land surface -0.45 in. Weight lbs./ft. Well thickness or gauge No TYPE OF SCREEN OR PERFORATION MATERIAL: [] Steel [] Stainless Steel [] Fiberglass [X] PVC [] Other (Specify) [] Brass [] Galvanized Steel [] Concrete tile [] None used (open hole) SCREEN OR PERFORATION OPENINGS ARE: [] Continuous Slot [X] Mill Slot [] Gauze Wrapped [] Torch Cut [] Drilled Holes [] Other (Specify) [] Louvered Shutter [] Key Punched [] Wire Wrapped [] Saw Cut [] None (Open Hole) SCREEN-PERFORATED INTERVALS: From 14 ft. to 24 ft, From ft. to ft, From ft. to ft, GRAVEL PACK INTERVALS: From 12 ft. to 24 ft, From ft. to ft, From ft. to ft,

9 GROUT MATERIAL: [] Neat cement [] Cement grout [X] Bentonite [X] Other Concrete: 0-0.7 Grout intervals: From 0.7 ft. to 12 ft, From ft. to ft, From ft. to ft,

Nearest source of possible contamination: [] Septic Tank [] Lateral Lines [] Pit Privy [] Livestock Pens [] Insecticide Storage [] Sewer Lines [] Cess Pool [] Sewage Lagoon [X] Fuel Storage [] Abandoned Water Well [] Watertight Sewer Lines [] Seepage Pit [] Feedyard [] Fertilizer Storage [] Oil Well / Gas Well [] Other (Specify) Direction from well? SW Distance from well? ~100 ft

Table with 6 columns: FROM, TO, LITHOLOGIC LOG, FROM, TO, LITHO. LOG (cont.) or PLUGGING INTERVALS. Rows: 0-1 Topsoil, mostly silty clay; 1-2 Weathered claystone/shale; 2-24 Shale.

Notes: KDHE ID: Sinclair #56255; U3-063-14986 Target of monitoring well is shallow groundwater, <20' of grout was installed at the direction of KDHE.

11 CONTRACTOR'S OR LANDOWNER'S CERTIFICATION: This water well was [X] constructed, [] reconstructed, or [] plugged under my jurisdiction and was completed on (mo-day-year) 3/5/19 and this record is true to the best of my knowledge and belief. Kansas Water Well Contractor's License No 757 This Water Well Record was completed on (mo-day-year) 4/2/19 under the business name of Larsen & Associates, Inc. Signature

Mail 1 white copy along with a fee of \$5.00 for each constructed well to: Kansas Department of Health and Environment, Bureau of Water, GWTS Section, 1000 SW Jackson St., Suite 420, Topeka, Kansas 66612-1367. Mail one to Water Well Owner and retain one for your records. Telephone 785-296-5524.

DENNIS L HANDKE

1820 NW 59th Terrace
TOPEKA, KANSAS 66618
785-286-4047 Home

Jess Chapman
Larsen & Associates
1311 E. 25th Street, Suite B
Lawrence, Kansas, 66046

March 30, 2019

RE: Monitor Well Elevation Survey
502 W. 8th St., Coffeyville, Kansas

Proj. 19-00M
Sinclair #56255
U3-063-14986

Bench Mark: Square cut on SE corner of concrete sign base at SW Corner of property.
Elev: 752.18 North 38.23 West 737.24 (from SE Cor. Sec. 35-34-16E)

MW-1	rim	751.94	North	66.04	SE1/4,SW1/4,SE1/4,SE1/4
	top pipe	751.62	West	719.41	Lat= 37.03631 Long = 95.62265
MW-2	rim	751.57	North	77.30	SW1/4,SE1/4,SE1/4,SE1/4
	top pipe	751.31	West	649.81	Lat= 37.03634 Long = 95.62241
MW-3	rim	751.56	North	41.09	SW1/4,SE1/4,SE1/4,SE1/4
	top pipe	751.27	West	654.31	Lat= 37.03624 Long = 95.62243
MW-4	rim	751.69	North	153.82	SE1/4,SW1/4,SE1/4,SE1/4
	top pipe	751.36	West	930.76	Lat= 37.03655 Long = 95.62338
MW-5	rim	750.97	North	38.08	SE1/4,SW1/4,SE1/4,SE1/4
	top pipe	750.70	West	566.84	Lat= 37.03624 Long = 95.62213
MW-6	rim	752.26	North	165.32	SE1/4,SW1/4,SE1/4,SE1/4
	top pipe	751.81	West	631.13	Lat= 37.03659 Long = 95.62235
MW-7	rim	751.27	North	121.25	SE1/4,SW1/4,SE1/4,SE1/4
	top pipe	751.03	West	513.07	Lat= 37.03646 Long = 95.62194

Lat & Long derived from Coffeyville East 7.5' quad map. WGS84

Elevation established from USGS BM L 26 1933, NAVD 88.

If you have any questions, please feel free to call me. Thank you for the opportunity to be of service to you.

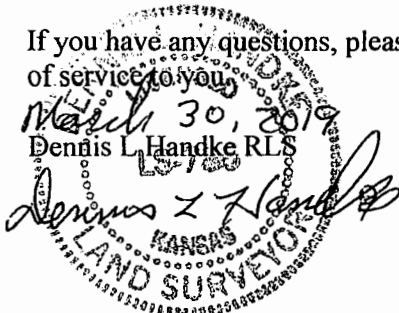

RECEIVED
APR 09 2019
BUREAU OF WATER

NOTE: Figures exhibited within this report are only to be used within the context of this report. Placement of property lines, wells, structures, and roads is based on the available information from county appraiser maps, surveys, site visits, and/or previous vendor reports and should be considered approximate.

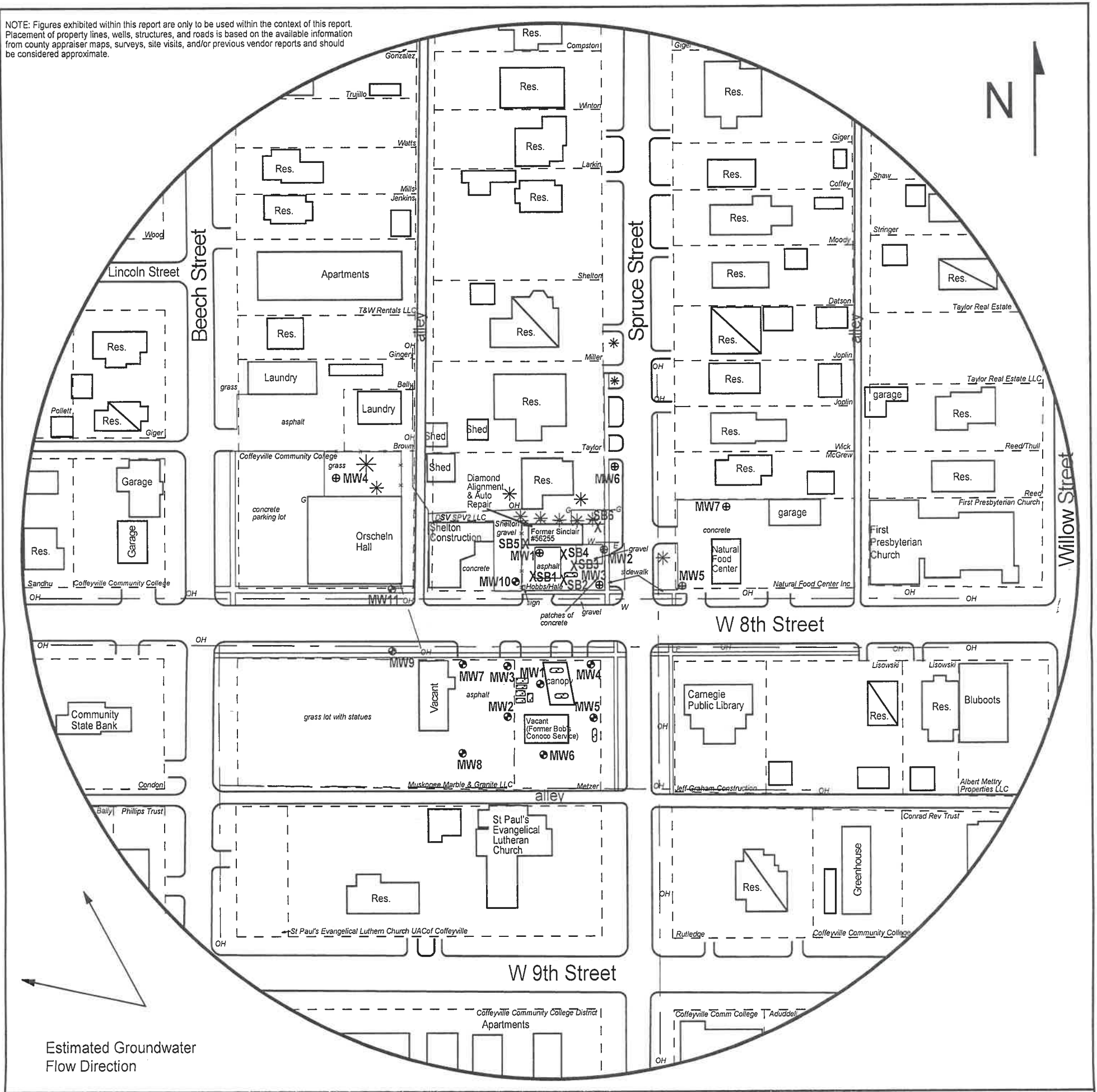

FIGURE 2.2 - 500 FT RADIUS AREA BASE MAP

LEGEND:

- Possible Location of Former Pump Islands
- Approximate Location of Former UST Basin and Pump Islands
- Building with Basement
- Approximate Location of Property Line
- Monitoring Well for Nearby Site Bob's Conoco Service (U3-063-14595)
- Monitoring Well (Installed 3/5-7/19)
- Soil Boring (Drilled 3/6-7/19)
- Electric Meter
- Fire Hydrant
- Gas Lines (2 - 6 ft BGS)
- Overhead Lines (25-40 ft high)
- Water Lines (2 - 6 ft BGS)

NOTE: SB5 & SB6 were drilled to collect hydrologic samples.
 NOTE: Utility depths, heights and locations are approximate.
 NOTE: Location of former UST basin is unknown.



PROJECT:

Sinclair #56255
 502 West 8th Street
 Coffeyville, KS
 KDHE ID: U3-063-14986
 Date: 3/21/19



1311 E 25th St., Suite B (785) 841-8707 office
 Lawrence, KS 66046 (785) 865-4282 fax

RECEIVED
 APR 09 2019
 BUREAU OF WATER