

**WATER WELL PLUGGING RECORD Form WWC-5P**

KSA 82a-1212 ID NO.

MW11

1 **LOCATION OF WATER WELL:** Fraction SE 1/4 NW 1/4 SW 1/4 Section Number 35 Township Number T 34 S Range Number 21  E  W  
 County: LABETTE

Street/Rural Address of Well Location; if unknown, distance & direction from nearest town or intersection: If at owner's address, check here  19 E. MAPLE CHETOPA, KS

**Global Positioning Systems (GPS) information:**  
 Latitude: \_\_\_\_\_ (in decimal degrees)  
 Longitude: \_\_\_\_\_ (in decimal degrees)  
 Elevation: 799 98  
 Horizontal Datum:  WGS84,  NAD83,  NAD27  
 Collection Method: \_\_\_\_\_

2 **WATER WELL OWNER:** JOHNSON'S GENERAL STOR  
 RR#, St. Address, Box #: PO BOX 9250  
 City, State ZIP Code: WICHITA, KS 67277

GPS unit (Make/Model: \_\_\_\_\_)  
 Digital Map/Photo,  Topographic Map,  Land Survey  
 Est Accuracy:  < 3 m,  3-5 m,  5-15 m,  > 15 m

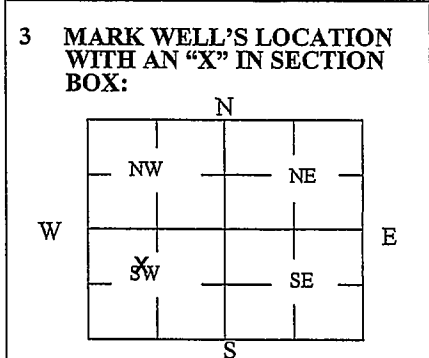

4 **DEPTH OF WELL** 15 00 ft.  
 WELL'S STATIC WATER LEVEL 8.65 ft  
 WELL WAS USED AS:  
 Domestic  Public Water Supply  Dewatering  
 Irrigation  Oil Field Water Supply  Monitoring  
 Feedlot  Domestic (Lawn & Garden)  Injection Well  
 Industrial  Air Conditioning  Other \_\_\_\_\_  
 Was a chemical/bacteriological sample submitted to Department? Yes  No

5 **TYPE OF BLANK CASING USED:**  
 Steel  RMP (SR)  Wrought  Fiberglass  Other (Specify below)  
 PVC  ABS  Asbestos-Cement  Concrete Tile  
 Blank casing diameter 2 in. Was casing pulled? Yes  No  If yes, how much 3'  
 Casing height above or below land surface 0 in.

6 **GROUT PLUG MATERIAL:**  Neat cement  Cement grout  Bentonite  Other GRASS/SOIL 0-0.5  
 Grout Plug Intervals: From 0.5 ft. to 15.00 ft., From \_\_\_\_\_ ft. to \_\_\_\_\_ ft., From \_\_\_\_\_ ft. to \_\_\_\_\_ ft.

What is the nearest source of possible contamination:  
 Septic tank  Seepage pit  Fuel storage  Other (specify below)  
 Sewer lines  Pit privy  Fertilizer storage  
 Watertight sewer lines  Sewage lagoon  Insecticide storage  
 Lateral lines  Feedyard  Abandoned water well Direction from well? SOUTHEAST  
 Cess pool  Livestock pens  Oil well/Gas well How many feet? 140

FROM	TO	PLUGGING MATERIALS	FROM	TO	PLUGGING MATERIALS
0	0.5	GRASS/SOIL			
0.5	15.00	BENTONITE			

7 **CONTRACTOR'S OR LANDOWNER'S CERTIFICATION:** This water well was plugged under my jurisdiction and was completed on (mo/day/year) 10/28/21 and this record is true to the best of my knowledge and belief. Kansas Water Well Contractor's License No. 585. This Water Well Record was completed on (mo/day/year) 11/3/21 under the business name of ASSOCIATED ENVIRONMENTAL INC. by (signature) \_\_\_\_\_

Send one white copy to Kansas Department of Health & Environment, Geology Section, 1000 SW Jackson Street, Ste. 420, Topeka, KS 66612-1367. Send one copy to WATER WELL OWNER and retain one for your records.  
 Visit us at <http://www.kdheks.gov/waterwell/index.html> Telephone 785-296-5524.

1

RESIDENTIAL

1ST ST

GRASS

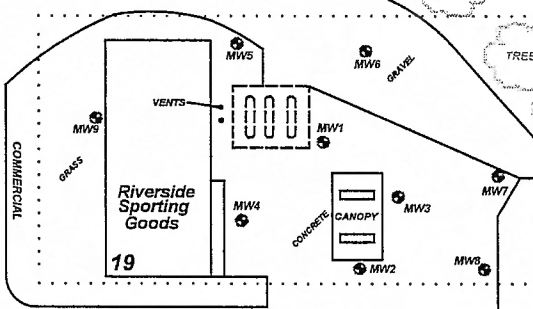

NEOSHO RIVER

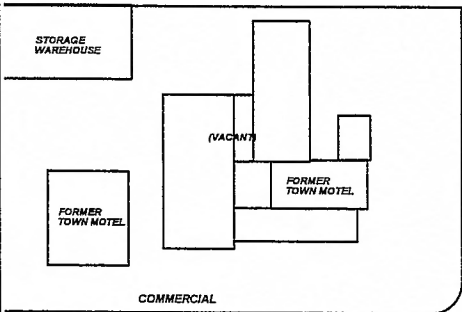
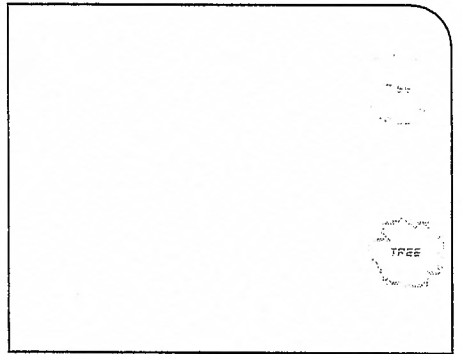

COMMERCIAL

PLE ST

MAPLE ST

US HWY 66

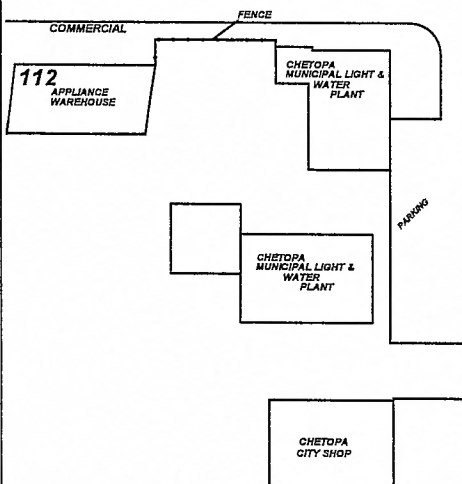

1ST ST

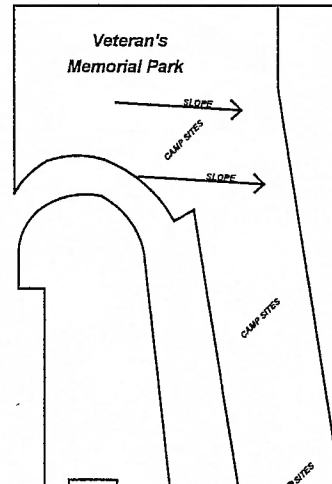
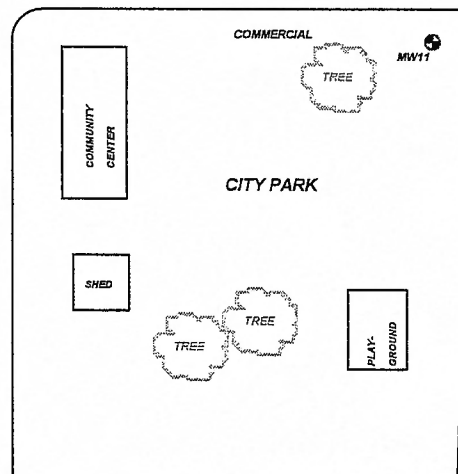

PROJECT: **Johnson's General Store #28**

ADDRESS: **19 E Maple**

LOCATION: **Chetopa, KS**

DRAWN BY: **B. Scott** DATE: **05/29/13**

REVISED BY: **B. Stalnaker** DATE: **11/3/21**

AEI JOB #: **TF460** KDHE JOB #: **U3-050-14439**

SCALE: **1" = 100'**

NOTES: **Sample Date: 3/2/21**

TITLE:

**ASSOCIATED ENVIRONMENTAL INC.**

LEGEND:

= (2) 10,000 gal. & (1) 6,000 gal. gasoline USTs (TEMP OUT)

= Plugged Monitor Well Location

= Site Property Boundary

**RECEIVED**

**NOV 29 2021**

**BUREAU OF WATER**

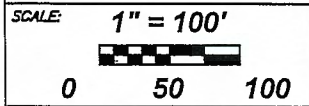

# SMH CONSULTANTS

August 30, 2013

Associated Environmental, Inc.  
Cole Roe  
404 Pottawatomie  
Manhattan, KS 66502  
Email: cole\_taylor@sbcglobal.net

RE: Project No. 1308MN1213

Dear Cole:

The following is the information requested on a Monitoring Well Site, Johnson's General Store No. 28, 19 East Maple, Chetopa, Labette County, Kansas.

Point	North Coord.	East Coord.	Distance SE Cor. North	From S.35 West	Elev. Top Of Rim or PK Nail	Elev. Top of PVC Pipe	Latitude North	Longitude West
SE Corner S.35-T34S-R21E	5000	5000						
MW1	6720.84	772.32	1720.84	4227.68	799.82	799.39	37.03727	95.08215
MW2	6655.48	791.65	1655.48	4208.35	799.56	799.09	37.03709	95.08208
MW3	6692.90	814.56	1692.90	4185.44	799.69	799.46	37.03720	95.08200
MW4	6682.17	737.52	1682.17	4262.48	800.45	800.08	37.03717	95.08226
MW5	6762.66	732.58	1762.66	4267.42	799.81	799.59	37.03739	95.08228
MW6	6761.09	795.87	1761.09	4204.13	798.23	798.04	37.03738	95.08267
MW7	6696.02	855.42	1696.02	4144.58	799.34	799.03	37.03721	95.08186
MW8	6657.35	857.16	1657.35	4142.84	799.53	799.26	37.03710	95.08185
MW9	6744.57	663.97	1744.57	4336.03	800.37	800.13	37.03733	95.08252
Site BM	6670.06	865.87	1670.06	4134.13		BM Elevation = 800.06		

BM Description: "X" cut on the southwest corner of light pole base at southeast corner of site.

MW1, MW2, MW3, MW4, MW5, MW6, MW7, MW8 are in the:  
MW9 is in the:

NE¼ SE¼ NW¼ SW¼ S.35-T34S-R21E  
NW¼ SE¼ NW¼ SW¼ S.35-T34S-R21E

If you have any questions please do not hesitate in giving us a call.

Sincerely,



Tim Sloan, L.S.  
SMH CONSULTANTS

# SMH CONSULTANTS

March 14, 2014

Associated Environmental, Inc.  
Cole Roe  
404 Pottawatomie  
Manhattan, KS 66502  
Email: cole\_taylor@sbcglobal.net

RE: Project No. 1403MN1072

Dear Cole:

The following is the information requested on a Monitoring Well Site, Johnson's General Store, 19 East Maple, Chetopa, Labette County, Kansas.

Point	North Coord.	East Coord.	Distance SE Cor. North	From S.35 West	Elev. Top Of Rim or PK Nail	Elev. Top of PVC Pipe	Latitude North	Longitude West
SE Corner S.35-T34S-R21E	5000	5000						
MW10	6702.02	901.87	1702.02	4098.13	798.37	798.03	37.03725	95.08169
MW11	6545.19	836.50	1545.19	4163.50	799.98	799.77	37.12011	95.08197
Site BM	6670.06	865.87	1670.06	4134.13		BM Elevation = 800.06		

BM Description: "X" cut on southwest corner of light pole base at southeast corner of site.

MW10 is in the: NE¼ SE¼ NW¼ SW¼ S.35-T34S-R21E  
MW11 is in the: SE¼ SE¼ NW¼ SW¼ S.35-T34S-R21E

If you have any questions please do not hesitate in giving us a call.

Sincerely,



Tim Sloan, L.S.  
SMH CONSULTANTS