

WATER WELL PLUGGING RECORD Form WWC-5P B1-A KSA 82a-1212 ID NO.

1 LOCATION OF WATER WELL: County: Cherokee	Fraction NW 1/4 SE 1/4 NW 1/4 1/4	Section Number 20	Township Number T 34 S	Range Number 25 <input checked="" type="checkbox"/> E <input type="checkbox"/> W
--	--------------------------------------	----------------------	---------------------------	---

Street/Rural Address of Well Location; if unknown, distance & direction from nearest town or intersection: If at owner's address, check here CCW Impoundment Levee

Riverton Power Station, 7240 SE Hwy 66, Riverton, KS

Global Positioning Systems (GPS) information:
 Latitude: 37.0684 (in decimal degrees)
 Longitude: 94.7030 (in decimal degrees)
 Elevation: 828.3
 Datum: WGS84, NAD83, NAD27
 Collection Method:
 GPS unit (Make/Model: _____)
 Digital Map/Photo, Topographic Map, Land Survey
 Est. Accuracy: < 3 m, 3-5 m, 5-15 m, > 15 m

2 WATER WELL OWNER: Empire District Electric
 RR#, St. Address, Box #: P.O. Box 127
 City, State ZIP Code: Joplin, MO 64802

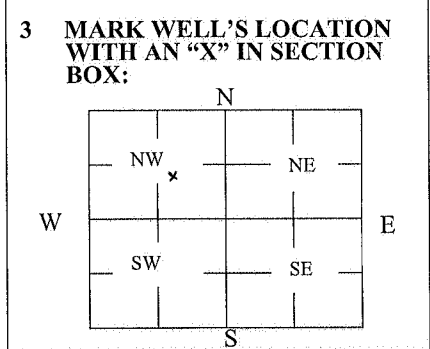

4 DEPTH OF WELL 30 ft.
 WELL'S STATIC WATER LEVEL 13.5 ft
 WELL WAS USED AS:
 Domestic Public Water Supply Dewatering
 Irrigation Oil Field Water Supply Monitoring
 Feedlot Domestic (Lawn & Garden) Injection Well
 Industrial Air Conditioning Other Piezometer
 Was a chemical/bacteriological sample submitted to Department? Yes No

5 TYPE OF BLANK CASING USED:

Steel RMP (SR) Wrought Fiberglass Other (Specify below)
 PVC ABS Asbestos-Cement Concrete Tile

Blank casing diameter 2 in. Was casing pulled? Yes No If yes, how much Full Depth
 Casing height above or below land surface NA in.

6 GROUT PLUG MATERIAL: Neat cement Cement grout Bentonite Other _____

Grout Plug Intervals: From 3 ft. to 30 ft., From _____ ft. to _____ ft., From _____ to _____ ft.

What is the nearest source of possible contamination:
 Septic tank Seepage pit Fuel Storage Other (specify below)
 Sewer lines Pit privy Fertilizer storage CCW Impoundment
 Watertight sewer lines Sewage lagoon Insecticide storage
 Lateral lines Feedyard Abandoned water well Direction from well? East
 Cess pool Livestock pens Oil well/Gas well How many feet? 5 ft.

FROM	TO	PLUGGING MATERIALS	FROM	TO	PLUGGING MATERIALS
0	3	Bentonite Chips			
3	30	Cement Grout w/ Bentonite Powder			

7 CONTRACTOR'S OR LANDOWNER'S CERTIFICATION: This water well was plugged under my jurisdiction and was completed on (mo/day/year) 6/10-11/13 and this record is true to the best of my knowledge and belief. Kansas Water Well Contractor's License No. 754. This Water Well Record was completed on (mo/day/year) 6/24/13 under the business name of Palmerton & Parrish, Inc. by (signature) *W. Parrish*

INSTRUCTIONS: Use typewriter or ballpoint pen. Please press firmly and print clearly. Please fill in blanks, underline or circle the correct answers. Send one copy to Kansas Department of Health and Environment, Bureau of Water, Geology Section, 1000 SW Jackson St., Ste. 420, Topeka, Kansas 66612-1367. Telephone: 785/296-5524. Send one to Water Well Owner and retain one for your records. Visit us at <http://www.kdheks.gov/waterwell/index.html>.

RECEIVED
 SURVEY