

WATER WELL RECORD Form WWC-5

Original Record Correction Change in Well Use

Division of Water Resources App. No.

Well ID

MW7D

1 LOCATION OF WATER WELL: County: COWLEY	Fraction NE ¼ NE ¼ NE ¼ NE ¼	Section Number 13	Township Number T 34 S	Range Number R 3 <input checked="" type="checkbox"/> E <input type="checkbox"/> W
---	--	-----------------------------	----------------------------------	---

2 WELL OWNER: Last Name: CASEY'S GENERAL STORE #3435 Business: CASEY'S GENERAL STORE #3435 Address: 3413 N. SUMMIT Address: City: ARKANSAS CITY State: KS ZIP: 67005	Street or Rural Address where well is located (if unknown, distance and direction from nearest town or intersection): If at owner's address, check here: <input checked="" type="checkbox"/>
---	--

3 LOCATE WELL WITH "X" IN SECTION BOX: 	4 DEPTH OF COMPLETED WELL: 40 ft. Depth(s) Groundwater Encountered: 1) 30 ft. 2) ft. 3) ft., or 4) <input type="checkbox"/> Dry Well WELL'S STATIC WATER LEVEL: 13.75 ft. <input checked="" type="checkbox"/> below land surface, measured on (mo-day-yr) 4/8/19 <input type="checkbox"/> above land surface, measured on (mo-day-yr) Pump test data: Well water was ft. after hours pumping gpm Well water was ft. after hours pumping gpm Estimated Yield: gpm Bore Hole Diameter: in. to ft. and in. to ft.	5 Latitude: 37.09918 (decimal degrees) Longitude: 97.04051 (decimal degrees) Horizontal Datum: <input checked="" type="checkbox"/> WGS 84 <input type="checkbox"/> NAD 83 <input type="checkbox"/> NAD 27 Source for Latitude/Longitude: <input type="checkbox"/> GPS (unit make/model:) (WAAS enabled? <input type="checkbox"/> Yes <input type="checkbox"/> No) <input checked="" type="checkbox"/> Land Survey <input type="checkbox"/> Topographic Map <input type="checkbox"/> Online Mapper: 6 Elevation: 1171.39 ft. <input type="checkbox"/> Ground Level <input checked="" type="checkbox"/> TOC Source: <input checked="" type="checkbox"/> Land Survey <input type="checkbox"/> GPS <input type="checkbox"/> Topographic Map <input type="checkbox"/> Other
---	---	--

7 WELL WATER TO BE USED AS:

1. Domestic: <input type="checkbox"/> Household <input type="checkbox"/> Lawn & Garden <input type="checkbox"/> Livestock <input type="checkbox"/> Irrigation <input type="checkbox"/> Feedlot <input type="checkbox"/> Industrial	5. <input type="checkbox"/> Public Water Supply: well ID 6. <input type="checkbox"/> Dewatering: how many wells? 7. <input type="checkbox"/> Aquifer Recharge: well ID 8. <input checked="" type="checkbox"/> Monitoring: well ID MW7D 9. Environmental Remediation: well ID <input type="checkbox"/> Air Sparge <input type="checkbox"/> Soil Vapor Extraction <input type="checkbox"/> Recovery <input type="checkbox"/> Injection	10. <input type="checkbox"/> Oil Field Water Supply: lease 11. Test Hole: well ID <input type="checkbox"/> Cased <input type="checkbox"/> Uncased <input type="checkbox"/> Geotechnical 12. Geothermal: how many bores? a) Closed Loop <input type="checkbox"/> Horizontal <input type="checkbox"/> Vertical b) Open Loop <input type="checkbox"/> Surface Discharge <input type="checkbox"/> Inj. of Water 13. <input type="checkbox"/> Other (specify):
--	---	---

Was a chemical/bacteriological sample submitted to KDHE? Yes No If yes, date sample was submitted:

Water well disinfected? Yes No

8 TYPE OF CASING USED: Steel PVC Other CASING JOINTS: Glued Clamped Welded Threaded
 Casing diameter **2** in. to **40** ft., Diameter in. to ft., Diameter in. to ft.
 Casing height above land surface in. Weight lbs./ft. Wall thickness or gauge No.

TYPE OF SCREEN OR PERFORATION MATERIAL:
 Steel Stainless Steel Fiberglass PVC Other (Specify)
 Brass Galvanized Steel Concrete tile None used (open hole)

SCREEN OR PERFORATION OPENINGS ARE:
 Continuous Slot Mill Slot Gauze Wrapped Torch Cut Drilled Holes Other (Specify)
 Louvered Shutter Key Punched Wire Wrapped Saw Cut None (Open Hole)

SCREEN-PERFORATED INTERVALS: From **20** ft. to **40** ft., From ft. to ft., From ft. to ft.
GRAVEL PACK INTERVALS: From **18** ft. to **40** ft., From ft. to ft., From ft. to ft.

9 GROUT MATERIAL: Neat cement Cement grout Bentonite Other **Concrete Surface Completion 0-1**
 Grout Intervals: From **1** ft. to **18** ft., From ft. to ft., From ft. to ft.

Nearest source of possible contamination:
 Septic Tank Lateral Lines Pit Privy Livestock Pens Insecticide Storage
 Sewer Lines Cess Pool Sewage Lagoon Fuel Storage Abandoned Water Well
 Watertight Sewer Lines Seepage Pit Feedyard Fertilizer Storage Oil Well/Gas Well
 Other (Specify)

Direction from well? **SOUTH** Distance from well? **75** ft.

10 FROM	TO	LITHOLOGIC LOG	FROM	TO	LITHO. LOG (cont.) or PLUGGING INTERVALS
0	15	SILTY CLAY			
15	18	LIMESTONE			
18	24	SANDY CLAY			
24	40	SHALE			

Notes:
U2-018-14122

11 CONTRACTOR'S OR LANDOWNER'S CERTIFICATION: This water well was constructed, reconstructed, or plugged under my jurisdiction and was completed on (mo-day-year) **4/8/19** and this record is true to the best of my knowledge and belief. Kansas Water Well Contractor's License No. **585** This Water Well Record was completed on (mo-day-year) **5/1/19** under the business name of **ASSOCIATED ENVIRONMENTAL INC.** Signature *[Signature]*

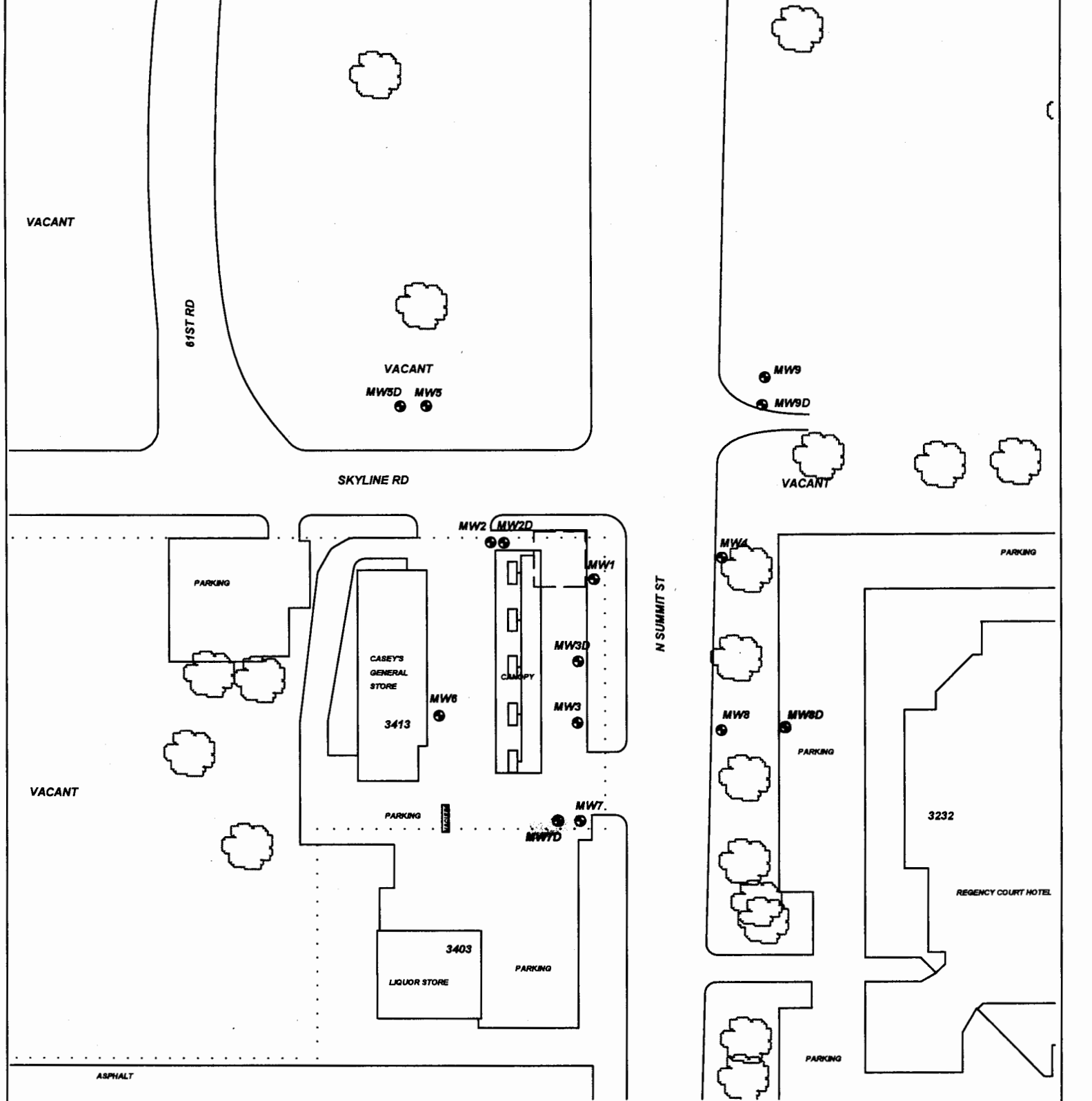

PROJECT: CASEY'S GENERAL STORE #3435

ADDRESS: 3413 N. SUMMIT

LOCATION: ARKANSAS CITY, KS

DRAWN BY: B. STALNAKER **DATE:** 4/26/17

REVISED BY: B. STALNAKER **DATE:** 4/30/19





AEI JOB #: TF501 **KDHE JOB #:** U2-018-14122

TITLE:



ASSOCIATED ENVIRONMENTAL INC.

LEGEND:

-  = CURRENT UST's (1)8,000 & (1)12,000 GAL. GASOLINE, (1)10,000 GAL. DIESEL
-  = MONITOR WELL
-  = CURRENT PUMPS AND PRODUCT LINES
-  = SUBJECT PROPERTY

SCALE: 1" = 100'



0 50 100

NOTES:
 No basements observed within 500'.
 A: DEEP WELLS, B: SHALLOW WELLS