

LOCATION OF WATER WELL:	Fraction SW SW NE NE ¼ ¼ ¼	Section Number	Township Number	Range Number
-------------------------	----------------------------------	----------------	-----------------	--------------

County: MONTGOMERY

EW

Distance and direction from nearest town or city street address of well if located within city?

Coffeyville Resources Refining & Marketing LLC

WATER WELL OWNER: Coffeyville, KS.

RR #, St. Address, Box #: 707 E 11TH Board of Agriculture, Division of Water Resources

City, State, ZIP Code: _____ Application Number: _____

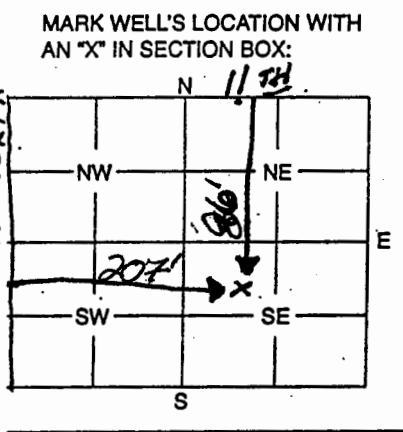

4 DEPTH OF WELL 19' ft.

WELL'S STATIC WATER LEVEL 10' ft.

WELL WAS USED AS:

<input checked="" type="radio"/> 1 Domestic	<input type="radio"/> 5 Public Water Supply	<input type="radio"/> 9 Dewatering
<input type="radio"/> 2 Irrigation	<input type="radio"/> 6 Oil Field Water Supply	<input type="radio"/> 10 Monitoring Well
<input type="radio"/> 3 Feedlot	<input type="radio"/> 7 Domestic (Lawn & Garden)	<input type="radio"/> 11 Injection Well
<input type="radio"/> 4 Industrial	<input type="radio"/> 8 Air Conditioning	<input type="radio"/> 12 Other

Was a chemical / bacteriological sample submitted to Department? Yes No

If yes, mo/day/yr sample was submitted

Water Well Disinfected: Yes .. No

TYPE OF BLANK CASING USED:

<input type="checkbox"/> 1 Steel	<input type="checkbox"/> 3 RMP (SR)	<input type="checkbox"/> 5 Wrought	<input type="checkbox"/> 7 Fiberglass	<input checked="" type="checkbox"/> 9 Other (Specify below) <u>BRICK</u>
<input type="checkbox"/> 2 PVC	<input type="checkbox"/> 4 ABS	<input type="checkbox"/> 6 Asbestos-Cement	<input type="checkbox"/> 8 Concrete Tile	

Blank casing diameter 3' 8" in. Was casing pulled? Yes No If yes, how much TOTAL

Casing height above or below land surface

GROUT PLUG MATERIAL: 1 Neat cement 2 Cement grout 3 Bentonite 4 Other Flowable Fill

Grout Plug Intervals: From ft. to ft., From ft. to ft., From to

What is the nearest source of possible contamination:

<input type="checkbox"/> 1 Septic tank	<input type="checkbox"/> 6 Seepage pit	<input type="checkbox"/> 11 Fuel storage	<input type="checkbox"/> 16 Other (specify below)
<input checked="" type="checkbox"/> 2 Sewer lines	<input type="checkbox"/> 7 Pit privy	<input type="checkbox"/> 12 Fertilizer storage	
<input type="checkbox"/> 3 Watertight sewer lines	<input type="checkbox"/> 8 Sewage lagoon	<input type="checkbox"/> 13 Insecticide storage	
<input type="checkbox"/> 4 Lateral lines	<input type="checkbox"/> 9 Feedyard	<input type="checkbox"/> 14 Abandoned water well	
<input type="checkbox"/> 5 Cess pool	<input type="checkbox"/> 10 Livestock pens	<input type="checkbox"/> 15 Oil well/Gas well	

Direction from well? SOUTH How many feet? 50'

FROM	TO	PLUGGING MATERIALS
19'	10'	Chlorinated Rock
10'	3' 6"	Compacted Soil
3' 6"	3'	Flowable Fill
3'	Grade	Compacted Soil

CONTRACTOR'S OF LANDOWNER'S CERTIFICATION: This water well was plugged under my jurisdiction and was completed on (mo/day/year) 01/25/08 and this record is true to the best of my knowledge and belief. Kansas Water Well Contractor's License No. _____ This Water Well Record was completed on (mo/day/year) _____ under the business name of _____ by (signature) _____

INSTRUCTIONS: Use typewriter or ball point pen. Please press firmly and print clearly. Please fill in blanks, underline or circle the correct answers. Send top three copies to Kansas Department of Health and Environment, Bureau of Water, Geology Section, 1000 SW Jackson Ste. 420, Topeka, Kansas 66612-1367. Telephone: 785/296-5522. Send one to Water Well Owner and retain one for your records.