

LEGEND

- = Parcel Boundary
- = Site Boundary
- = Pump Islands & Product Lines
- = Current UST
- = Fence
- = Proposed Monitoring Well
- = Destroyed/Plugged Well
- = Proposed Soil Boring
- = Proposed Geotech Boring
- = Overhead Electric (-20')
- = Underground Elec. (24" bgs)
- = Gas (24" bgs)
- = Sewer (30-48" bgs)
- = Communications (24" bgs)

*Water line locations are unknown

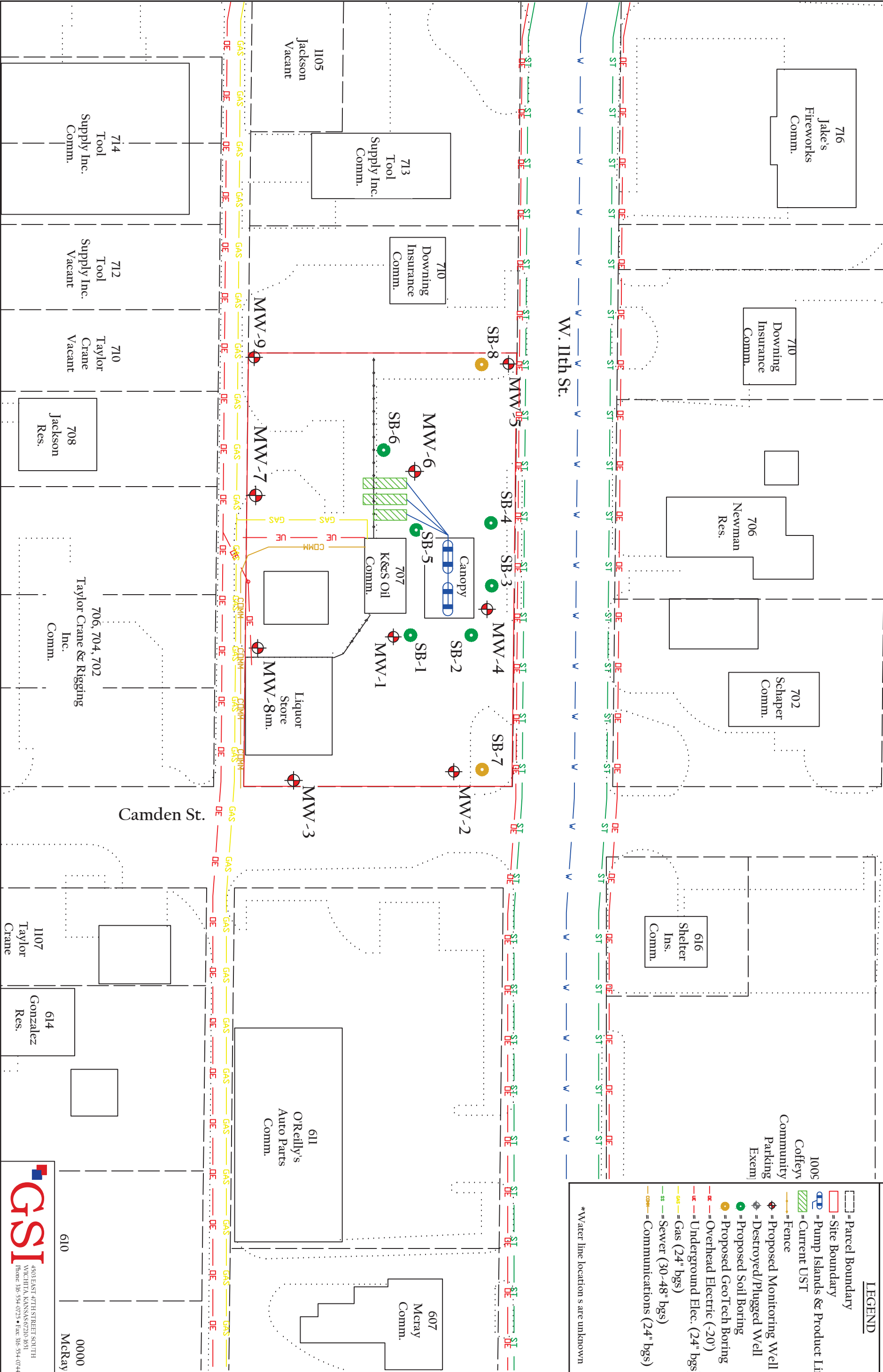

K&S Oil Co. # 1
 707 West 11th St.
 Coffeyville, Kansas
 KDHE#: U3-063-14926

JOB#: 1774097	DRAWN BY: CD
DATE: 2017-08-31	PROJ. MANGR: DR

4501 EAST 47TH STREET SOUTH
 WICHITA, KANSAS 67210-1651
 Phone: 316-534-0725 • Fax: 316-534-0744