

CORRECTION(S) TO WATER WELL RECORD (WWC-5)

(to rectify lacking or incorrect information)

County: Montgomery

Location listed as:

Location changed to:

Section-Township-Range: None Given

6-355-17E

Fraction (  $\frac{1}{4}$   $\frac{1}{4}$   $\frac{1}{4}$ ): \_\_\_\_\_

NE NE NW NW

Other changes: Initial statements: No owner name given.

Changed to: Coffeyville Resources Refining & Marketing, LLC

Comments: Owner's name from county assessor's parcel search online.

verification method: Well address, city street map, plat map, and mapping tool on KGS website.

initials: DR date: 12/3/2008

submitted by: Kansas Geological Survey, Data Resources Library, 1930 Constant Ave., Lawrence, KS 66047-3726

to: Kansas Dept of Health & Environment, Bureau of Water, 1000 SW Jackson, Suite 420, Topeka, KS 66612-1367.

<b>1</b> LOCATION OF WATER WELL:	Fraction	Section Number	Township Number	Range Number
County: <u>MONTGOMERY</u>	$\frac{1}{4}$ $\frac{1}{4}$ $\frac{1}{4}$			EW

Distance and direction from nearest town or city street address of well if located within city?

**2** WATER WELL OWNER: Coffeyville, KS  
 RR #, St. Address, Box #: 1215 E 8TH  
 City, State, ZIP Code : Coffeyville, KS  
 Board of Agriculture, Division of Water Resources  
 Application Number: \_\_\_\_\_

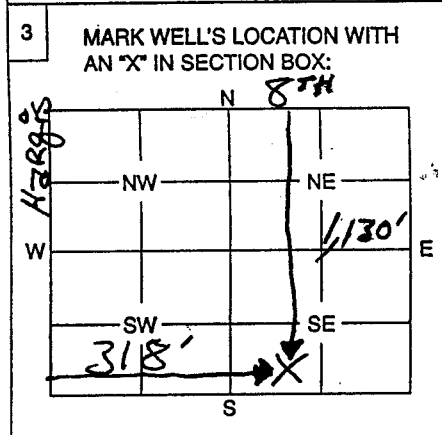

**4** DEPTH OF WELL 18' ft.  
 WELL'S STATIC WATER LEVEL 13' ft.  
 WELL WAS USED AS:  
 1 Domestic      5 Public Water Supply      9 Dewatering  
 2 Irrigation      6 Oil Field Water Supply      10 Monitoring Well  
 3 Feedlot      7 Domestic (Lawn & Garden)      11 Injection Well  
 4 Industrial      8 Air Conditioning      12 Other \_\_\_\_\_  
 Was a chemical / bacteriological sample submitted to Department? Yes \_\_\_\_\_ No  \_\_\_\_\_  
 If yes, mo/day/yr sample was submitted \_\_\_\_\_  
 Water Well Disinfected: Yes  No \_\_\_\_\_

**5** TYPE OF BLANK CASING USED:  
 1 Steel      3 RMP (SR)      5 Wrought      7 Fiberglass      9 Other (Specify below) ROCK  
 2 PVC      4 ABS      6 Asbestos-Cement      8 Concrete Tile  
 Blank casing diameter 5' in.      Was casing pulled? Yes  No \_\_\_\_\_      If yes, how much Total \_\_\_\_\_  
 Casing height above or below land surface \_\_\_\_\_ in.

**6** GROUT PLUG MATERIAL: 1 Neat cement      2 Cement grout      3 Bentonite      4 Other Flowable Fill  
 Grout Plug Intervals: From \_\_\_\_\_ ft. to \_\_\_\_\_ ft., From \_\_\_\_\_ ft. to \_\_\_\_\_ ft., From \_\_\_\_\_ to \_\_\_\_\_ ft.  
 What is the nearest source of possible contamination:  
 1 Septic tank      6 Seepage pit      11 Fuel storage      16 Other (specify below) \_\_\_\_\_  
 2 Sewer lines      7 Pit privy      12 Fertilizer storage      \_\_\_\_\_  
 3 Watertight sewer lines      8 Sewage lagoon      13 Insecticide storage      \_\_\_\_\_  
 4 Lateral lines      9 Feedyard      14 Abandoned water well      \_\_\_\_\_  
 5 Cess pool      10 Livestock pens      15 Oil well/Gas well      \_\_\_\_\_  
 Direction from well? \_\_\_\_\_      How many feet? \_\_\_\_\_

FROM	TO	PLUGGING MATERIALS
	<u>18'</u>	<u>Excavate Completely</u>
<u>18'</u>	<u>13'</u>	<u>Chlorinated Rock</u>
<u>13'</u>	<u>3'6"</u>	<u>Compacted Soil</u>
<u>3'6"</u>	<u>3'</u>	<u>Flowable Fill</u>
<u>3'</u>	<u>Grade</u>	<u>Compacted Fill</u>

**7** CONTRACTOR'S OF LANDOWNER'S CERTIFICATION: This water well was plugged under my jurisdiction and was completed on (mo/day/year) \_\_\_\_\_ and this record is true to the best of my knowledge and belief. Kansas Water Well Contractor's License No. \_\_\_\_\_ This Water Well Record was completed on (mo/day/year) 3/2/08 under the business name of \_\_\_\_\_ by (signature) [Signature]

**INSTRUCTIONS:** Use typewriter or ball point pen. Please press firmly and print clearly. Please fill in blanks, underline or circle the correct answers. Send top three copies to Kansas Department of Health and Environment, Bureau of Water, Geology Section, 1000 SW Jackson St., Ste. 420, Topeka, Kansas 66612-1367. Telephone: 785/296-5522. Send one to Water Well Owner and retain one for your records.