

County: Brown Fraction: SW SW NE SW Sec. 4 T. 3 S R. 18 E

CORRECTION(S) to WATER WELL COMPLETION RECORD Form WWC-5 (to rectify lacking or incorrect information)

Owner: Muckey, Angie

If location corrected, was listed as:

Section-Township-Range: _____

Fraction (1/4 calls): _____

Location changed to:

Other changes: Initial statements: _____

Sedgwick County changed to Brown County

Changed to: _____

Comments: _____

Verification method: Checked the well's address against the WWC-5 mapper

Submitted by: _____ Initials: BK Date: 2021-18-3

Kansas Geological Survey, Data Resources Library, 1930 Constant Ave., Lawrence, KS 66047-3724

Kansas Dept. of Health & Environment, Bureau of Water, 1000 SW Jackson, Suite 420, Topeka, KS 66612-1367

WATER WELL RECORD

Form WWC-5

Division of Water Resources App. No.

[Empty Box]

Well ID

MW13

[X] Original Record [] Correction [] Change in Well Use

1 LOCATION OF WATER WELL: County Sedgwick Fraction SE 1/4 SE 1/4 NW 1/4 SW 1/4 Section Number 4 Township Number T 3 S Range Number R 18 [X] E [] W

2 WELL OWNER: Last Name: Muckey First: Angie Street or Rural Address where well is located (if unknown, distance and direction from nearest town or intersection): 121 Parsons St., Robinson

3 LOCATE WELL WITH "X" IN SECTION BOX: [Diagram] 4 DEPTH OF COMPLETED WELL: 15.5 ft 5 Latitude: 39.81611 Longitude: 95.41000

7 WELL WATER TO BE USED AS: 1 Domestic: [] Household [] Lawn & Garden [] Livestock [] Irrigation [] Feedlot [] Industrial

Was a chemical/bacteriological sample submitted to KDHE? [] Yes [X] No If yes, date sample was submitted:

8 TYPE OF CASING USED: [] Steel [X] PVC [] Other CASING JOINTS: [] Glued [] Clamped [] Welded [X] Threaded

TYPE OF SCREEN OR PERFORATION MATERIAL: [] Steel [] Stainless Steel [] Fiberglass [X] PVC [] Brass [] Galvanized Steel [] Concrete tile [] None used (open hole)

9 GROUT MATERIAL: [] Neat cement [] Cement grout [X] Bentonite [X] Other Concrete: 0-0.5'

Nearest source of possible contamination: [] Septic Tank [] Lateral Lines [] Pit Privy [] Livestock Pens [] Insecticide Storage [] Sewer Lines [] Cess Pool [] Sewage Lagoon [X] Fuel Storage [] Abandoned Water Well

Table with 6 columns: FROM, TO, LITHOLOGIC LOG, FROM, TO, LITHO. LOG (cont.) or PLUGGING INTERVALS. Rows include Topsoil, Sand, Clay.

Notes: KDHE ID: 129 Parsons; U4-007-14498 Target of monitoring well is shallow groundwater, <20' of grout was installed at the direction of KDHE.

11 CONTRACTOR'S OR LANDOWNER'S CERTIFICATION: This water well was [X] constructed, [] reconstructed or [] plugged under my jurisdiction and was completed on (mo-day-year) 11/18/21

DENNIS L HANDKE

1820 NW 59th Terrace
TOPEKA, KANSAS 66618
785-286-4047 Home

Jess Chapman
Larsen & Associates
1311 E. 25th Street, Suite B
Lawrence, Kansas, 66046

November 26, 2021

RE: Monitor Well Elevation Survey
129 Parsons St, Robinson, Kansas

Proj. 21-00SS
129 Parsons
U4-007-14498

Bench Mark: "M" in Mueller on top of fire hydrant at the SW Corner of Mitchell Ave. and Parsons Street.
Elev: 954.80 North 1486.03 West 3946.12 (from SE Cor. Sec. 4-3-18E)

MW-12	rim	952.61	North	1535.79	SW1/4,SW1/4,NE1/4,SW1/4
	top pipe	952.19	West	3890.91	Lat= 39.81691 Long = 95.41033
MW-13	rim	952.55	North	1353.55	SE1/4,SE1/4,NW1/4,SW1/4
	top pipe	951.96	West	3980.49	Lat= 39.81611 Long = 95.41000
MW-14	rim	951.85	North	1521.14	SW1/4,SW1/4,NE1/4,SW1/4
	top pipe	951.34	West	3947.95	Lat= 39.81615 Long = 95.41055

Lat & Long derived from Robinson 7.5' quad map. WGS84

Elevation established from existing project. NAVD 88

If you have any questions, please feel free to call me. Thank you for the opportunity to be of service to you.

Dennis L Handke RL, 2021
Dennis L Handke
LAND SURVEYOR

RECEIVED
DEC 16 2021
BUREAU OF WATER

NOTE: Figures exhibited within this report are only to be used within the context of this report. Placement of property lines, wells, structures, and roads is based on the available information from county appraiser maps, surveys, site visits, and/or previous vendor reports and should be considered approximate.

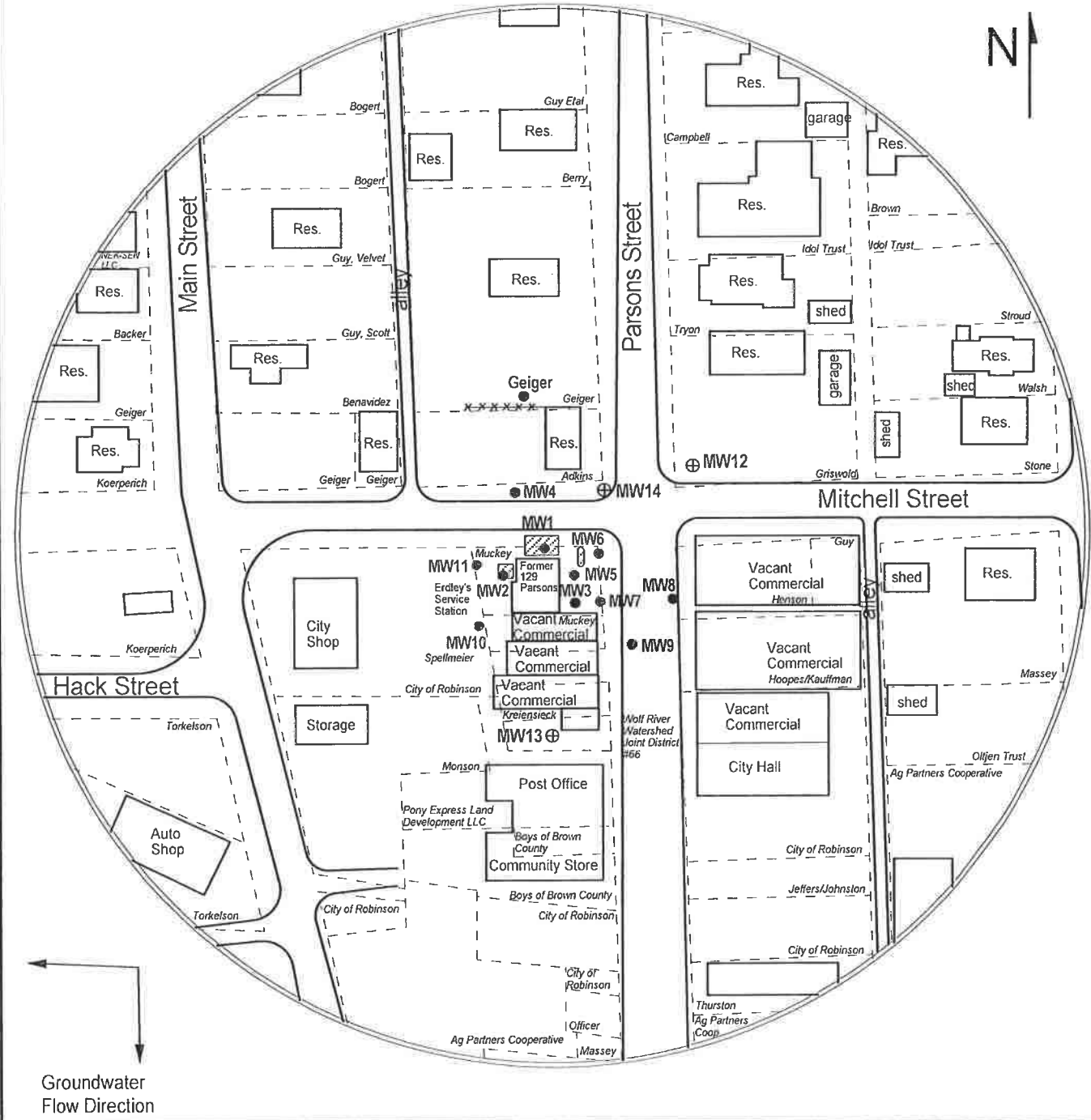

FIGURE 1 - SITE BASE MAP

larsen
& ASSOCIATES, INC.

PROJECT:
 129 Parsons
 129 Parsons Street
 Robinson, KS
 KDHE ID: U4-007-14498
 Date: 11/18/21

1311 E 25th St., Suite B (785) 841-8707 office
 Lawrence, KS 66046 (785) 865-4282 fax



- LEGEND:**
- Approximate Location of Former UST Basin and Pump Island
 - Approximate Location of Property Line
 - Monitoring Well
 - New Monitoring Well (installed 11/18/21)

RECEIVED
 FEB 16 2022
 KS GEOLOGICAL SURVEY

NOTE: Approximate location of product lines is unknown.