

County: Brown Fraction: SW SW NE SW Sec. 4 T. 3 S R. 18 E

**CORRECTION(S) to WATER WELL COMPLETION RECORD Form WWC-5** (to rectify lacking or incorrect information)

Owner: Muckey, Angie

If location corrected, was listed as:

Section-Township-Range: \_\_\_\_\_

Fraction (1/4 calls): \_\_\_\_\_

Location changed to:

\_\_\_\_\_

\_\_\_\_\_

Other changes: Initial statements: \_\_\_\_\_

Sedgwick County changed to Brown County

Changed to: \_\_\_\_\_

\_\_\_\_\_

Comments: \_\_\_\_\_

\_\_\_\_\_

Verification method: Checked the well's address against the WWC-5 mapper

\_\_\_\_\_

Submitted by: \_\_\_\_\_ Initials: BK Date: 2021-18-3

Kansas Geological Survey, Data Resources Library, 1930 Constant Ave., Lawrence, KS 66047-3724

Kansas Dept. of Health & Environment, Bureau of Water, 1000 SW Jackson, Suite 420, Topeka, KS 66612-1367

WATER WELL RECORD

Form WWC-5

Division of Water Resources App. No.

Well ID

MW14

[X] Original Record [ ] Correction [ ] Change in Well Use

1 LOCATION OF WATER WELL: County Sedgwick Fraction SW 1/4 SW 1/4 NE 1/4 SW 1/4 Section Number 4 Township Number T 3 S Range Number R 18 [X] E [ ] W

2 WELL OWNER: Last Name: Muckey First: Angie Street or Rural Address where well is located (if unknown, distance and direction from nearest town or intersection): ~30' north of 129 Parsons St., Robinson

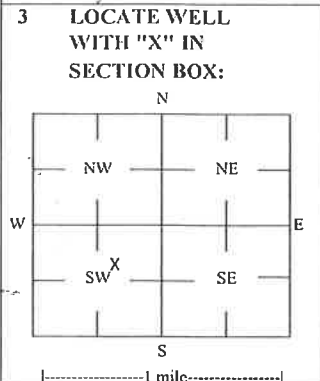

4 DEPTH OF COMPLETED WELL: 15.5 ft Depth(s) Groundwater Encountered: 1) 15.5 ft 2) \_\_\_\_\_ ft 3) \_\_\_\_\_ ft, or 4) [ ] Dry Well WELL'S STATIC WATER LEVEL: NA ft [X] below land surface, measured on (mo-day-yr) NA

5 Latitude: 39.81615 (decimal degrees) Longitude: 95.41055 (decimal degrees) Horizontal Datum: [X] WGS 84 [ ] NAD 83 [ ] NAD 27 Source for Latitude/Longitude: [ ] GPS (unit make/model: \_\_\_\_\_) (WAAS enabled? [ ] Yes [ ] No) [X] Land Survey [ ] Topographic Map [ ] Online Mapper

6 Elevation: 951.34 ft [ ] Ground Level [X] TOC Source: [X] Land Survey [ ] GPS [ ] Topographic Map [ ] Other

7 WELL WATER TO BE USED AS: 1 Domestic: [ ] Household [ ] Lawn & Garden [ ] Livestock [ ] Irrigation [ ] Feedlot [ ] Industrial 2 Public Water Supply: well ID 3 Dewatering: how many wells? 4 Aquifer Recharge: well ID 5 Monitoring: well ID MW14 6 Environmental Remediation: well ID 7 Air Sparge [ ] Soil Vapor Extractor 8 Recovery [ ] Injection 9 Oil Field Water Supply: lease 10 Test Hole: well ID [ ] Cased [ ] Uncased [ ] Geotechnical 11 Geothermal: How many bores? a) Closed Loop [ ] Horizontal [ ] Vertical b) Open Loop [ ] Surface Discharge [ ] Inj. of Water [ ] Other (specify): \_\_\_\_\_

Was a chemical/bacteriological sample submitted to KDHE? [ ] Yes [X] No If yes, date sample was submitted: \_\_\_\_\_ Water well disinfected? [ ] Yes [X] No

8 TYPE OF CASING USED: [ ] Steel [X] PVC [ ] Other CASING JOINTS: [ ] Glued [ ] Clamped [ ] Welded [X] Threaded Casing diameter 2 in. to 5.5 ft, Diameter \_\_\_\_\_ in. to \_\_\_\_\_ ft, Diameter \_\_\_\_\_ in. to \_\_\_\_\_ ft, Casing height above land surface -0.51 in. Weight \_\_\_\_\_ lbs./ft. Well thickness or gauge No \_\_\_\_\_ TYPE OF SCREEN OR PERFORATION MATERIAL: [ ] Steel [ ] Stainless Steel [ ] Fiberglass [X] PVC [ ] Brass [ ] Galvanized Steel [ ] Concrete tile [ ] None used (open hole) [ ] Other (Specify) \_\_\_\_\_ SCREEN OR PERFORATION OPENINGS ARE: [ ] Continuous Slot [X] Mill Slot [ ] Gauze Wrapped [ ] Torch Cut [ ] Drilled Holes [ ] Other (Specify) [ ] Louvered Shutter [ ] Key Punched [ ] Wire Wrapped [ ] Saw Cut [ ] None (Open Hole) SCREEN-PERFORATED INTERVALS: From 5.5 ft. to 15.5 ft, From \_\_\_\_\_ ft. to \_\_\_\_\_ ft, From \_\_\_\_\_ ft. to \_\_\_\_\_ ft, GRAVEL PACK INTERVALS: From 3.5 ft. to 15.5 ft, From \_\_\_\_\_ ft. to \_\_\_\_\_ ft, From \_\_\_\_\_ ft. to \_\_\_\_\_ ft,

9 GROUT MATERIAL: [ ] Neat cement [ ] Cement grout [X] Bentonite [X] Other Concrete: 0-0.5' Grout intervals: From 0.5 ft. to 3.5 ft, From \_\_\_\_\_ ft. to \_\_\_\_\_ ft, From \_\_\_\_\_ ft. to \_\_\_\_\_ ft,

Nearest source of possible contamination: [ ] Septic Tank [ ] Lateral Lines [ ] Pit Privy [ ] Livestock Pens [ ] Insecticide Storage [ ] Sewer Lines [ ] Cess Pool [ ] Sewage Lagoon [X] Fuel Storage [ ] Abandoned Water Well [ ] Watertight Sewer Lines [ ] Seepage Pit [ ] Feedyard [ ] Fertilizer Storage [ ] Oil Well / Gas Well [ ] Other (Specify) \_\_\_\_\_ Direction from well? SW Distance from well? ~45 ft

Table with 6 columns: 10 FROM, TO, LITHOLOGIC LOG, FROM, TO, LITHO. LOG (cont.) or PLUGGING INTERVALS. Row 1: 0, 0.8, Concrete and Asphalt, , , . Row 2: 0.8, 15.5, Clay, , , .

Notes: KDHE ID: 129 Parsons; U4-007-14498 Target of monitoring well is shallow groundwater, <20' of grout was installed at the direction of KDHE.

11 CONTRACTOR'S OR LANDOWNER'S CERTIFICATION: This water well was [X] constructed, [ ] reconstructed, or [ ] plugged under my jurisdiction and was completed on (mo-day-year) 11/18/21 and this record is true to the best of my knowledge and belief. Kansas Water Well Contractor's License No. 757 This Water Well Record was completed on (mo-day-year) 12/2/21 under the business name of Larsen & Associates, Inc. Signature \_\_\_\_\_

# DENNIS L HANDKE

1820 NW 59th Terrace  
TOPEKA, KANSAS 66618  
785-286-4047 Home

Jess Chapman  
Larsen & Associates  
1311 E. 25<sup>th</sup> Street, Suite B  
Lawrence, Kansas, 66046

November 26, 2021

RE: Monitor Well Elevation Survey  
129 Parsons St, Robinson, Kansas

Proj. 21-00SS  
129 Parsons  
U4-007-14498

Bench Mark: "M" in Mueller on top of fire hydrant at the SW Corner of Mitchell Ave. and Parsons Street.  
Elev: 954.80      North 1486.03      West 3946.12      (from SE Cor. Sec. 4-3-18E)

MW-12	rim	952.61	North	1535.79	SW1/4,SW1/4,NE1/4,SW1/4
	top pipe	952.19	West	3890.91	Lat= 39.81691   Long = 95.41033
MW-13	rim	952.55	North	1353.55	SE1/4,SE1/4,NW1/4,SW1/4
	top pipe	951.96	West	3980.49	Lat= 39.81611   Long = 95.41000
MW-14	rim	951.85	North	1521.14	SW1/4,SW1/4,NE1/4,SW1/4
	top pipe	951.34	West	3947.95	Lat= 39.81615   Long = 95.41055

Lat & Long derived from Robinson 7.5' quad map. WGS84

Elevation established from existing project. NAVD 88

If you have any questions, please feel free to call me. Thank you for the opportunity to be of service to you.

Dennis L Handke RL, 2021  
*Dennis L Handke*  
LAND SURVEYOR

RECEIVED  
DEC 16 2021  
BUREAU OF WATER

NOTE: Figures exhibited within this report are only to be used within the context of this report. Placement of property lines, wells, structures, and roads is based on the available information from county appraiser maps, surveys, site visits, and/or previous vendor reports and should be considered approximate.

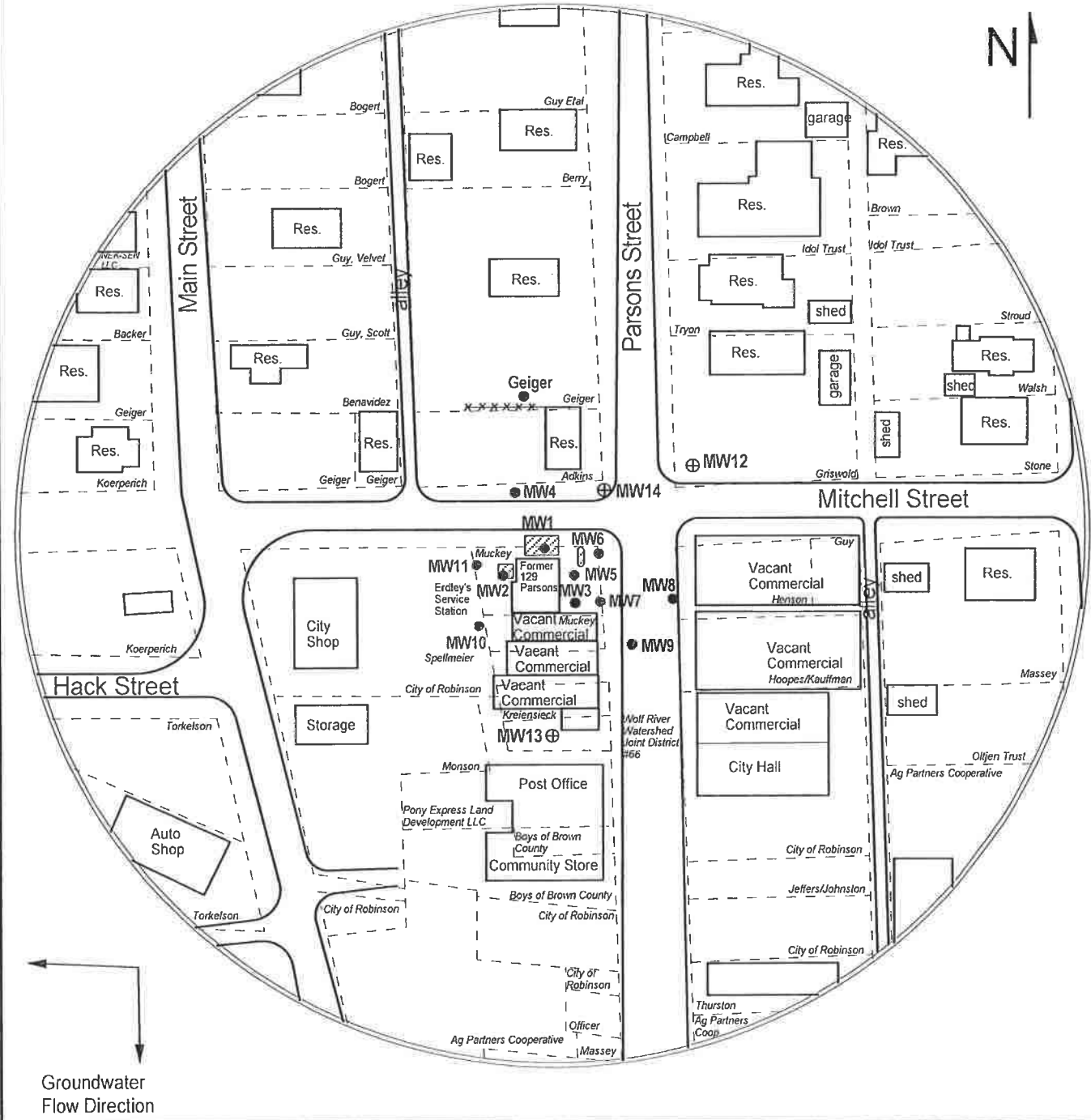

FIGURE 1 - SITE BASE MAP

**LEGEND:**

- Approximate Location of Former UST Basin and Pump Island
- Approximate Location of Property Line
- Monitoring Well
- New Monitoring Well (installed 11/18/21)



**PROJECT:**  
 129 Parsons  
 129 Parsons Street  
 Robinson, KS  
 KDHE ID: U4-007-14498  
 Date: 11/18/21



RECEIVED

FEB 16 2022

KS GEOLOGICAL SURVEY

1311 E 25th St., Suite B (785) 841-8707 office  
 Lawrence, KS 66046 (785) 865-4282 fax

NOTE: Approximate location of product lines is unknown.