

County: Brown Fraction: SW SW NE SW Sec. 4 T. 3 S R. 18 E

**CORRECTION(S) to WATER WELL COMPLETION RECORD Form WWC-5** (to rectify lacking or incorrect information)

Owner: Muckey, Angie

**If location corrected, was listed as:**

Section-Township-Range: \_\_\_\_\_

Fraction (1/4 calls): \_\_\_\_\_

**Location changed to:**

\_\_\_\_\_

\_\_\_\_\_

**Other changes:** Initial statements: \_\_\_\_\_

Sedgwick County changed to Brown County

Changed to: \_\_\_\_\_

\_\_\_\_\_

Comments: \_\_\_\_\_

\_\_\_\_\_

Verification method: Checked the well's address against the WWC-5 mapper

\_\_\_\_\_

Submitted by: \_\_\_\_\_ Initials: BK Date: 2021-18-3

Kansas Geological Survey, Data Resources Library, 1930 Constant Ave., Lawrence, KS 66047-3724

Kansas Dept. of Health & Environment, Bureau of Water, 1000 SW Jackson, Suite 420, Topeka, KS 66612-1367

**WATER WELL RECORD**

**Form WWC-5**

Division of Water  
Resources App. No.

Well ID

**MW12**

Original Record     Correction     Change in Well Use

**1 LOCATION OF WATER WELL:**  
 County Sedgwick    Fraction SW ¼ SW ¼ NE ¼ SW ¼    Section Number 4    Township Number T 3 S    Range Number R 18  E  W

**2 WELL OWNER:** Last Name: Muckey    First: Angie  
 Business:    Street or Rural Address where well is located (if unknown, distance and direction from nearest town or intersection): If at owner's address, check here:   
 Address: 605 Golden Gate    204 Parsons St., Robinson  
 Address:    City Robinson    State: KS    ZIP: 66532

**3 LOCATE WELL WITH "X" IN SECTION BOX:**  
 N  
 NW    NE  
 W    X    E  
 SW    SE  
 S  
 |-----1 mile-----|

**4 DEPTH OF COMPLETED WELL:** 15 ft  
 Depth(s) Groundwater Encountered: 1) \_\_\_\_\_ ft  
 2) \_\_\_\_\_ ft 3) \_\_\_\_\_ ft, or 4)  Dry Well  
 WELL'S STATIC WATER LEVEL: NA ft.  
 below land surface, measured on (mo-day-yr) NA  
 above land surface, measured on (mo-day-yr) \_\_\_\_\_  
 Pump test data: Well water was \_\_\_\_\_ ft  
 after \_\_\_\_\_ hours pumping \_\_\_\_\_ gpm  
 Water well was \_\_\_\_\_ ft  
 after \_\_\_\_\_ hours pumping \_\_\_\_\_ gpm  
 Estimated Yield: \_\_\_\_\_ gpm  
 Bore Hole Diameter: 7.25 in to \_\_\_\_\_ ft, and  
 \_\_\_\_\_ in to \_\_\_\_\_ ft

**5 Latitude:** 39.81691 (decimal degrees)  
**Longitude:** 95.41033 (decimal degrees)  
 Horizontal Datum  WGS 84  NAD 83  NAD 27  
 Source for Latitude/Longitude:  
 GPS (unit make/model: \_\_\_\_\_)  
 (WAAS enabled?  Yes  No)  
 Land Survey  Topographic Map  
 Online Mapper  
**6 Elevation:** 952.19 ft  Ground Level  TOC  
 Source  Land Survey  GPS  Topographic Map  
 Other \_\_\_\_\_

**7 WELL WATER TO BE USED AS:**  
 1 Domestic:  Household  Lawn & Garden  Livestock  Irrigation  Feedlot  Industrial  
 2  Public Water Supply: well ID \_\_\_\_\_  
 3  Dewatering: how many wells? \_\_\_\_\_  
 4  Aquifer Recharge: well ID \_\_\_\_\_  
 5  Monitoring: well ID MW12  
 6  Environmental Remediation: well ID \_\_\_\_\_  
 7  Air Sparge  Soil Vapor Extraction  
 8  Recovery  Injection  
 9  Oil Field Water Supply: lease \_\_\_\_\_  
 10  Test Hole: well ID \_\_\_\_\_  
 Cased  Uncased  Geotechnical  
 11 Geothermal: How many bores?  
 a) Closed Loop  Horizontal  Vertical  
 b) Open Loop  Surface Discharge  Inj. of Water  
 Other (specify): \_\_\_\_\_

Was a chemical/bacteriological sample submitted to KDHE?  Yes  No    If yes, date sample was submitted: \_\_\_\_\_  
 Water well disinfected?  Yes  No

**8 TYPE OF CASING USED:**  Steel  PVC  Other \_\_\_\_\_    CASING JOINTS:  Glued  Clamped  Welded  Threaded  
 Casing diameter 2 in. to 5 ft, Diameter \_\_\_\_\_ in. to \_\_\_\_\_ ft, Diameter \_\_\_\_\_ in. to \_\_\_\_\_ ft,  
 Casing height above land surface -0.42 in. Weight \_\_\_\_\_ lbs./ft. Well thickness or gauge No \_\_\_\_\_  
**TYPE OF SCREEN OR PERFORATION MATERIAL:**  
 Steel  Stainless Steel  Fiberglass  PVC  Other (Specify) \_\_\_\_\_  
 Brass  Galvanized Steel  Concrete tile  None used (open hole)  
**SCREEN OR PERFORATION OPENINGS ARE:**  
 Continuous Slot  Mill Slot  Gauze Wrapped  Torch Cut  Drilled Holes  Other (Specify) \_\_\_\_\_  
 Louvered Shutter  Key Punched  Wire Wrapped  Saw Cut  None (Open Hole)  
**SCREEN-PERFORATED INTERVALS:** From 5 ft. to 15 ft, From \_\_\_\_\_ ft. to \_\_\_\_\_ ft, From \_\_\_\_\_ ft. to \_\_\_\_\_ ft,  
**GRAVEL PACK INTERVALS:** From 3 ft. to 15 ft, From \_\_\_\_\_ ft. to \_\_\_\_\_ ft, From \_\_\_\_\_ ft. to \_\_\_\_\_ ft,

**9 GROUT MATERIAL:**  Neat cement  Cement grout  Bentonite  Other Concrete: 0-0.5'  
 Grout intervals: From 0.5 ft. to 3 ft, From \_\_\_\_\_ ft. to \_\_\_\_\_ ft, From \_\_\_\_\_ ft. to \_\_\_\_\_ ft.

**Nearest source of possible contamination:**  
 Septic Tank  Lateral Lines  Pit Privy  Livestock Pens  Insecticide Storage  
 Sewer Lines  Cess Pool  Sewage Lagoon  Fuel Storage  Abandoned Water Well  
 Watertight Sewer Lines  Seepage Pit  Feedyard  Fertilizer Storage  Oil Well / Gas Well  
 Other (Specify) \_\_\_\_\_  
 Direction from well? SW    Distance from well? -90 ft

10 FROM	TO	LITHOLOGIC LOG	FROM	TO	LITHO. LOG (cont.) or PLUGGING INTERVALS
0	0.5	Topsoil			
0.5	15	Clay			

Notes: KDHE ID: 129 Parsons; U4-007-14498  
 Target of monitoring well is shallow groundwater, <20' of grout was installed at the direction of KDHE.

**11 CONTRACTOR'S OR LANDOWNER'S CERTIFICATION:** This water well was  constructed,  reconstructed, or  plugged under my jurisdiction and was completed on (mo-day-year) 11/18/21 and this record is true to the best of my knowledge and belief. Kansas Water Well Contractor's License No 757    This Water Well Record was completed on (mo-day-year) 12/2/21 under the business name of Larsen & Associates, Inc.    Signature \_\_\_\_\_

# DENNIS L HANDKE

1820 NW 59th Terrace  
TOPEKA, KANSAS 66618  
785-286-4047 Home

Jess Chapman  
Larsen & Associates  
1311 E. 25<sup>th</sup> Street, Suite B  
Lawrence, Kansas, 66046

November 26, 2021

RE: Monitor Well Elevation Survey  
129 Parsons St, Robinson, Kansas

Proj. 21-00SS  
129 Parsons  
U4-007-14498

Bench Mark: "M" in Mueller on top of fire hydrant at the SW Corner of Mitchell Ave. and Parsons Street.  
Elev: 954.80      North 1486.03      West 3946.12      (from SE Cor. Sec. 4-3-18E)

MW-12	rim	952.61	North	1535.79	SW1/4,SW1/4,NE1/4,SW1/4
	top pipe	952.19	West	3890.91	Lat= 39.81691   Long = 95.41033
MW-13	rim	952.55	North	1353.55	SE1/4,SE1/4,NW1/4,SW1/4
	top pipe	951.96	West	3980.49	Lat= 39.81611   Long = 95.41000
MW-14	rim	951.85	North	1521.14	SW1/4,SW1/4,NE1/4,SW1/4
	top pipe	951.34	West	3947.95	Lat= 39.81615   Long = 95.41055

Lat & Long derived from Robinson 7.5' quad map. WGS84

Elevation established from existing project. NAVD 88

If you have any questions, please feel free to call me. Thank you for the opportunity to be of service to you.

Dennis L Handke RL, 2021  
*Dennis L Handke*  
LAND SURVEYOR

RECEIVED  
DEC 16 2021  
BUREAU OF WATER

NOTE: Figures exhibited within this report are only to be used within the context of this report. Placement of property lines, wells, structures, and roads is based on the available information from county appraiser maps, surveys, site visits, and/or previous vendor reports and should be considered approximate.

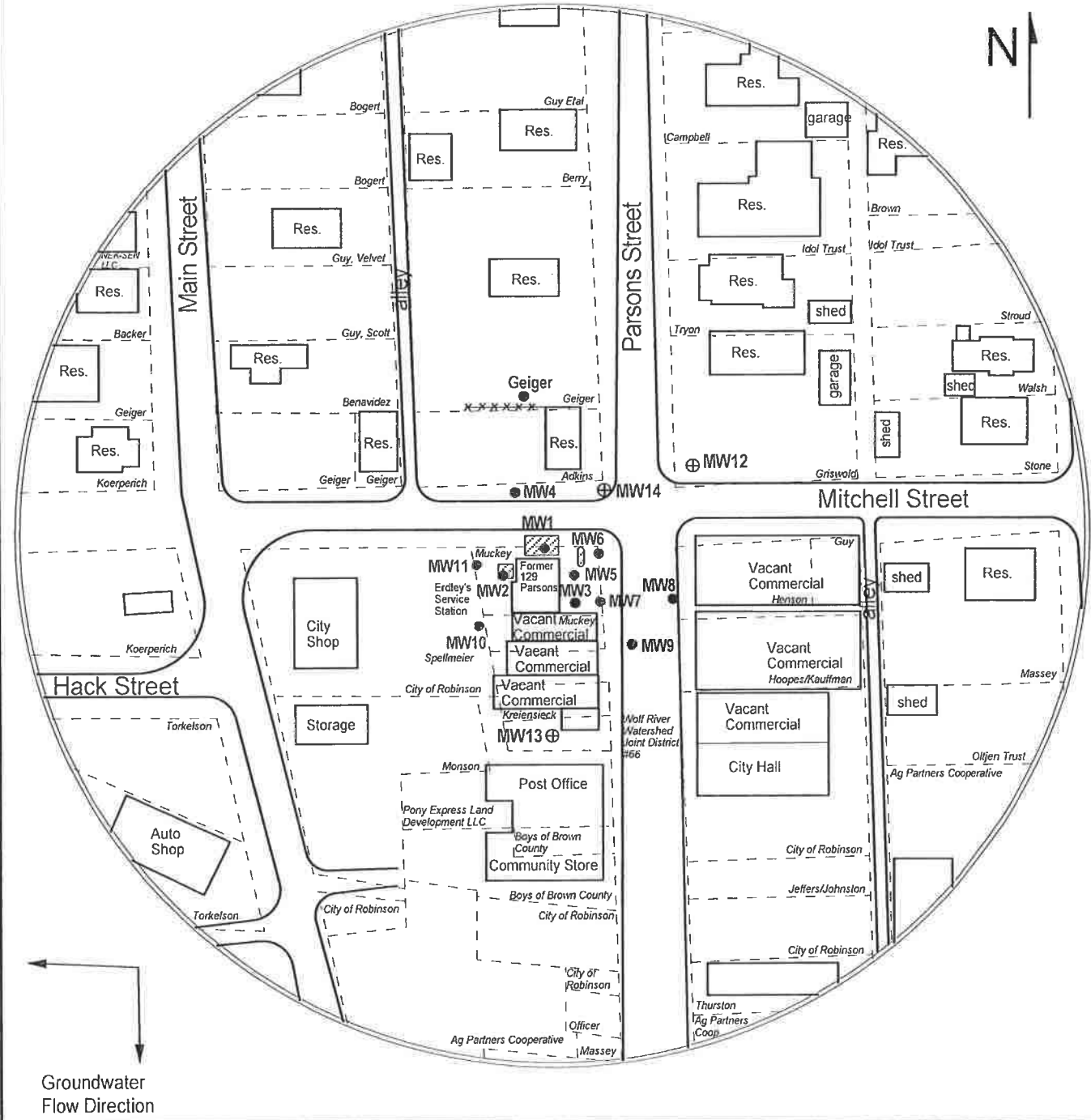

FIGURE 1 - SITE BASE MAP



1311 E 25th St., Suite B  
Lawrence, KS 66046

(785) 841-8707 office  
(785) 865-4282 fax

**PROJECT:**

129 Parsons  
129 Parsons Street  
Robinson, KS  
KDHE ID: U4-007-14498  
Date: 11/18/21



**LEGEND:**

- Approximate Location of Former UST Basin and Pump Island
- Approximate Location of Property Line
- Monitoring Well
- New Monitoring Well (installed 11/18/21)

RECEIVED

FEB 16 2022

KS GEOLOGICAL SURVEY

NOTE: Approximate location of product lines is unknown.