

WATER WELL RECORD Form WWC-5

Original Record Correction Change in Well Use

Division of Water Resources App. No.

Well ID

1 LOCATION OF WATER WELL: County: Fraction Section Number Township Number Range Number

2 WELL OWNER: Last Name: Business: Address: City: State: ZIP: Street or Rural Address where well is located

3 LOCATE WELL WITH "X" IN SECTION BOX: NW NE SW SE S

4 DEPTH OF COMPLETED WELL: Depth(s) Groundwater Encountered: WELL'S STATIC WATER LEVEL: Pump test data: Estimated Yield: Bore Hole Diameter:

5 Latitude: Longitude: Datum: Source for Latitude/Longitude: GPS Land Survey Topographic Map Online Mapper

6 Elevation: Ground Level TOC Source: Land Survey GPS Topographic Map Other

7 WELL WATER TO BE USED AS: 1. Domestic: 2. Irrigation: 3. Feedlot: 4. Industrial: 5. Public Water Supply: 6. Dewatering: 7. Aquifer Recharge: 8. Monitoring: 9. Environmental Remediation: 10. Oil Field Water Supply: 11. Test Hole: 12. Geothermal: 13. Other

Was a chemical/bacteriological sample submitted to KDHE? Water well disinfected?

8 TYPE OF CASING USED: CASING JOINTS: Casing diameter: Casing height above land surface: TYPE OF SCREEN OR PERFORATION MATERIAL: SCREEN OR PERFORATION OPENINGS ARE: SCREEN-PERFORATED INTERVALS: GRAVEL PACK INTERVALS:

9 GROUT MATERIAL: Grout Intervals: Nearest source of possible contamination: Direction from well? Distance from well?

Table with columns: FROM, TO, LITHOLOGIC LOG, FROM, TO, LITHO. LOG (cont.) or PLUGGING INTERVALS. Includes a Notes section.

11 CONTRACTOR'S OR LANDOWNER'S CERTIFICATION: This water well was constructed, reconstructed, or plugged under my jurisdiction and was completed on (mo-day-year) and this record is true to the best of my knowledge and belief.

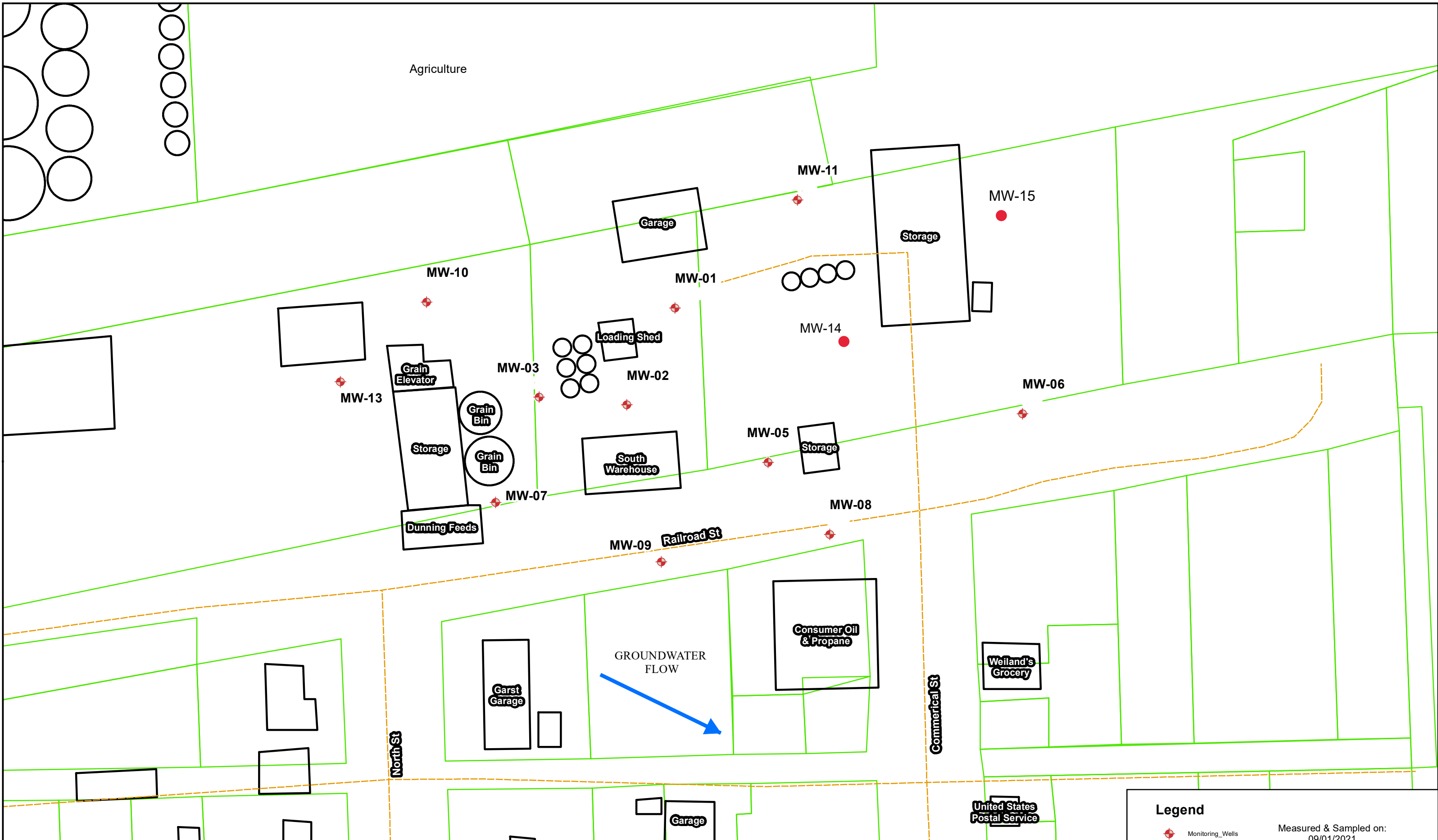

| | | | | | | | | |
|--|-------------------------|-----------------------------------|---|---|--|---|--|--|
| | FIGURE: 1.0 | FIGURE NAME: Site Base Map | Consumer Oil Co., Inc. Facility #05469 Railroad St. Bendena, KS KDHE Project Code: A4-022-40449; | Feet 0 60 1 in = 60 feet | | Legend <ul style="list-style-type: none"> Monitoring_Wells Roads Building Footprints Property Parcels | Measured & Sampled on: 09/01/2021 Units: ug/L ND = Not Detected NA = Not Located | |
| | DATE: 10/08/2021 | PROJECT NUMBER: 2174064 | | | | | | ALL BOUNDARIES AND LOCATIONS ARE APPROXIMATE |
| | DRAWN BY: PM | PROJECT MANAGER: BH | | | | | | |