

WATER WELL RECORD Form WWC-5

- Original Record Correction Change in Well Use

Division of Water Resources App. No.

[]

[]

Well ID

1 LOCATION OF WATER WELL: County: Fraction 1/4 1/4 1/4 1/4 Section Number Township Number T S Range Number R E W

2 WELL OWNER: Last Name: Business: Address: City: State: ZIP: Street or Rural Address where well is located

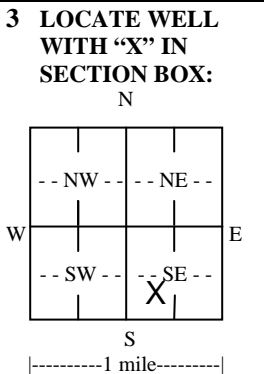

4 DEPTH OF COMPLETED WELL: Depth(s) Groundwater Encountered: 1) ... ft. 2) ... ft. 3) ... ft., or 4) Dry Well WELL'S STATIC WATER LEVEL: ... ft. below land surface, measured on (mo-day-yr) ... above land surface, measured on (mo-day-yr) ... Pump test data: Well water was ... ft. after ... hours pumping ... gpm Well water was ... ft. after ... hours pumping ... gpm Estimated Yield: ... gpm Bore Hole Diameter: ... in. to ... ft. and ... in. to ... ft.

5 Latitude: ... (decimal degrees) Longitude: ... (decimal degrees) Datum: WGS 84 NAD 83 NAD 27 Source for Latitude/Longitude: GPS (unit make/model: ... (WAAS enabled? Yes No) Land Survey Topographic Map Online Mapper: ...

6 Elevation: ... ft. Ground Level TOC Source: Land Survey GPS Topographic Map Other ...

7 WELL WATER TO BE USED AS: 1. Domestic: Household Lawn & Garden Livestock 2. Irrigation 3. Feedlot 4. Industrial 5. Public Water Supply: well ID ... 6. Dewatering: how many wells? ... 7. Aquifer Recharge: well ID ... 8. Monitoring: well ID ... 9. Environmental Remediation: well ID ... Air Sparge Soil Vapor Extraction Recovery Injection 10. Oil Field Water Supply: lease ... 11. Test Hole: well ID ... Cased Uncased Geotechnical 12. Geothermal: how many bores? ... a) Closed Loop Horizontal Vertical b) Open Loop Surface Discharge Inj. of Water 13. Other (specify): ...

Was a chemical/bacteriological sample submitted to KDHE? Yes No If yes, date sample was submitted: ... Water well disinfected? Yes No

8 TYPE OF CASING USED: Steel PVC Other ... CASING JOINTS: Glued Clamped Welded Threaded Casing diameter ... in. to ... ft., Diameter ... in. to ... ft., Diameter ... in. to ... ft. Casing height above land surface ... in. Weight ... lbs./ft. Wall thickness or gauge No. ... TYPE OF SCREEN OR PERFORATION MATERIAL: Steel Stainless Steel PVC Other (Specify) ... Brass Galvanized Steel None used (open hole) SCREEN OR PERFORATION OPENINGS ARE: Continuous Slot Mill Slot Gauze Wrapped Torch Cut Drilled Holes Other (Specify) ... Louvered Shutter Key Punched Wire Wrapped Saw Cut None (Open Hole) SCREEN-PERFORATED INTERVALS: From ... ft. to ... ft., From ... ft. to ... ft., From ... ft. to ... ft. GRAVEL PACK INTERVALS: From ... ft. to ... ft., From ... ft. to ... ft., From ... ft. to ... ft.

9 GROUT MATERIAL: Neat cement Cement grout Bentonite Other ... Grout Intervals: From ... ft. to ... ft., From ... ft. to ... ft., From ... ft. to ... ft. Nearest source of possible contamination: No potential source of contamination within 200 ft. Septic Tank Lateral Lines Pit Privy Livestock Pens Insecticide Storage Sewer Lines Cess Pool Sewage Lagoon Fuel Storage Abandoned Water Well Watertight Sewer Lines Seepage Pit Feedyard Fertilizer Storage Oil Well/Gas Well Other (Specify) ... Direction from well? ... Distance from well? ... ft.

Table with 6 columns: 10 FROM, TO, LITHOLOGIC LOG, FROM, TO, LITHO. LOG (cont.) or PLUGGING INTERVALS. Includes a 'Notes:' section.

11 CONTRACTOR'S OR LANDOWNER'S CERTIFICATION: This water well was constructed, reconstructed, or plugged under my jurisdiction and was completed on (mo-day-year) ... and this record is true to the best of my knowledge and belief. Kansas Water Well Contractor's License No. ... This Water Well Record was completed on (mo-day-year) ... under the business name of ...

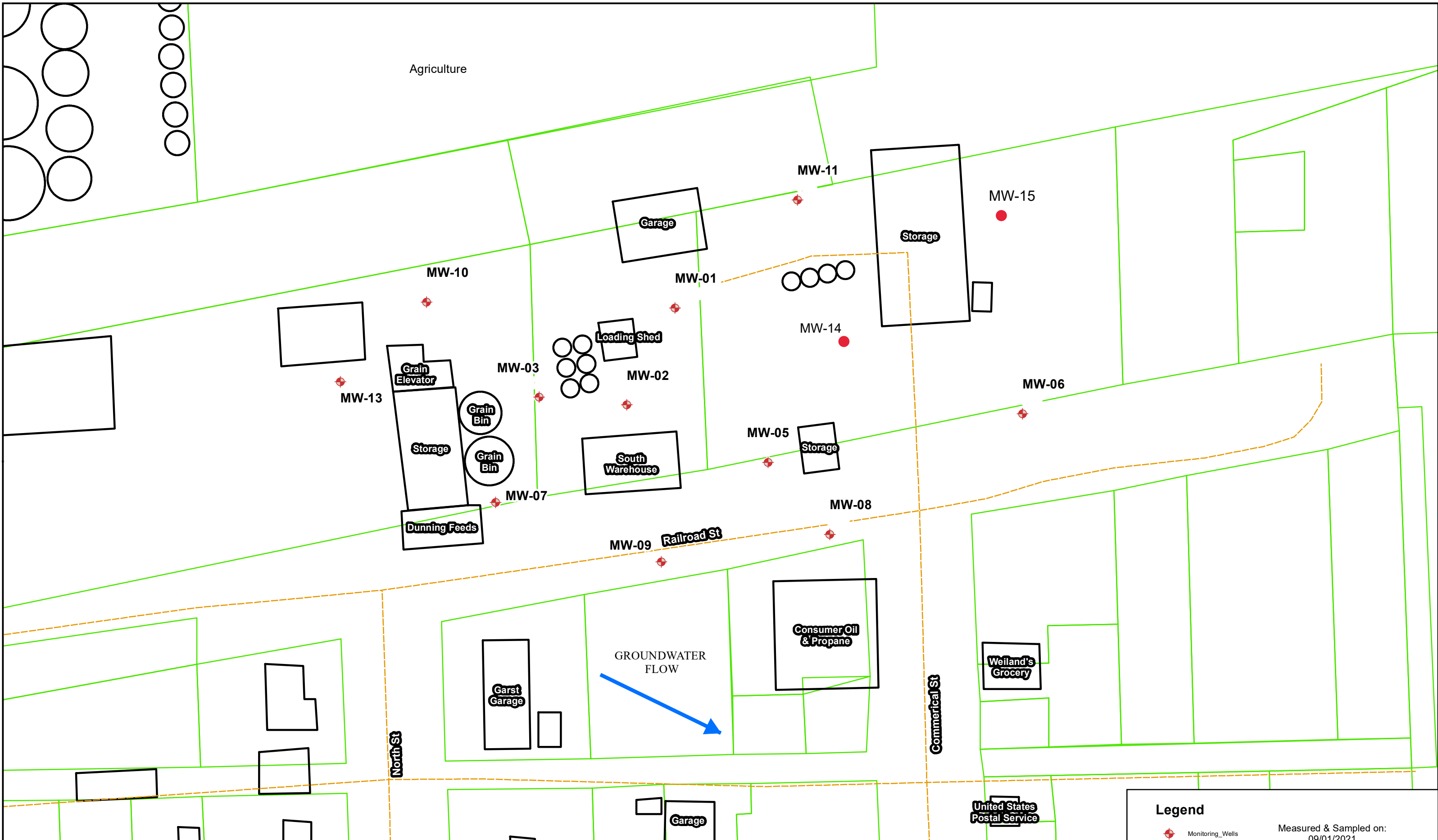

	FIGURE: 1.0	FIGURE NAME: Site Base Map	Consumer Oil Co., Inc. Facility #05469 Railroad St. Bendena, KS KDHE Project Code: A4-022-40449;	Measured & Sampled on: 09/01/2021 Units: ug/L ND = Not Detected NA = Not Located
	DATE: 10/08/2021	PROJECT NUMBER: 2174064		
	DRAWN BY: PM	PROJECT MANAGER: BH		

Feet

0 60

1 in = 60 feet

N

Legend

- ◆ Monitoring_Wells
- Roads
- Building Footprints
- Property Parcels

ALL BOUNDARIES AND LOCATIONS ARE APPROXIMATE