

WATER WELL RECORD

Form WWC-5

[X] Original Record [] Correction [] Change in Well Use

Division of Water Resources App. No.

Well ID

MW1

1 LOCATION OF WATER WELL: County Doniphan Fraction SE 1/4 SW 1/4 NW 1/4 NW 1/4 Section Number 31 Township Number T 3 S Range Number R 23 [X] E [] W

2 WELL OWNER: Last Name: Business: Affiliated Foods Midwest Coop Inc. Address: 1301 Omaha Ave., 1301 Oak Street, Elwood, KS City Norfolk State: NE ZIP: 68701 Street or Rural Address where well is located (if unknown, distance and direction from nearest town or intersection): If at owner's address, check here: []

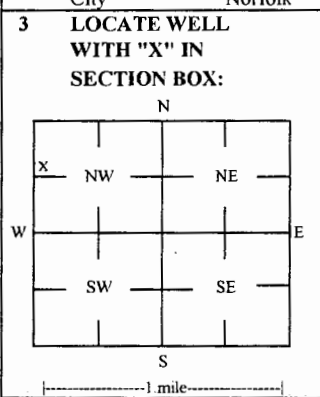

4 DEPTH OF COMPLETED WELL: 20 ft Depth(s) Groundwater Encountered: 1) _____ ft 2) _____ ft 3) _____ ft, or 4) [] Dry Well WELL'S STATIC WATER LEVEL: 14.18 ft [X] below land surface, measured on (mo-day-yr) 1/31/18 [] above land surface, measured on (mo-day-yr) _____ Pump test data: Well water was _____ ft after _____ hours pumping _____ gpm Water well was _____ ft after _____ hours pumping _____ gpm Estimated Yield: _____ gpm Bore Hole Diameter: 7.25 in to _____ ft, and _____ in to _____ ft

5 Latitude: 39.75193 (decimal degrees) Longitude: 94.88703 (decimal degrees) Horizontal Datum: WGS 84 [] NAD 83 [X] NAD 27 Source for Latitude/Longitude: [] GPS (unit make/model: _____) (WAAS enabled? [] Yes [] No) [X] Land Survey [] Topographic Map [] Online Mapper

6 Elevation: 815.14 ft [] Ground Level [X] TOC Source: [X] Land Survey [] GPS [] Topographic Map [] Other _____

7 WELL WATER TO BE USED AS: 1 Domestic: [] Household [] Lawn & Garden [] Livestock [] Irrigation [] Feedlot [] Industrial 2 [] Public Water Supply: well ID 3 [] Dewatering: how many wells? 4 [] Aquifer Recharge: well ID 5 [X] Monitoring: well ID MW1 6 [] Environmental Remediation: well ID 7 [] Air Sparge [] Soil Vapor Extractor 8 [] Recovery [] Injection 9 [] Oil Field Water Supply: lease 10 [] Test Hole: well ID [] Cased [] Uncased [] Geotechnical 11 Geothermal: How many bores? a) Closed Loop [] Horizontal [] Vertical b) Open Loop [] Surface Discharge [] Inj. of Water [] Other (specify): _____

Was a chemical/bacteriological sample submitted to KDHE? [] Yes [X] No If yes, date sample was submitted: _____ Water well disinfected? [] Yes [X] No

8 TYPE OF CASING USED: [] Steel [X] PVC [] Other _____ CASING JOINTS: [] Glued [] Clamped [] Welded [X] Threaded Casing diameter 2 in. to 10 ft, Diameter _____ in. to _____ ft, Casing height above land surface -0.34 in. Weight _____ lbs./ft. Well thickness or gauge No _____ TYPE OF SCREEN OR PERFORATION MATERIAL: [] Steel [] Stainless Steel [] Fiberglass [X] PVC [] Brass [] Galvanized Steel [] Concrete tile [] None used (open hole) [] Other (Specify) _____ SCREEN OR PERFORATION OPENINGS ARE: [] Continuous Slot [X] Mill Slot [] Gauze Wrapped [] Torch Cut [] Drilled Holes [] Other (Specify) _____ [] Louvered Shutter [] Key Punched [] Wire Wrapped [] Saw Cut [] None (Open Hole) SCREEN-PERFORATED INTERVALS: From 10 ft. to 20 ft, From _____ ft. to _____ ft, From _____ ft. to _____ ft, GRAVEL PACK INTERVALS: From 8 ft. to 20 ft, From _____ ft. to _____ ft, From _____ ft. to _____ ft,

9 GROUT MATERIAL: [] Neat cement [] Cement grout [X] Bentonite [X] Other Concrete: 0-1' Grout intervals: From 1 ft. to 8 ft, From _____ ft. to _____ ft, From _____ ft. to _____ ft,

Nearest source of possible contamination: [] Septic Tank [] Lateral Lines [] Pit Privy [] Livestock Pens [] Insecticide Storage [] Sewer Lines [] Cess Pool [] Sewage Lagoon [X] Fuel Storage [] Abandoned Water Well [] Watertight Sewer Lines [] Seepage Pit [] Feedyard [] Fertilizer Storage [] Oil Well / Gas Well [] Other (Specify) _____ Direction from well? NW Distance from well? ~30 ft

10 FROM	TO	LITHOLOGIC LOG	FROM	TO	LITHO. LOG (cont.) or PLUGGING INTERVALS
0	0.4	Topsoil			
0.4	1.5	Silty clay			
1.5	3	Silt			
3	20	Fine sand w/ clayey silt fingers			

Notes: KDHE ID: Affiliated Carriers, Inc.; A4-022-40480 Target of monitoring well is shallow groundwater. <20' of grout was installed at the direction of KDHE.

11 CONTRACTOR'S OR LANDOWNER'S CERTIFICATION: This water well was [X] constructed. [] reconstructed or [] plugged under my jurisdiction and was completed on (mo-day-year) 1/30/18 and this record is true to the best of my knowledge and belief. Kansas Water Well Contractor's License No 757 This Water Well Record was completed on (mo-day-year) 2/22/18 under the business name of Larsen & Associates, Inc. Signature _____

DENNIS L HANDKE

1820 NW 59th Terrace
TOPEKA, KANSAS 66618
785-286-4047 Home
785-286-1990 Fax

Jessica Chapman
Larsen & Associates
1311 E. 25th Street, Suite B
Lawrence, Kansas, 66046

February 17, 2018

RE: Monitor Well Elevation Survey
1301 Oak Street, Elwood, Kansas

Proj. 18-00D
Affiliated Carriers, Inc
A4-022-40480

Bench Mark: Square cut on South edge of concrete light base South of guard shack.
Elev: 817.63 North 4060 East 543 (from SW Cor. Sec. 31-3-23E)

MW-1	rim	815.48	North	4051	SE1/4,SW1/4,NW1/4,NW1/4
	top pipe	815.14	East	489	Lat= 39.75193 Long = 94.88703
MW-2	rim	817.08	North	4256	SE1/4,SW1/4,NW1/4,NW1/4
	top pipe	816.78	East	469	Lat= 39.75249 Long = 94.88711
MW-3	rim	816.48	North	4139	SE1/4,SW1/4,NW1/4,NW1/4
	top pipe	816.12	East	536	Lat= 39.75217 Long = 94.88687
MW-4	rim	816.98	North	4341	NE1/4,SW1/4,NW1/4,NW1/4
	top pipe	816.68	East	422	Lat= 39.75272 Long = 94.88728
MW-5	rim	816.72	North	4050	SE1/4,SW1/4,NW1/4,NW1/4
	top pipe	816.42	East	585	Lat= 39.75193 Long = 94.88669
MW-6	rim	817.49	North	4171	SE1/4,SW1/4,NW1/4,NW1/4
	top pipe	817.12	East	432	Lat= 39.75226 Long = 94.88724

There is no SE corner of Section 31. The corner fell into the Missouri River in 1856 when the sections were laid out. Therefore everything is calculated from the SW corner of Section 31.

Lat & Long derived from Wathena 7.5' quad map. NAVD 27

Elevation established from USGS BM N 106.

If you have any questions, please feel free to call me. Thank you for the opportunity to be of service to you.

February 17, 2018
Dennis L Handke

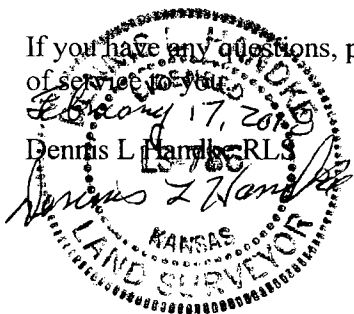

RECEIVED

MAR 26 2018

BUREAU OF WATER

NOTE: Figures exhibited within this report are only to be used within the context of this report. Placement of property lines, wells, structures, and roads is based on the available information from county appraiser maps, surveys, site visits, and/or previous vendor reports and should be considered approximate.

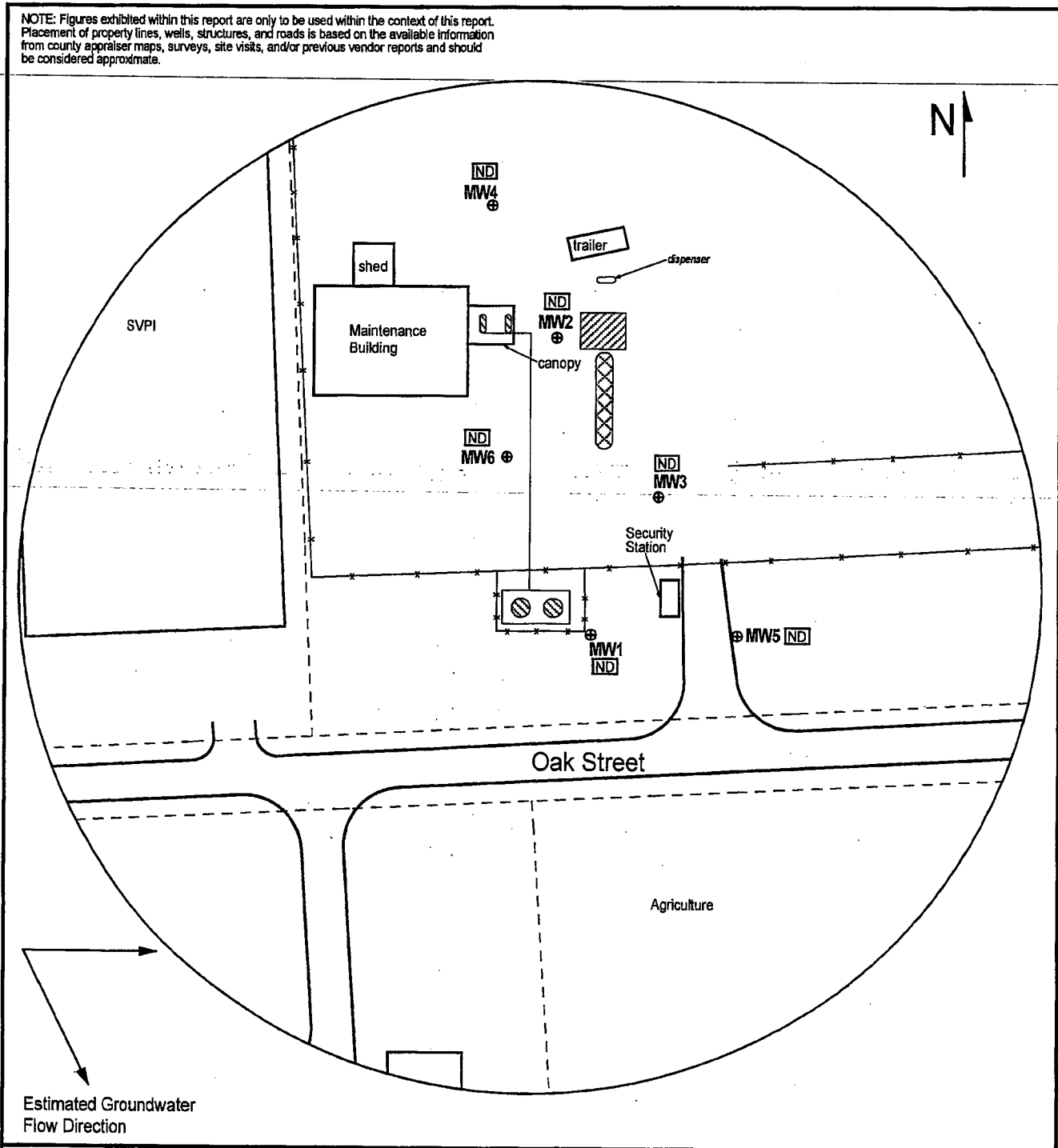

Estimated Groundwater Flow Direction

FIGURE 5.1 - GROUNDWATER ISOCONCENTRATION MAP: TOTAL BTEX IN WELLS

LEGEND:

- Possible Location of Former UST Basin
- Location of Active Diesel ASTs, Product Lines and Pump Island
- Approximate Location of Former AST Containing Water
- Approximate Location of Property Line
- Monitoring Well (Installed 1/29-30/18)
- Total BTEX Concentration (ppb)



PROJECT:

Affiliated Carriers, Inc.
 1301 Oak Street
 Elwood, KS
 KDHE ID: A4-022-40480
 Date: 1/31/18



1311 E 25th St., Suite B (785) 841-8707 office
 Lawrence, KS 66046 (785) 885-4282 fax