

USE TYPEWRITER OR BALL POINT PEN-PRESS FIRMLY, PRINT CLEARLY.

WATER WELL RECORD
KSA 82a-1201-1215

Kansas Department of Health and Environment-Division of Environment (Water well Contractors) Topeka, Kansas 66620

Location of well: **Marshall** County **Marshall** Fraction **1/4 SW 1/4 NW 1/4** Section number **30** Township number **T 3 S R 9 E/W** Range number **9**

Distance and direction from nearest town or city: **4 mi. North on K99 of Frankfort, Ks. on Winifred Rd.** 3. Owner of well: **Harry Wullschleger**
Street address of well location if in city: **1 mi. E. of Winifred, Kansas** City, state, zip code: **Winifred, Kansas**

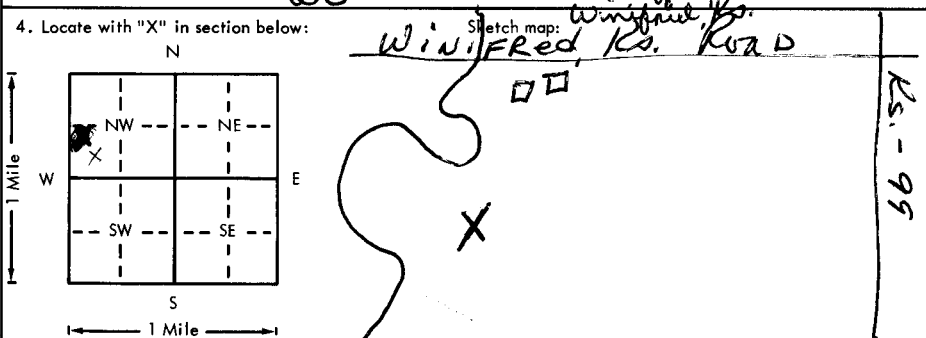

6. Bore hole dia. **30** in. Completion date **6-1-78**
Well depth **62** ft.

7. Cable tool Rotary Driven Dug
 Hollow rod Jetted Bored Reverse rotary

8. Use: Domestic Public supply Industry
 Irrigation Air conditioning Stock
 Lawn Oil field water Other

9. Casing: Material **steel** Height: (Above) or below
Threaded Welded Surface **12** in.
RMP PVC Weight lbs./ft.
Dia. **16** in. to **42** ft. depth Wall Thickness: inches or
Dia. in. to ft. depth gage No. **.219 w.t.**

5. Type and color of material	From	To
Black soil	0	3
Light brown silt	3	19
Gray clay	19	36
Large white gravel & gray clay	36	37
Very large brown gravel	37	42
Small to med. brown gravel	42	46
Small to med. brown gravel & green clay	46	49
Med. to large gray gravel	49	61
Brown silt	61	62
Stopped.	62	

10. Screen: Manufacturer's name **Free-Flo W. A. Brown Enterprises**
Type **steel** Dia. **16"**
(Slot) gauze **1/2 x 2** Length **20'**
Set between **42** ft. and **62** ft.
Gravel pack? **yes** Size range of material **1/8-1/4"**

11. Static water level: **6** ft. below land surface Date **5-4-78** mo./day/yr.

12. Pumping level below land surfaces:
ft. after hrs. pumping g.p.m.
ft. after hrs. pumping g.p.m.
Estimated maximum yield g.p.m.

13. Water sample submitted: Yes No Date mo./day/yr.

14. Well head completion: Pitless adapter Inches above grade

15. Well grouted? **yes**
With: Neat cement Bentonite Concrete
Depth: From **0** ft. to **10** ft.

16. Nearest source of possible contamination:
ft. **600** Direction **North** Type **creek**
Well disinfected upon completion? Yes No

17. Pump: Not installed
Manufacturer's name
Model number HP Volts
Length of drop pipe ft. capacity g.p.m.
Type: Submersible Turbine
 Jet Reciprocating
 Centrifugal Other

18. Elevation: **1171**
Topography: Hill Slope Upland Valley

19. Remarks: **We do not install pumps**

20. Water well contractor's certification:
This well was drilled under my jurisdiction and this report is true to the best of my knowledge and belief.
Hoobler Drilling Co. 323
Business name **St. Marys, Ks. 66536** License No. **6-22-78**
Address **Den Hoobler** Signed **Den Hoobler** Date **6-22-78**
Authorized representative

BK < 1109 D: 1165

T 3
 R 9
 W 30
 Sec 30
 1/4 1/4 1/4
 NW SW
 SE