

USE TYPEWRITER OR BALL POINT PEN—PRESS FIRMLY, PRINT CLEARLY.

WATER WELL RECORD
KSA 82a-1201-1215

Kansas Department of Health and Environment—Division of Environment (Water well Contractors) Topeka, Kansas 66620

NE-NE-NW 27

1. Location of well: County Doniphan Fraction SE 1/4 Section number 22 Township number T 4 S Range number R 20 E/W

2. Distance and direction from nearest town or city: 4 S - 1 E 3. Owner of well: MRS. C. D. MERRIDITH
Street address of well location if in city: OF Bendena R.R. or street: Bendena
City, state, zip code: Bendena

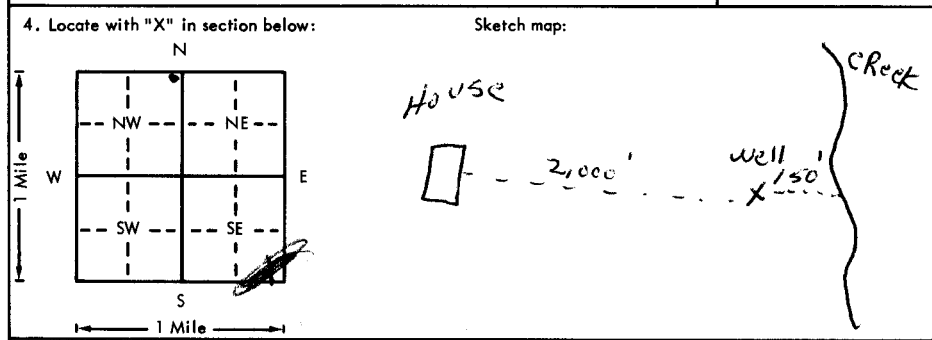

6. Bore hole dia. 10 in. Completion date 9-28-76
Well depth 40 ft.
7. Cable tool Rotary Driven Dug
 Hollow rod Jetted Bored Reverse rotary
8. Use: Domestic Public supply Industry
 Irrigation Air conditioning Stock
 Lawn Oil field water Other
9. Casing: Material PVC Height: Above or below
Threaded Welded Surface 6 in.
RMP PVC 9L Weight 2.58 lbs./ft.
Dia. 5 in. to 40 ft. depth Wall Thickness: inches or
Dia. 5 in. to 40 ft. depth gage No. 279

5. Type and color of material	From	To
<u>TOP SOIL</u>	<u>0</u>	<u>6</u>
<u>BROWN CLAY</u>	<u>6</u>	<u>23</u>
<u>COURSE SAND-MEDIUM GRAVEL</u>	<u>23</u>	<u>33</u>
<u>GREY SHALE</u>	<u>33</u>	<u>40</u>

10. Screen: Manufacturer's name PUMPCO
Type PVC Dia. 5
Slot/gauze .020 Length 10
Set between 24 ft. and 34 ft.
Gravel pack? Size range of material 10/30 X 10/60
11. Static water level: 10 ft. below land surface Date 9-28-76 mo./day/yr.
12. Pumping level below land surfaces:
20 g.p.m. Estimated maximum yield
13. Water sample submitted: Yes No Date
14. Well head completion: CAP
12 Pitless adapter 12 inches above grade
15. Well grouted?
With: Neat cement Bentonite Concrete
Depth: From 5 ft. to 15 ft.
16. Nearest source of possible contamination: 100 ft. Direction E Type DRAINAGE
Well disinfected upon completion? Yes No
17. Pump: Not installed
Manufacturer's name
Model number HP Volts
Length of drop pipe ft. capacity g.p.m.
Type:
 Submersible Turbine
 Jet Reciprocating
 Centrifugal Other

18. Elevation: 902 19. Remarks: OWNER WILL INSTALL SLAB

Topography:
 Hill
 Slope
 Upland
 Valley

20. Water well contractor's certification:
This well was drilled under my jurisdiction and this report is true to the best of my knowledge and belief.
Business name STANLEY DELG CO INC License No.
Address RT 1 HOLTON, KS
Signed Don Gibson Date 9-27-76
Authorized representative

Forward the white, blue and pink copies to the Department of Health and Environment

Form WWC-5

BR = 869
879
902
D = 892