

USE TYPEWRITER OR BALL POINT PEN-PRESS FIRMLY, PRINT CLEARLY.

WATER WELL RECORD  
KSA 82a-1201-1215

4 3 E 2 4 C W  
T R EW sec 1/4 1/4 1/4 No.

Kansas State Dept. Of Health  
(Water Well Contractors)  
Forbes-Bldg. 740  
Topeka, Kansas 66620

1 Location of well: County WASHINGTON Township name LINN Fraction CNW 1/4 Section number 24 Town number T4 S Range number R3 E

Distance and direction from nearest town or city: 2 W 1 SOUTH TO LINN 3 Owner of well: ROBERT + NORMA OHLDE

Street address of well location if in city: LINN, KANS Address: LINN, KANS

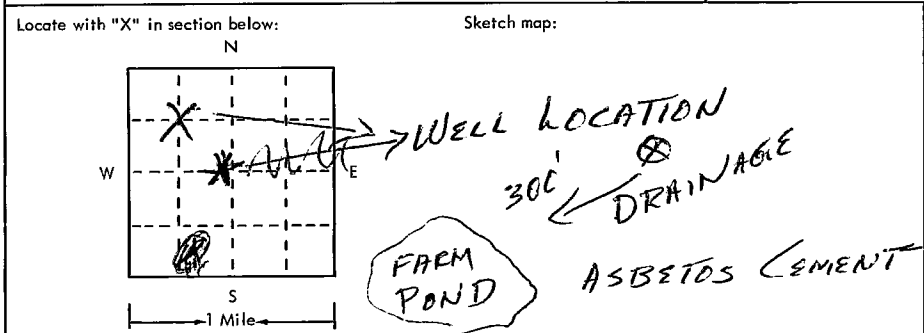

4 Well depth: 113 ft. Date of completion 9/6/75  
Well diameter 22 in.

5  Cable tool  Rotary  Driven  Dug  
 Hollow rod  Jetted  Bored  Reverse rotary

6 Use:  Domestic  Public supply  Industry  
 Irrigation  Air conditioning  Commercial  
 Test well

7 Casing: Material AL Height: above below  
Threaded  Welded  Surface 12 in.  
Diam. 12 in. Weight 30 lbs./ft.  
12 in. to 113 ft. depth Drive shoe?  Yes  No  
\_\_\_ in. to \_\_\_ ft. depth

2	Type and color of material	From	To
	TOPSOIL	0	3
	BROWN CLAY	3	5
	SANDY CLAY	5	10
	SANDROCK	10	23
	GRAY CLAY	23	27
	SANDROCK	27	30
	GRAY CLAY	30	50
	BROWN CLAY	50	59
	SANDROCK	59	81
	BROWN CLAY	81	84
	SANDROCK	84	101
	HARDROCK	101	103
	GRAY CLAY	103	106
	BLUE SHALE	106	133
	STOP	133	

8 Screen: Manufacturer JOHNSON CASING CO  
Type Sanded AL Dia. 12  
Slot/gauze 1/8" Length 39'  
Set between 43 ft. and 74 ft.  
Fittings: Gravel pack  Yes  No Size range of material 1/4" - 1/2"

9 Static water level: 40 ft. below land surface Date 9/6/75

10 Pumping level below land surfaces:  
100 ft. after 1 hrs. pumping 280 g.p.m.  
\_\_\_ ft. after \_\_\_ hrs. pumping \_\_\_ g.p.m.  
Estimated maximum yield 280 g.p.m.

11 Water sample submitted:  
 Yes  No Date \_\_\_

12 Well head completion:  
 Pitless adapter  Inches above grade

13 Well grouted?  Yes  No  
 Neat cement  Bentonite  Concrete  
Depth: From \_\_\_ ft. to \_\_\_ ft.

14 Nearest source of possible contamination:  
ft. 300 Direction S W Type FARM POND  
Well disinfected upon completion?  Yes  No

15 Pump:  Not installed  
Manufacturer's name WESTERN LAND ROLLER  
Model number 6M10C HP 15 Volts 220  
Length of drop pipe 100 ft. capacity 250 g.p.m.  
Type:  Submersible  Turbine  
 Jet  Reciprocating  
 Centrifugal  Other

16 Remarks: elevation 1420' WELL ON HIGH GROUND WITH GOOD DRAINAGE

Topography:  
 Hill  
 Slope  
 Upland  
 Valley

17 Water well contractor's certification:  
This well was drilled under my jurisdiction and this report is true to the best of my knowledge and belief.  
Geo Cox + Sons 258  
Business name License No.  
Address CLIFTON KANSAS  
Signed Daryl Ray Date 9/6/75  
Authorized representative