

**WATER WELL RECORD**

**Form WWC-5**

Division of Water Resources; App. No.  

**1 LOCATION OF WATER WELL:** Fraction NW ¼ NE ¼ SE ¼ Section Number 11 Township Number T 5 S Range Number R 14 E  
 County: Nemaha  
 Distance and direction from nearest town or city street address of well if located within city? 333 2<sup>nd</sup> St., Wetmore KS **Global Positioning System** (decimal degrees, min. of 4 digits)  
 Latitude: \_\_\_\_\_  
 Longitude: \_\_\_\_\_  
 Elevation: \_\_\_\_\_  
 Datum: \_\_\_\_\_  
 Data Collection Method: \_\_\_\_\_

**2 WATER WELL OWNER: KDHE**  
 RR#, St. Address, Box # : 1000 SW Jackson Blvd  
 City, State, ZIP Code : Topeka KS 66612

**3 LOCATE WELL'S LOCATION WITH AN "X" IN SECTION BOX:**

N	
NW	NE
SW	SE
S	

**4 DEPTH OF COMPLETED WELL 25.2 ft.**  
 MW6  
 Depth(s) Groundwater Encountered 1 \_\_\_\_\_ ft. 2 \_\_\_\_\_ ft. 3 \_\_\_\_\_ ft.  
 WELL'S STATIC WATER LEVEL \_\_\_\_\_ ft. below land surface measured on mo/day/yr  
 Pump test data: Well water was \_\_\_\_\_ ft. after \_\_\_\_\_ hours pumping \_\_\_\_\_ gpm  
 Est. Yield \_\_\_\_\_ gpm: Well water was \_\_\_\_\_ ft. after \_\_\_\_\_ hours pumping \_\_\_\_\_ gpm  
 WELL WATER TO BE USED AS: 5 Public water supply 8 Air conditioning 11 Injection well  
 1 Domestic 3 Feed lot 6 Oil field water supply 9 Dewatering 12 Other (Specify below)  
 2 Irrigation 4 Industrial 7 Domestic (lawn & garden) **10** Monitoring well  
 Was a chemical/bacteriological sample submitted to Department? Yes \_\_\_\_\_ No **X**; If yes, mo/day/yr  
 Sample was submitted \_\_\_\_\_ Water Well Disinfected? Yes \_\_\_\_\_ No **X**

**5 TYPE OF CASING USED:** 5 Wrought Iron 8 Concrete tile CASING JOINTS: Glued \_\_\_\_\_ Clamped \_\_\_\_\_  
 1 Steel 3 RMP (SR) 6 Asbestos-Cement 9 Other (specify below) Welded \_\_\_\_\_  
**2** PVC 4 ABS 7 Fiberglass Threaded **X**  
 Blank casing diameter 2 in. to 10.2 ft., Dia \_\_\_\_\_ in. to \_\_\_\_\_ ft., Dia \_\_\_\_\_ in. to \_\_\_\_\_ ft.  
 Casing height below land surface \_\_\_\_\_ ft., Weight \_\_\_\_\_ lbs./ft. Wall thickness or gauge No. \_\_\_\_\_

**TYPE OF SCREEN OR PERFORATION MATERIAL:**  
 1 Steel 3 Stainless steel 5 Fiberglass **7** PVC 9 ABS 11 Other (specify) \_\_\_\_\_  
 2 Brass 4 Galvanized steel 6 Concrete tile 8 RM (SR) 10 Asbestos-Cement 12 None used (open hole)  
**SCREEN OR PERFORATION OPENINGS ARE:**  
 1 Continuous slot **3** Mill slot 5 Gauze wrapped 7 Torch cut 9 Drilled holes 11 None (open hole)  
 2 Louvered shutter 4 Key punched 6 Wire wrapped 8 Saw Cut 10 Other (specify) \_\_\_\_\_  
**SCREEN-PERFORATED INTERVALS:** From 10.2 ft. to 25.2 ft. From \_\_\_\_\_ ft. to \_\_\_\_\_ ft.  
 From \_\_\_\_\_ ft. to \_\_\_\_\_ ft. From \_\_\_\_\_ ft. to \_\_\_\_\_ ft.  
**GRAVEL PACK INTERVALS:** From 8 ft. to 25.75 ft. From \_\_\_\_\_ ft. to \_\_\_\_\_ ft.  
 From \_\_\_\_\_ ft. to \_\_\_\_\_ ft. From \_\_\_\_\_ ft. to \_\_\_\_\_ ft.

**6 GROUT MATERIAL:** 1 Neat cement 2 Cement grout **3** Bentonite **4** Other **Concrete: 0-1'**  
 Grout Intervals From 1 ft. to 8 ft. From \_\_\_\_\_ ft. to \_\_\_\_\_ ft. From \_\_\_\_\_ ft. to \_\_\_\_\_ ft.  
 What is the nearest source of possible contamination:  
 1 Septic tank 4 Lateral lines 7 Pit privy 10 Livestock pens 13 Insecticide Storage 16 Other (specify below)  
 2 Sewer lines 5 Cess pool 8 Sewage lagoon **11** Fuel storage 14 Abandoned water well  
 3 Watertight sewer lines 6 Seepage pit 9 Feedyard 12 Fertilizer storage 15 Oil well/ gas well  
 Direction from well? S How many feet? ~200'

FROM	TO	LITHOLOGIC LOG	FROM	TO	PLUGGING INTERVALS
0	10	Grass on top; Brown silty clay			
10	20	Fine sandy clay			
20	25.75	Fine tan clayey sand			

**7 CONTRACTOR'S OR LANDOWNER'S CERTIFICATION:** This water well was **1** constructed, **2** reconstructed, or **3** plugged under my jurisdiction and was completed on (mo/day/year) 6/18/14 and this record is true to the best of my knowledge and belief.  
 Kansas Water Well Contractor's License No. 757. This Water Well Record was completed on (mo/day/year) 7/16/14  
 under the business name of Larsen & Associates, Inc. by (signature) \_\_\_\_\_

**INSTRUCTIONS:** Please fill in blanks or circle the correct answers. Send top three copies to Kansas Department of Health and Environment, Bureau of Water, Geology Section, 1000 SW Jackson St., Suite 420, Topeka, Kansas 66612-1367. Telephone 785-296-5522. Send one to WATER WELL OWNER and retain one for your records. Fee of \$5.00 for each constructed well. Visit us at <http://www.kdheks.gov/waterwell>.

Newaba

11-5-14E

~~VCS 008~~

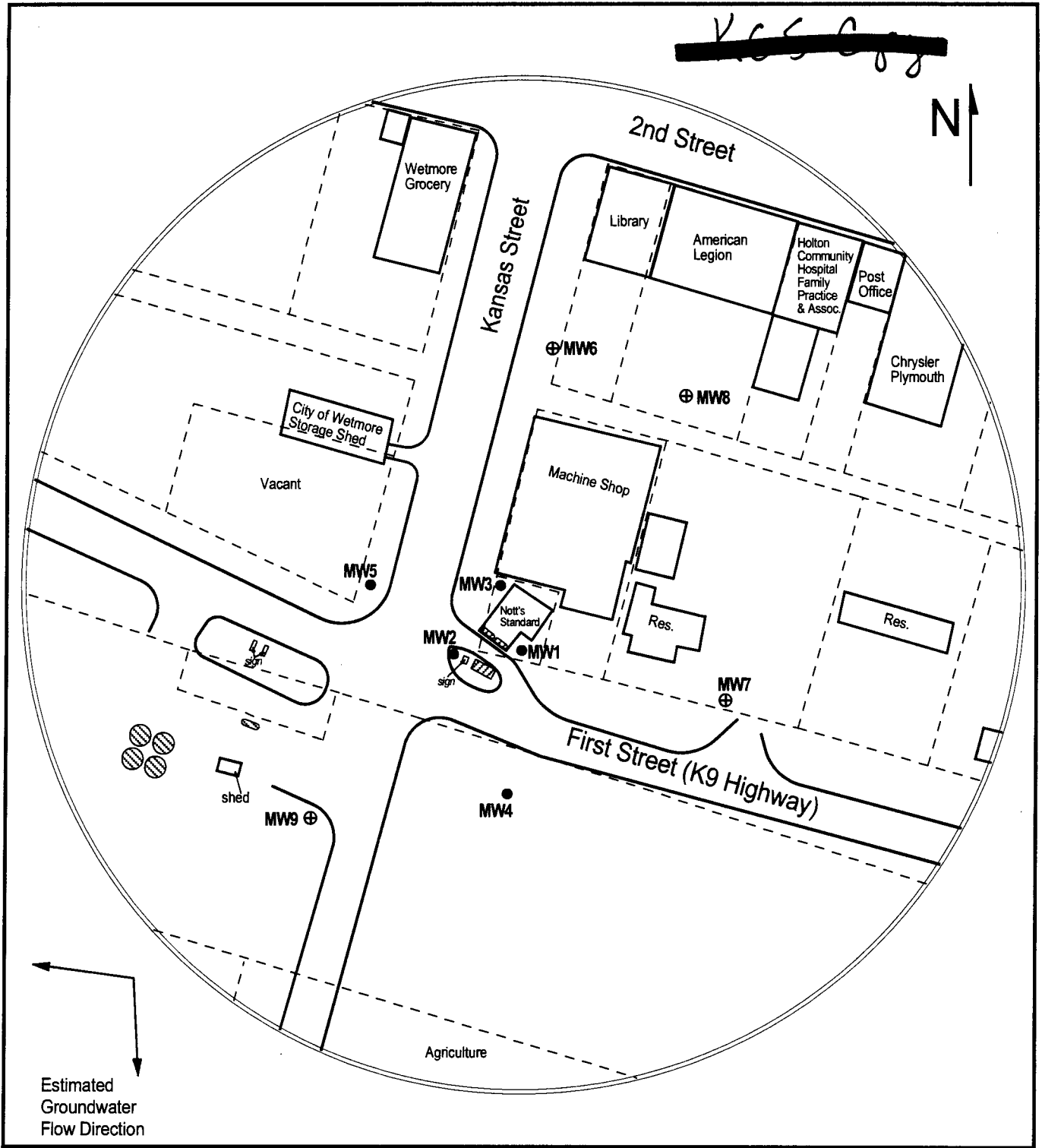

Estimated Groundwater Flow Direction

**LEGEND:**

- Approximate Location of Former UST Basin
- Approximate Location of Active AST and Pump Island
- Approximate Location of Property Line
- Monitoring Well
- Monitoring Well (Installed 3/4/14)



**PROJECT:**  
 Nott's Standard  
 1st & Kansas Ave  
 Wetmore, KS  
 KDHE ID: U4-066-12294  
 Date: 3/4/14



1311 E 25th St., Suite B (785) 841-8707 office  
 Lawrence, KS 66046 (785) 865-4282 fax

NOTE: Approximate location of active and former product lines are unknown.  
 NOTE: Monitoring wells have not been formerly surveyed by a licensed surveyor.  
 The top of casing elevation is based on an onsite benchmark.