

1 LOCATION OF WATER WELL: County: *Atchison* Fraction *1/4 NW 1/4 SW 1/4 NW 1/4* Section Number *30* Township Number *T 5 S* Range Number *R 21 E*

2 WELL OWNER: Last Name: *Kansas Dept. of Corrections* First: *714 Jackson, Suite 300* Street or Rural Address where well is located (if unknown, distance and direction from nearest town or intersection): If at owner's address, check here:
 Address: *Topeka* State: *Ks* ZIP: *66603* *Atchison, Ks.*

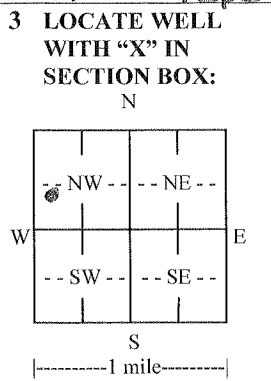

4 DEPTH OF COMPLETED WELL: *30'* ft.
 Depth(s) Groundwater Encountered: 1) *22'* ft.
 2) ft. 3) ft., or 4) Dry Well
 WELL'S STATIC WATER LEVEL: *21.94'* ft.
 below land surface, measured on (mo-day-yr) *7/14/14*
 above land surface, measured on (mo-day-yr)
 Pump test data: Well water was ft. after hours pumping gpm
 Well water was ft. after hours pumping gpm
 Estimated Yield: gpm
 Bore Hole Diameter: *7 1/2"* in. to *36'* ft. and in. to ft.

5 Latitude: *39.352559* (decimal degrees)
Longitude: *95.064677* (decimal degrees)
 Datum: WGS 84 NAD 83 NAD 27
 Source for Latitude/Longitude:
 GPS (unit make/model:)
 (WAAS enabled? Yes No)
 Land Survey Topographic Map
 Online Mapper: *Google Earth*
6 Elevation: *786.21* ft. Ground Level TOC
 Source: Land Survey GPS Topographic Map
 Other

- 7 WELL WATER TO BE USED AS:**
- 1. Domestic: Household Lawn & Garden Livestock
 - 2. Irrigation
 - 3. Feedlot
 - 4. Industrial
 - 5. Public Water Supply: well ID
 - 6. Dewatering: how many wells?
 - 7. Aquifer Recharge: well ID
 - 8. Monitoring: well ID
 - 9. Environmental Remediation: well ID
 Air Sparge Soil Vapor Extraction
 Recovery Injection
 - 10. Oil Field Water Supply: lease
 - 11. Test Hole: well ID
 Cased Uncased Geotechnical
 - 12. Geothermal: how many bores?
 a) Closed Loop Horizontal Vertical
 b) Open Loop Surface Discharge Inj. of Water
 - 13. Other (specify):

Was a chemical/bacteriological sample submitted to KDHE? Yes No If yes, date sample was submitted:
 Water well disinfected? Yes No

8 TYPE OF CASING USED: Steel PVC Other CASING JOINTS: Glued Clamped Welded Threaded
 Casing diameter: *2.375* in. to *15'* ft., Diameter in. to ft., Diameter in. to ft.
 Casing height above land surface: *Flush Mt.* in. Weight lbs./ft. Wall thickness or gauge No. *sch 40*
 TYPE OF SCREEN OR PERFORATION MATERIAL:
 Steel Stainless Steel Fiberglass PVC Other (Specify)
 Brass Galvanized Steel Concrete tile None used (open hole)
 SCREEN OR PERFORATION OPENINGS ARE:
 Continuous Slot Mill Slot Gauze Wrapped Torch Cut Drilled Holes Other (Specify)
 Louvered Shutter Key Punched Wire Wrapped Saw Cut None (Open Hole)
 SCREEN-PERFORATED INTERVALS: From *30'* ft. to *15'* ft., From ft. to ft., From ft. to ft.
 GRAVEL PACK INTERVALS: From *30'* ft. to *13'* ft., From ft. to ft., From ft. to ft.

9 GROUT MATERIAL: Neat cement Cement grout Bentonite Other *Concrete*
 Grout Intervals: From *13'* ft. to *2'* ft., From *2'* ft. to *0'* ft., From ft. to ft.

Nearest source of possible contamination:
 Septic Tank Lateral Lines Pit Privy Livestock Pens Insecticide Storage
 Sewer Lines Cess Pool Sewage Lagoon Fuel Storage *Fumes* Abandoned Water Well
 Watertight Sewer Lines Seepage Pit Feedyard Fertilizer Storage Oil Well/Gas Well
 Other (Specify)
 Direction from well? *West South West* Distance from well? *75'* ft.

10 FROM	TO	LITHOLOGIC LOG	FROM	TO	LITHO. LOG (cont.) or PLUGGING INTERVALS
0	7.0	Med. bn. silty clay			
7.0	15.0	Redd. bn. clay till			
15.0	22.0	bn. clayey sand			
22.0	30.0	gray bn. silty clay sand			
Notes:					

11 CONTRACTOR'S OR LANDOWNER'S CERTIFICATION: This water well was constructed, reconstructed, or plugged under my jurisdiction and was completed on (mo-day-year) *7/19/14* and this record is true to the best of my knowledge and belief. Kansas Water Well Contractor's License No. *1223* This Water Well Record was completed on (mo-day-year) *7/18/14* under the business name of *QB Environmental Drilling* *James Beckli*