

1 LOCATION OF WATER WELL: County: Atchison Fraction: 1/4 NW 1/4 SW 1/4 NW 1/4 Section Number: 30 Township Number: T 5 S Range Number: R 21 E

2 WELL OWNER: Last Name: _____ First: _____
 Business: Kansas Dept. of Collections Street or Rural Address where well is located (if unknown, distance and direction from nearest town or intersection): If at owner's address, check here:
 Address: 714 Jackson; Suite 300 1900 N. 2nd Str.
 Address: _____
 City: Topeka State: Ks. ZIP: 66603 Atchison, Ks.

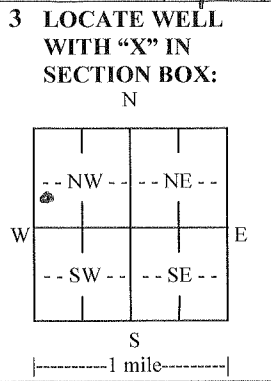

4 DEPTH OF COMPLETED WELL: 40' ft.
 Depth(s) Groundwater Encountered: 1) 32' ft.
 2) _____ ft. 3) _____ ft., or 4) Dry Well
 WELL'S STATIC WATER LEVEL: _____ ft.
 below land surface, measured on (mo-day-yr) 7/14/14
 above land surface, measured on (mo-day-yr) _____
 Pump test data: Well water was _____ ft. after _____ hours pumping _____ gpm
 Well water was _____ ft. after _____ hours pumping _____ gpm
 Estimated Yield: _____ gpm
 Bore Hole Diameter: 7 1/2" in. to 40' ft. and _____ in. to _____ ft.

5 Latitude: 37.352368 (decimal degrees)
Longitude: 95.064791 (decimal degrees)
 Datum: WGS 84 NAD 83 NAD 27
 Source for Latitude/Longitude:
 GPS (unit make/model: _____) (WAAS enabled? Yes No)
 Land Survey Topographic Map
 Online Mapper: Google Earth
6 Elevation: 1521.20 ft. Ground Level TOC
 Source: Land Survey GPS Topographic Map
 Other _____

- 7 WELL WATER TO BE USED AS:**
- 1. Domestic: Household Lawn & Garden Livestock
 - 2. Irrigation
 - 3. Feedlot
 - 4. Industrial
 - 5. Public Water Supply: well ID _____
 - 6. Dewatering: how many wells? _____
 - 7. Aquifer Recharge: well ID _____
 - 8. Monitoring: well ID _____
 - 9. Environmental Remediation: well ID _____
 Air Sparge Soil Vapor Extraction
 Recovery Injection
 - 10. Oil Field Water Supply: lease _____
 - 11. Test Hole: well ID _____
 Cased Uncased Geotechnical
 - 12. Geothermal: how many bores? _____
 a) Closed Loop Horizontal Vertical
 b) Open Loop Surface Discharge Inj. of Water
 - 13. Other (specify): _____

Was a chemical/bacteriological sample submitted to KDHE? Yes No If yes, date sample was submitted: _____
 Water well disinfected? Yes No

8 TYPE OF CASING USED: Steel PVC Other _____ CASING JOINTS: Glued Clamped Welded Threaded
 Casing diameter 2.375 in. to 25' ft., Diameter _____ in. to _____ ft., Diameter _____ in. to _____ ft.
 Casing height above land surface FLUSH in. Weight _____ lbs./ft. Wall thickness or gauge No. SCH 40
TYPE OF SCREEN OR PERFORATION MATERIAL:
 Steel Stainless Steel Fiberglass PVC Other (Specify) _____
 Brass Galvanized Steel Concrete tile None used (open hole)
SCREEN OR PERFORATION OPENINGS ARE:
 Continuous Slot Mill Slot Gauze Wrapped Torch Cut Drilled Holes Other (Specify) _____
 Louvered Shutter Key Punched Wire Wrapped Saw Cut None (Open Hole)
SCREEN-PERFORATED INTERVALS: From 40' ft. to 25' ft., From _____ ft. to _____ ft., From _____ ft. to _____ ft.
GRAVEL PACK INTERVALS: From 40' ft. to 23' ft., From _____ ft. to _____ ft., From _____ ft. to _____ ft.

9 GROUT MATERIAL: Neat cement Cement grout Bentonite Other concrete
 Grout Intervals: From 23' ft. to 2' ft., From 2' ft. to 0' ft., From _____ ft. to _____ ft.

Nearest source of possible contamination:
 Septic Tank Lateral Lines Pit Privy Livestock Pens Insecticide Storage
 Sewer Lines Cess Pool Sewage Lagoon Fuel Storage tower Abandoned Water Well
 Watertight Sewer Lines Seepage Pit Feedyard Fertilizer Storage Oil Well/Gas Well
 Other (Specify) _____
 Direction from well? North Distance from well? 150' ft.

10 FROM	TO	LITHOLOGIC LOG	FROM	TO	LITHO. LOG (cont.) or PLUGGING INTERVALS
0	3.0	DK Ben clay			
3.0	20.0	Med Ben silty clay			
20.0	32.0	Rust Ben sandy clay till			
32.0	40.0	Ben sandy clay till			

Notes: well drilled 7/9/14

11 CONTRACTOR'S OR LANDOWNER'S CERTIFICATION: This water well was constructed, reconstructed, or plugged under my jurisdiction and was completed on (mo-day-year) 7/14/14 and this record is true to the best of my knowledge and belief.
 Kansas Water Well Contractor's License No. 7322 This Water Well Record was completed on (mo-day-year) 7/14/14
 under the business name of O.B. Environmental Drilling James Burke