

WATER WELL RECORD

Form WWC-5

Division of Water Resources App. No.

Blank box for application number

1 LOCATION OF WATER WELL: County: Marshall Co. NW 1/4 SW 1/4 SW 1/4 1/4 Section Number 28 Township No. T 5 S Range Number R 7 E W

Street/Rural Address of Well Location; if unknown, distance & direction from nearest town or intersection: If at owner's address, check here [ ] From Blue Rapids go south 5 miles on PARD Rd. to Cyclone Rd. then go 1 mi. East to 9th Rd. 600 ft. South

Global Positioning System (GPS) information: Latitude: Longitude: Datum: [ ] WGS 84, [ ] NAD 83, [ ] NAD 27 Collection Method: [ ] GPS unit (Make/Model: [ ] Digital Map/Photo, [ ] Topographic Map, [ ] Land Survey Est. Accuracy: [ ] <3 m, [ ] 3-5 m, [ ] 5-15 m, [ ] >15 m

2 WATER WELL OWNER: RR#, Street Address, Box #: 18929 N. Otter Branch Randolph, KS 66554 City, State, ZIP Code

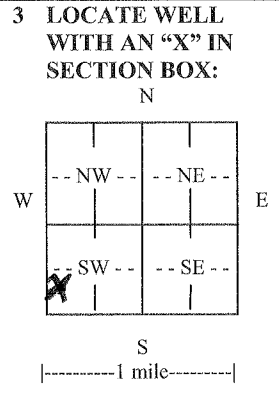

3 LOCATE WELL WITH AN 'X' IN SECTION BOX: N W E S 1/4 mile 4 DEPTH OF COMPLETED WELL 116 ft. Depth(s) Groundwater Encountered (1) 47 ft. (2) (3) WELL'S STATIC WATER LEVEL 40 ft. below land surface measured on mo/day/yr Pump test data: Well water was ft. after hours pumping gpm EST. YIELD 470 gpm Well water was ft. after hours pumping gpm Bore Hole Diameter 9 in. to 11.6 ft., and in. to ft. WELL WATER TO BE USED AS: [ ] Public water supply [ ] Geothermal [ ] Injection well [ ] Domestic [ ] Feedlot [ ] Oil field water supply [ ] Dewatering [ ] Other (Specify below) [ ] Irrigation [ ] Industrial [ ] Domestic-lawn & garden [ ] Monitoring well [ ] Limestone Was a chemical/bacteriological sample submitted to Department? [ ] Yes [ ] No If yes, mo/day/yr sample was submitted Water well disinfected? [ ] Yes [ ] No

5 TYPE OF CASING USED: [ ] Steel [ ] PVC [ ] Other CASING JOINTS: [ ] Glued [ ] Clamped [ ] Welded [ ] Threaded Casing diameter 5 in. to 9.6 in., Diameter in. to in. to in. to in. to Casing height above land surface 3 in., Weight 24.40 lbs./ft., Wall thickness or gauge No. TYPE OF SCREEN OR PERFORATION MATERIAL: [ ] Steel [ ] Stainless Steel [ ] PVC [ ] Brass [ ] Galvanized Steel [ ] None used (open hole) SCREEN OR PERFORATION OPENING ARE: [ ] Continuous slot [ ] Mill 4/1000 slot [ ] Gauze wrapped [ ] Torch cut [ ] Drilled holes [ ] None (open hole) [ ] Louvered shutter [ ] Knipunched [ ] Wire wrapped [ ] Saw cut [ ] Other (specify) SCREEN-PERFORATED INTERVALS: From 9.6 ft. to 116 ft., From ft. to ft. to ft. GRAVEL PACK INTERVALS: From 3.0 ft. to 116 ft., From ft. to ft. to ft.

6 GROUT MATERIAL: [ ] Neat cement [ ] Cement grout [ ] Bentonite [ ] Other Grout Intervals: From 5 ft. to 30 ft., From ft. to ft. to ft. to ft. What is the nearest source of possible contamination: None Close [ ] Septic tank [ ] Lateral lines [ ] Pit privy [ ] Livestock pens [ ] Insecticide storage [ ] Other (specify below) [ ] Sewer lines [ ] Cesspool [ ] Sewage lagoon [ ] Fuel storage [ ] Abandoned water well [ ] Watertight sewer lines [ ] Seepage pit [ ] Feedyard [ ] Fertilizer storage [ ] Oil well/gas well Direction from well Distance from well

Table with columns FROM, TO, LITHOLOGIC LOG, FROM, TO, LITHO. LOG (cont.) or PLUGGING INTERVALS. Rows include: 0-1 Top Soil, 1-15 Brown Clay, 15-19 Limestone, 19-34 Greenish Shale, 34-36 Limestone, 36-47 Gray Shale, 47-62 Limestone, 62-72 Limestone, 72-77 Gray Silty Shale, 77-88 Tan Shale. Plugging intervals: 88-92 Limestone, 92-101 Tan Shale, 101-106 Limestone, 106-116 Gray Silty Shale (Dark).

7 CONTRACTOR'S OR LANDOWNER'S CERTIFICATION: This water well was [ ] constructed, [ ] reconstructed, or [ ] plugged under my jurisdiction and was completed on (mo/day/year) 3/20/2013. This record is true to the best of my knowledge and belief. Kansas Water Well Contractor's License No. 451. This Water Well Record was completed on (mo/day/year) 4/10/2013 under the business name of Holdenman Well Drilling by (signature) Craig W. Holdenman

INSTRUCTIONS: Use typewriter or ball point pen. PLEASE PRESS FIRMLY and PRINT clearly. Please fill in blanks and check the correct answers. Send three copies (white, blue, pink) to Kansas Department of Health and Environment, Bureau of Water, Geology Section, 1000 SW Jackson St., Suite 420, Topeka, Kansas 66612-1367. Telephone 785-296-5524. Send one copy to WATER WELL OWNER and retain one for your records. Include fee of \$5.00 for each constructed well. Visit us at http://www.kdheks.gov/waterwell/index.html.