

## WATER WELL PLUGGING RECORD Form WWC-5P

KSA 82a-1212

ID NO.

MW1

<b>1 LOCATION OF WATER WELL:</b> County: Pottawatomie	Fraction SW ¼ NW¼ SE ¼ NE ¼	Section Number 29	Township Number T 6 S	Range Number 10 <input checked="" type="checkbox"/> E <input type="checkbox"/> W
Street/Rural Address of Well Location; if unknown, distance & direction from nearest town or intersection: If at owner's address, check here <input type="checkbox"/> Main Street & Center Street Wheaton, Kansas		<b>Global Positioning Systems (GPS) information:</b> Latitude: 39.50287 (in decimal degrees) Longitude: 96.31804 (in decimal degrees) Elevation: 1510.15 Ground Horizontal Datum: <input type="checkbox"/> WGS84, <input checked="" type="checkbox"/> NAD83, <input type="checkbox"/> NAD27 Collection Method:		

<b>2 WATER WELL OWNER:</b> Pottawatomie County RR#, St. Address, Box #: PO Box 187 City, State ZIP Code: Westmoreland, KS 66549	<input type="checkbox"/> GPS unit (Make/Model: _____) <input type="checkbox"/> Digital Map/Photo, <input type="checkbox"/> Topographic Map, <input checked="" type="checkbox"/> Land Survey Est. Accuracy: <input checked="" type="checkbox"/> < 3 m, <input type="checkbox"/> 3-5 m, <input type="checkbox"/> 5-15 m, <input type="checkbox"/> > 15 m
---	--

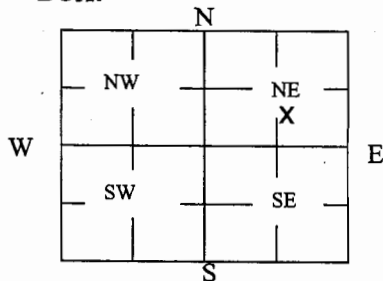
**3 MARK WELL'S LOCATION WITH AN "X" IN SECTION BOX:****4 DEPTH OF WELL** 24.94 **ft.**WELL'S STATIC WATER LEVEL Dry ft

WELL WAS USED AS:

- |                                     |   |  |
|-------------------------------------|---|--|
| <input type="checkbox"/> Domestic   | <input type="checkbox"/> Public Water Supply      | <input type="checkbox"/> Dewatering            |
| <input type="checkbox"/> Irrigation | <input type="checkbox"/> Oil Field Water Supply   | <input checked="" type="checkbox"/> Monitoring |
| <input type="checkbox"/> Feedlot    | <input type="checkbox"/> Domestic (Lawn & Garden) | <input type="checkbox"/> Injection Well        |
| <input type="checkbox"/> Industrial | <input type="checkbox"/> Air Conditioning         | <input type="checkbox"/> Other _____           |

Was a chemical/bacteriological sample submitted to Department? Yes ☐ No ☒**5 TYPE OF BLANK CASING USED:**

- |   |                                   |  |  |  |
|---|-----------------------------------|--|--|--|
| <input checked="" type="checkbox"/> Steel | <input type="checkbox"/> RMP (SR) | <input type="checkbox"/> Wrought         | <input type="checkbox"/> Fiberglass    | <input type="checkbox"/> Other (Specify below) _____ |
| <input checked="" type="checkbox"/> PVC   | <input type="checkbox"/> ABS      | <input type="checkbox"/> Asbestos-Cement | <input type="checkbox"/> Concrete Tile |  |

 Blank casing diameter 2 in. Was casing pulled? Yes ☒ No ☐ If yes, how much 3 Ft  
 Casing height above or below land surface 36 in.
**6 GROUT PLUG MATERIAL:** ☐ Neat cement ☐ Cement grout ☒ Bentonite ☐ Other \_\_\_\_\_Grout Plug Intervals: From 3 ft. to 24.94 ft., From \_\_\_\_\_ ft. to \_\_\_\_\_ ft., From \_\_\_\_\_ ft. to \_\_\_\_\_ ft.

What is the nearest source of possible contamination:

- |   |   |   |  |
|---|---|---|--|
| <input type="checkbox"/> Septic tank            | <input type="checkbox"/> Seepage pit    | <input type="checkbox"/> Fuel storage         | <input checked="" type="checkbox"/> Other (specify below)<br><u>Contaminated Site U4-075-14975</u> |
| <input type="checkbox"/> Sewer lines            | <input type="checkbox"/> Pit privy      | <input type="checkbox"/> Fertilizer storage   |  |
| <input type="checkbox"/> Watertight sewer lines | <input type="checkbox"/> Sewage lagoon  | <input type="checkbox"/> Insecticide storage  |  |
| <input type="checkbox"/> Lateral lines          | <input type="checkbox"/> Feedyard       | <input type="checkbox"/> Abandoned water well |  |
| <input type="checkbox"/> Cess pool              | <input type="checkbox"/> Livestock pens | <input type="checkbox"/> Oil well/Gas well    |  |

 Direction from well? On site  
 How many feet? 0

FROM	TO	PLUGGING MATERIALS	FROM	TO	PLUGGING MATERIALS
0	3	Compacted Silt/Clay w/grvl on top			
3	24.94	Hydrated Bentonite chips			
					U4-075-14975

**7 CONTRACTOR'S OR LANDOWNER'S CERTIFICATION:** This water well was plugged under my jurisdiction and was completed on (mo/day/year) 12/20/18 and this record is true to the best of my knowledge and belief. Kansas Water Well Contractor's License No. 585. This Water Well Record was completed on (mo/day/year) 1/10/19 under the business name of Associated Environmental, Inc. by (signature) [Signature]

Send one white copy to Kansas Department of Health & Environment, Geology Section, 1000 SW Jackson Street, Ste. 420, Topeka, KS 66612-1367. Send one copy to WATER WELL OWNER and retain one for your records.  
 Visit us at <http://www.kdheks.gov/waterwell/index.html> Telephone 785-296-5524.

KSA82a-1212

Revised 1/20/2015

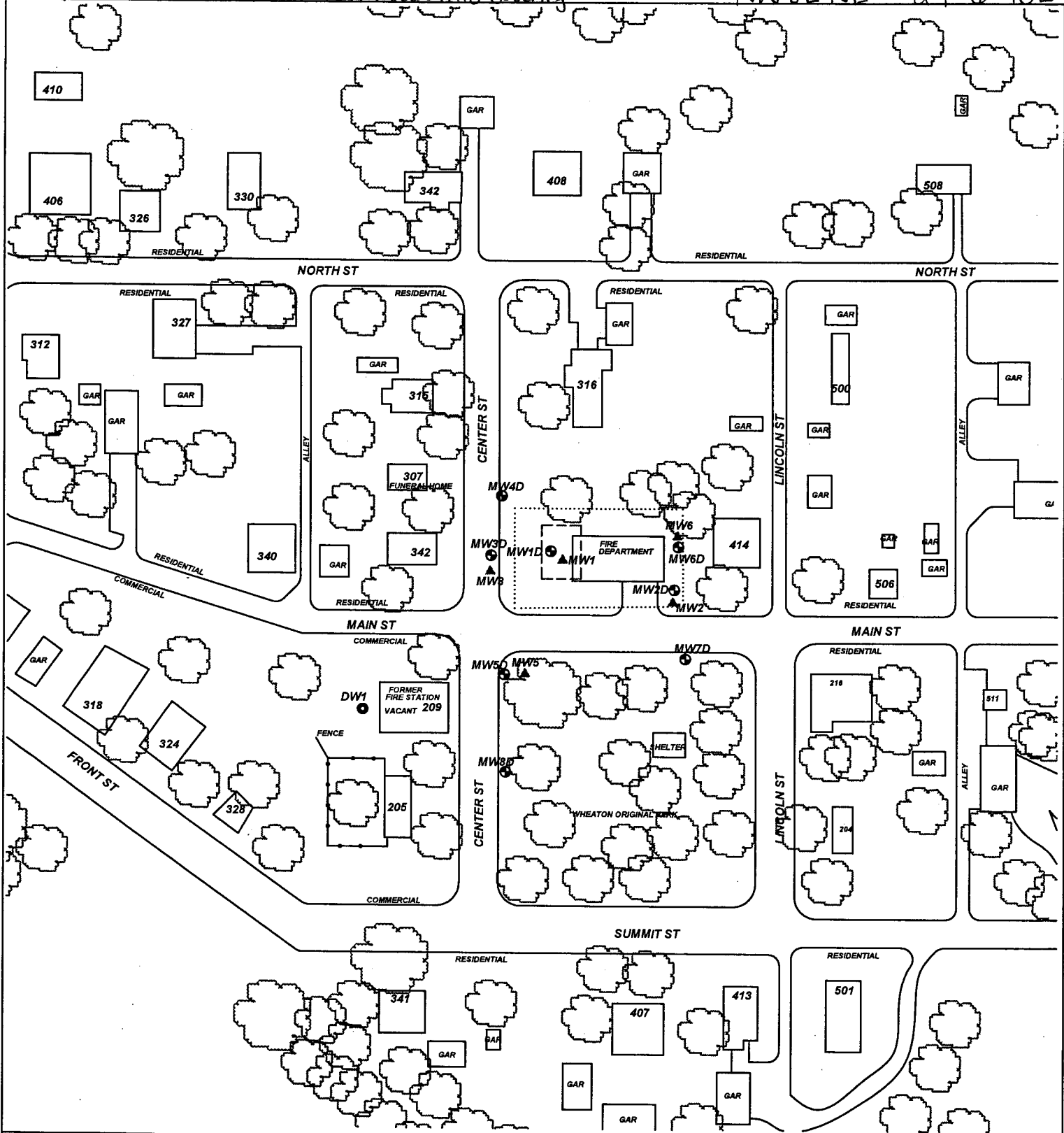

PROJECT: **NEW WHEATON FIRE STATION**

ADDRESS: **MAIN ST & CENTER ST**

LOCATION: **WHEATON, KS**

DRAWN BY: **B. STALNAKER** DATE: **2/6/18**

REVISED BY: **B. STALNAKER** DATE: **1/8/19**

AEI JOB # **TM226** KDHE JOB # **U4-075-14975**

SCALE: **1" = 100'**



NOTES:  
No basements observed within 500'.



**ASSOCIATED  
ENVIRONMENTAL  
INC.**

LEGEND:

- = FORMER UST BASIN/EXCAVATION
- = MONITORING WELL
- = PRIVATE WELL
- = PLUGGED/DESTROYED WELL

..... = SUBJECT PROPERTY

