

WATER WELL RECORD

Form WWC-5

Division of Water Resources App. No.

DWR-46701

1 LOCATION OF WATER WELL: County: <u>Atchison</u>	Fraction $\frac{1}{4}$ $\frac{1}{4}$ <u>NW</u> $\frac{1}{4}$ <u>NW</u> $\frac{1}{4}$	Section Number <u>26</u>	Township No. T <u>6</u> S	Range Number R <u>17</u> <input checked="" type="checkbox"/> E <input type="checkbox"/> W
---	---	-----------------------------	------------------------------	--

Street/Rural Address of Well Location; if unknown, distance & direction from nearest town or intersection: If at owner's address, check here .
North of intersection of Chautauqua Road and Route 116 southwest of Effingham, Atchison Co., Kansas

2 WATER WELL OWNER:
RR#, Street Address, Box #: Atchison County CRWD No. 5
City, State, ZIP Code: P.O. Box 65 Lancaster, Kansas 66041

Global Positioning System (GPS) information:
Latitude: (in decimal degrees)
Longitude: (in decimal degrees)
Elevation:
Datum: WGS 84, NAD 83, NAD 27
Collection Method:
 GPS unit (Make/Model:)
 Digital Map/Photo, Topographic Map, Land Survey
Est. Accuracy: <3 m, 3-5 m, 5-15 m, >15 m

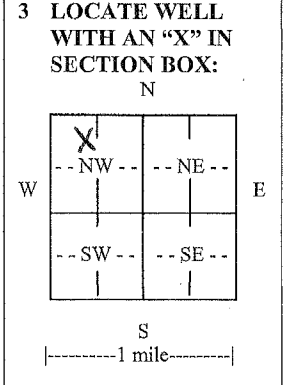

4 DEPTH OF COMPLETED WELL 130 ft.

Depth(s) Groundwater Encountered (1).....37.32 ft. (2)..... ft. (3)..... ft.

WELL'S STATIC WATER LEVEL.....37.32 ft. below land surface measured on mo/day/yr...10/19/11

Pump test data: Well water was.....62.72 ft. after.....24 hours pumping.....412 gpm

EST. YIELD.....300 gpm. Well water was..... ft. after..... hours pumping..... gpm

Bore Hole Diameter36 in. to130 ft., and in. to ft.

WELL WATER TO BE USED AS: Public water supply Geothermal Injection well
 Domestic Feedlot Oil field water supply Dewatering Other (Specify below)
 Irrigation Industrial Domestic-lawn & garden Monitoring well

Was a chemical/bacteriological sample submitted to Department? Yes No
 If yes, mo/day/yr sample was submitted.....10/19/11

Water well disinfected? Yes No

5 TYPE OF CASING USED: Steel PVC Other

CASING JOINTS: Glued Clamped Welded Threaded

Casing diameter16 in. to112.47 ft., Diameter in. to ft., Diameter in. to ft.

Casing height above land surface.....24 in., Weight lbs./ft., Wall thickness or gauge No.0.375"

TYPE OF SCREEN OR PERFORATION MATERIAL:

Steel Stainless Steel PVC Other (Specify)
 Brass Galvanized Steel None used (open hole)

SCREEN OR PERFORATION OPENINGS ARE:

Continuous slot Mill slot Gauze wrapped Torch cut Drilled holes None (open hole)
 Louvered shutter Key punched Wire wrapped Saw cut Other (specify)

SCREEN-PERFORATED INTERVALS: From.....110.42 ft. to130 ft., From ft. to ft.
 From..... ft. to ft., From ft. to ft.

GRAVEL PACK INTERVALS: From.....27 ft. to77 ft., From101 ft. to130 ft.
 From..... ft. to ft., From ft. to ft.

6 GROUT MATERIAL: Neat cement Cement grout Bentonite Other

Grout Intervals: From27 ft. to101 ft., From ft. to ft., From ft. to ft.

What is the nearest source of possible contamination:

Septic tank Lateral lines Pit privy Livestock pens Insecticide storage Other (specify below)
 Sewer lines Cesspool Sewage lagoon Fuel storage Abandoned water well
 Watertight sewer lines Seepage pit Feedyard Fertilizer storage Oil well/gas well

Direction from well Distance from well

FROM	TO	LITHOLOGIC LOG	FROM	TO	LITHO. LOG (cont.) or PLUGGING INTERVALS
0	1	Top Soil	130	131	Sand or soft clay
1	8.5	Clay, rusty-brown	131		Limestone
8.5	18	Clay, grey to rusty-brown			
18	31.5	Clay, tan to grey			
31.5	50.5	Silty clay w/ some gravel			
50.5	58.5	Clay, tan to grey w/ silt; boulder			
58.5	98	Sand, vt., some silty clay			
98	108	Sand, vt., w/ some fine gravel			
108	111	Sand, f.c., w/ fine gravel			
111	130	Gravel, f.c., w/ f.c. sand; brown			

7 CONTRACTOR'S OR LANDOWNER'S CERTIFICATION: This water well was constructed, reconstructed, or plugged under my jurisdiction and was completed on (mo/day/year) ...10/14/11... and this record is true to the best of my knowledge and belief.

Kansas Water Well Contractor's License No. ...102... This Water Well Record was completed on (mo/day/year)2/23/12... under the business name of ...Layne Christensen Company... by (signature)

INSTRUCTIONS: Use typewriter or ball point pen. PLEASE PRESS FIRMLY and PRINT clearly. Please fill in blanks and check the correct answers. Send three copies (white, blue, pink) to Kansas Department of Health and Environment, Bureau of Water, Geology Section, 1000 SW Jackson St., Suite 420, Topeka, Kansas 66612-1367. Telephone 785-296-5524. Send one copy to WATER WELL OWNER and retain one for your records. Include fee of \$5.00 for each constructed well. Visit us at <http://www.kdheks.gov/waterwell/index.html>.