

## WATER WELL RECORD Form WWC-5

Division of Water  
Resources App. No.

MW6

☒ Original Record ☐ Correction ☐ Change in Well Use

Well ID

## 1 LOCATION OF WATER WELL:

County: Jackson

Fraction

NW 1/4 NE 1/4 SE 1/4 NW 1/4

Section Number

9

Township Number

T 7 S

Range Number

R 15 E W

## 2 WELL OWNER: Last Name: Roush

First: Jerry

Business: Star Fuel Centers, Inc.

Address: 7415 W. 130th St., Suite 100

Address:

City: Overland Park

State: KS

ZIP: 66213

Street or Rural Address where well is located (if unknown, distance and direction from nearest town or intersection): If at owner's address, check here: ☐

111 S. Arizona Ave./HWY 75

Holton, KS 66436

3 LOCATE WELL  
WITH "X" IN  
SECTION BOX:

N

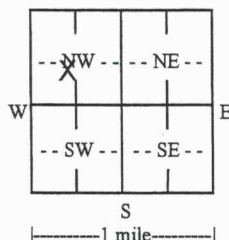

## 4 DEPTH OF COMPLETED WELL: 20 ft.

Depth(s) Groundwater Encountered: 1) 15 ft.

2) ft. 3) ft. or 4) ☐ Dry Well

WELL'S STATIC WATER LEVEL: 11.62 ft.

☒ below land surface, measured on (mo-day-yr) 1-27-20☐ above land surface, measured on (mo-day-yr)

Pump test data: Well water was ft.

after hours pumping gpm

Well water was ft.

after hours pumping gpm

Estimated Yield: gpm

Bore Hole Diameter: 8.5 in. to 20 ft. and

in. to ft.

5 Latitude: 39.45934 (decimal degrees)

Longitude: 95.74915 (decimal degrees)

Horizontal Datum: ☐ WGS 84 ☒ NAD 83 ☐ NAD 27

Source for Latitude/Longitude:

☐ GPS (unit make/model: )(WAAS enabled? ☐ Yes ☐ No)☒ Land Survey ☐ Topographic Map☐ Online Mapper:6 Elevation: 1062.32 ft. ☐ Ground Level ☒ TOCSource: ☐ Land Survey ☐ GPS ☐ Topographic Map☐ Other

## 7 WELL WATER TO BE USED AS:

1. Domestic:

☐ Household☐ Lawn & Garden☐ Livestock2. ☐ Irrigation3. ☐ Feedlot4. ☐ Industrial5. ☐ Public Water Supply: well ID6. ☐ Dewatering: how many wells?7. ☐ Aquifer Recharge: well ID8. ☒ Monitoring: well ID MW6

9. Environmental Remediation: well ID

☐ Air Sparge ☐ Soil Vapor Extraction☐ Recovery ☐ Injection10. ☐ Oil Field Water Supply: lease

11. Test Hole: well ID

☐ Cased ☐ Uncased ☐ Geotechnical

12. Geothermal: how many bores?

a) Closed Loop ☐ Horizontal ☐ Verticalb) Open Loop ☐ Surface Discharge ☐ Inj. of Water13. ☐ Other (specify):Was a chemical/bacteriological sample submitted to KDHE? ☐ Yes ☒ No If yes, date sample was submitted:Water well disinfected? ☐ Yes ☐ No8 TYPE OF CASING USED: ☐ Steel ☒ PVC ☐ Other CASING JOINTS: ☐ Glued ☐ Clamped ☐ Welded ☒ Threaded

Casing diameter 2 in. to 10 ft., Diameter in. to ft., Diameter in. to ft.

Casing height above land surface in. Weight lbs./ft. Wall thickness or gauge No. 40

TYPE OF SCREEN OR PERFORATION MATERIAL:

☐ Steel☐ Stainless Steel☐ Fiberglass☒ PVC☐ Other (Specify)☐ Brass☐ Galvanized Steel☐ Concrete tile☐ None used (open hole)

SCREEN OR PERFORATION OPENINGS ARE:

☐ Continuous Slot☒ Mill Slot☐ Gauze Wrapped☐ Torch Cut☐ Drilled Holes☐ Other (Specify)☐ Louvered Shutter☐ Key Punched☐ Wire Wrapped☐ Saw Cut☐ None (Open Hole)

SCREEN-PERFORATED INTERVALS: From 10 ft. to 20 ft., From ft. to ft., From ft. to ft.

GRAVEL PACK INTERVALS: From 8 ft. to 20 ft., From ft. to ft., From ft. to ft.

9 GROUT MATERIAL: ☐ Neat cement ☒ Cement grout ☒ Bentonite ☐ Other

Grout Intervals: From 0 ft. to 1 ft., From 1 ft. to 8 ft., From ft. to ft.

Nearest source of possible contamination:

☐ Septic Tank☐ Lateral Lines☐ Pit Privy☐ Livestock Pens☐ Insecticide Storage☐ Sewer Lines☐ Cess Pool☐ Sewage Lagoon☒ Fuel Storage☐ Abandoned Water Well☐ Watertight Sewer Lines☐ Seepage Pit☐ Feedyard☐ Fertilizer Storage☐ Oil Well/Gas Well☐ Other (Specify)

Direction from well? Southeast Distance from well? 110 ft.

10 FROM TO LITHOLOGIC LOG FROM TO LITHO. LOG (cont.) or PLUGGING INTERVALS

0 0.5 Concrete

0.5 20 Silty Clay (CL), brown, firm

Notes:

KDHE  
U4-043-1516611 CONTRACTOR'S OR LANDOWNER'S CERTIFICATION: This water well was ☒ constructed, ☐ reconstructed, or ☐ plugged under my jurisdiction and was completed on (mo-day-year) 1-20-20 and this record is true to the best of my knowledge and belief. Kansas Water Well Contractor's License No. 585 This Water Well Record was completed on (mo-day-year) 2-10-20 under the business name of Associated Environmental, Inc. Signature

Mail 1 white copy along with a fee of \$5.00 for each constructed well to: Kansas Department of Health and Environment, Bureau of Water, GWTS Section,

1000 SW Jackson St., Suite 420, Topeka, Kansas 66612-1367. Mail one to Water Well Owner and retain one for your records. Telephone 785-296-5524.

Visit us at <http://www.kdheks.gov/waterwell/index.html>

KSA 82a-1212

Revised 7/10/2015

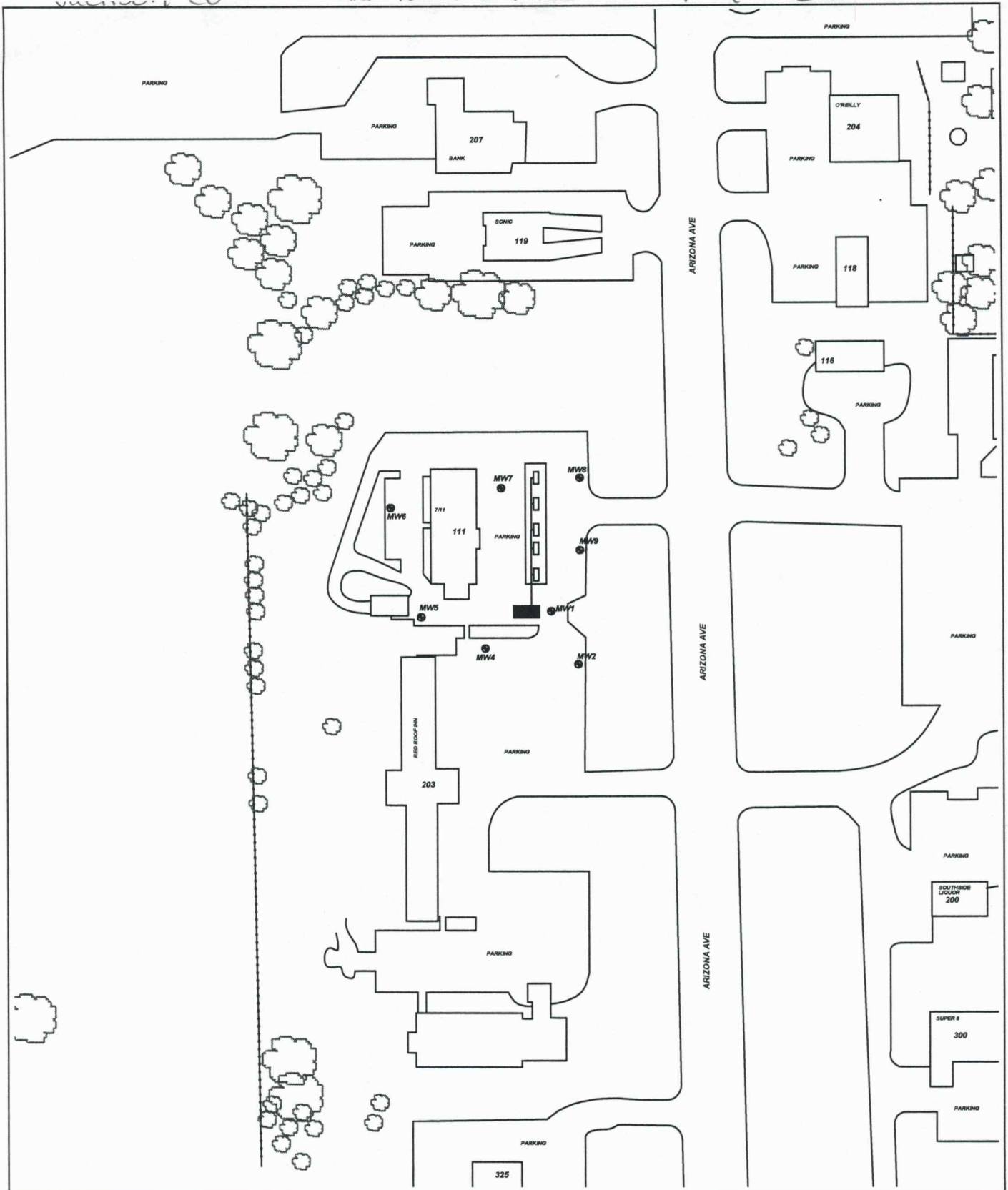

PROJECT: 7/11/STAR FUEL #606

ADDRESS: 111 S. 75 HWY

LOCATION: HOLTON, KS

DRAWN BY: C. ROE DATE: 11/6/19

REVISED BY: C. ROE DATE: 3/19/20

AEI JOB #: TF522 KDHE JOB #: U4-043-15166

SCALE: 1" = 100'

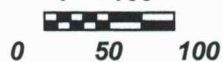

NOTES:

TITLE:



ASSOCIATED  
ENVIRONMENTAL  
INC.

LEGEND:

= UST BASIN AND PUMP ISLANDS

= MONITORING WELL

..... = SUBJECT PROPERTY

