

☒ Original Record ☐ Correction ☐ Change in Well Use

Well ID

MW9

1 LOCATION OF WATER WELL: County: Jackson		Fraction NE ¼ NE ¼ SE ¼ NW ¼		Section Number 9		Township Number T 7 S		Range Number R 15 E W																																																																			
2 WELL OWNER: Last Name: Roush First: Jerry Business: Star Fuel Centers, Inc. Address: 7415 W. 130th St., Suite 100 Address: City: Overland Park State: KS ZIP: 66213				Street or Rural Address where well is located (if unknown, distance and direction from nearest town or intersection): If at owner's address, check here: <input type="checkbox"/> 111 S. Arizona Ave./HWY 75 Holton, KS 66436																																																																							
3 LOCATE WELL WITH "X" IN SECTION BOX: N  S W E 1 mile		4 DEPTH OF COMPLETED WELL: 20 ft. Depth(s) Groundwater Encountered: 1) 15 ft. 2) ft. 3) ft., or 4) <input type="checkbox"/> Dry Well WELL'S STATIC WATER LEVEL: 8.09 ft. <input checked="" type="checkbox"/> below land surface, measured on (mo-day-yr) 1-27-20 <input type="checkbox"/> above land surface, measured on (mo-day-yr) Pump test data: Well water was ft. after hours pumping gpm Well water was ft. after hours pumping gpm Estimated Yield: gpm Bore Hole Diameter: 8.5 in. to 20 ft. and in. to ft.				5 Latitude: 39.45921 (decimal degrees) Longitude: 95.74840 (decimal degrees) Horizontal Datum: <input type="checkbox"/> WGS 84 <input checked="" type="checkbox"/> NAD 83 <input type="checkbox"/> NAD 27 Source for Latitude/Longitude: <input type="checkbox"/> GPS (unit make/model: (WAAS enabled? <input type="checkbox"/> Yes <input type="checkbox"/> No) <input checked="" type="checkbox"/> Land Survey <input type="checkbox"/> Topographic Map <input type="checkbox"/> Online Mapper:																																																																					
7 WELL WATER TO BE USED AS: 1. Domestic: <input type="checkbox"/> Household <input type="checkbox"/> Lawn & Garden <input type="checkbox"/> Livestock 2. <input type="checkbox"/> Irrigation 3. <input type="checkbox"/> Feedlot 4. <input type="checkbox"/> Industrial 5. <input type="checkbox"/> Public Water Supply: well ID 6. <input type="checkbox"/> Dewatering: how many wells? 7. <input type="checkbox"/> Aquifer Recharge: well ID 8. <input checked="" type="checkbox"/> Monitoring: well ID MW9 9. Environmental Remediation: well ID <input type="checkbox"/> Air Sparge <input type="checkbox"/> Soil Vapor Extraction <input type="checkbox"/> Recovery <input type="checkbox"/> Injection 10. <input type="checkbox"/> Oil Field Water Supply: lease 11. Test Hole: well ID <input type="checkbox"/> Cased <input type="checkbox"/> Uncased <input type="checkbox"/> Geotechnical 12. Geothermal: how many bores? a) Closed Loop <input type="checkbox"/> Horizontal <input type="checkbox"/> Vertical b) Open Loop <input type="checkbox"/> Surface Discharge <input type="checkbox"/> Inj. of Water 13. <input type="checkbox"/> Other (specify):																																																																											
Was a chemical/bacteriological sample submitted to KDHE? <input type="checkbox"/> Yes <input checked="" type="checkbox"/> No If yes, date sample was submitted: Water well disinfected? <input type="checkbox"/> Yes <input type="checkbox"/> No																																																																											
8 TYPE OF CASING USED: <input type="checkbox"/> Steel <input checked="" type="checkbox"/> PVC <input type="checkbox"/> Other CASING JOINTS: <input type="checkbox"/> Glued <input type="checkbox"/> Clamped <input type="checkbox"/> Welded <input checked="" type="checkbox"/> Threaded Casing diameter 2 in. to 10 ft., Diameter in. to ft., Diameter in. to ft. Casing height above land surface in. Weight lbs./ft. Wall thickness or gauge No. 40 TYPE OF SCREEN OR PERFORATION MATERIAL: <input type="checkbox"/> Steel <input type="checkbox"/> Stainless Steel <input type="checkbox"/> Fiberglass <input checked="" type="checkbox"/> PVC <input type="checkbox"/> Other (Specify) <input type="checkbox"/> Brass <input type="checkbox"/> Galvanized Steel <input type="checkbox"/> Concrete tile <input type="checkbox"/> None used (open hole) SCREEN OR PERFORATION OPENINGS ARE: <input type="checkbox"/> Continuous Slot <input checked="" type="checkbox"/> Mill Slot <input type="checkbox"/> Gauze Wrapped <input type="checkbox"/> Torch Cut <input type="checkbox"/> Drilled Holes <input type="checkbox"/> Other (Specify) <input type="checkbox"/> Louvered Shutter <input type="checkbox"/> Key Punched <input type="checkbox"/> Wire Wrapped <input type="checkbox"/> Saw Cut <input type="checkbox"/> None (Open Hole) SCREEN-PERFORATED INTERVALS: From 10 ft. to 20 ft., From ft. to ft., From ft. to ft. GRAVEL PACK INTERVALS: From 8 ft. to 20 ft., From ft. to ft., From ft. to ft.																																																																											
9 GROUT MATERIAL: <input type="checkbox"/> Neat cement <input checked="" type="checkbox"/> Cement grout <input checked="" type="checkbox"/> Bentonite <input type="checkbox"/> Other Grout Intervals: From 0 ft. to 1 ft., From 1 ft. to 8 ft., From ft. to ft. Nearest source of possible contamination: <input type="checkbox"/> Septic Tank <input type="checkbox"/> Lateral Lines <input type="checkbox"/> Pit Privy <input type="checkbox"/> Livestock Pens <input type="checkbox"/> Insecticide Storage <input type="checkbox"/> Sewer Lines <input type="checkbox"/> Cess Pool <input type="checkbox"/> Sewage Lagoon <input checked="" type="checkbox"/> Fuel Storage <input type="checkbox"/> Abandoned Water Well <input type="checkbox"/> Watertight Sewer Lines <input type="checkbox"/> Seepage Pit <input type="checkbox"/> Feedyard <input type="checkbox"/> Fertilizer Storage <input type="checkbox"/> Oil Well/Gas Well <input type="checkbox"/> Other (Specify) Direction from well: Southwest Distance from well? 50 ft.																																																																											
<table border="1" style="width: 100%; border-collapse: collapse;"> <thead> <tr> <th colspan="2">10 FROM TO</th> <th>LITHOLOGIC LOG</th> <th>FROM</th> <th>TO</th> <th>LITHO. LOG (cont.) or PLUGGING INTERVALS</th> </tr> </thead> <tbody> <tr> <td>0</td> <td>0.5</td> <td>Concrete</td> <td></td> <td></td> <td></td> </tr> <tr> <td>0.5</td> <td>20</td> <td>Silty Clay (CL), brown, firm</td> <td></td> <td></td> <td></td> </tr> <tr><td> </td><td> </td><td> </td><td> </td><td> </td><td> </td></tr> <tr><td> </td><td> </td><td> </td><td> </td><td> </td><td> </td></tr> <tr><td> </td><td> </td><td> </td><td> </td><td> </td><td> </td></tr> <tr><td> </td><td> </td><td> </td><td> </td><td> </td><td> </td></tr> <tr><td> </td><td> </td><td> </td><td> </td><td> </td><td> </td></tr> <tr><td> </td><td> </td><td> </td><td> </td><td> </td><td> </td></tr> <tr><td> </td><td> </td><td> </td><td> </td><td> </td><td> </td></tr> <tr><td> </td><td> </td><td> </td><td> </td><td> </td><td> </td></tr> </tbody> </table>										10 FROM TO		LITHOLOGIC LOG	FROM	TO	LITHO. LOG (cont.) or PLUGGING INTERVALS	0	0.5	Concrete				0.5	20	Silty Clay (CL), brown, firm																																																			
10 FROM TO		LITHOLOGIC LOG	FROM	TO	LITHO. LOG (cont.) or PLUGGING INTERVALS																																																																						
0	0.5	Concrete																																																																									
0.5	20	Silty Clay (CL), brown, firm																																																																									
Notes: KDHE # 44-043-15166																																																																											
11 CONTRACTOR'S OR LANDOWNER'S CERTIFICATION: This water well was <input checked="" type="checkbox"/> constructed, <input type="checkbox"/> reconstructed, or <input type="checkbox"/> plugged under my jurisdiction and was completed on (mo-day-year) 1-20-20 and this record is true to the best of my knowledge and belief. Kansas Water Well Contractor's License No. 585 This Water Well Record was completed on (mo-day-year) 2-10-20 under the business name of Associated Environmental, Inc. Signature																																																																											
Mail 1 white copy along with a fee of \$5.00 for each constructed well to: Kansas Department of Health and Environment, Bureau of Water, GWTS Section, 1000 SW Jackson St., Suite 420, Topeka, Kansas 66612-1367. Mail one to Water Well Owner and retain one for your records. Telephone 785-296-5524. Visit us at http://www.kdheks.gov/waterwell/index.html KSA 82a-1212 Revised 7/10/2015																																																																											

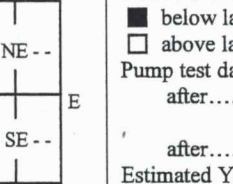
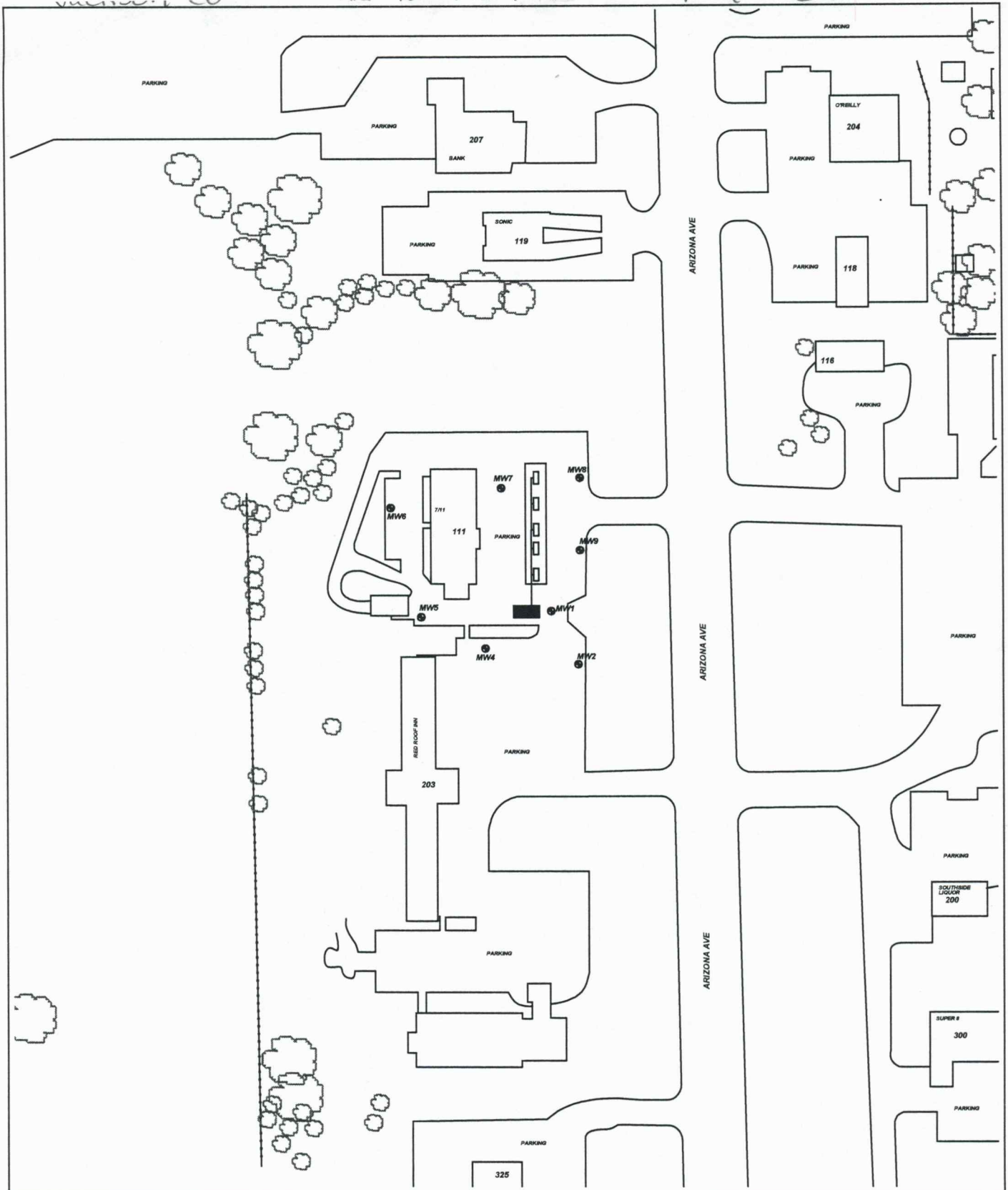

PROJECT: 7/11/STAR FUEL #606

ADDRESS: 111 S. 75 HWY

LOCATION: HOLTON, KS

DRAWN BY: C. ROE DATE: 11/6/19

REVISED BY: C. ROE DATE: 3/19/20

AEI JOB #: TF522 KDHE JOB #: U4-043-15166

SCALE: 1" = 100'



NOTES:

TITLE:



ASSOCIATED
ENVIRONMENTAL
INC.

LEGEND:

= UST BASIN AND PUMP ISLANDS

= MONITORING WELL

..... = SUBJECT PROPERTY

